

PLACED IN THE BUILDING COMMITTEE MEETING  
HELD ON 17.02.2023 & RECOMMENDED

CONDITIONALLY APPROVED THE PLAN AND NOTICE  
REGARDING INSPECTION BEFORE LAY OUT PLAN &  
BUILDING IS ATTACHED

Passed in the MIC Meeting  
Held on 17.02.2023

Passed in the Board Meeting  
Held on 22.02.2023



SOUTH SIDE ELEVATION  
SCALE - 1:100

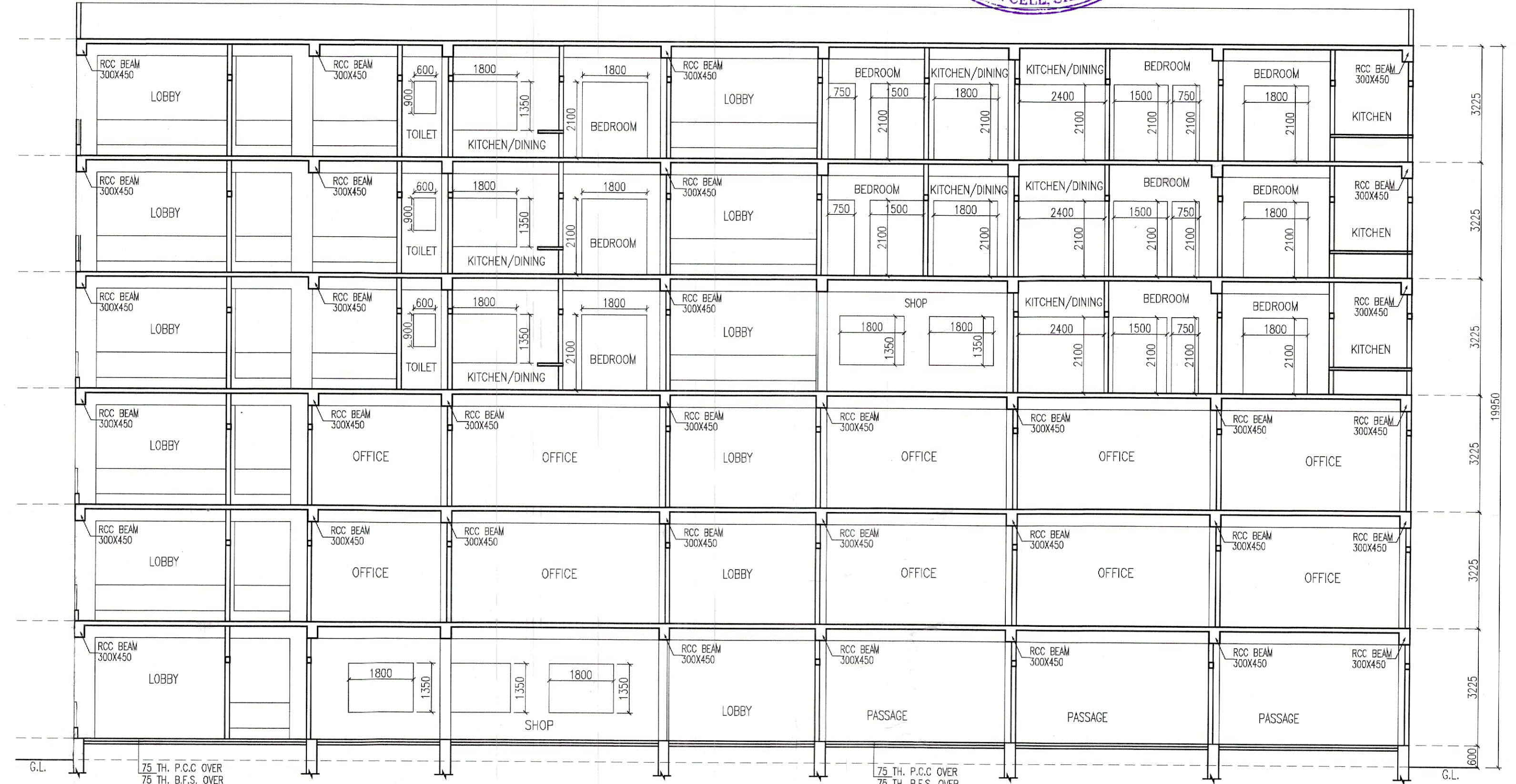

SECTION AT BB  
SCALE - 1:100



WEST SIDE ELEVATION  
SCALE - 1:100



NORTH SIDE ELEVATION  
SCALE - 1:100

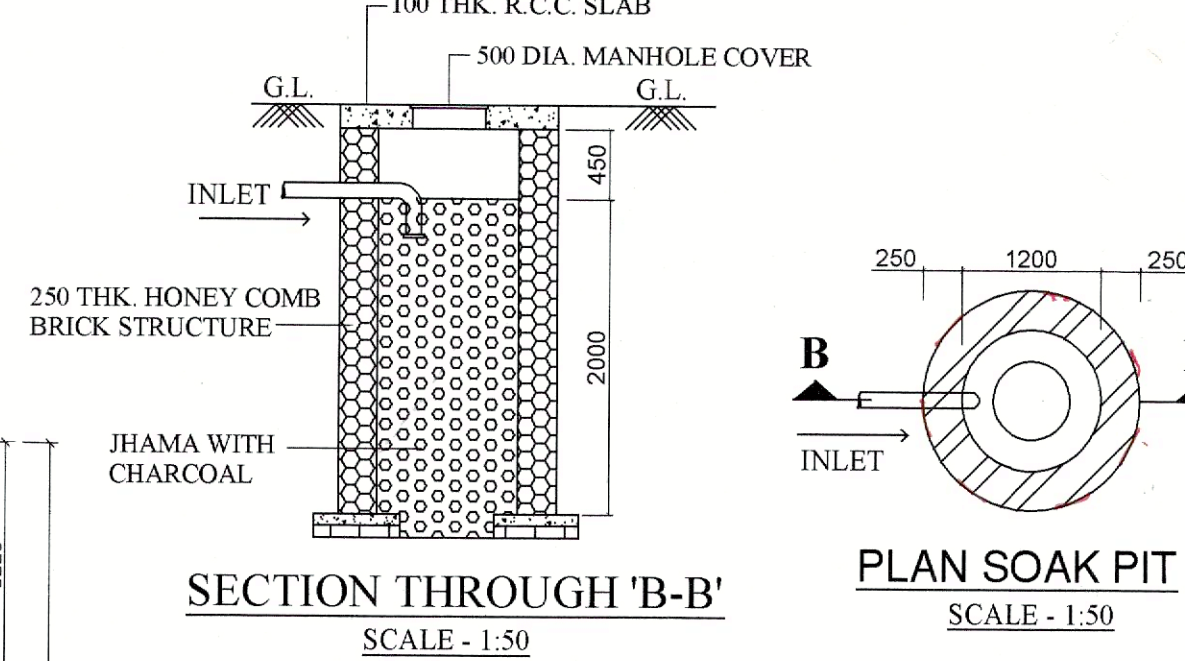

SECTION THROUGH 'B-B'  
SCALE - 1:50  
PLAN SOAK PIT  
SCALE - 1:50

Sanctioned by  
Commissioner  
Siliguri Municipal Corporation

Executive Engineer  
Siliguri Municipal Corporation  
Siliguri



Valid for Three Years  
From the Date of  
Sanctioned 22.02.2023



EAST SIDE ELEVATION  
SCALE - 1:100

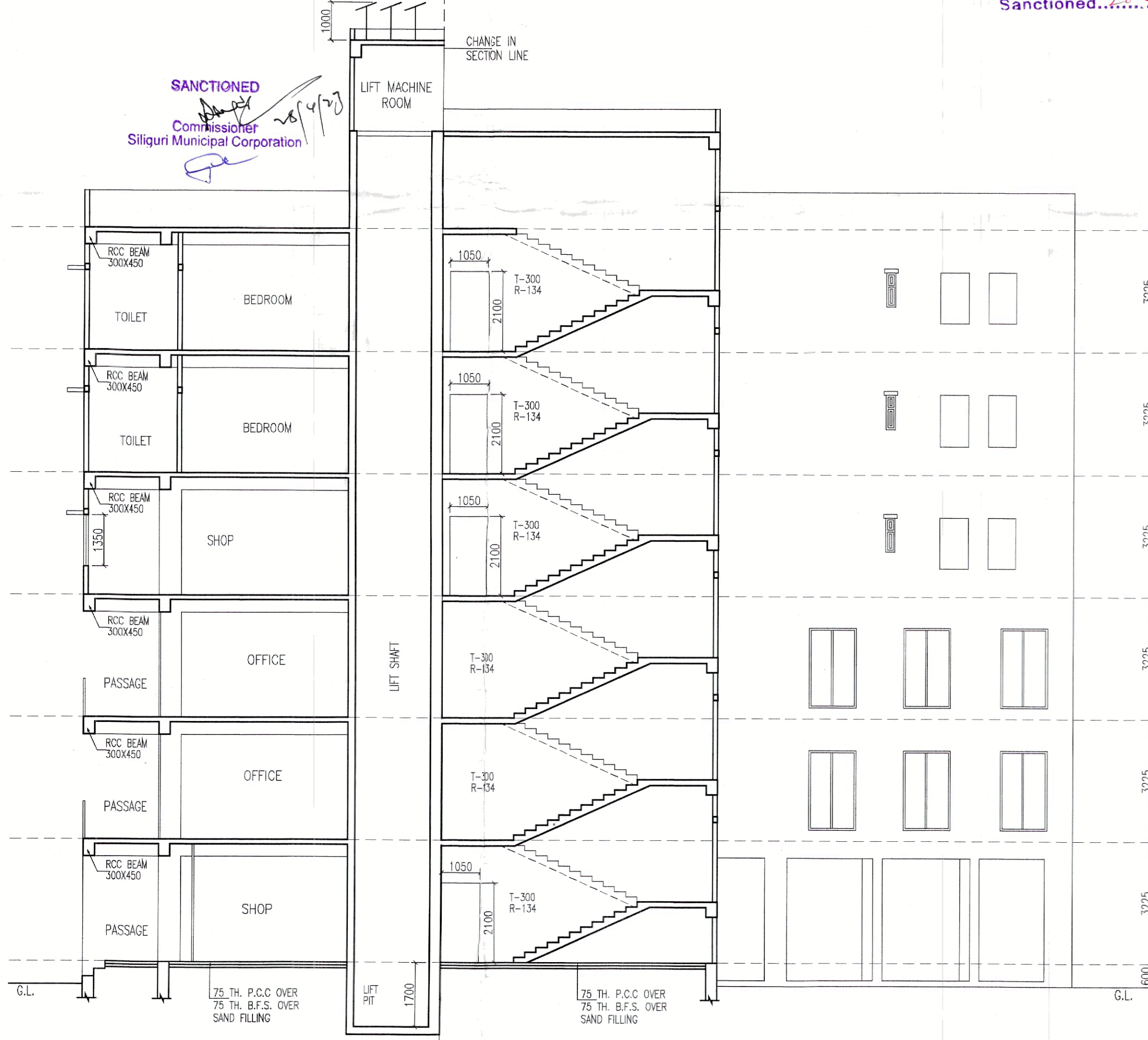

SECTION AT AA  
SCALE - 1:100

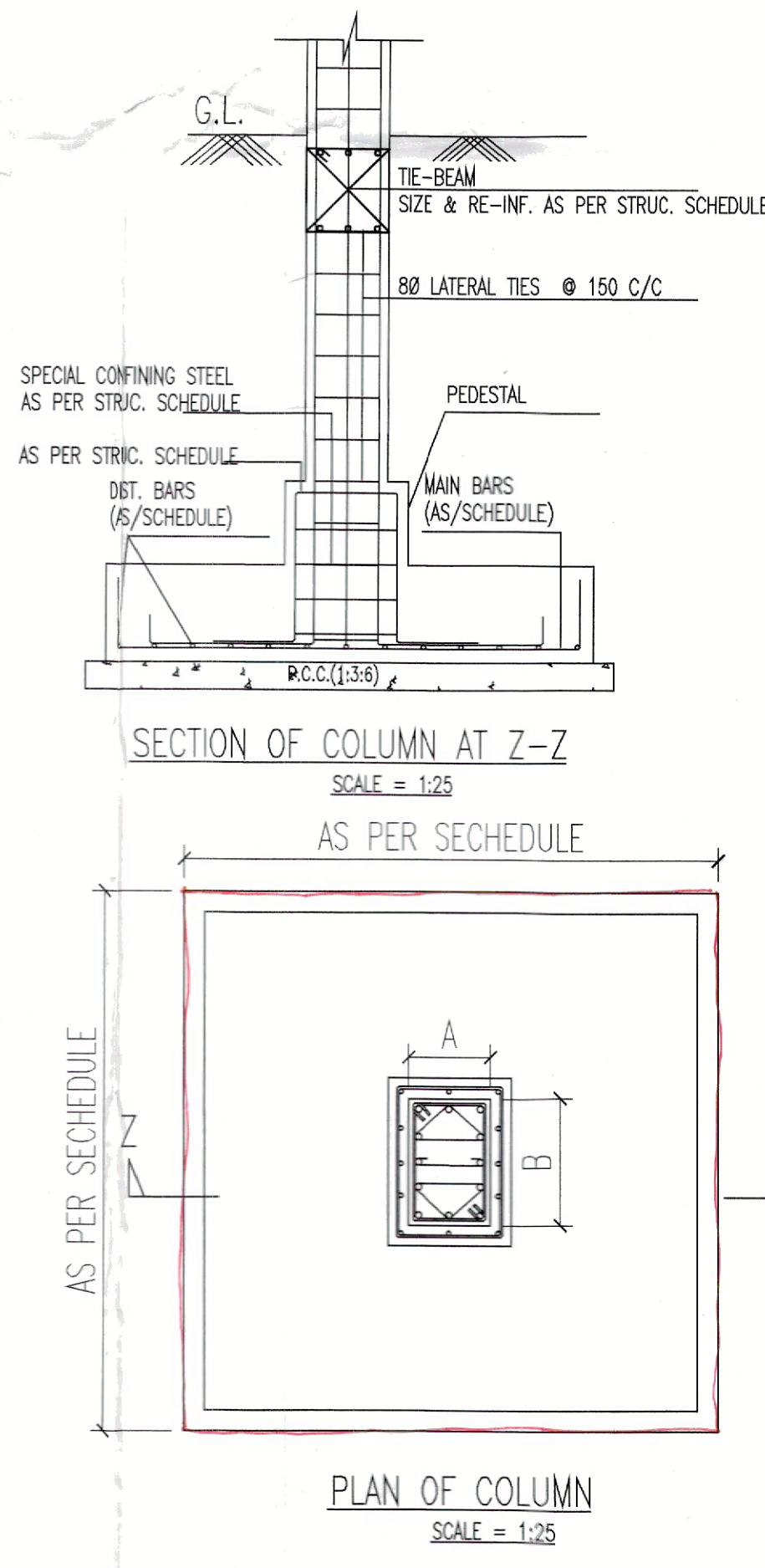

SECTION OF COLUMN AT Z-Z  
SCALE = 1:25

PLAN OF COLUMN  
SCALE = 1:25

REVISED PROP. GROUND + 5 STD. RESIDENTIAL  
CUM COMMERCIAL BUILDING AT PRADHAN  
NAGAR, NEAR NORTH BENGAL CLINIC, SILIGURI

LOCATION - NEAR NORTH BENGAL CLINIC

OWNER:  
SWARNMAHAL INFRAPROJECT PVT. LTD. @LLP,  
REP. BY. SRI RATAN KUMAR BANK

SMC HOLDING NO. - 189/14/325 DT. - 04.07.2019  
APVD. L.U.CC MEMO NO. - 3474/SJDA DT. - 08.07.2019  
APVD. SITE PLAN NO. - 558 DT. - 31.08.2019  
PREV. APVD. PLAN NO. - 595

LAND SCHEDULE -  
MOUZA - SILIGURI  
PLOT NO - 291, 309 (RS), 2947 (LR)  
J.L. NO. - 110 (88)  
KHATAN NO. - 432, 423/8 (RS), 1430 (LR)  
SHEET NO. - 3 (RS), 09 (LR)  
W.NO. - 02 (S.M.C.)  
PARAGANA - BAIKUNTHAPUR  
P. S. - PRADHANNAGAR  
DIST. - DARJEELING

DECLARATION BY OWNER  
I DO HEREBY DECLARE THAT THE BUILDING PROPOSED FOR CONSTRUCTION  
SHALL BE SUPERVISED BY THE L.B.A. / S. ENGINEER THE BUILDING PLAN  
APPLICATION OR IN HIS ABSENCE BY ANY OTHER L.B.A./S. OF THE  
APPROPRIATE CATEGORY AND AS APPROVED BY THE AUTHORITY.

SWARNMAHAL INFRAPROJECTS LLP  
Rajon ko Banile  
PRTNER

SIGNATURE OF OWNER

DECLARATION BY L.B.S./L.B.A.  
I DO HEREBY CERTIFY THAT THE PLANS, ELEVATION, SECTION AND OTHER  
STRUCTURAL DETAILS OF THE PROPOSED BUILDING ON THE PLOT NO. 291, 309 (RS),  
WARD NO. - 02 UNDER THE JURISDICTION OF SILIGURI MUNICIPAL CORP. AUTHORITY,  
HAVE BEEN PREPARED IN CONFORMITY WITH ALL RELEVANT PROVISIONS UNDER THE  
WEST BENGAL MUNICIPAL BUILDING RULES 2007. THIS IS ALSO TO CERTIFY THAT ALL  
RELEVANT NO OBJECTION CERTIFICATE FROM THE RESPECTIVE AUTHORITIES SUCH  
AS FIRE AND EMERGENCY SERVICES, AIRPORT AUTHORITY, POLLUTION CONTROL  
BOARD, TELECOMMUNICATION DEPT. ETC ARE ALSO ENCLOSED WITH THE  
APPLICATION FOR SECURING OF THE PLAN TO CONSTRUCTION/RECONSTRUCTION.  
ADDITION TO ALTERATION ON THE SAID PLOT.

Pritham Dey  
PRITHAM DEY (B. Arch.)  
COUNCILING ARCHITECT  
CA/2006/39076

SIGNATURE OF L.B.A.

DECLARATION BY GEO TECHNICAL ENGG.  
I DO HEREBY CERTIFY THAT THE FOUNDATION & SUPERSTRUCTURE OF THE  
PROPOSED BUILDING ON THE PLOT NO. 291, 309 (RS), WARD NO. - 02 UNDER THE  
JURISDICTION OF SILIGURI MUNICIPAL CORP. AUTHORITY, HAVE BEEN PERSONALLY  
INSPECTED BY ME AND WILL BE MANUFACTURED AND SUPERSTRUCTURE SAFE  
IN ALL RESPECTS INCLUDING THE CONSIDERATION OF BEARING CAPACITY AND  
SETTLEMENT ON SOIL AND OTHER GEOTECHNICAL ASPECTS IF ANY CONFORMING TO ALL  
STIPULATIONS OF ALL RELEVANT S. CODES OF PRACTICE AND NATIONAL BUILDING  
CODE.

Soumen Adak  
SOUJEN ADAK  
Structural Engineer, Class-1  
S.M.C. Empanment No.-24  
E-25/10, Nirman Abadan,  
EKTIP, Phase-V, Kolkata-700107  
Mob. No.-9311029467  
soumen\_sga@yahoo.com

Sulagno Banerjee  
SULAGNO BANERJEE  
EMANELLED GEOTECHNICAL ENGINEER-I  
Siliguri Municipal Corporation  
Empanment No: G.7/1/14, MGS (LM-48)  
Ph. No: 6290246698 / 9231829649

TITLE -  
ELEVATIONS & SECTIONS

DRAWN SOURAV SCALE AS SHOWN  
CHKD. S. M. SHEET NO. 03/03

Subrata Majumder  
Majumder & Associates  
Cont. - +91-9832062034, +91-9933575581