

STATE GOVT. HOUSING  
39518

CONTRACT APPROVED THE PLAN AND NOTICE  
REMARKS INSPECTION BEFORE LAY OUT PLAN &  
BASING OF FOUNDATION & ROOF CASTING OF  
BUILDING ATTACHED

Passed in the Mut. Meeting  
Held on 18-2-19

Passed in the Board Meeting  
Held on 28-2-19

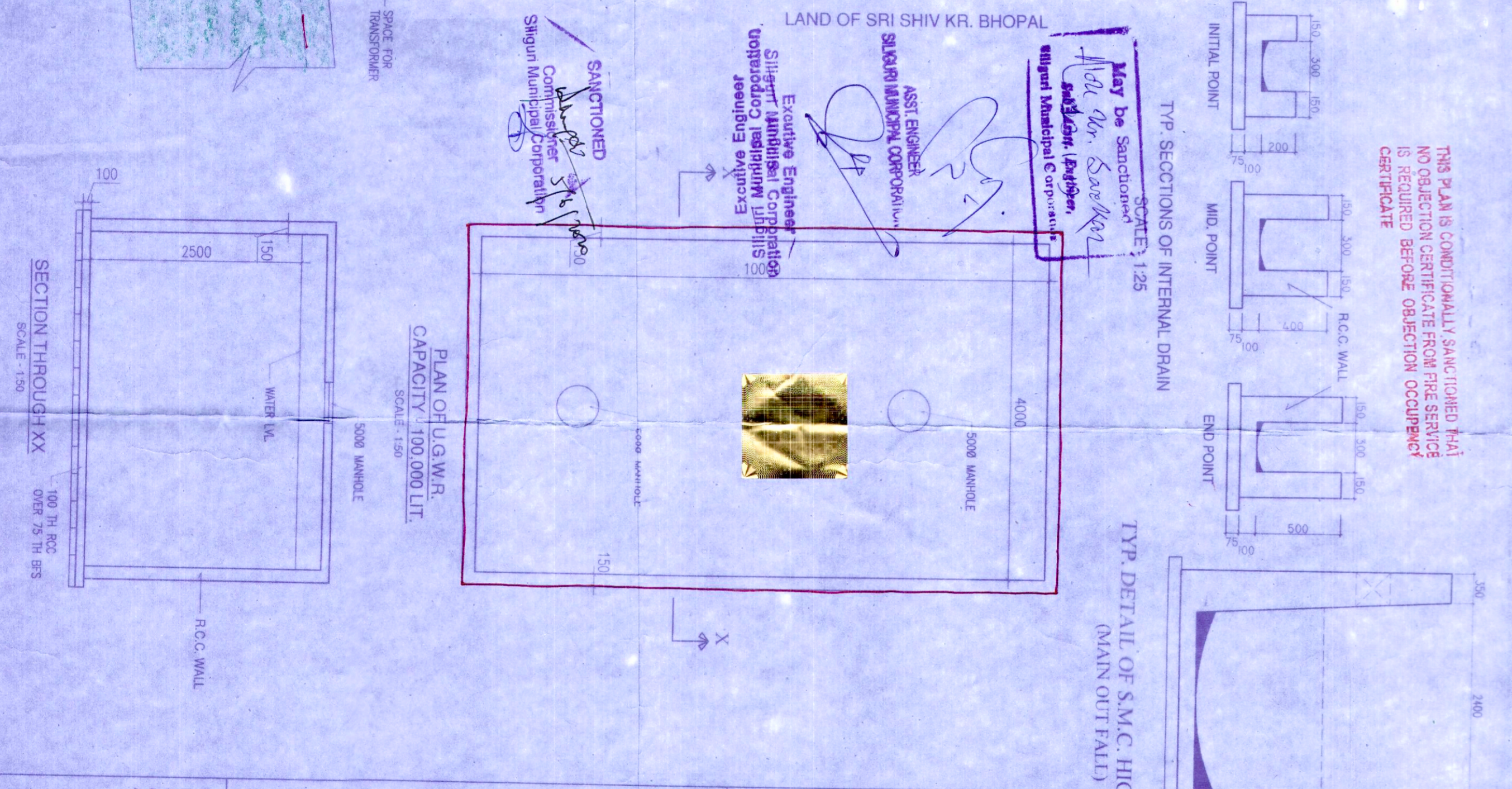
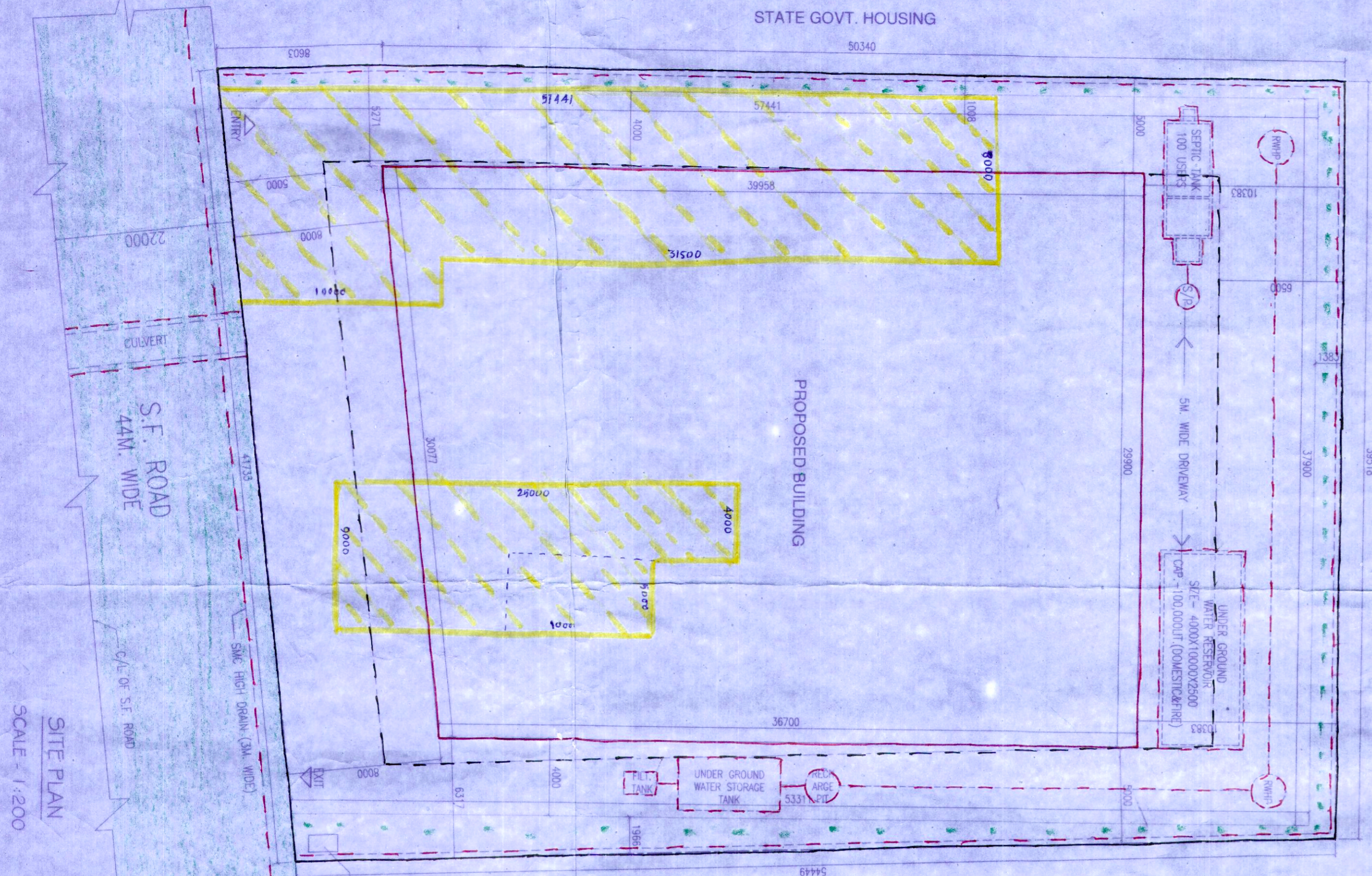
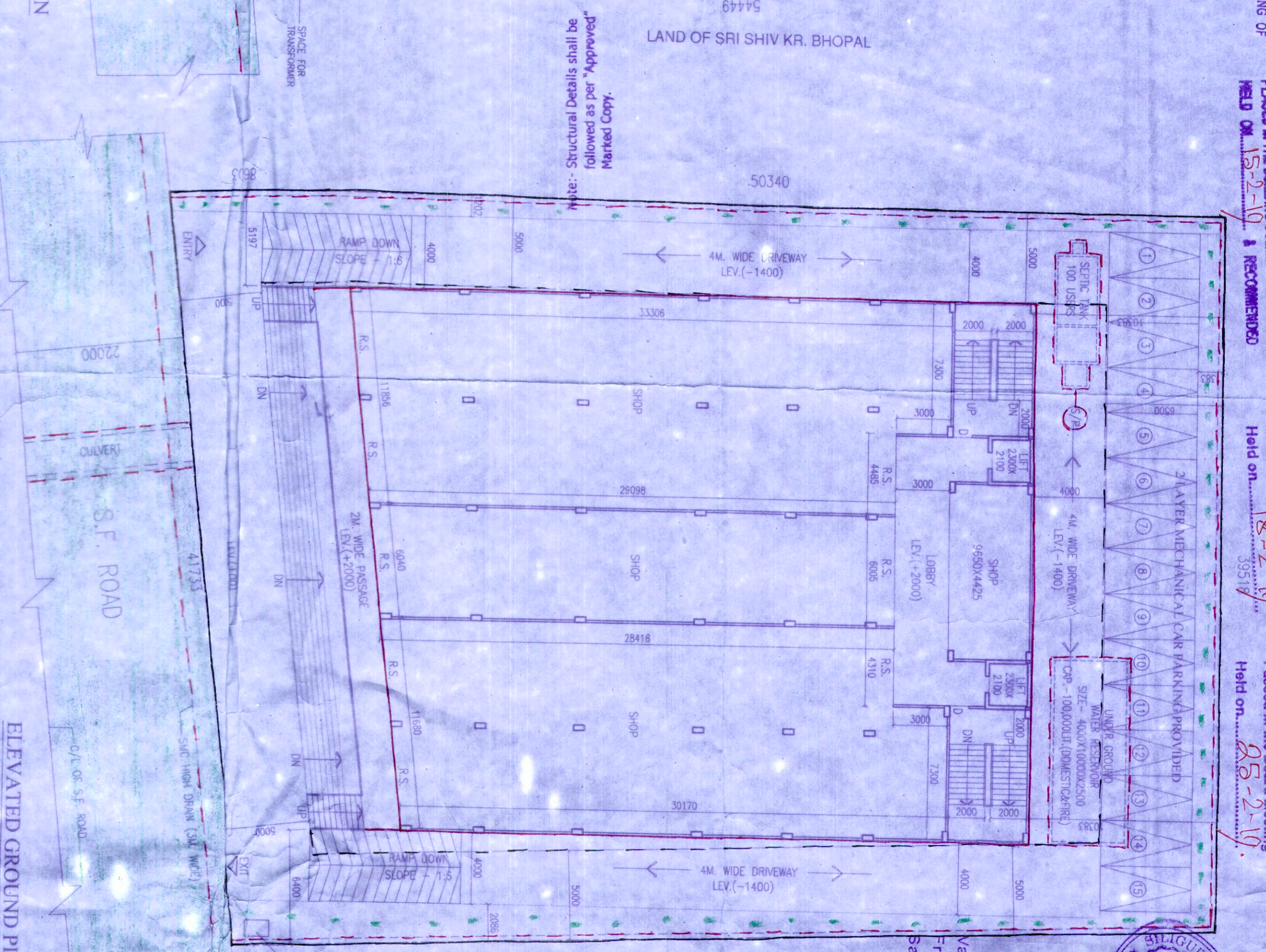
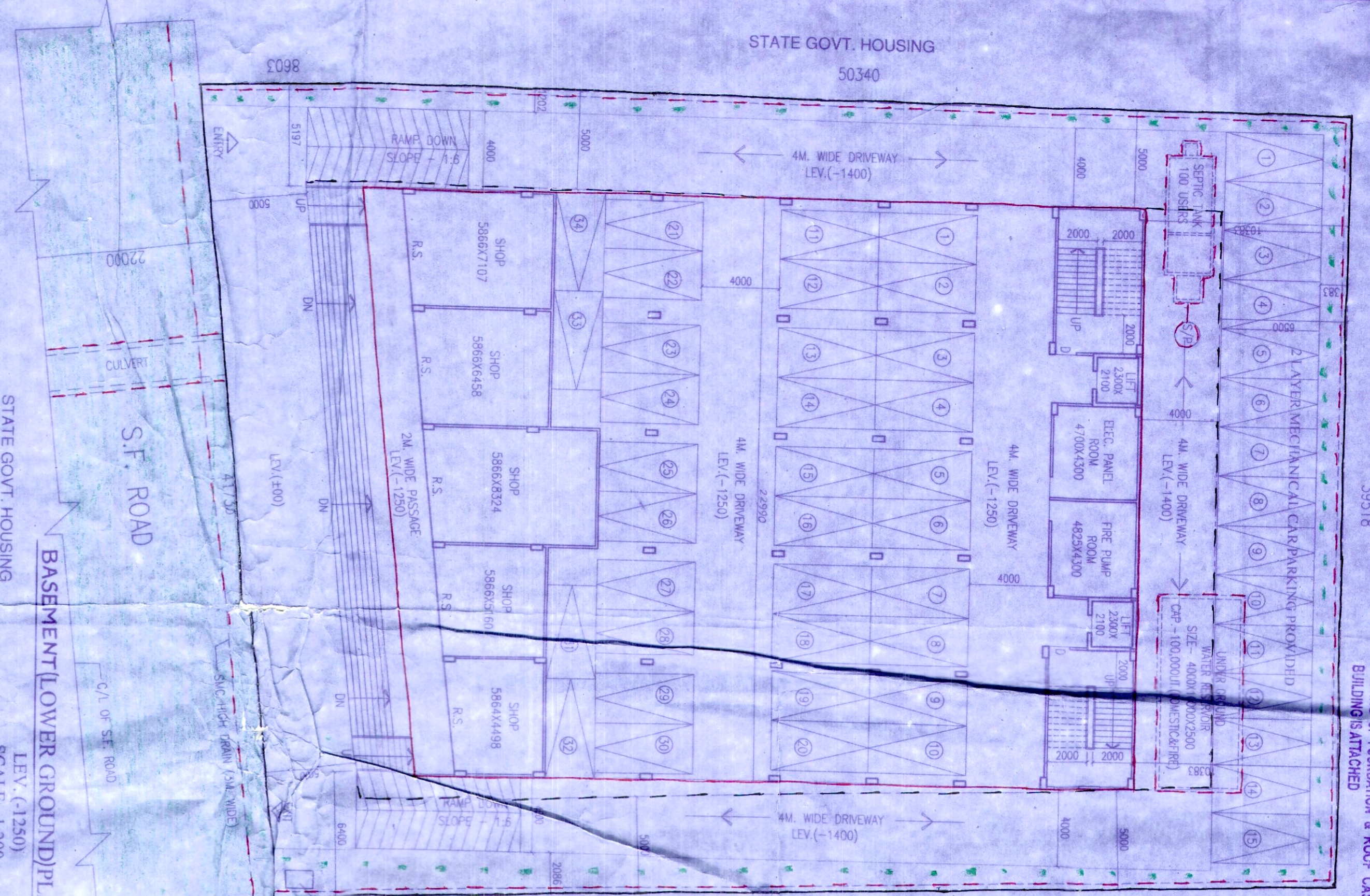

**PRITAM DEVI (B Arch)**  
Consulting Architect  
C/210/80/29/1078

**Signature of L.B.S.A.B.A.**

**DECLARATION BY GEO TECHNICAL ENGR.**

**DECLARATION BY L.B.S.A.B.A.**

**DECLARATION BY OWNER**

**Signature of Owner**

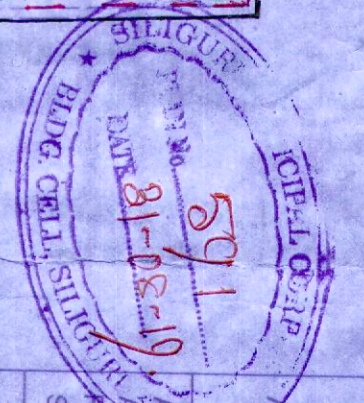

**PROJ. BASEMENT (LOWER GR) + 7 STORED  
RESIDENTIAL CUM COMMERCIAL BUILDING  
AT S.F. ROAD, OPP. FIRE BRIGADE, SILIGURI,  
DIST. - DARJEELING**

**NAME OF OWNERS:**  
1. SRI. SUSHIL KUMAR BHUPAL  
S/O LT. MAHABIR PRASAD BHUPAL

**SCHEDULE OF LAND**

**LAND AREA AS PER DEED**  
LAND AREA AS PER SITE  
PERM. GR. COVERAGE  
PERM. HT. OF BUILDING  
PROP. HT. OF BUILDING  
OPEN SPACE LEFT

**FLOOR AREAS:**  
BASEMENT (LOWER GR.)  
SHOP AREA (INCL. FRONT PASS)  
COMMON AREA  
CAR PARKING AREA  
TOTAL AREA

**LAND AREA AS PER DEED**  
LAND AREA AS PER SITE  
PERM. GR. COVERAGE  
PERM. HT. OF BUILDING  
PROP. HT. OF BUILDING  
OPEN SPACE LEFT

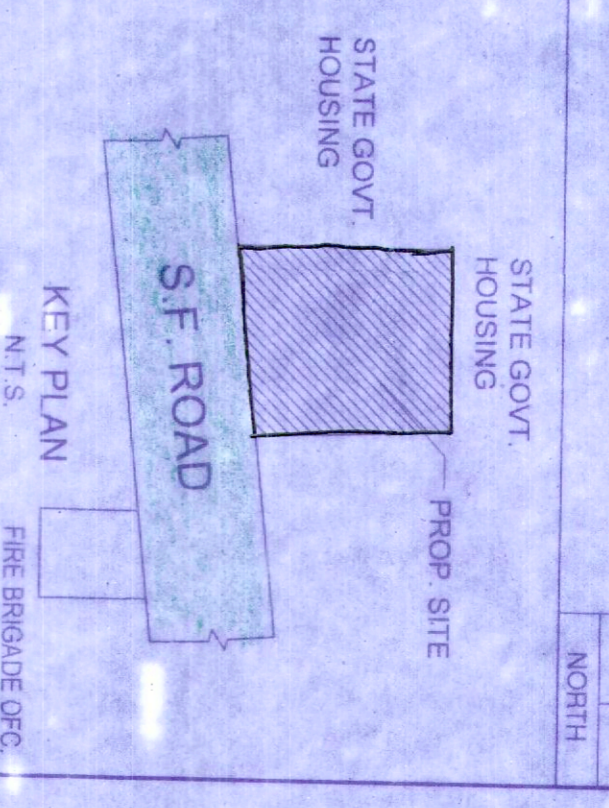

TITLE	SCALE	SHEET NO.	AS SHOWN
BASEMENT PLAN, LOWER GR. PLAN, E.L.V. GR. PLAN, SITE PLAN	SCALE 1:200	01/04	

ITEM	DESCRIPTION	AREA (SQ.M)
1	LAND AREA AS PER DEED	2208.71 SQ.M
2	LAND AREA AS PER SITE	2208.71 SQ.M
3	PERM. GR. COVERAGE	50% OF 1152.35 SQ.M
4	PERM. HT. OF BUILDING	40.27% OF 1166.04 SQ.M
5	PROP. HT. OF BUILDING	25.45 M
6	OPEN SPACE LEFT	50.27% OF 1158.47 SQ.M

ITEM	DESCRIPTION	AREA (SQ.M)
1	LAND AREA AS PER DEED	2208.71 SQ.M
2	LAND AREA AS PER SITE	2208.71 SQ.M
3	PERM. GR. COVERAGE	50% OF 1152.35 SQ.M
4	PERM. HT. OF BUILDING	40.27% OF 1166.04 SQ.M
5	PROP. HT. OF BUILDING	25.45 M
6	OPEN SPACE LEFT	50.27% OF 1158.47 SQ.M

ITEM	DESCRIPTION	AREA (SQ.M)
1	LAND AREA AS PER DEED	2208.71 SQ.M
2	LAND AREA AS PER SITE	2208.71 SQ.M
3	PERM. GR. COVERAGE	50% OF 1152.35 SQ.M
4	PERM. HT. OF BUILDING	40.27% OF 1166.04 SQ.M
5	PROP. HT. OF BUILDING	25.45 M
6	OPEN SPACE LEFT	50.27% OF 1158.47 SQ.M

**Majumdar & Associates**  
Civil Engineers & Architects  
C/210/80/29/1078