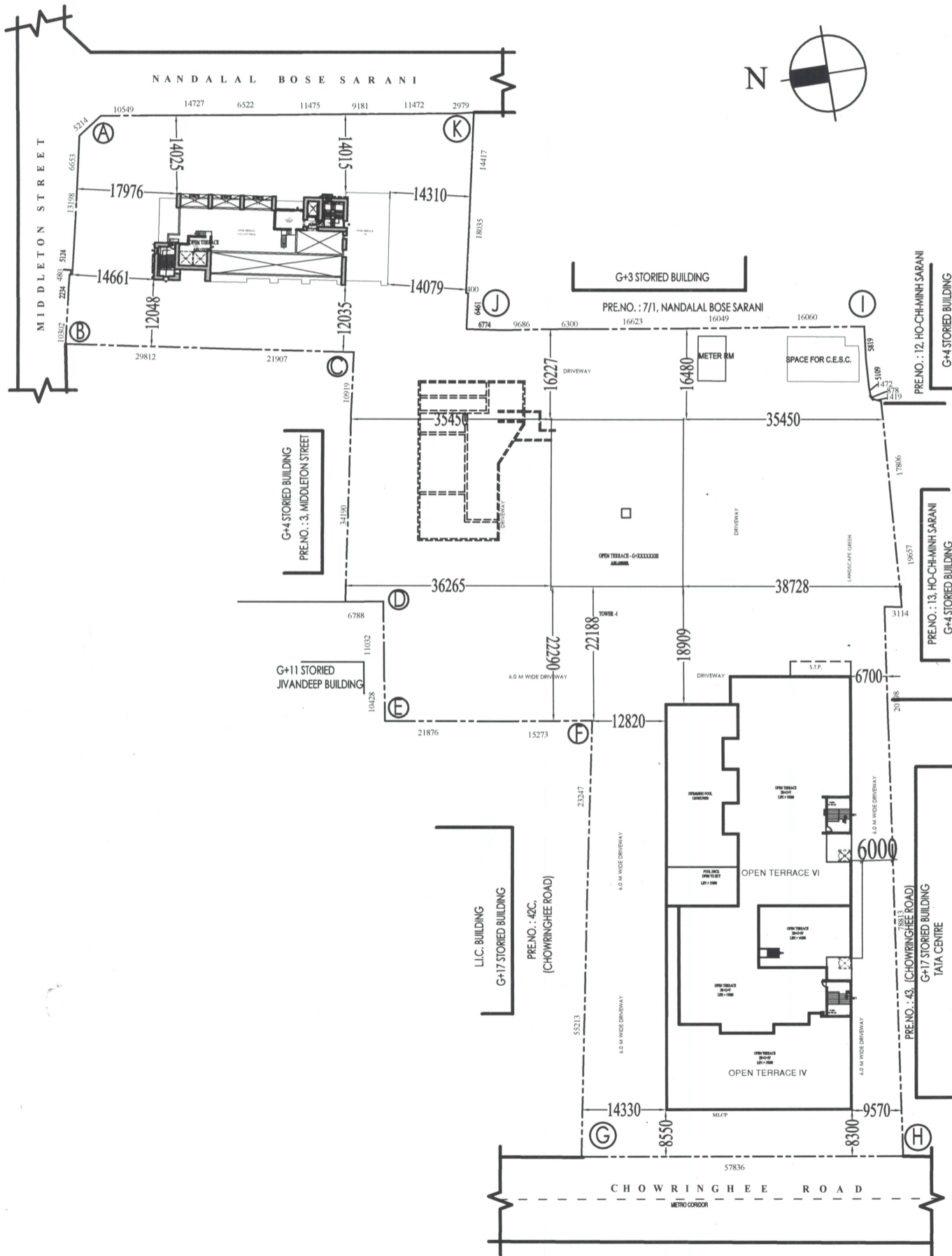

Table: All Corner Coordinates

SL. No	Latitude	Longitude
A.	22°32'56.57"N	88°21'2.49"E
B.	22°32'57.06"N	88°21'1.14"E
C.	22°32'55.50"N	88°21'0.61"E
D.	22°32'55.65"N	88°20'59.03"E
E.	22°32'55.83"N	88°20'58.36"E
F.	22°32'54.73"N	88°20'57.99"E
G.	22°32'55.21"N	88°20'55.61"E
H.	22°32'53.40"N	88°20'55.12"E
I.	22°32'52.39"N	88°20'59.94"E
J.	22°32'54.54"N	88°21'0.56"E
K.	22°32'54.18"N	88°21'1.81"E



SITE PLAN
SCALE 1 : 600

Si

Subir Kumar Basu

SUBIR KUMAR BASU
Registered Architect
Regn. No.- CA/78/4375

SIGNATURE OF ARCHITECT.

PROJECT :
PROPOSED 2B+G+44 STORIED (HT.- 157.93 M.) RESIDENTIAL BUILDING (TOWER-2) AND CESC DISTRICTUION BUILDING (HT.- 6.5 M.) U/S 394 OF K.M.C. ACT '1980' & U/R 69A(1)(C) OF K.M.C. BUILDING RULE 2009. WITH SUPERSEEDING THE SANCTIONED PLAN VIDE B.P. NO. 2022070139 DATED 07/11/2022, IN ADDITION WITH EXISTING (G+62)STORIED (HT.+249.36 M.) RESIDENTIAL BUILDING (TOWER-1)AND 2B +G+V STORIED (HT.+19.20 M.) MLCP BUILDING AT PRE. NO. 42B CHOWRINGHEE ROAD, KOLKATA-700071, WARD-63, BOROUGH-VII.

THE PREVIOUS BUILDING PERMIT NO. 2012070281, DATED. 14.12.2012 & REVALIDATED FOR 5 YEARS FROM 14.12.17. APPROVED BY DY.CE (C) BLDG. BR-VII, DATED-16.3.18 SUBSEQUENTLY REGULARIZED U/R 26 (2a) & 2(b) APPROVED BY M.B.C. MEETING DATED 20.06.2018

FURTHER SANCTIONED U/S 394 VIDE BUILDING PERMIT NO. 2018070238, DATED. 18.01.2019 AND COMPLETION CERTIFICATE OBTAINED FOR TOWER-1 AND MLCP BUILDING VIDE COMPLETION CASE NUMBER 2021070001 DATED 26.04.2021.

ARCHITECT:-

Subir Kumar Basu

4, Broad Street, kolkata - 700019

(T) +91 33 22870333, (F) +91 33 22833043

(E) basu_subirkumar@yahoo.com

Designed:	Drawn:	Checked:	Approved:
	D.PAL	S. CHAKRABORTY	S. K. BASU