

ROOF PLAN
Scale 1:100

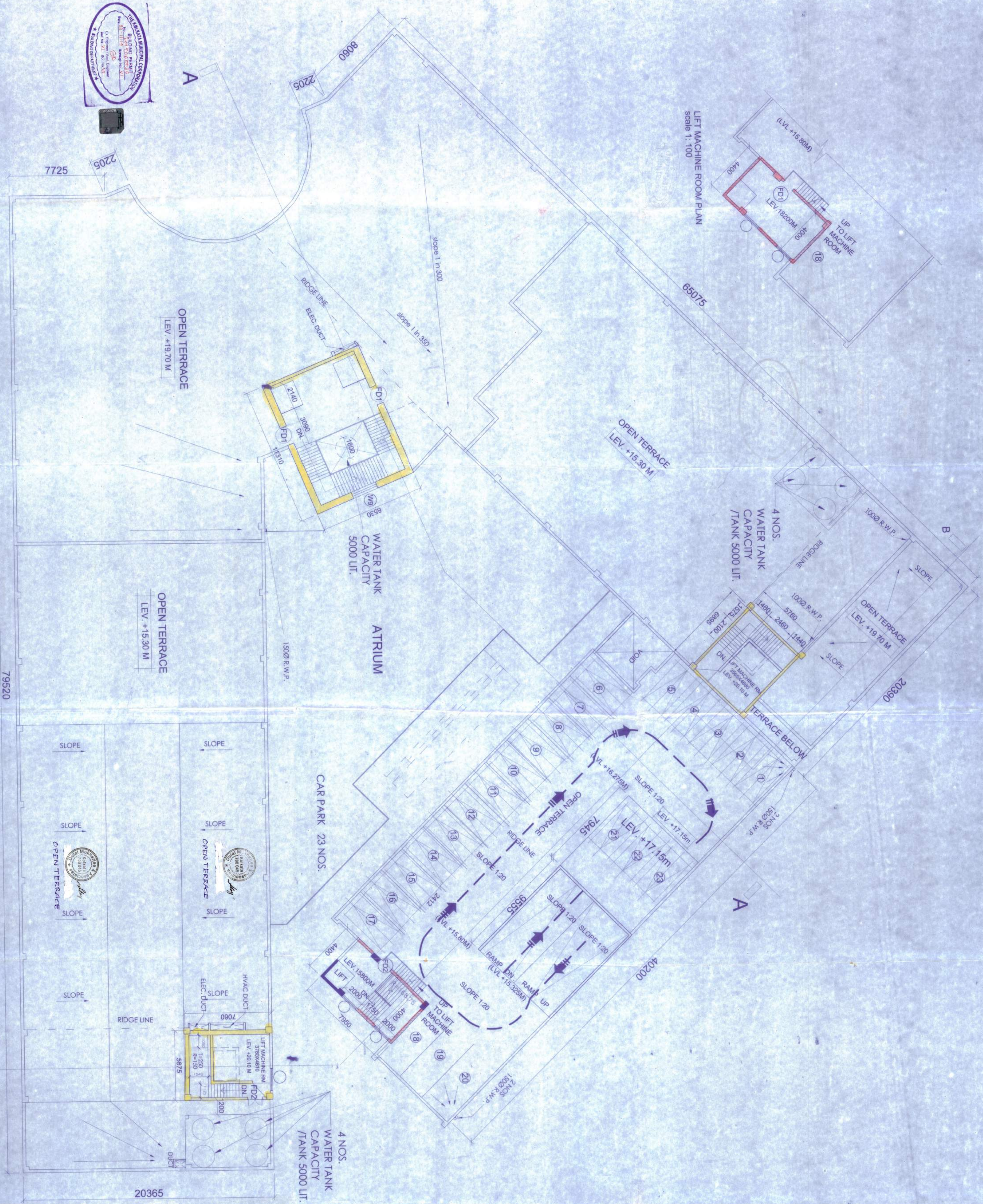

PROJECT
ADDITION AND ALTERATION OF
STATESMAN HOUSE
AT PREMISES NO. 4, CHROMINGHEE SQUARE
KOLKATA 700001

TITLE
ROOF PLAN

DRG. NO.	S289/0389/A-09	DATE	12.11.2019
SCALE	1:100	DESIGNED BY	DM/ASB
DATE	12.11.2019	CHECK BY	DM/ASB
JOB NO.	DM/ASB	APPROVED BY	DM
ISSUE STATUS	ISSUE FOR PERMIT	DESIGNED BY	DM

NOTE:
1. All dimensions are in meters unless otherwise stated.
2. All structural details are to be as per the approved drawings unless otherwise indicated.

STRUCTURAL CONSULTANT
M.N. CONSULTANTS PVT. LTD.
VILLAGE: BILIMORIGUDA, POST: BILIMORIGUDA
DISTRICT: CHITTOUR, ANDHRA PRADESH

CLIENT'S DECLARATION:
I, the undersigned, hereby declare that the above mentioned building has been constructed in accordance with the approved drawings and specifications of the Structural Consultant and that the same is safe and sound and that I have no objection to the issue of the Certificate of Occupancy for the same.

Signature: _____
Name: _____
Address: _____
Date: _____

Client's Declaration:
I, the undersigned, hereby declare that the above mentioned building has been constructed in accordance with the approved drawings and specifications of the Structural Consultant and that the same is safe and sound and that I have no objection to the issue of the Certificate of Occupancy for the same.

Signature: _____
Name: _____
Address: _____
Date: _____

Professional Engineer's Stamp:
D. Srinivasan
No. 12345
State of Karnataka

Architect's Stamp:
DUAL WUKHREEE & ASSOCIATES
28 B SHANKARAPUR STREET, CHITTOUR, ANDHRA PRADESH

CERTIFIED COPY

CERTIFIED COPY

ROSAKIA MUNICIPAL CORPORATION
MUNICIPAL ENGINEER'S
CERTIFIED COPY OF S.S. PLAN
No. 2817-B-2022 D.C. 23-11-19
Brought No. 2817-B-2022
Approved: [Signature]
Municipal Engineer

2817-B-2022

Before starting any construction the contractor shall submit to the Engineer a copy of this plan and a copy of the contract. The validity of the within permission is subject to the above conditions.

Director of all Structural Members should conform to standards included in the National Building Code of India.

All Building Materials to be used in construction shall conform to the National Building Code of India.

Non-Commencement of Estimated Work within Five years will require re-approval of permission.

REVISIONS TO BE MADE BY THE CONTRACTOR AT HIS OWN RISK AND COST. THE CONTRACTOR SHALL BE RESPONSIBLE FOR THE SAFETY OF THE WORK.

APPROVED AS PER THE PROVISIONS OF M.C. AND REGULATIONS IN FORCE AT THE DATE OF APPROVAL.

APPROVED BY: [Signature]
Municipal Engineer

APPROVED BY: [Signature]
Municipal Engineer

APPROVED BY: [Signature]
Municipal Engineer

APPROVED BY: [Signature]
Municipal Engineer

APPROVED BY: [Signature]
Municipal Engineer

APPROVED BY: [Signature]
Municipal Engineer

APPROVED BY: [Signature]
Municipal Engineer

APPROVED BY: [Signature]
Municipal Engineer

APPROVED BY: [Signature]
Municipal Engineer

APPROVED BY: [Signature]
Municipal Engineer

APPROVED BY: [Signature]
Municipal Engineer

APPROVED BY: [Signature]
Municipal Engineer

APPROVED BY: [Signature]
Municipal Engineer

APPROVED BY: [Signature]
Municipal Engineer

APPROVED BY: [Signature]
Municipal Engineer

APPROVED BY: [Signature]
Municipal Engineer

APPROVED BY: [Signature]
Municipal Engineer

APPROVED BY: [Signature]
Municipal Engineer

APPROVED BY: [Signature]
Municipal Engineer

APPROVED BY: [Signature]
Municipal Engineer

APPROVED BY: [Signature]
Municipal Engineer

APPROVED BY: [Signature]
Municipal Engineer

APPROVED BY: [Signature]
Municipal Engineer

APPROVED BY: [Signature]
Municipal Engineer

APPROVED BY: [Signature]
Municipal Engineer

RECEIVED
DATE 21/11/22

