

### SCHEDULE OF COLUMN

LEVEL	GRID	SECTION	SECTION	SECTION	SECTION	SECTION	SECTION	SECTION	SECTION
ROOF & ABOVE LEVEL	10	10	10	10	10	10	10	10	10
1 <sup>ST</sup> FLOOR	10	10	10	10	10	10	10	10	10
2 <sup>ND</sup> FLOOR	10	10	10	10	10	10	10	10	10
3 <sup>RD</sup> FLOOR	10	10	10	10	10	10	10	10	10
FOUNDATION	10	10	10	10	10	10	10	10	10

### BEAM SCHEDULE

GRADE OF CONCRETE: M25	BEAM NO.	BEAM SIZE	REINFT. AT SUPPT.	REINFT. AT SPAN	STIRRUPS
	1	200 x 400	2-18 T, 2-18 B	2-18 T, 2-18 B	8 @ 100mm C/C
	2	200 x 400	2-18 T, 2-18 B	2-18 T, 2-18 B	8 @ 100mm C/C
	3	200 x 400	2-18 T, 2-18 B	2-18 T, 2-18 B	8 @ 100mm C/C
	4	200 x 400	2-18 T, 2-18 B	2-18 T, 2-18 B	8 @ 100mm C/C
	5	200 x 400	2-18 T, 2-18 B	2-18 T, 2-18 B	8 @ 100mm C/C

### SLAB SCHEDULE

SLAB NO.	THICKNESS	REINFT. AT SUPPORT	REINFT. AT LOWER SPAN	REINFT. AT UPPER SPAN
S1	150	8 @ 100 C/C (TOP)	8 @ 125 C/C (TOP)	8 @ 125 C/C (TOP)
S2	115	8 @ 125 C/C (TOP)	8 @ 150 C/C (BOTTOM)	8 @ 150 C/C (BOTTOM)
S3	125	10 @ 125 C/C (TOP)	10 @ 150 C/C (BOTTOM)	10 @ 150 C/C (BOTTOM)
S4	115	8 @ 125 C/C (TOP)	8 @ 150 C/C (BOTTOM)	8 @ 150 C/C (BOTTOM)
S5	125	10 @ 125 C/C (TOP)	10 @ 150 C/C (BOTTOM)	10 @ 150 C/C (BOTTOM)

### PILE CAP SCHEDULE

PILE CAP NO.	TYPE	DEPTH	REINFORCEMENT
1	1	1000	12 @ 80mm C/C (T), 12 @ 80mm C/C (B)
2	1	1000	12 @ 80mm C/C (T), 12 @ 80mm C/C (B)
3	1	1000	12 @ 80mm C/C (T), 12 @ 80mm C/C (B)
4	1	1000	12 @ 80mm C/C (T), 12 @ 80mm C/C (B)
5	1	1000	12 @ 80mm C/C (T), 12 @ 80mm C/C (B)

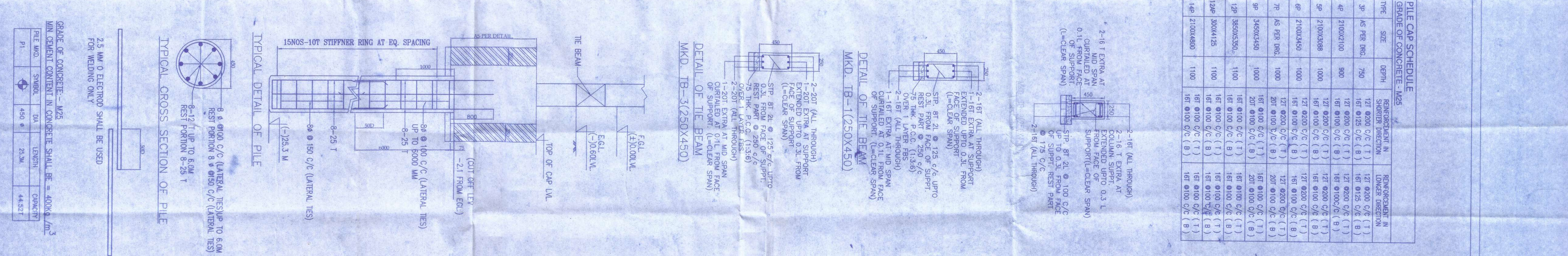
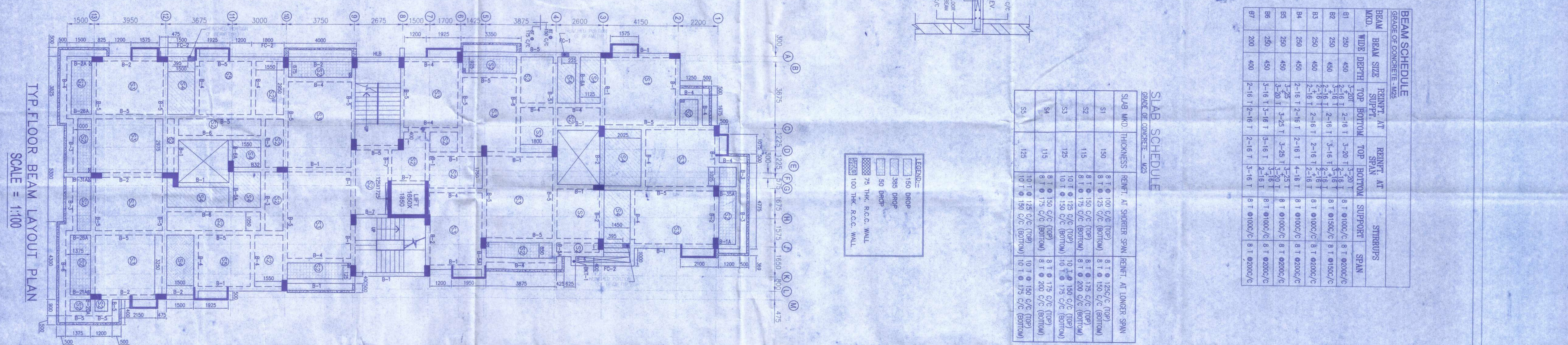
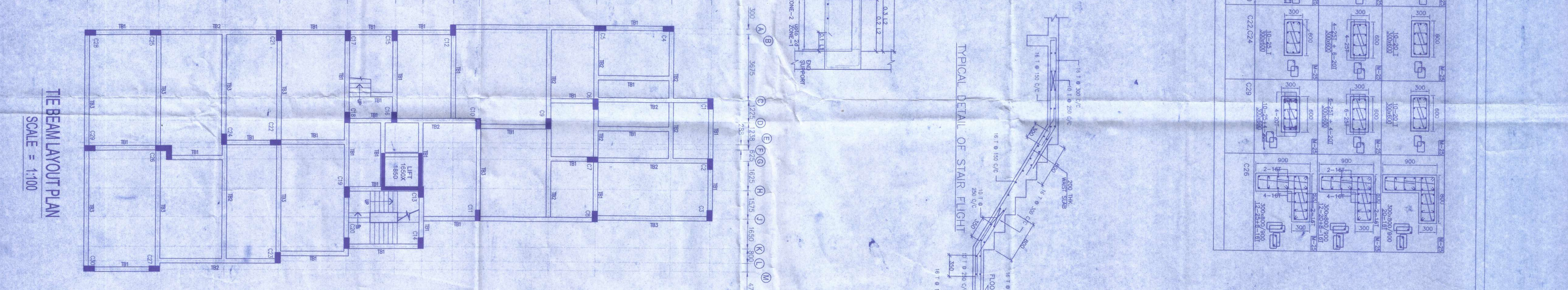
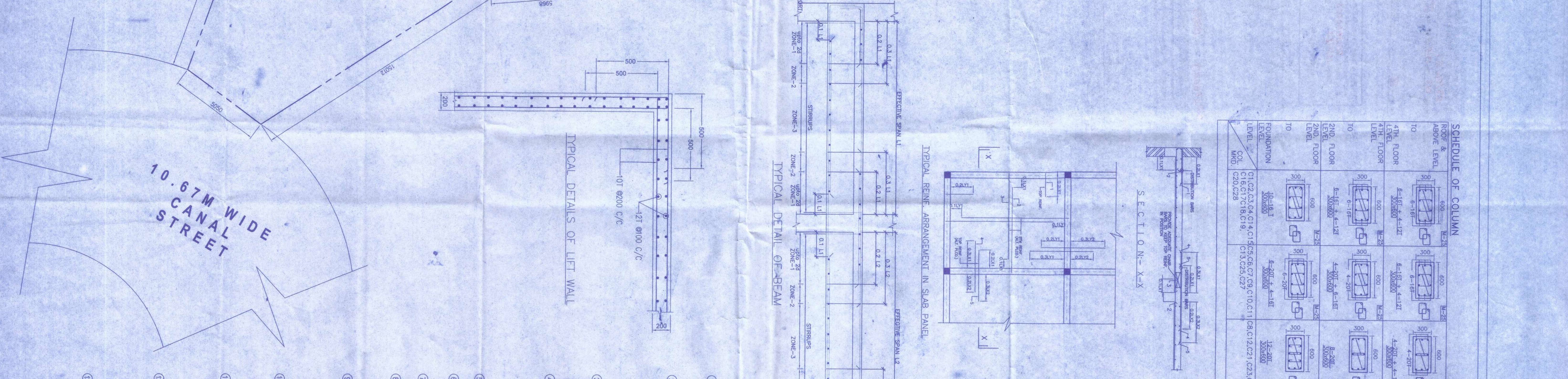
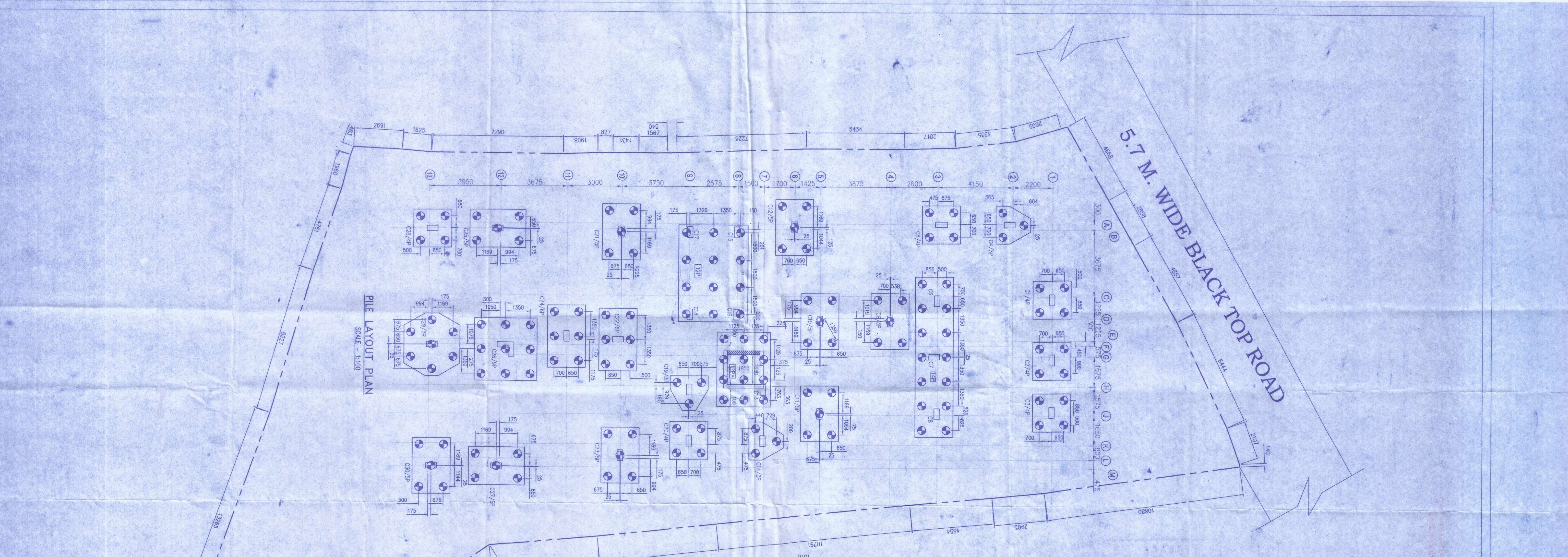

### NOTES AND SPECIFICATION

1. ALL DIMENSIONS ARE IN MILLIMETERS UNLESS OTHERWISE SPECIFIED.
2. ANY AMBIGUITY IN THE DRAWINGS SHOULD BE CLARIFIED BY THE CONSULTANT BEFORE COMMENCING WORK.
3. BRICK MASONRY SHALL BE AS PER IS: 8000.
4. THE BEAMING IS TO BE DONE ALONG WITH ALL RELEVANT WORK.
5. ALL MATERIALS SHALL CONFORM TO RELEVANT IS CODES.
6. ALL DIMENSIONS ARE TO BE PROVIDED UNLESS OTHERWISE SPECIFIED.
7. ALL DIMENSIONS ARE TO BE PROVIDED UNLESS OTHERWISE SPECIFIED.
8. ALL DIMENSIONS ARE TO BE PROVIDED UNLESS OTHERWISE SPECIFIED.
9. ALL DIMENSIONS ARE TO BE PROVIDED UNLESS OTHERWISE SPECIFIED.
10. ALL DIMENSIONS ARE TO BE PROVIDED UNLESS OTHERWISE SPECIFIED.
11. ALL DIMENSIONS ARE TO BE PROVIDED UNLESS OTHERWISE SPECIFIED.
12. ALL DIMENSIONS ARE TO BE PROVIDED UNLESS OTHERWISE SPECIFIED.
13. ALL DIMENSIONS ARE TO BE PROVIDED UNLESS OTHERWISE SPECIFIED.
14. ALL DIMENSIONS ARE TO BE PROVIDED UNLESS OTHERWISE SPECIFIED.
15. ALL DIMENSIONS ARE TO BE PROVIDED UNLESS OTHERWISE SPECIFIED.

**CERTIFICATE OF STRUCTURAL ENGINEER**  
 I hereby certify that the design and construction of the above structure is in accordance with the provisions of the Indian Standards Code of Practice for Reinforced Concrete Structures IS: 456-2000 and the Indian Standards Code of Practice for Design and Construction of Reinforced Concrete Structures IS: 10264-2009. I am a duly registered Structural Engineer with the Council of Registered Engineers and Architects, Kerala.

**NAME OF THE STRUCTURAL ENGINEER:** M.S. WIMA SAHA  
**REGISTERED NO.:** AC-99-866-01-117102  
**DATE:** 20/08/2023

**NAME OF THE ARCHITECT:** ANIRAV BISWAS  
**REGISTERED NO.:** CA/2010/117102  
**DATE:** 20/08/2023

**PROJECT:** REVISED PLAN JLN 25 (2) & 26) FOR THE PROPOSED G.V.V. P.S. ENTAILY, KOLAKATTA, 700/14 VIDE BUILDING PERMIT NO. 20 CANAL STREET, WARD NO. 55, BROUGHAM, K.M.C. ACT 1989 WITHIN THE KOLKATA MUNICIPAL CORPORATION.

**PROJECT NO.:** PRA/CONV/MK/SAC

**SCALE:** 1:100

**DATE:** 20/08/2023

**DRAWN BY:** S.S.MURTA

**CHECKED BY:** M.S.MURTA

**SHEET NO.:** 1 OF 1



**PARTY'S COPY**

*Approved by 29/04/13*

KOLKATA MUNICIPAL CORPORATION  
BUILDING DEPARTMENT  
PLANS APPROVED UNDER SECTION 110  
K.M.C. BUILDING RULES 1956  
IN 25/04/13  
No. 57  
Municipal Engineer  
B. No. : 57  
B. No. : 1097

This Plan is to be treated as Part  
And Part and Complies To  
B. Section 110 of the  
K.M.C. Building Rules 1956  
B. No. : 57  
B. No. : 1097

This Plan is to be treated as Part  
And Part and Complies To  
B. Section 110 of the  
K.M.C. Building Rules 1956  
B. No. : 57  
B. No. : 1097

