

PROPOSED TWO STORIED BUNGALOW AT
MOUZA-AMGACHIA, J.L. NO- 093, L.R. KHATIAN
NO.S-9830, 9750, 11116, 10955, 10954, 10953, 10952,
10951, 10950, 10949, 10948, 10947, 10946, 10945,
10944, 10943, 10942, 10941, 10913, 10912, 10911,
10879, 10878, 10877, 10876, 10875, 10874,
10879, 10346 & 10083.
L.R. DAG NO.-262, 268, 382, 383, 384, 384/718 & 385.
P.S.-BISHNUPUR, DIST. SOUTH 24 PARGANAS
UNDER AMGACHIA GRAM PANCHAYAT

AREA CALCULATION
TYPE-D
AREA STATEMENT OF ONE BUILDING:
 PLINTH AREA = 51.202 SQ.M
 = 551 SQ.FT.
 FIRST FLOOR AREA = 45.493 SQ.M
 = 490 SQ.FT.
TOTAL AREA = (51.202+45.493) SQ.M
 = 96.695 SQ.M
 = 1041 SQ.FT.
NO. OF PARKING = 1 NO.
TOTAL NUMBER OF BUILDING = 2 NOS.
TOTAL AREA OF 2 NOS BUILDING = (96.695 X 2) SQ.M
 = 193.39 SQ.M
 = 2082 SQ.FT.
TOTAL NOS. OF PARKING = 2 NOS.

I CERTIFY THAT ALL THE ARCHITECTURAL DRAWINGS OF PROPOSED TWO STORIED BUNGALOW AT MOUZA-AMGACHIA, J.L. NO- 093, L.R. KHATIAN NO.S-9830, 9750, 11116, 10955, 10954, 10953, 10952, 10951, 10950, 10949, 10948, 10947, 10946, 10945, 10944, 10943, 10942, 10941, 10913, 10912, 10911, 10879, 10878, 10877, 10876, 10875, 10874, 10679, 10346 & 10083, L.R. DAG NO.-262, 268, 382, 383, 384, 384/718 & 385, P.S.-BISHNUPUR, DIST. SOUTH 24 PARGANAS, UNDER AMGACHIA GRAM PANCHAYAT HAVE BEEN PREPARED BY ME COMPLYING WITH THE PROVISIONS OF THE NATIONAL BUILDING CODE 2005 AND THE WEST BENGAL MUNICIPAL BUILDING RULES 2007. NO SUCH WRONG AND INCORRECT INFORMATION HAS BEEN FURNISHED BY ME INCLUDING AREA CALCULATION CHARTS IN THIS DRAWINGS AND NO VIOLATION OF THE PROVISIONS OF THESE RULES WILL BE FOUND IN ANY OF THE DRAWINGS AND DOCUMENTS SUBMITTED TO THE SANCTIONING AUTHORITY FOR OBTAINING SANCTIONS.

Signature of Architect / Engineer

[Signature]
 CONSTITUTED ATTORNEY

AUTHORIZED SIGNATORY

TITLE : TYPE-D
 GROUND FLOOR PLAN, FIRST FLOOR PLAN, ROOF PLAN, ELEVATION AT E1 SECTION X-X, FOUNDATION LAYOUT, TIE BEAM LAYOUT AT 1850 LVL, TIE BEAM LAYOUT AT 40.0 LVL, FIRST FLOOR DOOR & WINDOW LAYOUT, TYPICAL DETAIL OF COLUMN, FOUNDATION & STAIR, SCHEDULE OF FOUNDATION, COLUMN, BEAM & SLAB

DRAWN BY :	PP
CHECKED BY :	A.C
SCALE :	1 : 100
SUBMISSION DRAWING	
DRAWING NO :	REVISION NO :
DWC-ARCH / SAN / BD4 (AN4) - BD7D	(F2) / 05

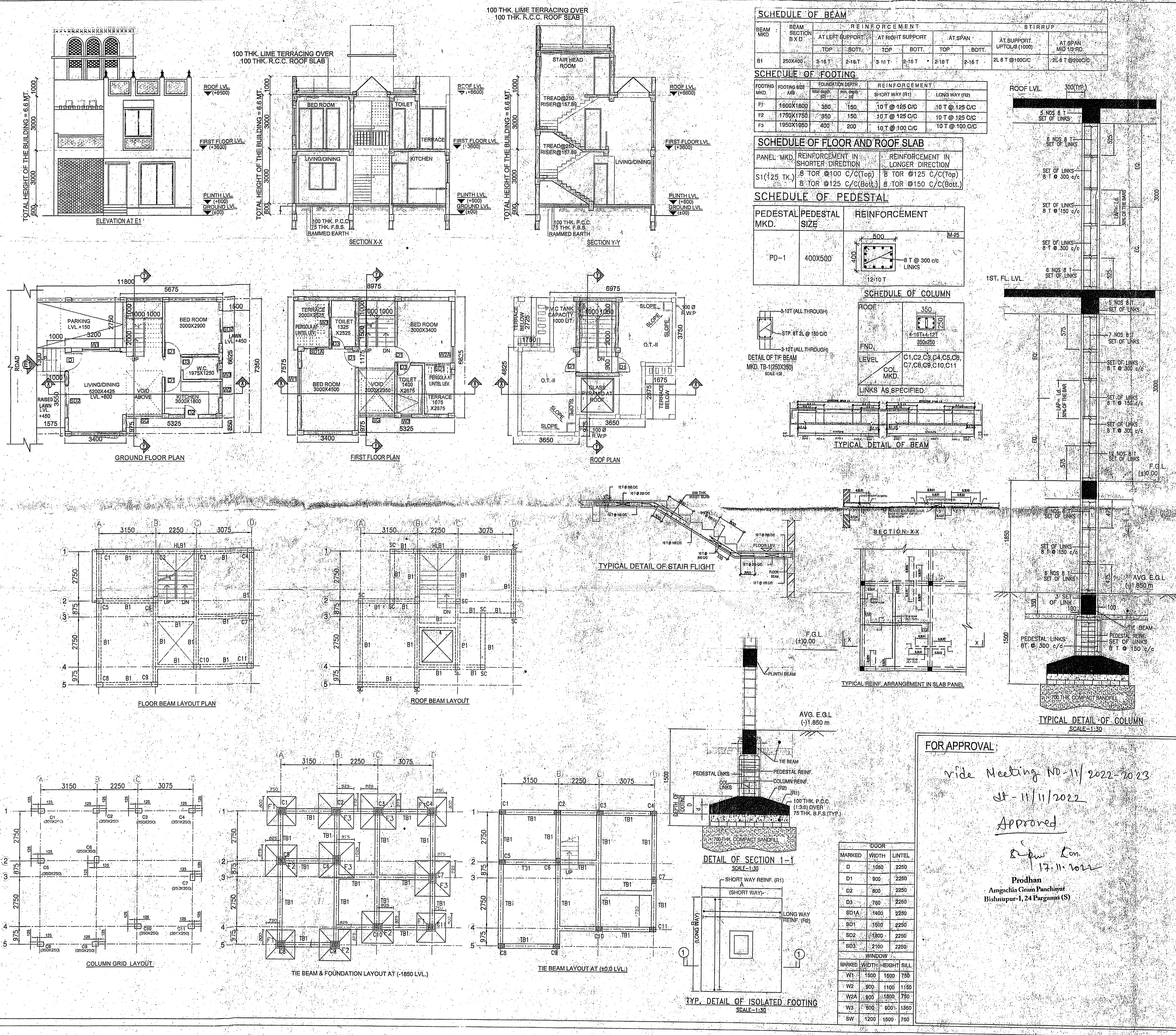

SCHEDULE OF BEAM

BEAM MKD	BEAM SECTION B X D	REINFORCEMENT				STIRRUP	
		AT LEFT SUPPORT	AT RIGHT SUPPORT	AT SPAN	AT SUPPORT	AT SPAN	
B1	250X400	3-16T	2-16T	3-16T	2-16T	2-16T	2L 8T @ 100C/C

SCHEDULE OF FOOTING

FOOTING MKD	FOOTING SIZE	FOUNDATION DEPTH	REINFORCEMENT	
			SHORT WAY (R1)	LONG WAY (R2)
F1	1600X1600	350	10T @ 125 C/C	10T @ 125 C/C
F2	1750X1750	350	10T @ 125 C/C	10T @ 125 C/C
F3	1850X1850	400	10T @ 100 C/C	10T @ 100 C/C

SCHEDULE OF FLOOR AND ROOF SLAB

PANEL MKD	REINFORCEMENT IN SHORTER DIRECTION		REINFORCEMENT IN LONGER DIRECTION	
	TOP	BOTT.	TOP	BOTT.
S1 (125 TK)	8 TOR @ 100 C/C (Top)	8 TOR @ 125 C/C (Top)	8 TOR @ 125 C/C (Top)	8 TOR @ 150 C/C (Bottom)

SCHEDULE OF PEDESTAL

PEDESTAL MKD.	PEDESTAL SIZE	REINFORCEMENT
PD-1	400X500	8 T @ 300 c/c LINKS

SCHEDULE OF COLUMN

LEVEL	COL MKD.	REINFORCEMENT
ROOF	C1, C2, C3, C4, C5, C6, C7, C8, C9, C10, C11	LINKS AS SPECIFIED

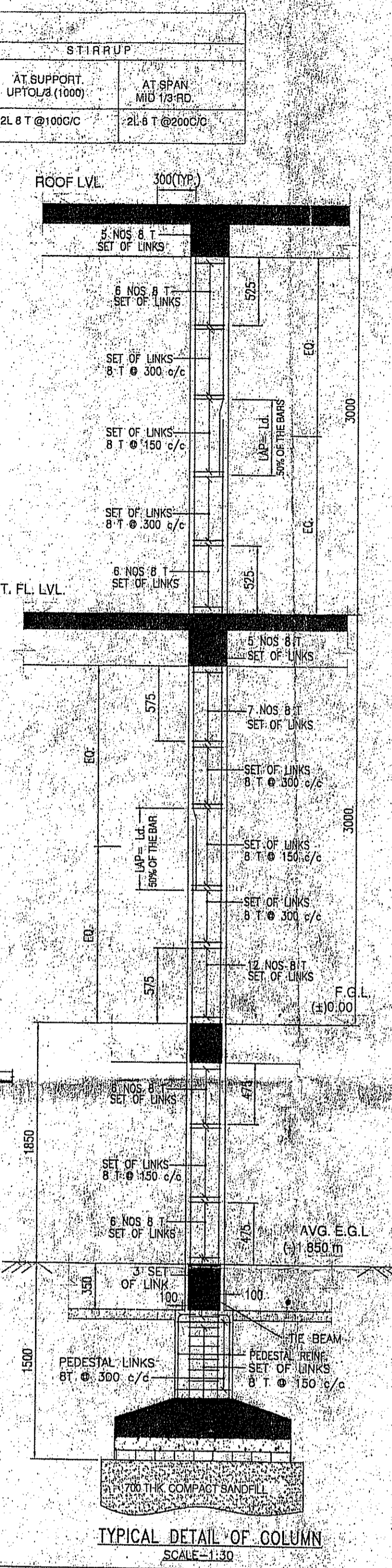

FOR APPROVAL:
vide Meeting NO-11/2022-20/23
dt- 11/11/2022
 Approved
[Signature]
 Pradhan
 Amgachia Gram Panchayat
 Bishnupur-1, 24 Parganas (S)

DOOR

MARKED	WIDTH	LINTEL
D	1200	2250
D1	800	2250
D2	800	2250
D3	750	2250
SD1A	1400	2250
SD1	1500	2250
SD2	1800	2250
SD3	2100	2250

WINDOW

MARKED	WIDTH	HEIGHT	SILL
W1	1800	1600	750
W2	800	1100	1150
W2A	800	1800	750
W3	600	900	1350
SW	1200	1000	750

