



p

No. 038141

BY SPEED POST

## KOLKATA METROPOLITAN DEVELOPMENT AUTHORITY

Housing Sector  
Unnayan Bhawan, 1<sup>st</sup> Floor, DJ – 11, Sector – II,  
Salt Lake, Kolkata – 700091.

No. 2E / OB / CE / ..... 569 / XII - 2020 / 17870

Dated 25/01/2021

Sri / Smt. IMRAN KHAN & MOHAMMAD SHAMIM,  
83/A/H/34, Khudiram Bose Sarani,  
P.O. – Belgachia,  
Kolkata – 700 037.

Re. :- 252, Acharya Prafulla Chandra Road,  
Ward no. – 015,  
Borough No.- II.  
Kolkata – 700 006.

Dear Sir / Madam,

In reply to your letter No. .... NIL ..... dated 14/12/2020.

I have to inform you that the site / building plan submitted with your application has been examined with erstwhile Trust Plan / Records. Accordingly the above property is not affected at present by any published / sanctioned Scheme / Alignment of the erstwhile Trust.

The above observation has to be read with the copy of the site plan which is returned herewith duly endorsed on the reverse. The correctness of the site plan is not verified / certified.

Further, the letter should be treated as invalid or cancelled if any overwriting, erasing or any kind of disfiguration is made either on this letter or on the enclosed site plan.

Yours faithfully,

Chief Engineer, Housing Sector,  
Kolkata Metropolitan Development Authority

Encl. : Copy of endorsed site plan.

No. 2E / OB / CE / / /

Copy Forwarded to :-

D. G. BUILDING, K.M.C.  
5, S. N. Banerjee Road,  
Kolkata – 700013.

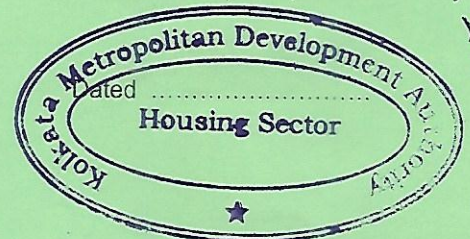

Chief Engineer, Housing Sector,  
Kolkata Metropolitan Development Authority



**SITE PLAN OF PREMISES NO - 252, ACHARYA PRAFULLA CHANDRA ROAD, KOLKATA - 700 006, WARD NO - 015, P.S.- MANIKTALA, BOROUGH - II, UNDER KOLKATA MUNICIPAL CORPORATION, U/S 393A OF BUILDING RULE 2009**

NOTE :- PREMISES NO - 252, ACHARYA PRAFULLA CHANDRA ROAD SHOWN THUS

TOTAL AREA OF LAND - 07 K.-02 CH-41 SFT. = 480.397 SQM.

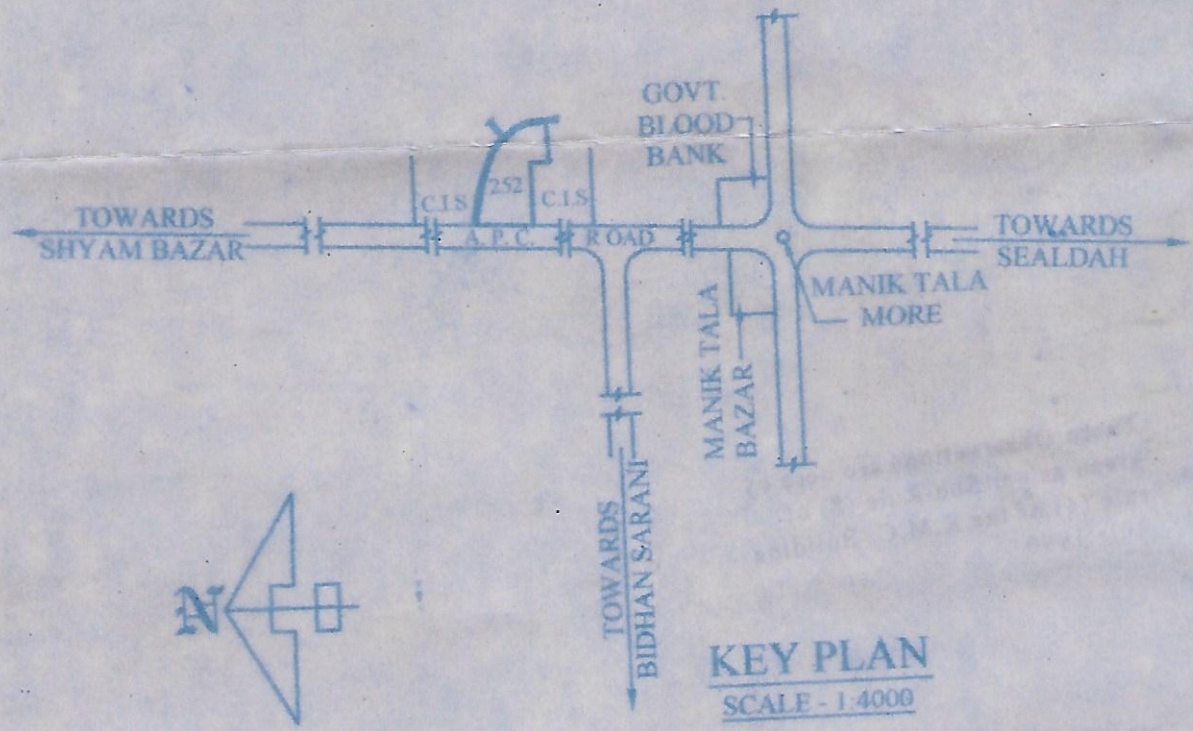

**KEY PLAN**  
SCALE - 1:4000

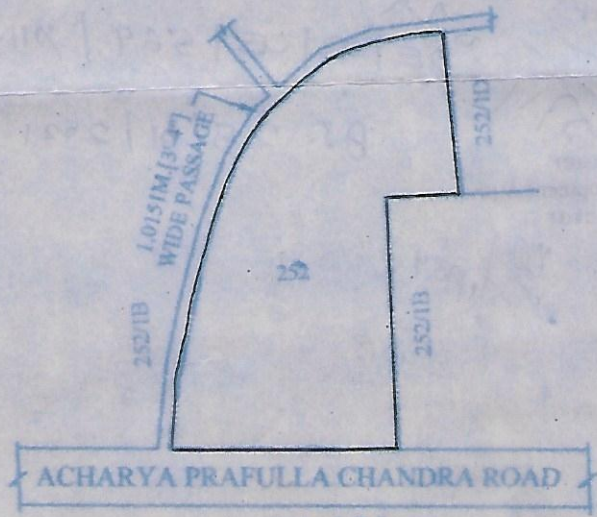

**SITE PLAN**  
SCALE - 1:600

*Mr. Shyam Sundar Khan*  
CONSTITUED ATTORNEY'S OF  
SATYANARAYAN JAISWAL  
ASHA DEVI JAISWAL  
LAKSHMI NARAYAN JAISWAL  
MALA JAISWAL  
JAGDISH NARAYAN JAISWAL  
RAJNI JAISWAL  
SIG. OF OWNER'S CA

*Ashis Chakraborty*  
ASHIS CHAKRABORTY  
CLASS-I L.B.S. OF  
KOLKATA MUNICIPAL CORPORATION  
REGN. NO-1262  
SIG OF LBS





SM  
28/12/2020

**These Observations are here by  
given as per Sub-Rule (8) of  
rule (4) of the K.M.C. Building  
Rule 1990**

This Plan was enclosed with Party's applications. The correctness of the plan is not verified / Certified Enclosure to the Letter

No. 2E, OB No. .... Date .....

Chief Engineer

Kolkata Metropolitan Development Authority  
Housing Sector

*(Handwritten signature)*

2E/13/CE/569/XII-2020/7870

Dt. 25/01/2021