

PARKING AREA DETAILS OF PREMISES NO. 42D, JAINUDDY MISTRY LANE, K.M.C WARD NO.-82, BOROUGH NO.- IX, UNDER K.M.C. P.S. - CHETLA, KOLKATA - 700027.

REQUIRED CAR PARKING = 2 NOS. (FOR RESIDENTIAL).
 = 2 NOS. (FOR BUSINESS). } TOTAL = 4 NOS.

NOS. OF PARKING PROVIDED = COVERED = 6 NOS.

PERMISSIBLE AREA FOR PARKING :-

a) GROUND FLOOR = 100 SQ.M.

b) BASEMENT FLOOR = N.A.

ACTUAL AREA OF PARKING PROVIDED = 138.902 SQ.M.

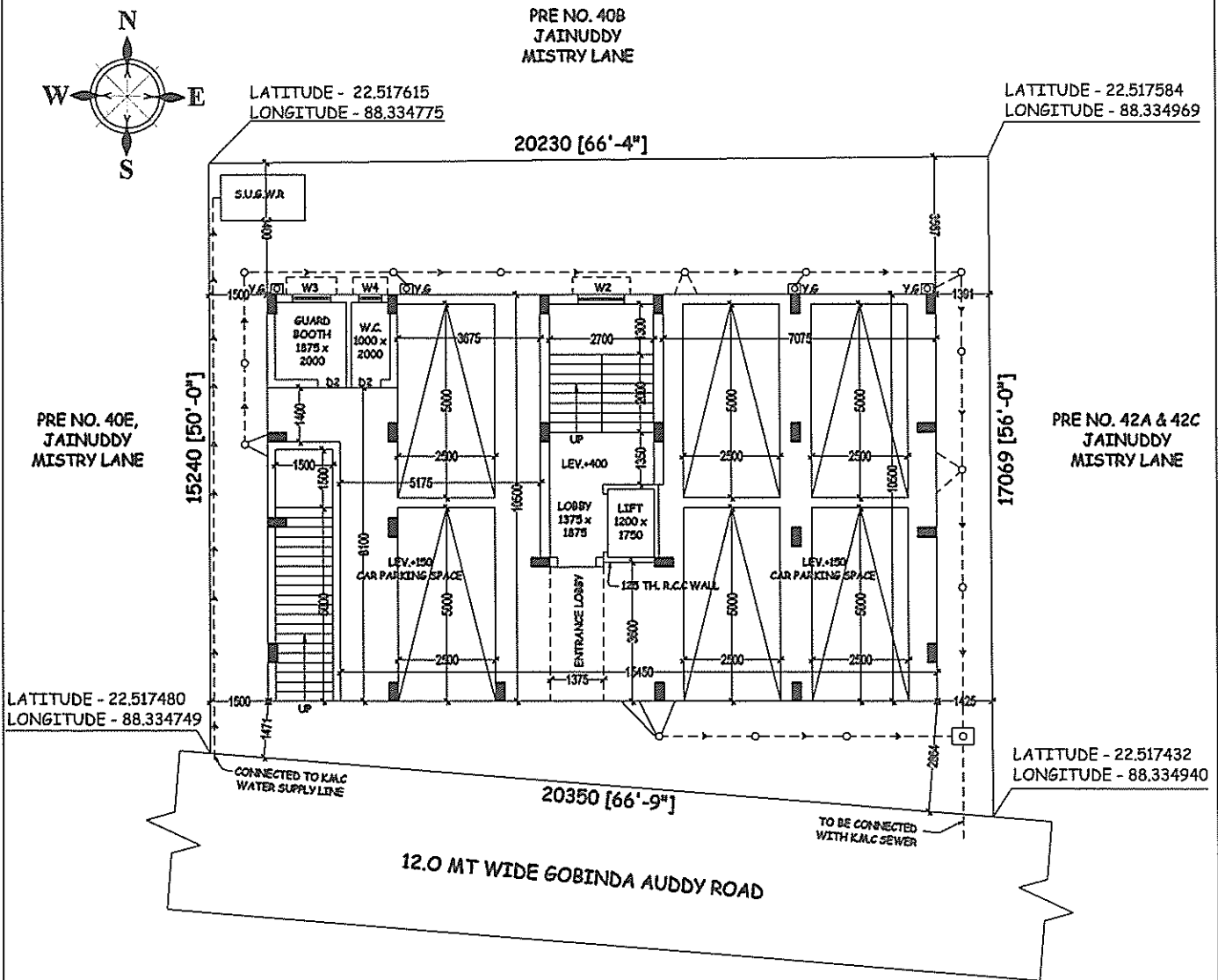

Lokenath Construction

Jaladhar Chatterjee

Proprietor

SIGNATURE OF PROPRIETOR