

MITUL SHUKLA (B.ARCH.)
CA/2004/33251

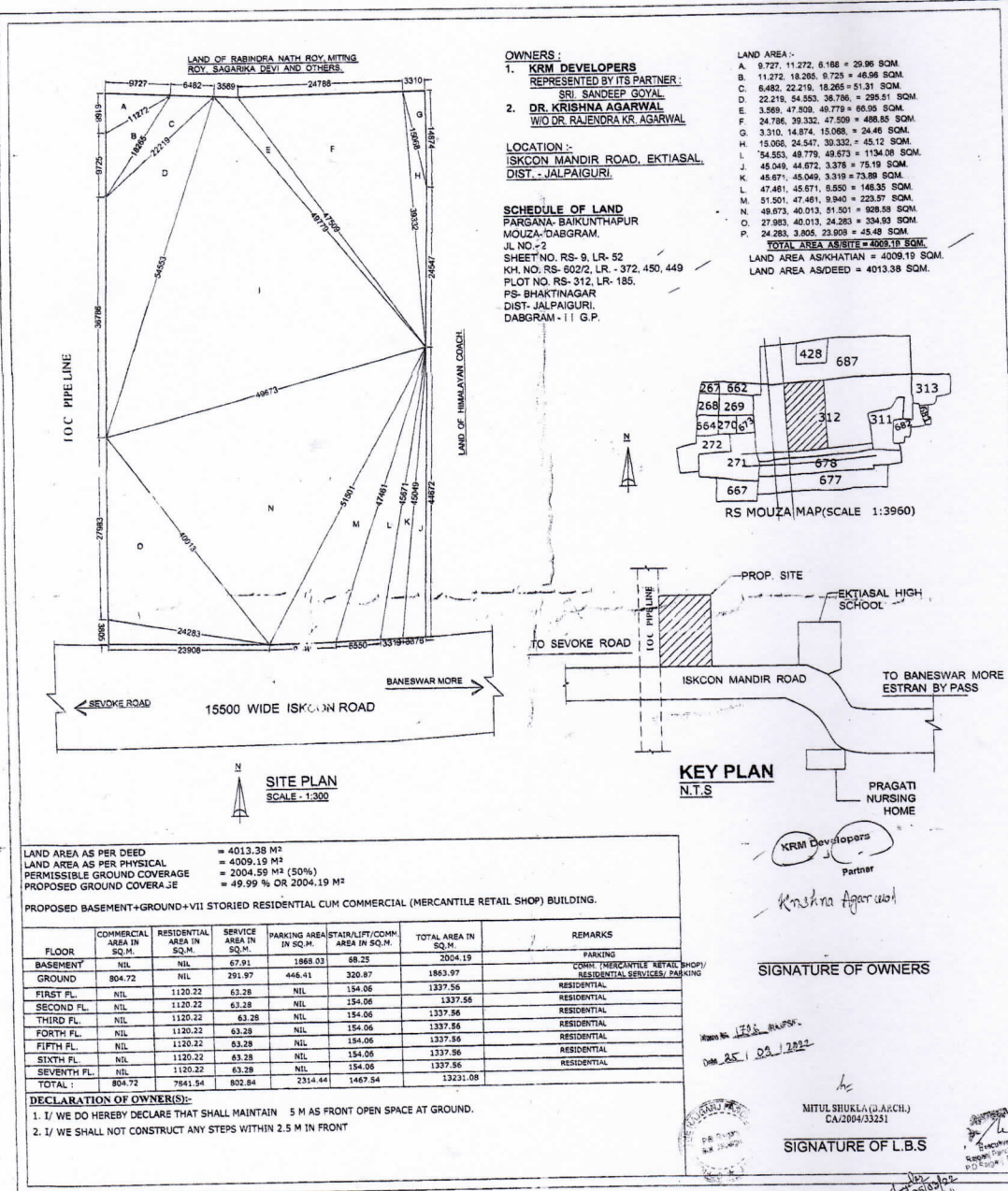

OWNERS :
1. **KRM DEVELOPERS**
REPRESENTED BY ITS PARTNER:
SRI SANDEEP GOYAL
2. **DR. KRISHNA AGARWAL**
W/O DR. RAJENDRA KR. AGARWAL

LOCATION :
ISKCON MANDIR ROAD, EKTIASAL
DIST. - JALPAIGURI

SCHEDULE OF LAND
PARGANA: BAIKUNTHAPUR
MOUZA: DABGRAM
JL NO - 2
SHEET NO. RS - G. LR - 52
KH. NO. RS - 502/2, LR - 372, 450, 449
PLOT NO. RS - 312, LR - 185.
PS - BHAKTINAGAR
DIST - JALPAIGURI,
DABGRAM - II G.P.

LAND AREA -
A. 9,727, 11,272, 8,108 = 29,96 SQM.
B. 11,272, 18,265, 9,725 = 48,96 SQM.
C. 6,482, 22,210, 18,265 = 51,31 SQM.
D. 22,210, 54,553, 38,750 = 205,51 SQM.
E. 3,988, 47,920, 48,779 = 60,95 SQM.
F. 24,786, 39,332, 47,509 = 488,55 SQM.
G. 3,310, 14,874, 15,088 = 24,46 SQM.
H. 15,088, 24,547, 30,332 = 45,12 SQM.
I. 54,553, 48,779, 49,873 = 113,48 SQM.
J. 45,049, 44,872, 3,378 = 75,19 SQM.
K. 48,871, 48,049, 3,319 = 73,89 SQM.
L. 47,481, 45,871, 8,550 = 148,35 SQM.
M. 51,501, 47,481, 8,940 = 223,97 SQM.
N. 49,873, 46,013, 51,501 = 308,58 SQM.
O. 27,983, 40,013, 24,283 = 334,93 SQM.
P. 24,283, 3,808, 23,909 = 45,48 SQM.
TOTAL AREA AS SITE = 4909.19 SQM.
LAND AREA AS KHATAAN = 4009.19 SQM.
LAND AREA AS DEED = 4013.38 SQM.

LAND AREA AS PER DEED = 4013.38 M²
LAND AREA AS PER PHYSICAL = 4009.19 M²
PERMISSIBLE GROUND COVERAGE = 2004.59 M² (50%)
PROPOSED GROUND COVERAGE = 49.99 % OR 2004.19 M²

PROPOSED BASEMENT+GROUND+VII STORED RESIDENTIAL CUM COMMERCIAL (MERCANTILE RETAIL SHOP) BUILDING.

FLOOR	COMMERCIAL AREA IN SQ.M.	RESIDENTIAL AREA IN SQ.M.	SERVICE AREA IN SQ.M.	PARKING AREA IN SQ.M.	STAIR/LIFT/COMM. AREA IN SQ.M.	TOTAL AREA IN SQ.M.	REMARKS
BASEMENT	NIL	NIL	67.91	1868.03	68.25	2004.19	PARKING
GROUND	804.72	NIL	291.97	446.41	320.87	1863.97	CORR. (MERCANTILE RETAIL SHOP) RESIDENTIAL SERVICES/PARKING
FIRST FL.	NIL	1120.22	63.28	NIL	154.06	1337.56	RESIDENTIAL
SECOND FL.	NIL	1120.22	63.28	NIL	154.06	1337.56	RESIDENTIAL
THIRD FL.	NIL	1120.22	63.28	NIL	154.06	1337.56	RESIDENTIAL
FORTH FL.	NIL	1120.22	63.28	NIL	154.06	1337.56	RESIDENTIAL
FIFTH FL.	NIL	1120.22	63.28	NIL	154.06	1337.56	RESIDENTIAL
SIXTH FL.	NIL	1120.22	63.28	NIL	154.06	1337.56	RESIDENTIAL
SEVENTH FL.	NIL	1120.22	63.28	NIL	154.06	1337.56	RESIDENTIAL
TOTAL	804.72	7841.54	802.84	2314.44	1467.54	13231.08	

DECLARATION OF OWNER(S):
1. I/ WE DO HEREBY DECLARE THAT SHALL MAINTAIN 5 M AS FRONT OPEN SPACE AT GROUND.
2. I/ WE SHALL NOT CONSTRUCT ANY STEPS WITHIN 2.5 M IN FRONT

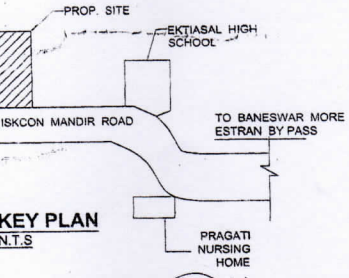
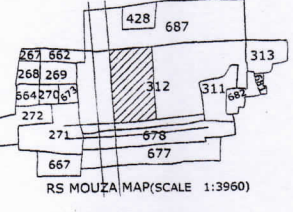

SIGNATURE OF OWNERS
KRM Developers
Partner
Krishna Agarwal

SIGNATURE OF L.B.S
MITUL SHUKLA (B.ARCH.)
CA/2004/33251

Stamp: 28.08.2022
Stamp: 28.08.2022