

AREA STATEMENT OF MODIFIED BUILDINGS

TOWER 14A		TOWER 14B	
GROUND FLOOR	1116.27	GROUND FLOOR	559.55
TYPICAL FLOOR (1ST TO 20TH)	2129.40	TYPICAL FLOOR (1ST TO 20TH)	10675.40
CAR PARKING EXPLOSION	760	CAR PARKING EXPLOSION	360
TOTAL FOR 2 BLOCKS	4296.22	TOTAL FOR 1 BLOCK	10854.95

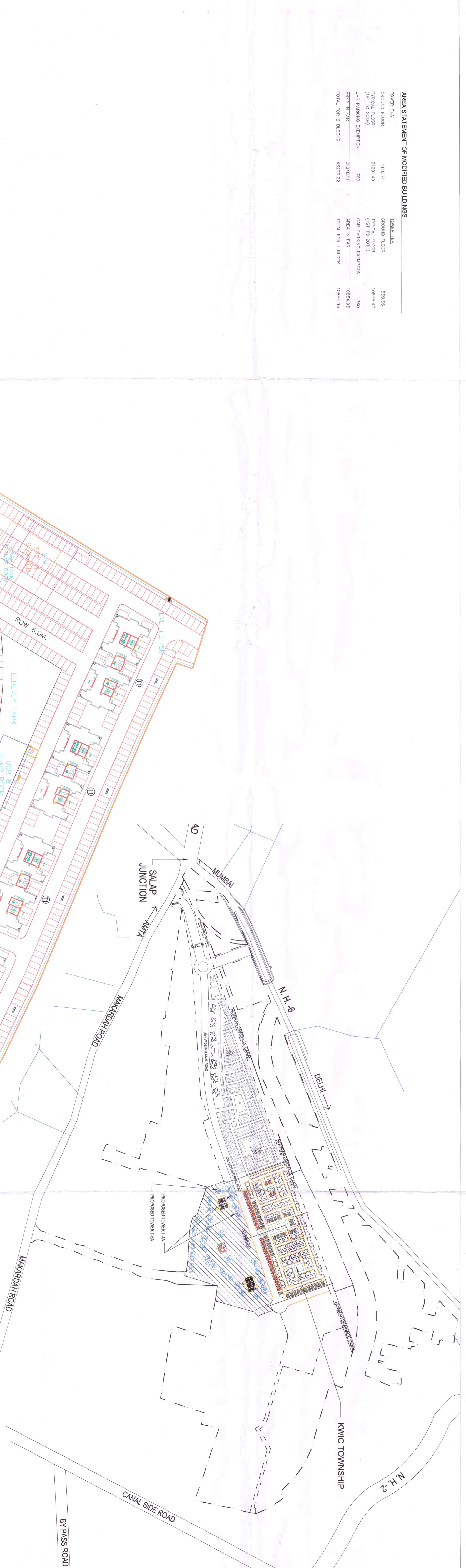

KEY PLAN
SCALE: 1:60000

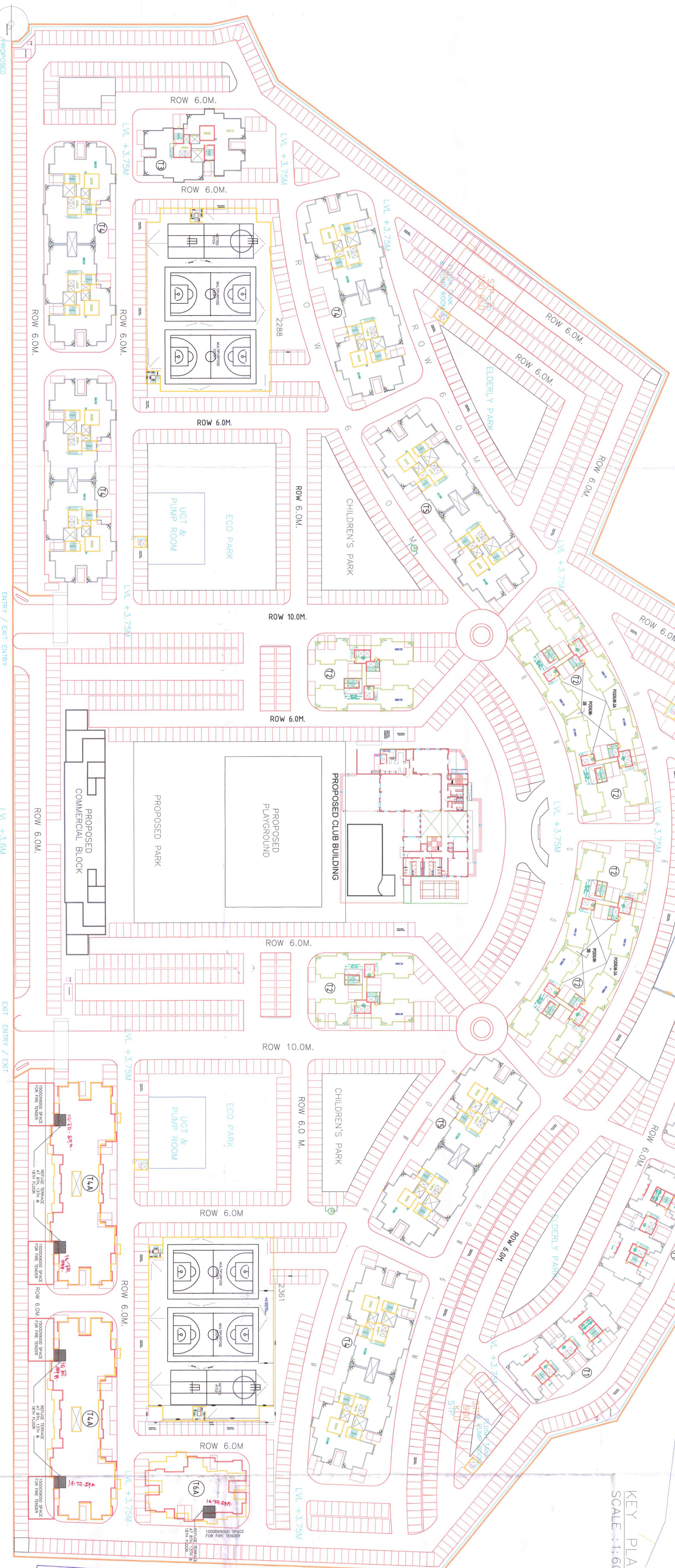

CHECKED BY
T. E. C.

(Signature)
T. E. C.

PROJECT :
PROPOSED G+20 RESIDENTIAL BUILDINGS
TOWERS 14A AND 14B WITHIN PROPOSED
AFFORDABLE HOUSING PROJECT AT PLOT R2B
OF KVIC, HOWRAH

SIGNATURE OF OWNER
(Signature)
Kolkata West International City Pvt. Ltd.
KVIC
Kolkata West International City

SIGNATURE OF STRUCTURAL ENGINEER
(Signature)
SUNIL DATTA CHAKRAVARTY
Registered Architect
Regn No. CHA/2015234

SIGNATURE OF GEO-TECHNICAL ENGINEER
(Signature)
SUNIL DATTA CHAKRAVARTY
Registered Geotechnical Engineer
Regn No. CHA/2015234

SIGNATURE OF ARCHITECT
(Signature)
SUNIL DATTA CHAKRAVARTY
Registered Architect
Regn No. CHA/2015234

CLIENT:
KOLKATA WEST INTERNATIONAL CITY
SALAP MORE, HOWRAH

ARCHITECT:
MSBA SPECTRA
Consultants Pvt. Ltd.
D4-170, 5th Lake, Sector-1, Kolkata-700064
Ph: +91-35-25373008, Fax: +91-35-25211231

CONTENT:
MASTER PLAN (SHOWING 14A & 14B BUILDING),
KEY PLAN

SCALE: 1:600
DATE: 02-02-2019
DEALT:
REVISION:
CHD