

**TERRACE PLAN**

**LEGEND FOR WALLS**

- 200 MM THK NON STRUCTURAL WALL
- 160 MM THK NON STRUCTURAL WALL
- 100 MM THK FULL HEIGHT NON STRUCTURAL WALL
- 100 MM THK & 950 MM HEIGHT NON STRUCTURAL WALL

**LEGEND FOR SUNK**

- 50 MM SUNK FOR TOILETS & BALCONIES
- TILE DROP

**2BHK DOOR & WINDOW SCHEDULE SCHEDULE OF OPENINGS**

DOOR SCHEDULE						
S.NO	TYPE	WIDTH	HEIGHT	CILL LVL	LINTEL HT	REMARKS
1.	D1	1200	2100	+50	+2150	LIVING, MAIN ENTRANCE, ASSOCIATION
2.	D1a	1000	1500	+650	+2150	F.H.C. SHAFT DOOR
3.	D1b	600	1500	+650	+2150	M.V./L.V SHAFT DOOR
4.	D2	900	2100	+50	+2150	BED RM, CHILDRENS & MASTER BED
5.	D2a	900	2100	+50	+2150	BALCONY DOOR
6.	D3	750	2100	+50	+2150	TOILET DOOR
7.	FD	1200	2100	+50	+2150	STAIRCASE, LMR, ELV. RM.
8.	FD1	1200	2100	+50	+2150	TERRACE
9.	FD2	1500	2100	+50	+2150	METER RM

WINDOW SCHEDULE						
S.NO	TYPE	WIDTH	HEIGHT	CILL LVL	LINTEL HT	REMARKS
1.	W1	1500	1200	+950	+2150	LIVING & DINING, STAIRCASE, BEDROOM
2.	W2	1400	1200	+950	+2150	KITCHEN & UTILITY
3.	W3	1200	1200	+950	+2150	MASTER BED, KITCHEN & UTILITY, METER RM
4.	W3a	900	1200	+950	+2150	ASSOCIATION ROOM
5.	W4	600	900	+1250	+2150	BATH, WC

**CHECKED BY T. E. G.**

The Plan is Presently approved subject to the changes as marked and on compliance of recommendation issued.  
 Director-in-Charge  
 Fire prevention wing  
 W.B. Fire & Emergency Services  
 Govt. of West Bengal

**PROJECT :**  
**PROPOSED G+20 RESIDENTIAL BUILDING (TOWERS T4A AND T6A) WITHIN PROPOSED AFFORDABLE HOUSING PROJECT AT PLOT R2B OF KWIC, HOWRAH**

**GENERAL NOTES:**  
 1. ALL DIMENSIONS IN MILLIMETERS AND LEVELS ARE IN METER UNLESS OTHERWISE SPECIFIED.  
 2. ALL DIMENSIONS ARE TO BE CHECKED AND CO-RELATED WITH THE RELEVANT ARCHITECTURAL, STRUCTURAL AND SERVICES DRAWINGS AND ANY AMBIGUITY, DISCREPANCY OR OMISSION SHALL BE BROUGHT IN TO NOTICE OF ARCHITECT.  
 3. DO NOT SCALE THE DRAWING, WRITTEN DIMENSION TO BE FOLLOWED.  
 4. THIS DRAWING TO BE READ IN CONJUNCTION WITH THE RELEVANT SERVICES AND STRUCTURAL DRAWINGS.

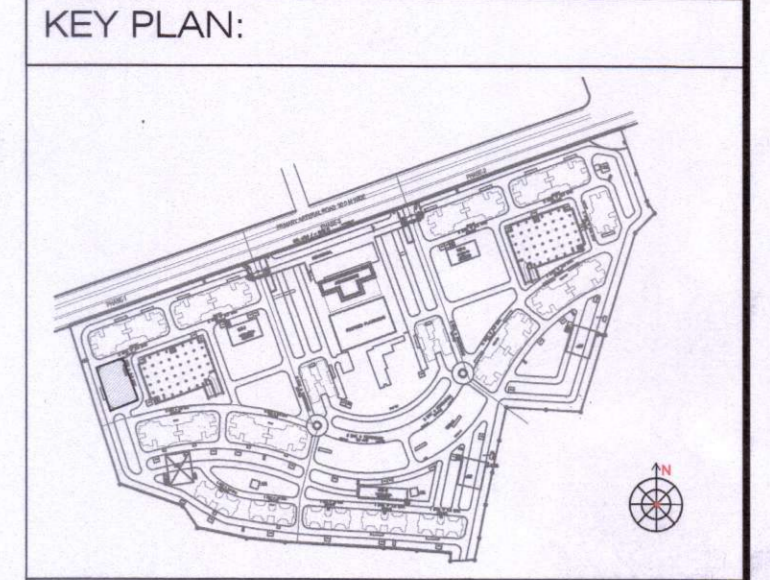

**ABBREVIATIONS**

FFL FINISHED FLOOR LEVEL  
 FGL FINISHED GROUND LEVEL  
 FRL FINISHED ROAD LEVEL  
 FPL FINISHED PAVING LEVEL  
 UFL UNFINISHED LEVEL

**AREA STATEMENT**

TOWER T6A	
GROUND FLOOR	559.55
TYPICAL FLOOR (1ST TO 20TH)	10675.40
CAR PARKING EXEMPTION	380
AREA IN FAR	10854.95
TOTAL FOR 1 BLOCK	10854.95

**DESIGN BUILD**

**SHAPOORJI PALLONJI & CO. PVT. LTD.**  
 DESIGN & BUILD DIVISION  
 Contractor Building, 1st Floor,  
 Ramjibhai Kamani Marg, Ballard Estate  
 Mumbai - 400 038.  
 Tel/Fax: +91-22-66233500/533

THIS DRAWING IS THE PROPERTY OF SHAPOORJI PALLONJI & CO. PVT. LTD. (DESIGN & BUILD) IT SHALL NOT BE COPIED, REPRODUCED OR TRANSFERRED IN ANY MANNER EITHER IN PART OR FULL WHAT SO EVER & SHALL BE USED ONLY FOR THE JOB ISSUED FOR.

**DESIGN ASSOCIATE (ARCH, STR & MEP)**

DESIGN CENTRE  
 SHAPOORJI PALLONJI ENGINEERING & CONSTRUCTION

Kolkata West International City Pvt. Ltd.  
  
 Authorised Signatory

SIGNATURE OF OWNER

THE STRUCTURAL DESIGN & DRAWINGS OF BOTH FOUNDATION & SUPERSTRUCTURE OF THE BUILDING HAS BEEN MADE BY ME CONSIDERING ALL POSSIBLE LOADS INCLUDING THE SEISMIC LOAD AS PER THE NATIONAL BUILDING CODE OF INDIA CERTIFIED THAT IT IS SAFE AND STABLE IN ALL RESPECT.

SIGNATURE OF STRUCTURAL ENGINEER

SIGNATURE OF GEO-TECHNICAL ENGINEER

THE PLOT HAS BEEN INSPECTED BY ME AND ON THAT BASIS I DO CERTIFY WITH FULL RESPONSIBILITY THAT THE PROPOSED BUILDING PLAN HAS BEEN DRAWN AS PER PROVISION OF K.M.D.A. DEVELOPMENT CONTROL REGULATIONS & BUILDING BYE LAWS FOR KOLKATA WEST INTERNATIONAL CITY.

SUTANU BHATTACHARYYA  
 Registered Architect  
 Council of Architecture  
 Regn. No. CA/92/15324

SIGNATURE OF ARCHITECT

**CLIENT:**  
**KOLKATA WEST INTERNATIONAL CITY SALAP MORE, HOWRAH**

**ARCHITECT:**  
  
 SBA SPECTRA  
 Consultants Pvt. Ltd.  
 DA-170, Salt Lake, Sector-1, Kolkata-700064  
 Tel: +91-33-23373008, Fax: +91-33-23211231

**CONTENT :**  
 TOWER T6A  
 TERRACE PLAN

SCALE	1:100	DRG. NO.	SBA/KWC/SANC/T6A/03
DATE	02.02.2019		
DEALT			
CHKD.			

T-6A