

PROJECT :

PROPOSED G+20 RESIDENTIAL BUILDING (TOWERS T4A AND T6A) WITHIN PROPOSED AFFORDABLE HOUSING PROJECT AT PLOT R2B OF KWIC, HOWRAH

GENERAL NOTES:

1. ALL DIMENSIONS IN MILLIMETERS AND LEVELS ARE IN METER UNLESS OTHERWISE SPECIFIED.
2. ALL DIMENSIONS ARE TO BE CHECKED AND CO-RELATED WITH THE RELEVANT ARCHITECTURAL, STRUCTURAL AND SERVICES DRAWINGS AND ANY AMBIGUITY, DISCREPANCY OR OMISSION SHALL BE BROUGHT IN TO NOTICE OF ARCHITECT.
3. DO NOT SCALE THE DRAWING, WRITTEN DIMENSION TO BE FOLLOWED.
4. THIS DRAWING TO BE READ IN CONJUNCTION WITH THE RELEVANT SERVICES AND STRUCTURAL DRAWINGS.

KEY PLAN:

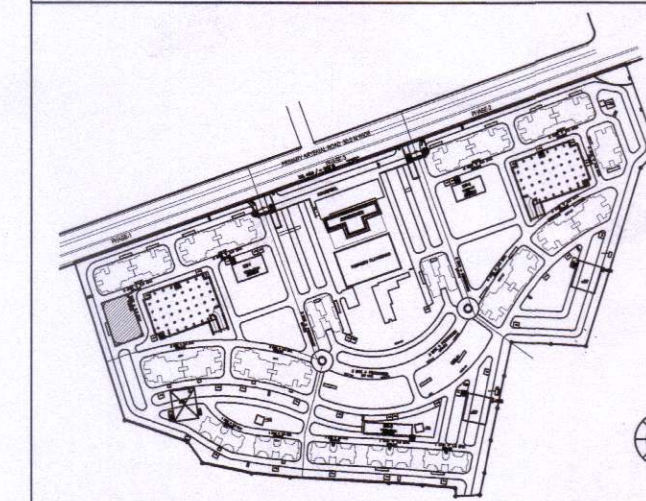

ABBREVIATIONS

- FFL FINISHED FLOOR LEVEL
 FGL FINISHED GROUND LEVEL
 FRL FINISHED ROAD LEVEL
 FPL FINISHED PAVING LEVEL
 UFL UNFINISHED LEVEL

AREA STATEMENT

TOWER T6A	
GROUND FLOOR	559.55
TYPICAL FLOOR (1ST TO 20TH)	10675.40
CAR PARKING EXEMPTION	380
AREA IN FAR	10854.95
TOTAL FOR 1 BLOCK	10854.95

DESIGN BUILD

ENGINEERING & CONSTRUCTION
SHAPOORJI PALLONJI & CO. PVT. LTD.
 DESIGN & BUILD DIVISION
 Contractor Building, 1st Floor,
 Ramjibhai Kamani Marg, Ballard Estate
 Mumbai - 400 038.
 Tel/Fax: +91-22-66233500/533

THIS DRAWING IS THE PROPERTY OF SHAPOORJI PALLONJI & CO. PVT. LTD. (DESIGN & BUILD) IT SHALL NOT BE COPIED, REPRODUCED OR TRANSFERRED IN ANY MANNER EITHER IN PART OR FULL WHAT SO EVER & SHALL BE USED ONLY FOR THE JOB ISSUED FOR.

DESIGN ASSOCIATE (ARCH, STR & MEP)

DESIGN CENTRE
SHAPOORJI PALLONJI ENGINEERING & CONSTRUCTION

Kolkata West International City Pvt. Ltd.

Ramjit
 Authorised Signatory

SIGNATURE OF OWNER
 THE STRUCTURAL DESIGN & DRAWINGS OF BOTH FOUNDATION & SUPERSTRUCTURE OF THE BUILDING HAS BEEN MADE BY ME CONSIDERING ALL POSSIBLE LOADS INCLUDING THE SEISMIC LOAD AS PER THE NATIONAL BUILDING CODE OF INDIA CERTIFIED THAT IT IS SAFE AND STABLE IN ALL RESPECT.

SIGNATURE OF STRUCTURAL ENGINEER

SIGNATURE OF GEO-TECHNICAL ENGINEER
 THE PLOT HAS BEEN INSPECTED BY ME AND ON THAT BASIS I DO CERTIFY WITH FULL RESPONSIBILITY THAT THE PROPOSED BUILDING PLAN HAS BEEN DRAWN AS PER PROVISION OF K.M.D.A. DEVELOPMENT CONTROL REGULATIONS & BUILDING BYE LAWS FOR KOLKATA WEST INTERNATIONAL CITY.

Sutanu Bhattacharyya
 SUTANU BHATTACHARYYA
 Registered Architect
 Council of Architecture
 Regn. No. CA/92/15324

SIGNATURE OF ARCHITECT

CLIENT:
KOLKATA WEST INTERNATIONAL CITY
 SALAP MORE, HOWRAH

ARCHITECT:

SBA SPECTRA
 Consultants Pvt. Ltd.
 DA-170, Sell Lake, Sector-1, Kolkata-700064
 Tel: +91-33-23373008, Fax: +91-33-23211231

CONTENT:
 TOWER T6A
 SECTION - AA

SCALE	1:100	DRG. NO.	SBA/KWC/SANC/T6A/07
DATE	02.02.2019	REVISION	
DEALT			
CHKD.			

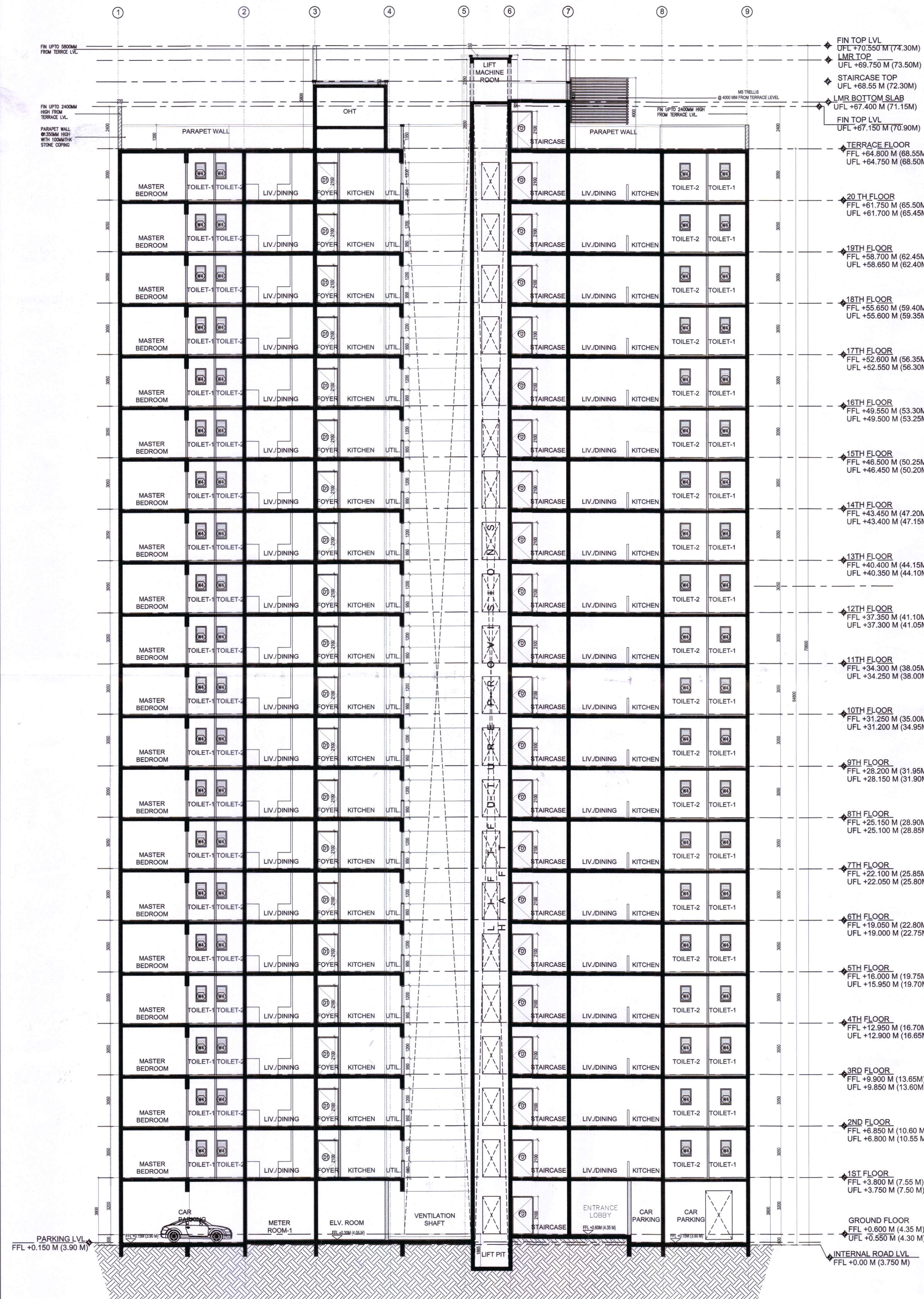

- FIN TOP LVL UFL +70.50 M (74.30M)
- LMR TOP UFL +69.750 M (73.50M)
- STAIRCASE TOP UFL +68.55 M (72.30M)
- LMR BOTTOM SLAB UFL +67.400 M (71.15M)
- FIN TOP LVL UFL +67.150 M (70.90M)
- TERRACE FLOOR FFL +64.800 M (68.55M) UFL +64.750 M (68.50M)
- 20TH FLOOR FFL +61.750 M (65.50M) UFL +61.700 M (65.45M)
- 19TH FLOOR FFL +58.700 M (62.45M) UFL +58.650 M (62.40M)
- 18TH FLOOR FFL +55.650 M (59.40M) UFL +55.600 M (59.35M)
- 17TH FLOOR FFL +52.600 M (56.35M) UFL +52.550 M (56.30M)
- 16TH FLOOR FFL +49.550 M (53.30M) UFL +49.500 M (53.25M)
- 15TH FLOOR FFL +46.500 M (50.25M) UFL +46.450 M (50.20M)
- 14TH FLOOR FFL +43.450 M (47.20M) UFL +43.400 M (47.15M)
- 13TH FLOOR FFL +40.400 M (44.15M) UFL +40.350 M (44.10M)
- 12TH FLOOR FFL +37.350 M (41.10M) UFL +37.300 M (41.05M)
- 11TH FLOOR FFL +34.300 M (38.05M) UFL +34.250 M (38.00M)
- 10TH FLOOR FFL +31.250 M (35.00M) UFL +31.200 M (34.95M)
- 9TH FLOOR FFL +28.200 M (31.95M) UFL +28.150 M (31.90M)
- 8TH FLOOR FFL +25.150 M (28.90M) UFL +25.100 M (28.85M)
- 7TH FLOOR FFL +22.100 M (25.85M) UFL +22.050 M (25.80M)
- 6TH FLOOR FFL +19.050 M (22.80M) UFL +19.000 M (22.75M)
- 5TH FLOOR FFL +16.000 M (19.75M) UFL +15.950 M (19.70M)
- 4TH FLOOR FFL +12.950 M (16.70M) UFL +12.900 M (16.65M)
- 3RD FLOOR FFL +9.900 M (13.65M) UFL +9.850 M (13.60M)
- 2ND FLOOR FFL +6.850 M (10.60M) UFL +6.800 M (10.55M)
- 1ST FLOOR FFL +3.800 M (7.55M) UFL +3.750 M (7.50M)
- GROUND FLOOR FFL +0.800 M (4.35M) UFL +0.850 M (4.30M)
- INTERNAL ROAD LVL FFL +0.00 M (3.750 M)

2BHK DOOR & WINDOW SCHEDULE

SCHEDULE OF OPENINGS

DOOR SCHEDULE						
S.NO	TYPE	WIDTH	HEIGHT	CILL LVL	LINTEL HT	REMARKS
1.	D1	1200	2100	+50	+2150	LIVING, MAIN ENTRANCE, ASSOCIATION
2.	D1a	1000	1500	+650	+2150	F.H.C. SHAFT DOOR
3.	D1b	600	1500	+650	+2150	M.V./LV SHAFT DOOR
4.	D2	900	2100	+50	+2150	BED RM, CHILDRENS & MASTER BED
5.	D2a	900	2100	+50	+2150	BALCONY DOOR
6.	D3	750	2100	+50	+2150	TOILET DOOR
7.	FD	1200	2100	+50	+2150	STAIRCASE, LMR, ELV. RM.
8.	FD1	1200	2100	+50	+2150	TERRACE
9.	FD2	1500	2100	+50	+2150	METER RM

WINDOW SCHEDULE						
S.NO	TYPE	WIDTH	HEIGHT	CILL LVL	LINTEL HT	REMARKS
1.	W1	1500	1200	+950	+2150	LIVING & DINING, STAIRCASE, BEDROOM
2.	W2	1400	1200	+950	+2150	KITCHEN & UTILITY
3.	W3	1200	1200	+950	+2150	MASTER BED, KITCHEN & UTILITY, METER RM.
4.	W3a	900	1200	+950	+2150	ASSOCIATION ROOM
5.	W4	600	900	+1250	+2150	BATH, WC

CHECKED BY
T. E. C.

The Plan is Presently a...
 subject to the changes as...
 and on completion of recom...
 issued.
SM
 Director in Charge
 Fire prevention wing
 W.B. Fire & Emergency Service
 Govt. of West Bengal

A SECTION A-A (2+2.5 BHK TOWER)
 SCALE - 1:125

T-6A