

WATER SUPPLY PLAN

PROPOSED G+IV STORED BUILDING OF 'MAYFAIR PROPERTIES' AT PREMISES NO.:-16-0633, PLOT NO.:- AA-1IB-961, HIG-111 OF ACTION AREA-1IB OF NEW TOWN, KOLKATA.

NAME OF OWNER :-
MR. RAHUL GUPTA
MRS. MINU GUPTA
C/O MAYFAIR PROPERTIES

COMMUNICATION ADDRESS OF SIGNATORY:-
CK-102, SECTOR-41, SALT LAKE, BIDHANNAGAR
KOLKATA-700091

WATER DEMAND CALCULATION

TOTAL WATER REQUIREMENT PER HEAD/CAPITA PER DAY = 120 LITS.
CONSIDERING 6 OCCUPANTS FOR EACH FLAT (There are 8 FLOORS)
AND 2 OCCUPANTS AT GROUND FLOOR (CARETAKERS ROOM + OFFICE).
ANOTHER 4 OCCUPANTS (FLOATING) FOR GROUND FLOOR (SHOP + OFFICE).
(40 Lits. Per Capita For Floating Population)
TOTAL NO. OF PERSON ACCOMMODATED = 48+2 PERSONS + 4 PERSONS (Floating)
SO, TOTAL REQUIREMENT OF WATER = (50 * 120) + (4 * 40) = 6160 LITS.
CONSIDERING O.H. WATER RESERVOIR FILLED UP TWICE DAILY:
CAPACITY OF O.H.T. RESERVOIR REQUIRED = 3080 LITS
CAPACITY OF U.G. RESERVOIR REQUIRED = 6160 LITS.
CAPACITY OF O.H. RESERVOIR PROVIDED = 3197 LITS (OK)
CAPACITY OF SEMI U.G. RESERVOIR PROVIDED = 6291 LITS (OK)
CAPACITY OF RAIN WATER HARVESTING TANK (REQUIRED) = 4000 LITS.
CAPACITY OF RAIN WATER HARVESTING TANK (PROVIDE) = 4112 LITS.

CERTIFICATE OF THE ARCHITECT :-

I CERTIFY THAT ALL THE ARCHITECTURAL DRAWINGS OF THE PROJECT AT PREMISES NO. 16-0633 HAVE BEEN PREPARED BY ME COMPLYING WITH THE NEW TOWN KOLKATA BUILDING RULES, 2009. I ALSO CERTIFY THAT THE PLANS AND DRAWINGS PREPARED BY ME COMPLY WITH ALL PROVISIONS REGARDING THE FIRE PROTECTION AS PER THE PREVAILING NATIONAL BUILDING CODE. I SHALL BE HELD RESPONSIBLE IF ANY INCORRECT INFORMATION IS FURNISHED BY ME OR ANY VIOLATION OF PROVISIONS OF THESE RULES OR THE PREVAILING NATIONAL BUILDING CODE IS FOUND IN ANY OF THE DRAWINGS AND DOCUMENTS, SIGNED BY ME AND SUBMITTED TO THE SANCTIONING AUTHORITY FOR OBTAINING SANCTION.

SUBHADIP BOY
NAME OF ARCHITECT
ENROLLMENT NO.:- ARCH-HIDCO/09/00019

CERTIFICATE OF THE STRUCTURAL ENGINEER/CIVIL ENGINEER:-

CERTIFIED THAT THE STRUCTURAL DRAWING & DESIGN OF BOTH THE FOUNDATION AND SUPERSTRUCTURE OF THE BUILDING HAS BEEN MADE CONSIDERING THE SOIL TEST REPORT, AS PER THE RULES & REGULATIONS MADE UNDER THE ACT AND ALSO CONSIDERING ALL POSSIBLE LOADS, SEISMIC LOAD & THE MOMENTS GENERATED BY THE PROPOSED STRUCTURE AS PER THE BUREAU OF INDIAN STANDARD & NATIONAL BUILDING CODE OF INDIA & CERTIFIED THAT IT IS SAFE AND STABLE IN ALL RESPECT AND THESE PROVISIONS SHALL BE ADHERED TO DURING THE CONSTRUCTION.

UMESH MISHRA
NAME OF CIVIL ENGINEER
ENROLLMENT NO.:- CVER-HIDCO/09/00018

DESIGNED BY :-

M M C S (P) LTD.
FD - 396, SECTOR - III,
SALT LAKE CITY, KOLKATA - 700 106.
PH:- 4004 5307.
e-mail: umes_mmsc_2006@yahoo.co.in

DRG. NO.:- MMCS/RJ/A - 1IB-961/RS/WATER SUPPLY/21-22

SCALE:- 1:100, 1:50

DRAWN BY: GAYATRI BISWAS

DATE: 08-07-2021

PRE. NO. - 16-0633

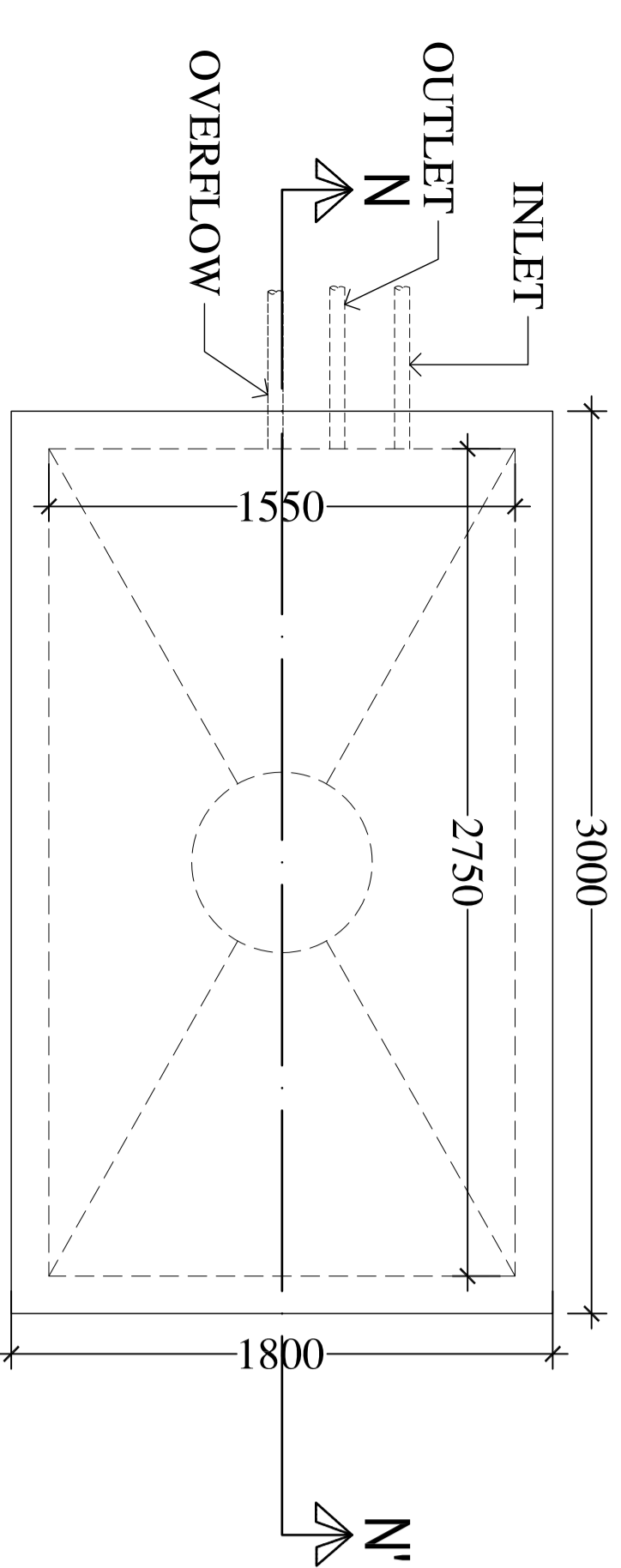
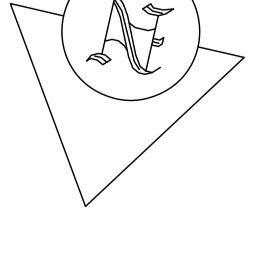

OVER HEAD WATER TANK
2750X1550X750
(CAP:-3197 LITS.)
SCALE:-1:50

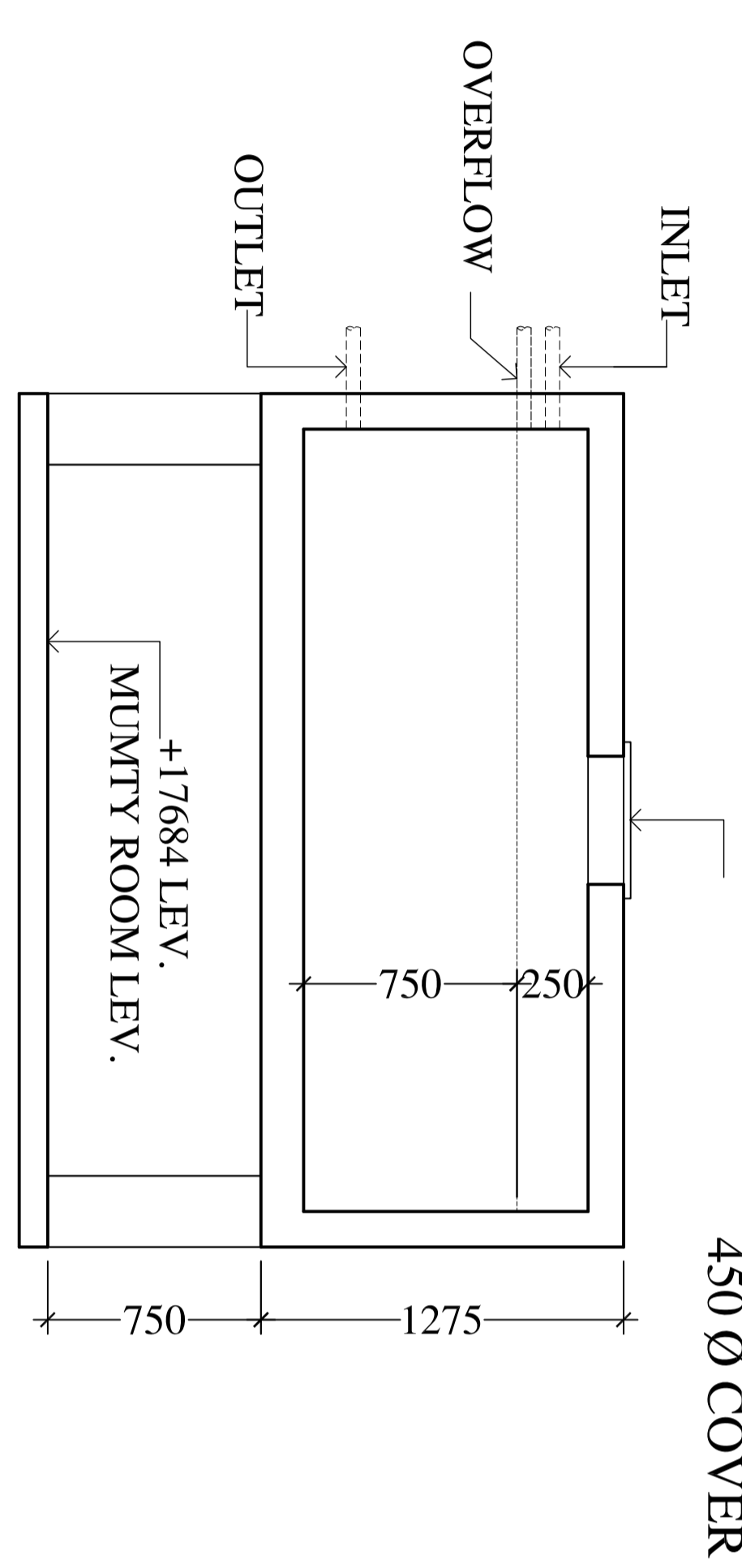

SECTION OF O.H.W.R.
THROUGH AT 'N-N'
SCALE:-1:50

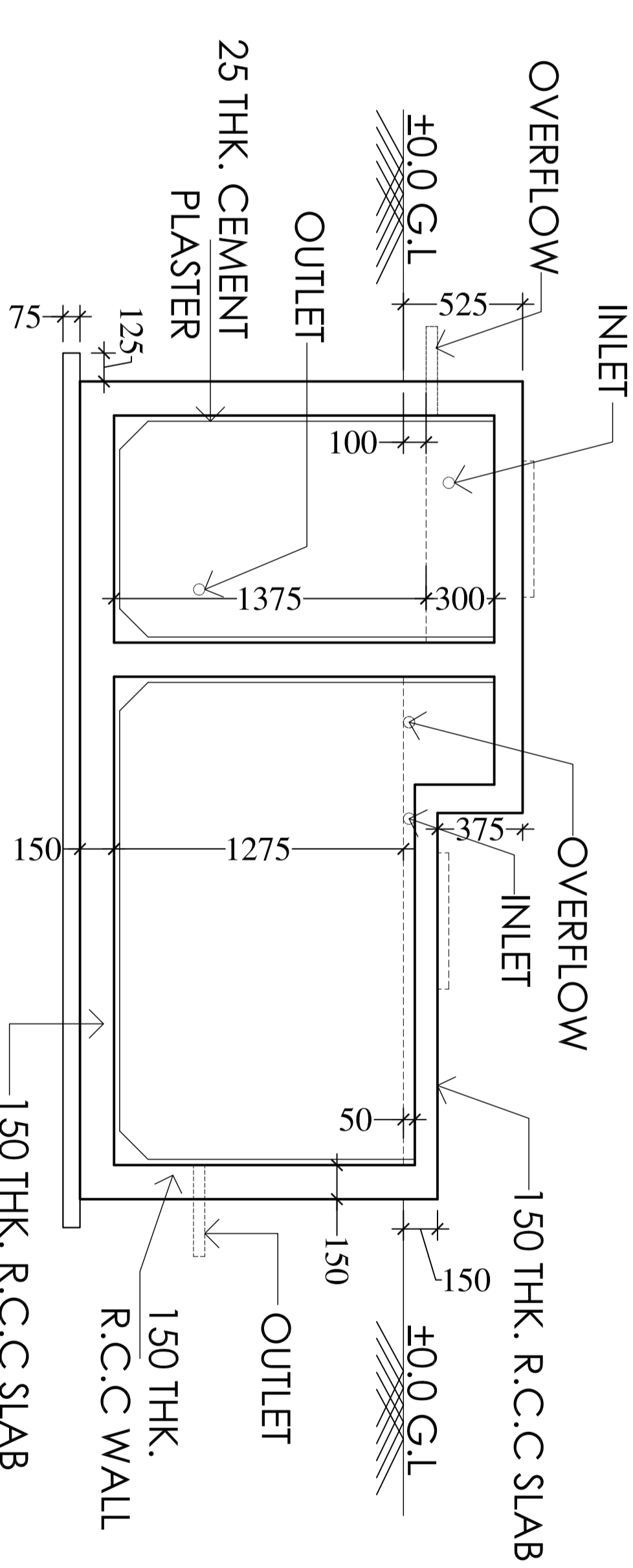

SECTION OF SEMI U.G. W.R.
THROUGH AT 'M-M'
SCALE:-1:50

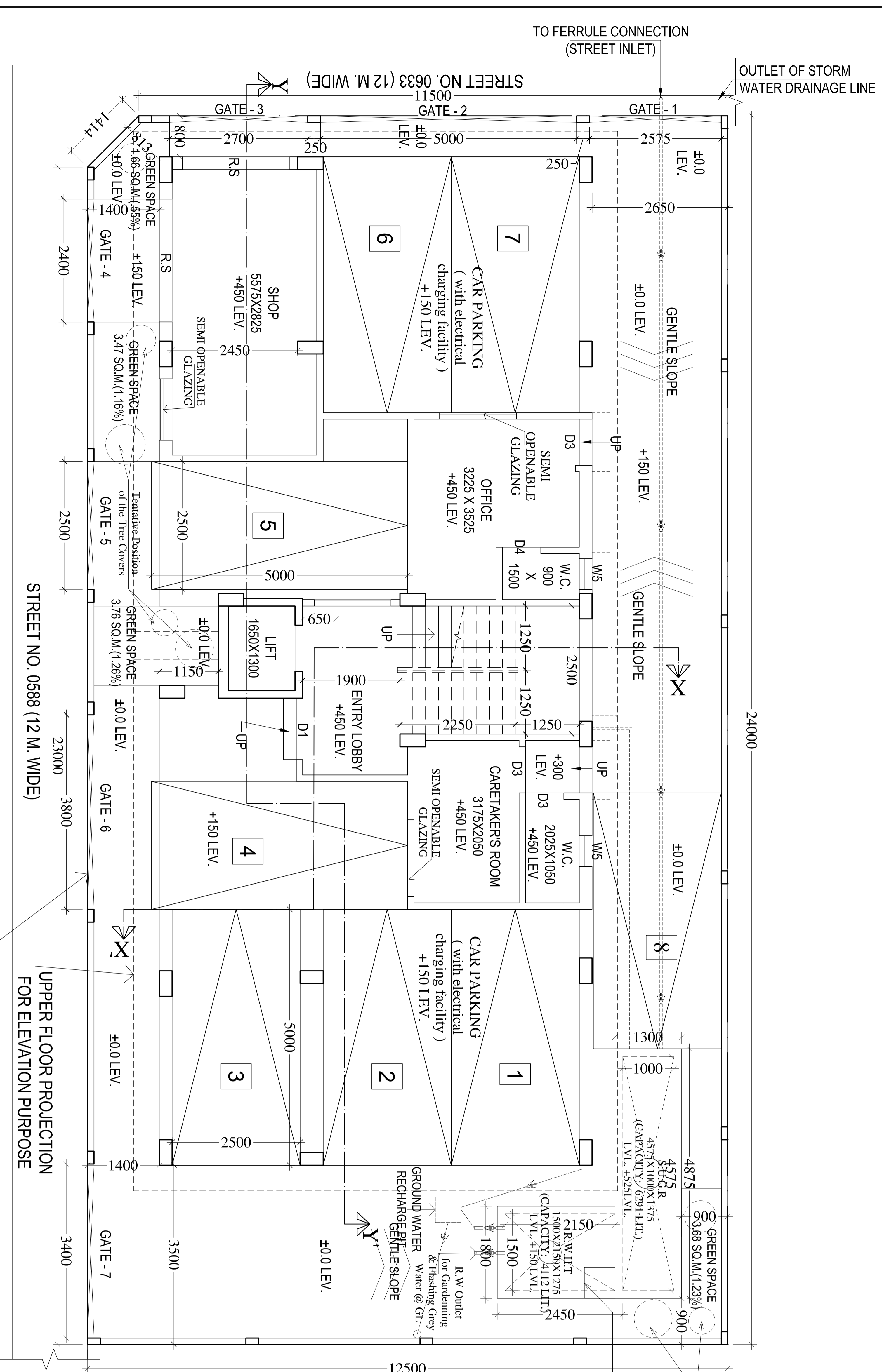

GROUND FLOOR PLAN
SCALE - 1:100

FRONT SIDE OF PLOT
UPPER FLOOR PROJECTION
FOR ELEVATION PURPOSE

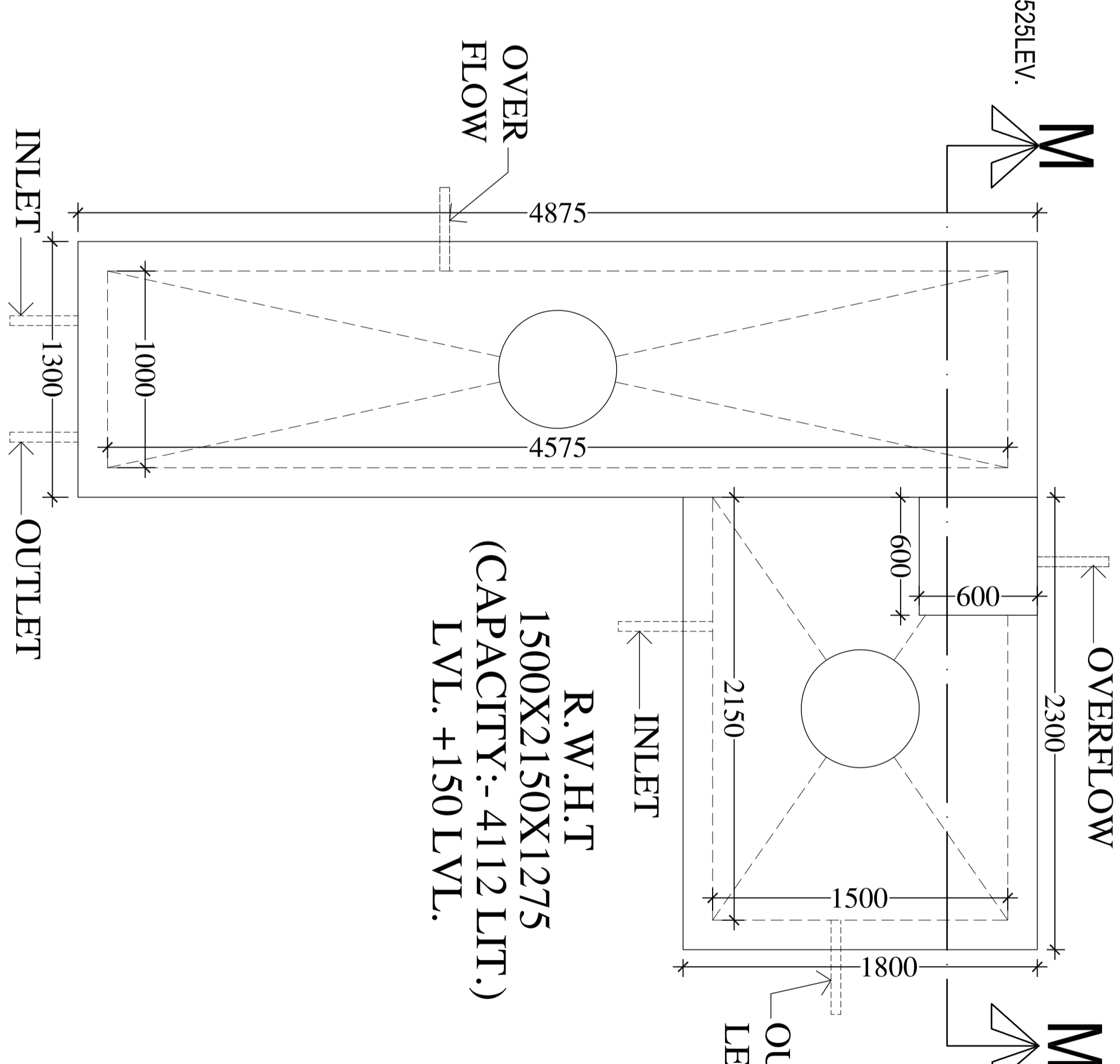

PLAN OF SEMI U.G. W.R.
(1000X4575X1375)
CAPACITY = 6291 LITS.
LVL. 525 LVL.
SCALE:-1:50