

PS Group Realty Pvt. Ltd.  
 Rain Chakraborty

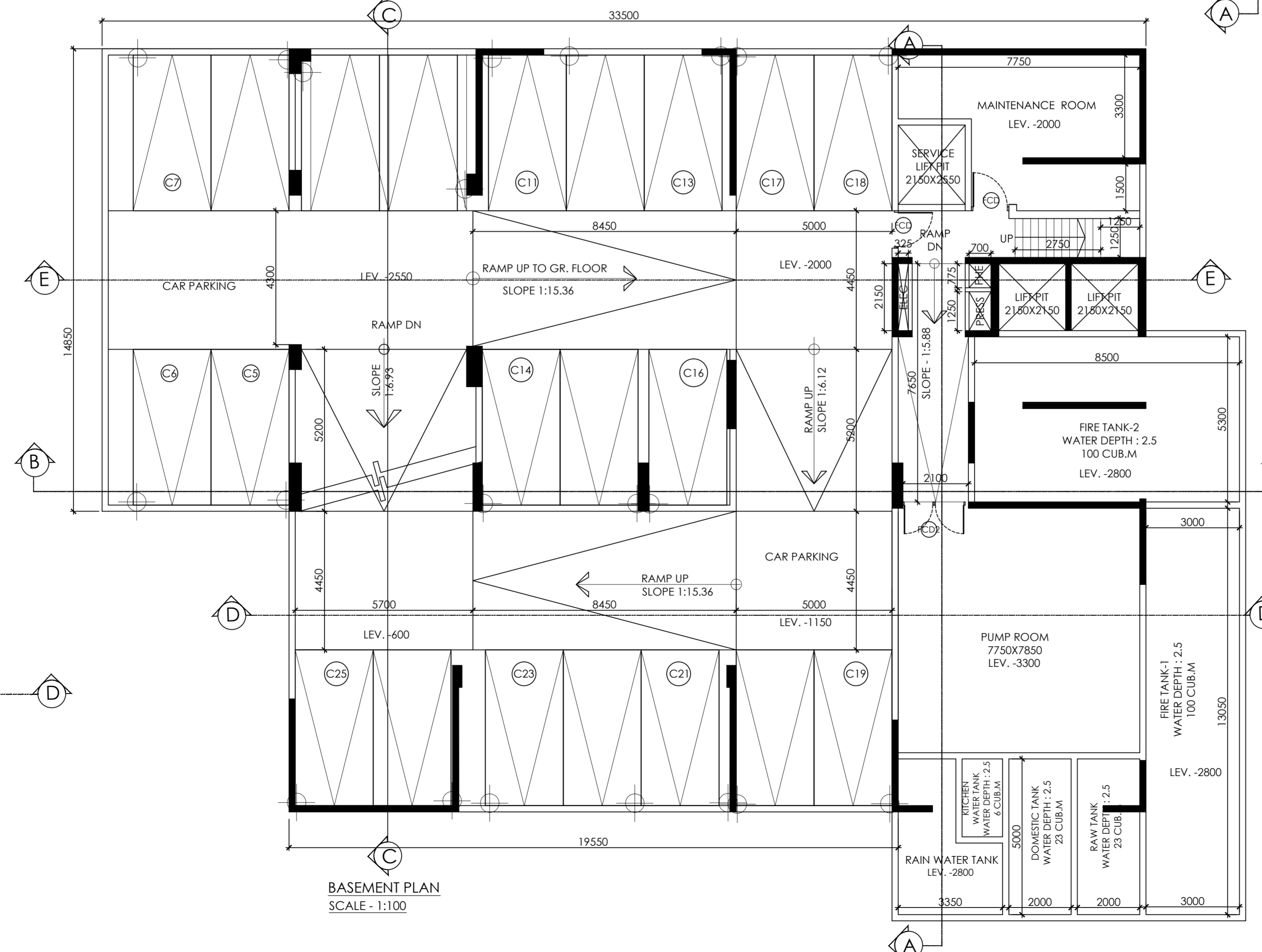
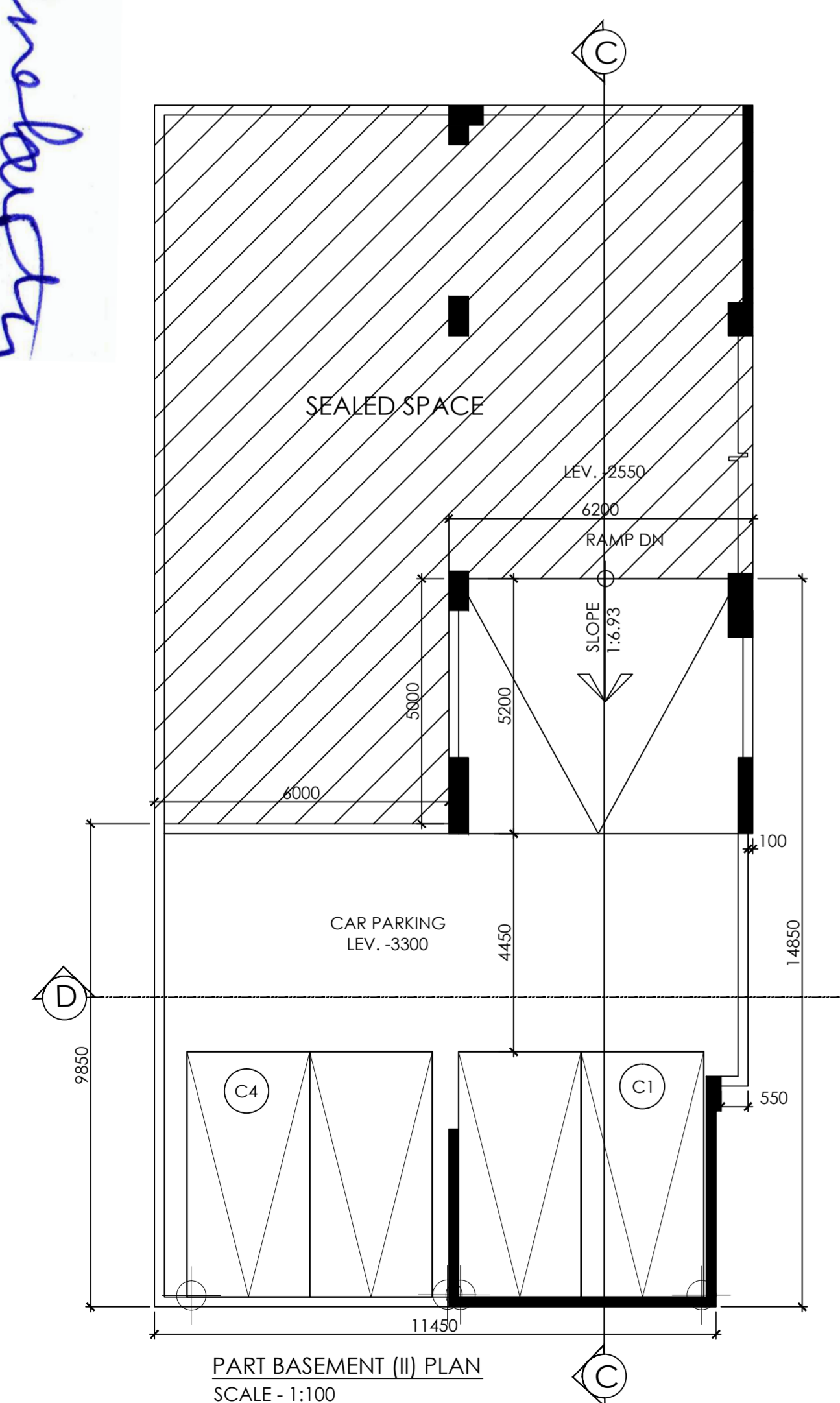
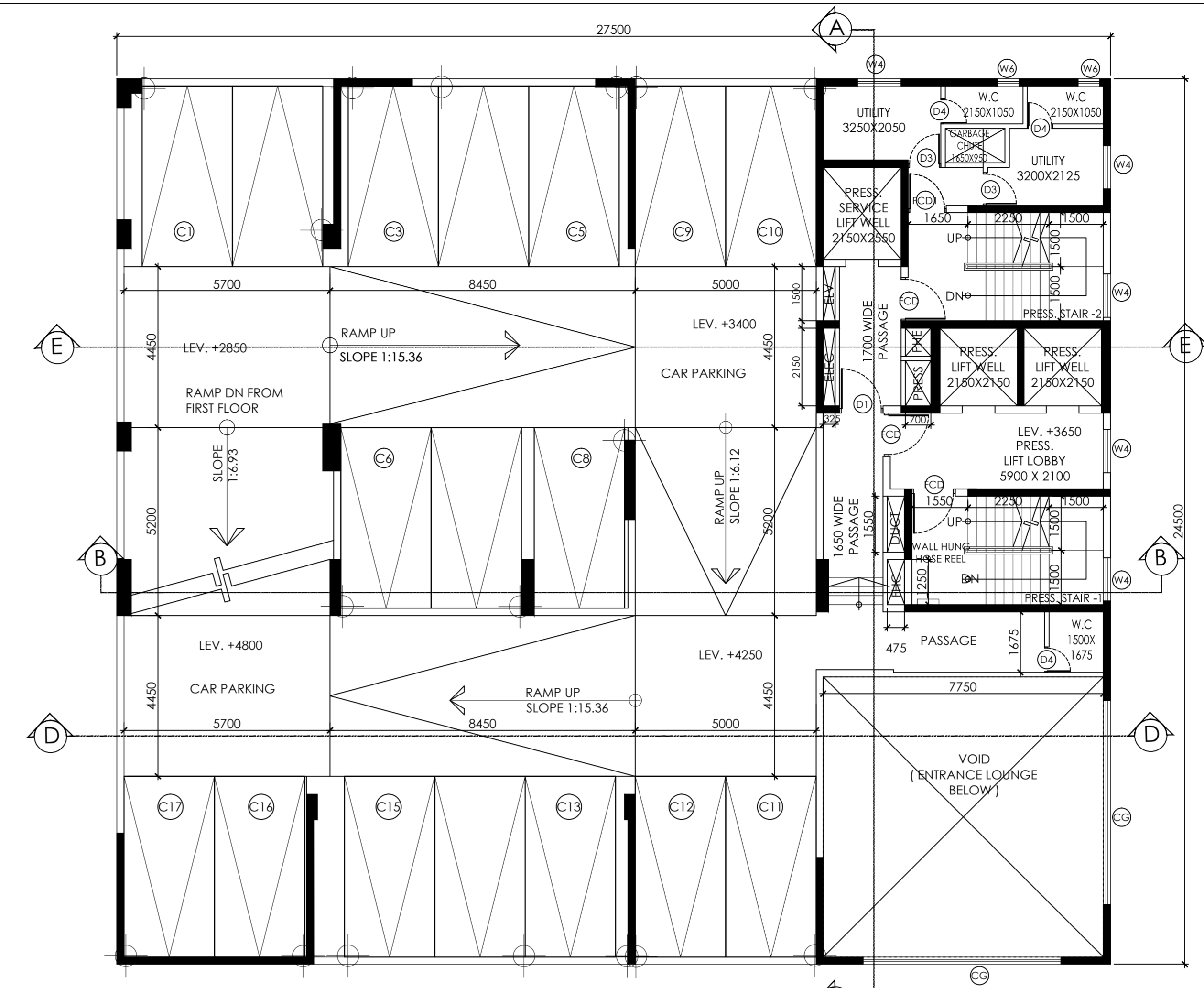

PLAN CASE NO. - 2021080051

100% OF COVERED PARKING SPACE WILL HAVE ELECTRICAL VEHICLE RECHARGING PROVISION

DOOR/WINDOW SCHEDULE			
NO.	SIZE (mm)	SILL	UNTEL.
D1	1200x2450	-	2450
D2	1050x2450	-	2450
D3	900x2450	-	2450
D4	850x2450	-	2450
FCD	1200x2450	-	2450
FCD1	1050x2450	-	2450
FC02	2000x2450	-	2450
SD	7950x2850	-	BEAM BOTTOM
SD1	5000x2850	-	BEAM BOTTOM
SD2	4500x2700	-	BEAM BOTTOM
SD3	3850x2850	-	BEAM BOTTOM
SD4	3000x2850	-	BEAM BOTTOM
SD5	2550x2850	-	BEAM BOTTOM
SD6	1775x2700	-	BEAM BOTTOM
SD7	1500x2700	-	BEAM BOTTOM
SFD	5200x2450	-	BEAM BOTTOM
W	3000x2550	150	BEAM BOTTOM
Wa	3000x2700	150	BEAM BOTTOM
W1	2700x2550	150	BEAM BOTTOM
W1a	2700x2700	150	BEAM BOTTOM
W2	2400x2550	150	BEAM BOTTOM
W3	2100x2550	150	BEAM BOTTOM
W4	1200x2550	150	BEAM BOTTOM
W4a	1200x2700	150	BEAM BOTTOM
W4b	1200x2300	150	BEAM BOTTOM
W5	1200x1650	1050	BEAM BOTTOM
W6	600x1450	1250	BEAM BOTTOM
W6a	600x2700	150	BEAM BOTTOM
W7	750x2700	150	BEAM BOTTOM
W7a	750x1350	1500	BEAM BOTTOM
W8	900x2300	150	BEAM BOTTOM
C.G	AS PER ELEVATION	150	BEAM BOTTOM

**NOTES:**

- ALL DIMENSIONS ARE IN MM.
- ONLY WRITTEN DIMENSIONS ARE TO BE FOLLOWED.
- ALL EXTERNAL WALLS ARE 200mm THICK WALL AND INTERNAL WALLS ARE 100mm THICK.
- ALL ELECTRICAL ROOMS HAVE 2 HRS RATING WALL.
- FIRE REFUGE AREA NOT LESS THAN 15 SQM WITH FCD AT ENTRANCE.
- SPRINKLER SHALL BE PROVIDED.

**DECLARATION OF OWNER**

I DO HEREBY UNDERTAKE WITH FULL RESPONSIBILITY THAT

- I SHALL ENGAGE ARCHITECT & E.S.E. DURING CONSTRUCTION.
- I SHALL FOLLOW THE INSTRUCTION OF ARCHITECT & E.S.E. DURING CONSTRUCTION OF THE BUILDING (AS PER B.S. PLAN).
- K.M.C. AUTHORITY WILL NOT BE RESPONSIBLE FOR STRUCTURE STABILITY OF THE BUILDING AND ADJOINING STRUCTURE.
- IF ANY SUBMITTED DOCUMENTS ARE FOUND TO BE FAKE, THE K.M.C. AUTHORITY WILL REVOKE THE SANCTION PLAN.
- THE CONSTRUCTION OF WATER RESERVOIR AND SEPTIC TANK WILL BE UNDER THE GUIDANCE OF L.B.A./E.S.E. BEFORE STARTING OF BUILDING FOUNDATION WORK.
- DURING INSPECTION SITE WAS IDENTIFIED BY US.

**CERTIFICATE OF GEO-TECHNICAL ENGINEER.**

UNDERSIGNED HAS INSPECTED THE SITE AND CARRIED OUT SOIL INVESTIGATION THEREON. IT IS CERTIFIED THAT THE EXISTING SOIL OF THE SITE IS ABLE TO CARRY THE LOAD COMING FROM THE PROPOSED CONSTRUCTION AND THE FOUNDATION SYSTEM PROPOSED HEREIN IS SAFE & STABLE IN ALL RESPECT FROM GEO-TECHNICAL POINT OF VIEW.

**CERTIFICATE OF STRUCTURAL ENGINEER.**

CERTIFY THAT THE STRUCTURAL DRAWING AND DESIGN OF BOTH THE FOUNDATION AND SUPER STRUCTURE OF THE BUILDING HAS BEEN MADE BY ME CONSIDERING THE SOIL TEST REPORT (AS PER THESE RULES AND THE REGULATIONS MADE UNDER THE ACT) AND ALSO CONSIDERING ALL POSSIBLE LOADS, SEISMIC LOAD AND THE MOMENTS GENERATED BY THE PROPOSED STRUCTURE AS PER THE BUREAU OF INDIAN STANDARD AND NATIONAL BUILDING CODE OF INDIA AND CERTIFIED THAT IT IS SAFE AND STABLE IN ALL RESPECT AND THESE PROVISIONS SHALL BE ADHERED TO DURING THE CONSTRUCTION.

**NAME OF OWNER**  
 NAME : PRATIT CHAKRABORTY  
 CONSTITUTED ATTORNEY FOR  
 M/S. PADRONE MARKETING (P) LTD.  
 SRI RATAN LAL GAGGAR  
 SMT BHAGWATI DEVI GAGGAR  
 SMT RAJSHREE GAGGAR

**NAME OF GEO-TECHNICAL ENGINEER**  
 NAME : SUJIT KUMAR BOSE  
 NO : GT/1/12

**NAME OF STRUCTURAL ENGINEER REVIEWER**  
 NAME : UTPAL SANTRA  
 NO : ESR/1/58

**NAME OF ARCHITECT**  
 NAME : JUI MALLIK  
 NO : CA/98/23840

**ARCHITECT:**  
**ABIN DESIGN STUDIO**  
 ARCHITECTURE | INTERIOR | EXHIBITION | PRODUCT DESIGN | GRAPHICS  
 42/2, HINDUSTAN PARK, GARIAHAT, KOLKATA 700029, INDIA  
 E-MAIL: contact@abindesignstudio.com

**PROJECT:**  
 PROPOSED B+G+XXIII STORIED RESIDENTIAL BUILDING ( BLOCK 1 , 80.0 M. HEIGHT), & III STORIED CLUB BUILDING ( BLOCK - 2, 12.45 M. HEIGHT ) AT PREMISES NO. 11, SARAT BOSE ROAD, WARD NO - 70, BOROUGH NO - VIII, KOLKATA - 700020. WITHIN THE KOLKATA MUNICIPAL CORPORATION. U/S 393 A OF KMC BUILDING RULES 2009, READ ALONG WITH RULE 69 A (1) (3) OF KMC BUILDING RULES 2009.

**TITLE:**  
 PART BASEMENT PLAN, BASEMENT PLAN, FIRST FLOOR PLAN & PART SECTION AT CC (BLOCK - 1)

**DATE:** 22.06.22 **DRAWING NO.:** SBR/BLOCK1/A02

**SCALE:** 1:100

**DRAWN BY:** S.G **CHKD. BY:** C.P

THIS DRAWING IS THE SOLE PROPERTY OF ABIN DESIGN STUDIO AND IS NOT TO BE USED, COPIED OR CIRCULATED IN ANY MANNER OTHER THAN THE PURPOSE FOR WHICH IT IS ISSUED WITHOUT THEIR WRITTEN PERMISSION

**BUILDING PERMIT NO: 2022080096**  
**DATE: 29-10-2022** **VALID UP TO: 28-10-2027**

**SIGNATURE OF A.E.(C.)** BLDG. / BR-VIII **SIGNATURE OF E.E.(C.)** BLDG. / BR-VIII