

SCHEDULE OF DOORS & WINDOWS					
TYPE	SILL	LINTEL	SIZE	TYPE	SIZE
D	-	2150	1500x2150	W1	900 2150
D1	-	2150	1100x2150	W2	450 2150
D2	-	2150	900x2150	W3	450 2150
D3	-	2150	1000x2150	W4	450 2150
D4	-	2150	750x2150	W5	1050 2150
D5	-	2150	1800x2150	W6	900 2150
F.C.D.	-	2150	1100x2150	Y	1250 2150

UNDERTAKING

I AM UNDERTAKING THAT WHEN THE SEWER LINE WILL BE AVAILABLE AT THE SITE, I SHALL TAKE CONNECTION AT MY OWN COST.

- I WILL ENGAGE ARCHITECT AND E.S.E DURING CONSTRUCTION.
- I WILL FOLLOW THE INSTRUCTIONS OF ARCHITECT AND E.S.E DURING CONSTRUCTION OF THE BUILDING.
- H.M.C AUTHORITY WILL NOT BE RESPONSIBLE FOR STRUCTURAL STABILITY OF BUILDING AND ADJOINING STRUCTURE.
- IF ANY SUBMITTED DOCUMENT IS FOUND TO BE FAKE THE H.M.C AUTHORITY MAY REVOKE THE SANCTION PLAN.
- THE CONSTRUCTION OF WATER RESERVOIR AND SEPTIC TANK WILL BE EXECUTED UNDER THE GUIDANCE OF ARCHITECT & E.S.E

DECLARATION:

I/WE DO HEREBY DECLARE THAT WE SHALL ARRANGE THE FILL COVER TO RAISE & MAINTAIN THE PLANTATION AT MY/OUR OWN COST AS SHOWN IN THE DRAWING. THE CHARACTER OF THE ROAD IS A H.M.C ROAD & I DO HEREBY DECLARE WITH FULL RESPONSIBILITY THAT THE BUILDING PLAN HAS BEEN DRAWN BY ME AS PER PROVISION OF H.M.C & THE SITE CONDITION INCLUDING THE WIDTH OF THE ADJOINING ROAD CONFORM WITH SITE PLAN & THAT IS BUILDABLE SITE & NOT A TANK OF FILLED UP LAND.

ALOM EXTRUSIONS LTD.
[Signature]
 Director
SIGNATURE OF OWNER

CERTIFICATE OF STRUCTURAL ENGINEER

CERTIFIED THAT, "THE STRUCTURAL DESIGN & DRAWINGS OF BOTH FOUNDATION & SUPER STRUCTURE OF THE BUILDING HAS BEEN MADE BY ME CONSIDERING ALL POSSIBLE LOADS INCLUDING THE SEISMIC LOAD AS PER THE NATIONAL BUILDING CODE OF INDIA & CERTIFIED THAT IT IS SAFE & STABLE IN ALL RESPECTS."

[Signature]
SANJIV J. PAREKH
 ALLAHABAD, U.P. (INDIA)
 REG. NO. 104-088202-0
 E.S.E., 91, 97, 100/101
 MUNICIPAL CORPORATION.

SIGNATURE OF STRUCTURAL ENGINEER

CERTIFICATE OF ARCHITECT

THE L.B.A. HAS CERTIFIED ON THE PLAN ITSELF WITH FULL RESPONSIBILITY THAT THE BUILDING PLAN HAS BEEN DRAWN UP AS PER PROVISION OF H.M.C. BLDG. RULES 2009, AS AMENDED FROM TIME TO TIME AND THAT THE SITE CONDITION INCLUDING THE WIDTH OF THE ADJOINING ROAD CONFORM WITH THE PLAN AND IT IS A BUILDABLE SITE AND NOT A TANK OR A FILLED UP TANK.

[Signature]
Raj Kumar Agrawal
 L.B.A. No. 38
 88, ROYD STREET, KOL-16
SIGNATURE OF ARCHITECT

- SPECIFICATION OF BUILDING**
- ALL DIMENSIONS ARE IN MM. UNLESS OTHERWISE NOTED.
 - ONLY WRITTEN DIMENSION SHOULD BE STRICTLY FOLLOWED.
 - ALL BR. WORK SHOULD BE DONE BY SAND CEMENT MORTAR
 - FOR 250 THK WALL 1:5 MIX.
 - INTERNAL WALL 1:5 MIX.
 - FOR 75 MM THK. WALL 1:4 MIX WITH WIRE MESH.
 - PLASTERING SHOULD BE DONE BY SAND CEMENT MORTAR
 - IN EXTERNAL WALL (1:5) 12MM THK.
 - INTERNAL WALL (1:5) 12MM THK. IN CEILING, LINTEL, CHAMRA ETC (1:4) 6MM THK.
 - FOR 75 MM THK. WALL 1:4 MIX WITH WIRE MESH.
 - DOOR & WINDOW FRAME WILL BE OF SAL WOOD & SHUTTER WILL BE OF CAMAL.
 - REINFORCEMENT AREA TO OF H.Y.S.D. BARS (GRADE FE-415) CONFORMING TO IS.1786-1978.
 - LAP LENGTH/BOND LENGTH, CRANKS ETC ARE TO BE REQUIRED AS PER IS-456-1978.
 - FOR STRUCTURAL DETAILS REFER DRG. SHEET NO. 2 OF 2.
 - ALL 90° BENDS SHOULD BE 64.

TITLE
 ROOF PLAN.

PROJECT

PROPOSED G+VIII STORED (27.75 MT. HT.) RESIDENTIAL BUILDING AT PRE. NO.-184, J. N. MUKHERJEE ROAD, J.L. NO.-01, NEBATTAN NO.-251, R.S DAG NO-160, 161, 162/267, 74/254, 82, 83, 84, 85, 86, 1, R. DAG NO.-168, 169, 171, 172, 88, 89, 90, 91, 92, MOUZA-MALIPANCIGHARA, WARD NO-04, P.S-MALIPANCIGHARA, DIST. HOWRAH, HOWRAH-711106, UNDER HOWRAH MUNICIPAL CORPORATION.

DATE	DRG NO	SEAL	CHECKED	SHEET NO
01.02.21	ARCH/687/2019	WITHAN	NORMAL	

SCALE: 1:100

ARCHITECT
RAJ AGRAWAL & ASSOCIATES
 88, ROYD STREET, CALCUTTA - 16

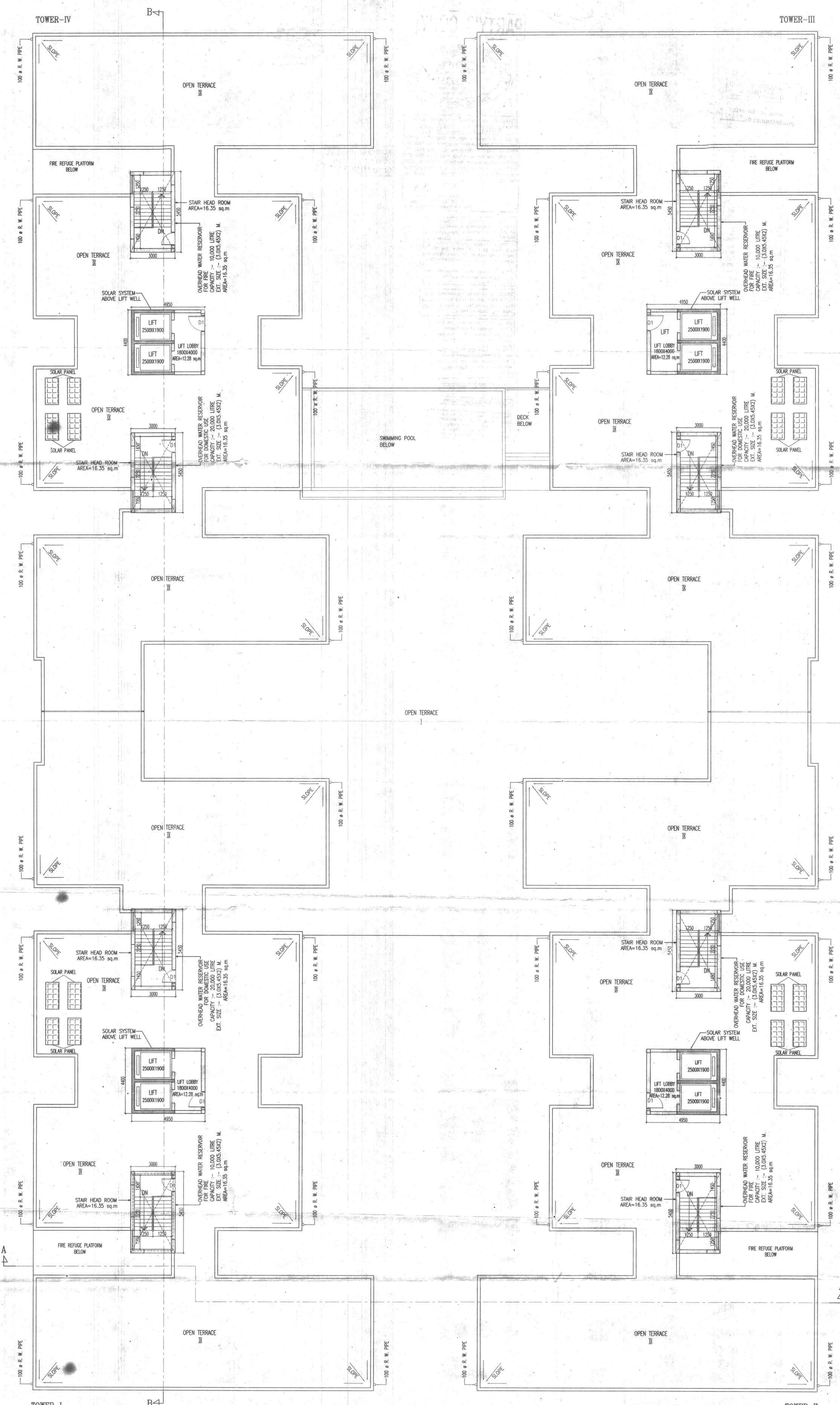

ROOF PLAN

1

APPLICANT HAS TO EXHIBIT AT A CONSPICUOUS PLACE:

PREMISES NO :-
NAME OF THE LBA, LBS :-
NAME OF THE STRUCTURAL ENGG. :-
NAME OF THE GEO-TECHNICAL ENGINEER :-
NAME OF OWNER :-
NAME OF THE APPLICANT :-
BUILDING PERMIT :-

THE SANCTION IS VALID
UP TO 31/1/2026...

APPROVED AS PER ORDER OF
COMMISSIONER D. 07/03/2021

The applicant shall keep at the site one set of plans and Specifications and shall also exhibit at a conspicuous place the number of the Premises. The Name of the Architect or Licensed Building Surveyor, Structural Engineer and Geo Technical Engineer Name of Owner and number and date of the Building Permit.

CONSTRUCTION SITE SHALL BE MAINTAINED TO PREVENT MOSQUITO BREEDING IN SUCH MANNER SO THAT ALL WATER COLLECTION & PARTICULARLY LIFT WELLS, VATS, BASEMENT CURING SITES, OPEN RECEPTACLES ETC. MUST BE EMPTIED COMPLETELY TWICE A WEEK.

Sanctioned Conditionally on undertaking from the owner that if any part of the building to be constructed falls within the alignment of HMC, the same will be demolished by the owner at his/her risk and for this the owner will not claim any compensation from HMC

Plan for water connection arrangement SEMI U. G. should be submitted at the Office of the Assistant Engineer of Borough and sanction to be obtained before proceeding with the work of Water Supply. Any deviation may lead to disconnection / demolition.

No rain water pipe should be fixed or discharged on Road or Footpath. Drainage plan should be submitted at the Borough Assistant Engineer's Office and the sanction obtained before proceeding with the drainage work.

CERTIFIED COPY



CORRECTION PLAN
BRC No. 39119-2, Ward No. 04
07/03/2021
Sub. Asst. Engineer
Bldg. Department
Howrah Municipal Corporation

Structural plan and design calculation as submitted by the structural engineer have been kept with B.P. No. 39119-2, Date 23/2/2021 for record of the Howrah Municipal Corporation without verification. No deviation from the submitted structural plan should be made at the time of erection without submitting fresh structural plan along with design calculation and stability certificate in the prescribed form, necessary steps should be taken for the safety of the adjoining premises public and private properties and safety of Human Life during construction.

Executive Engineer
Building Department
Howrah Municipal Corporation
07/03/2021

PLACED IN MUNICIPAL
BUILDING COMMITTEE
DATED 02/03/2021

Sanctioned subject to demolition of existing structure to provide open space as per plan before construction is started.

Before starting any Construction the site must conform with the plans sanctioned and all the conditions as proposed in the plan should be fulfilled.

The validity of the written permission to execute the work is subject to the conditions.

The Building Materials necessary for construction should conform to standard specified in the National Building Code of India.

Design of all structural Members including that of the foundation should conform to Standards specified in the National Building Code of India.

Non Commencement of Erection or Re-Erection within Two Year will Require Fresh Application for Sanction.

RESIDENTIAL BUILDING

DEVIATION WOULD MEAN DEMOLITION

Necessary steps should be taken for the safety of the lives of the adjoining public and private properties during construction. Also to avoid pollution as per WBPCB Guidelines in VAGUE.