

**FLOOR SLAB SCHEDULE:-**

SLAB THK.	SHORTER SPAN		LONGER SPAN	
	SUPPORT TOP	MID SPAN BOTTOM	SUPPORT TOP	MID SPAN BOTTOM
100	8 T @ 150 C/C	8 T @ 200 C/C	8 T @ 150 C/C	8 T @ 200 C/C
115	8 T @ 150 C/C	8 T @ 175 C/C	8 T @ 150 C/C	8 T @ 200 C/C
150	10 T @ 150 C/C	10 T @ 150 C/C	10 T @ 150 C/C	10 T @ 150 C/C

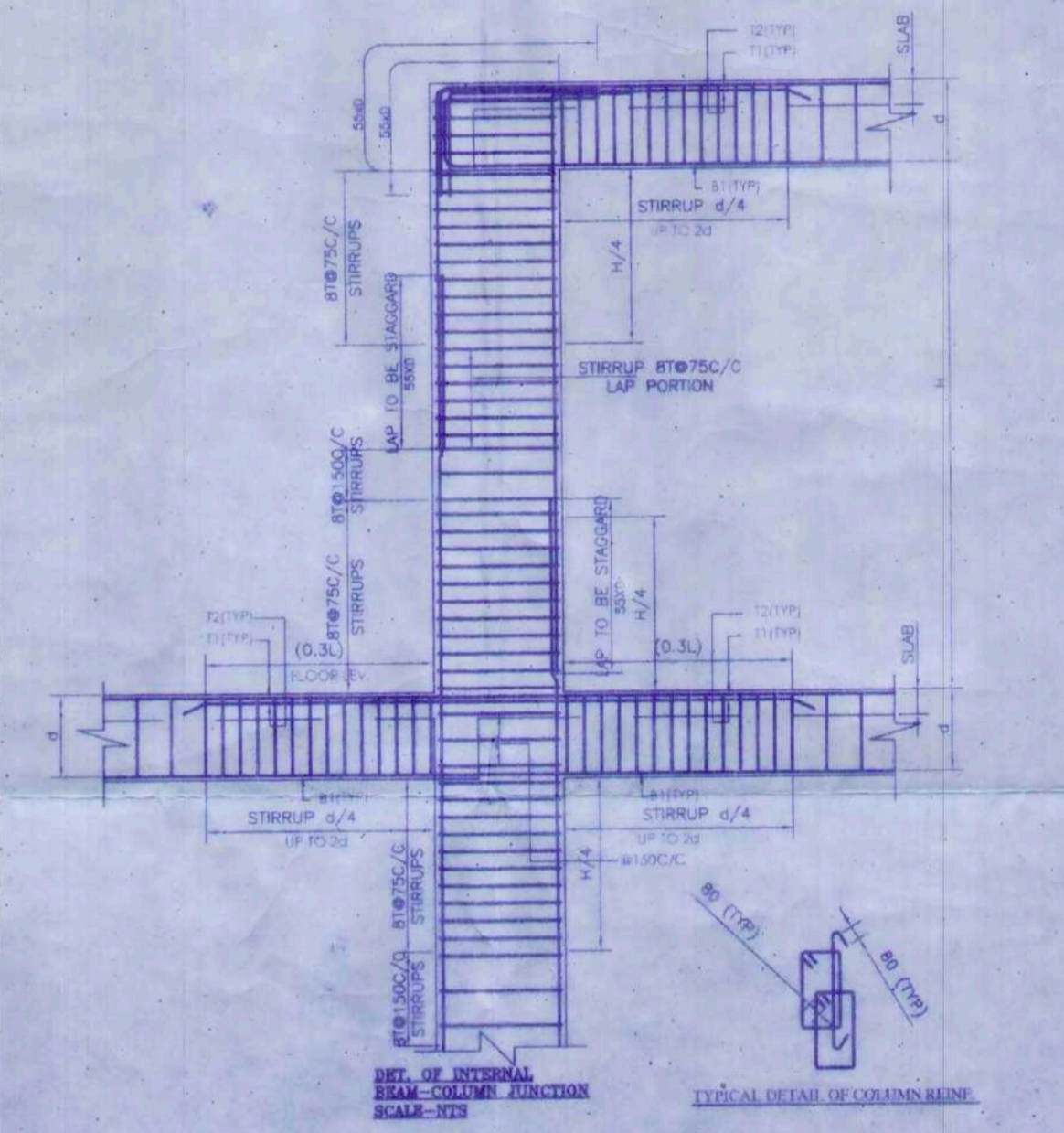
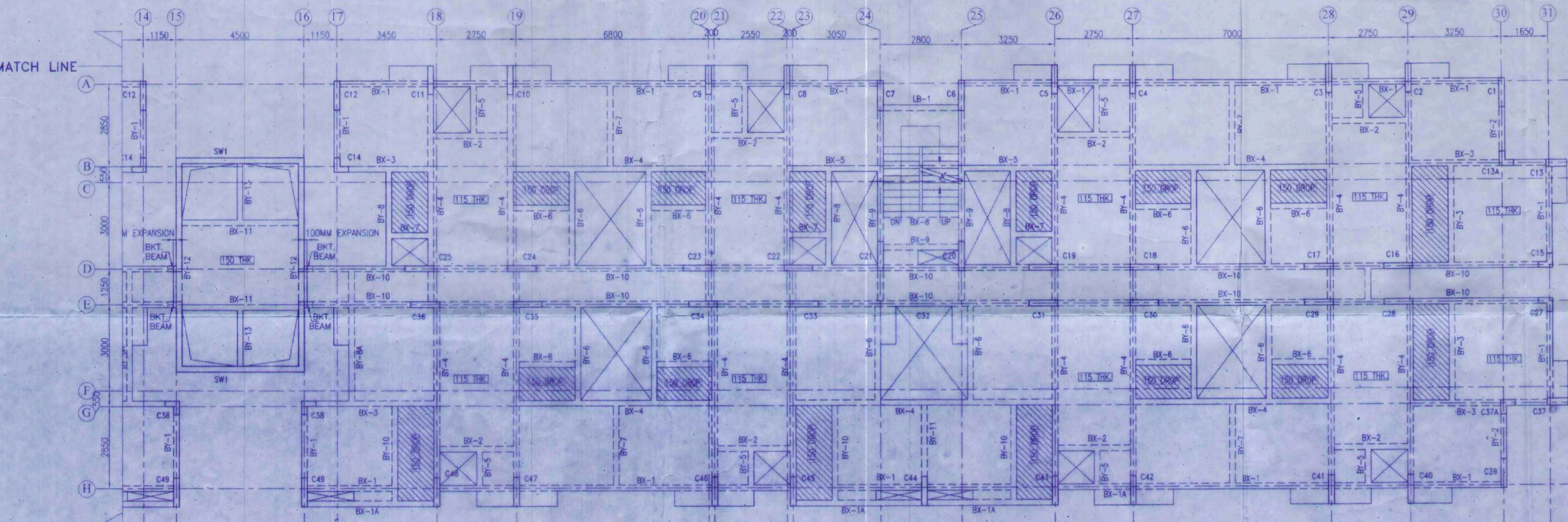

**G.A OF TYPICAL FLOOR LEVEL**  
UNLESS OTHERWISE MENTION ALL SLAB THICKNESS 100MM

**TYPICAL FLOOR BEAM SCHEDULE:-**

BEAM MKD.	BEAM SIZE	SUPPORT REINFORCEMENT			SPAN REINFORCEMENT		
		TOP	BOTTOM	STIRRUPS	TOP	BOTTOM	STIRRUPS
BX-1	200X900/600	3-20T+3-16T	3-20T	2L-8T@115 C/C	2-20T	3-20T+3-16T	2L-8T@200 C/C
BX-1A	200X900	3-20T+3-16T	3-20T	2L-8T@115 C/C	2-20T	3-20T+3-16T	2L-8T@200 C/C
BX-2	200X400	2-16T	3-16T	2L-8T@115 C/C	2-16T	3-16T	2L-8T@200 C/C
BX-3	200X600	3-20T	3-20T	2L-8T@115 C/C	2-20T	3-20T	2L-8T@200 C/C
BX-4	200X600	2-20T	3-20T	2L-8T@115 C/C	2-20T	3-20T	2L-8T@200 C/C
BX-5	200X400	3-20T	3-20T	2L-8T@115 C/C	2-20T	3-20T	2L-8T@200 C/C
BX-6	200X400	2-16T	3-20T	2L-8T@115 C/C	2-16T	3-20T	2L-8T@200 C/C
BX-7	200X400	2-16T	3-20T	2L-8T@115 C/C	2-16T	3-20T	2L-8T@200 C/C
BX-8	200X400	2-20T	3-20T	2L-8T@115 C/C	2-20T	3-20T	2L-8T@200 C/C
BX-9	200X600	3-20T	3-20T	2L-8T@115 C/C	2-20T	3-20T	2L-8T@200 C/C
BX-10	200X600	3-20T+3-16T	3-20T	2L-8T@115 C/C	2-20T	3-20T+3-16T	2L-8T@200 C/C
BX-11	200X600	3-20T+3-16T	3-20T	2L-8T@115 C/C	2-20T	3-20T+3-16T	2L-8T@200 C/C
LB	200X600	3-20T	3-20T	2L-8T@115 C/C	2-20T	3-20T	2L-8T@200 C/C

**TYPICAL FLOOR BEAM SCHEDULE:-**

BEAM MKD.	BEAM SIZE	SUPPORT REINFORCEMENT			SPAN REINFORCEMENT		
		TOP	BOTTOM	STIRRUPS	TOP	BOTTOM	STIRRUPS
BY-1	200X900	3-20T+3-16T	3-20T	2L-8T@115 C/C	2-20T	3-20T+3-16T	2L-8T@200 C/C
BY-2	200X900	3-20T	3-20T	2L-8T@115 C/C	2-20T	3-20T	2L-8T@200 C/C
BY-3	200X400	2-20T	3-20T	2L-8T@115 C/C	2-20T	3-20T	2L-8T@200 C/C
BY-4	200X600	3-20T+3-16T	3-20T	2L-8T@115 C/C	2-20T	3-20T+3-16T	2L-8T@200 C/C
BY-5	200X400	2-16T	3-16T	2L-8T@115 C/C	2-16T	3-16T	2L-8T@200 C/C
BY-6	200X400	2-20T	3-20T	2L-8T@115 C/C	2-20T	3-20T	2L-8T@200 C/C
BY-7	200X400	2-20T	3-20T	2L-8T@115 C/C	2-20T	3-20T	2L-8T@200 C/C
BY-8	200X400	2-20T	3-20T	2L-8T@115 C/C	2-20T	3-20T	2L-8T@200 C/C
BY-8A	200X600	3-20T	3-20T	2L-8T@115 C/C	2-20T	3-20T	2L-8T@200 C/C
BY-9	200X600	3-20T+3-16T	3-20T	2L-8T@115 C/C	2-20T	3-20T+3-16T	2L-8T@200 C/C
BY-10	200X400	3-20T	3-20T	2L-8T@115 C/C	2-20T	3-20T	2L-8T@200 C/C
BY-11	200X600	3-20T	3-20T	2L-8T@115 C/C	2-20T	3-20T	2L-8T@200 C/C
BY-12	200X600	3-20T+3-16T	3-20T	2L-8T@115 C/C	2-20T	3-20T+3-16T	2L-8T@200 C/C
BY-13	200X400	3-20T	3-20T	2L-8T@115 C/C	2-20T	3-20T	2L-8T@200 C/C

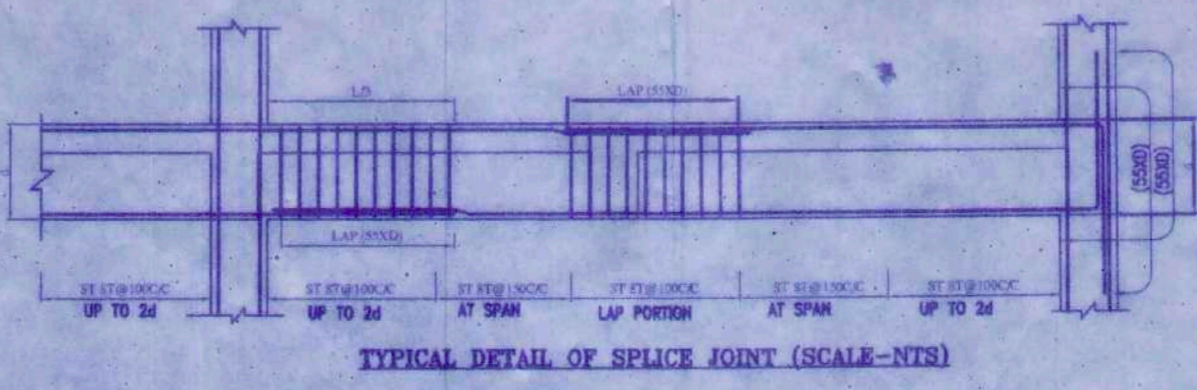
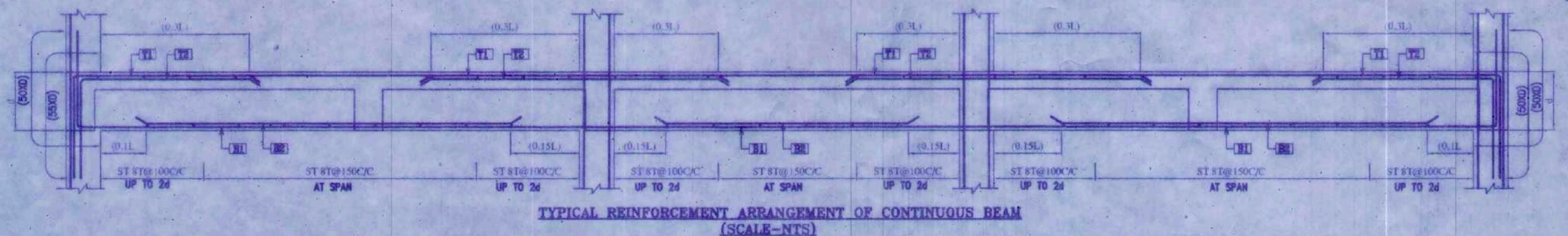
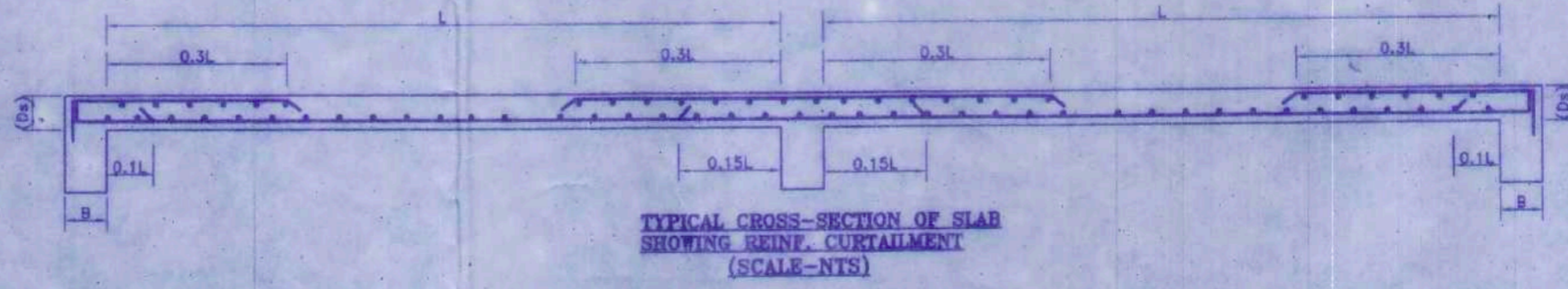

**PROPOSED AFFORDABLE HOUSING UNDER PRADHAN MANTRI AWAS YOJANA AT PRE. NO.39/1 SHALIMAR ROAD, MOUZA SHIBPUR SHEET NO.169,170,179,180, I.I. NO. 1, L.R. KHATIAN NO. 170,9,15,17, L.R. DAG NO. 12,13,39,40,41,42,44,45,60,61,62,63,6,7,8,9,10,11,12,13,14,15,16,17,22,24,1,2,11 P.S-SHIBPUR, WARD NO-39, BOROUGH -VIJIST HOWRAH-711003, UNDER HOWRAH MUNICIPAL CORPORATION, WEST BENGAL.**

**TITLE**  
G.A OF TYPICAL FLOOR (TOWER-1)

**NOTES**  
1. ALL DIMENSIONS ARE IN MM EXCEPT NOTED  
2. GRADE OF CONCRETE - M40 M25  
3. GRADE OF STEEL Fe500D

**PROVISION**  
1. 1ST CLASS CEMENT BRICK WORK IN SUPERSTRUCTURE  
2. 200 THK. EXT. BRICK WALL & 100 THK. INT. BRICK WALL IN 1/4 CM SAND MORTAR  
3. LEAN CONG. (1:2) WITH 10MM DOWN GRADED STONE CHIPS FOR ALL P.C.C. WORKS  
4. M25 CONG. (1:1:2) FOR ALL C.C. WORKS  
5. 20MM & 10MM THK. PLASTER (1:1) ON EXT. & INT. BRICK WALL RESPECTIVELY & 15MM THK. PLASTER (1:1) ON CONG.  
6. 20 X 25 PLATE ORNAMENTAL GRILL WITH WINDOW FRAME & 45 X 45MM THK. MARBLE FLOORING INCLUDING BATHING OVERHEAD FLOOR SLAB  
7. SINGLE LAYER 1.5 CM IN FOUNDATION SLAB  
8. HIRE & LABOUR FOR SHUTTERING & LABOUR WORKS INCLUDING STRUT TIES TO BE PLACED AS PER SPECIFICATION  
9. ALL WORKS TO BE DONE IN ACC. WITH THE SPECIFICATIONS & STANDARDS & BIDDERS  
10. SANITARY & PLUMBING FITTINGS & FIXINGS COMPLETE AS PER PLAN  
11. MATERIALS TO BE USED: CEMENT-PORTLAND, SAND-MEDIUM GRADE, STONE CHIPS-10MM DOWN GRADED  
12. 20MM COARSE TO MEDIUM GRADE FINE SAND, 20MM COLUMN-40MM BEAM-25MM, SLAB-20MM  
13. SAIL WOOD TO BE USED FOR DOOR & WINDOW FRAME & TEAK WOOD FOR SHUTTERS  
14. ALL DIMENSIONS ARE IN MM UNLESS OTHERWISE MENTIONED & WRITTEN DIMENSIONS WILL SUPERSEDE MEASURED DIMENSIONS

**DECLARATION**  
I, THE UNDERSIGNED, BEING A REGISTERED ARCHITECT, DO HEREBY DECLARE THAT THE CHARACTER OF THE ROAD (M.M. ROAD) IS NOT AFFECTED BY THE PROPOSED BUILDING AND THAT THE BUILDING PLAN HAS BEEN DRAWN BY ME AS PER PROVISION OF T.M.C. BUILDING RULES 2008 AS EXTENDED M.T.P.A. NOTWITHSTANDING THE SITE CONDITION INCLUDING THE WIDTH OF THE ADJOINING ROAD (CONFORM WITH THE SITE PLAN AND THAT IS BUILDABLE & IS SUITABLE FOR THE PROPOSED BUILDING.)  
**MALAY KUMAR GHOSH**  
Reg. No. CA/82/14854  
35A, Dr. Sarat Banerjee Road  
Kolkata - 700 029  
DIRECTOR

**DECLARATION**  
I, THE UNDERSIGNED, BEING A REGISTERED ARCHITECT, DO HEREBY DECLARE THAT THE CHARACTER OF THE ROAD (M.M. ROAD) IS NOT AFFECTED BY THE PROPOSED BUILDING AND THAT THE BUILDING PLAN HAS BEEN DRAWN BY ME AS PER PROVISION OF T.M.C. BUILDING RULES 2008 AS EXTENDED M.T.P.A. NOTWITHSTANDING THE SITE CONDITION INCLUDING THE WIDTH OF THE ADJOINING ROAD (CONFORM WITH THE SITE PLAN AND THAT IS BUILDABLE & IS SUITABLE FOR THE PROPOSED BUILDING.)  
**BIBEK BIKASH MULLICK**  
Reg. No. H.C./ST. ENGG./CLASS-1/LIC/NO.30  
35A, Dr. Sarat Banerjee Road  
Kolkata - 700 029  
DIRECTOR

**UNDERTAKING**  
1. I/WE UNDERTAKE THAT WHEN THE SEWER LINE WILL BE AVAILABLE, I/WE SHALL TAKE CONNECTION AT MY OWN COST & AS PER RULE  
2. NO BUILDING MATERIALS WILL BE STORED/DEPOSITED ON ROAD OVERNIGHT  
3. I/WE SHALL ARRANGE FOR PAINTING & MAINTENANCE OF THIS AS SHOWN IN THE DRAWING AT MY OWN COST

**STRUCTURAL CONSULTANT:**  
**P.M. CONSULTANT**  
STRUCTURAL ENGINEERING CONSULTANT  
3A, SIDDHESWAR ROAD,  
KOLKATA - 700029.  
PHONE: 26514813  
WEB: <http://pmstructure.wixsite.com/pmcon>  
Email: [pmstructure@gmail.com](mailto:pmstructure@gmail.com), [bibekm@rediffmail.com](mailto:bibekm@rediffmail.com)

DESIGNED-BEM REF.  
CHECKED-BEM SCALE: 1:100, 1:25  
DEALT - P.M. DATE: 05.03.2020  
DRG. NO.: P/MC/MUN/ST/SHALIMAR/TOWER-1/02

PROVIDED BY:  
35A, DR. SARAT BANERJEE ROAD,  
KOLKATA 700 029  
PHONE: 26514813  
THIS DRAWING IS A PROPERTY OF P.M. CONSULTANT 3A, SIDDHESWAR ROAD, KOLKATA-700029. ANY REPRODUCTION, CHANGE/DEVIATION IS NOT PERMISSIBLE WITHOUT PRIOR PERMISSION TO P.M. CONSULTANT. IN THE CONTRARY THIS WILL BE TREATED AS ILLEGAL ACT.



SPACE FOR H.M.C.



**PARTY'S COPY**

Structural plan and design calculation as submitted by the structural engineer have been kept with B.P. No. 156/17-20 Date 11/12/20 for record of the Howrah Municipal Corporation without verification. No deviation from the submitted structural plan should be made at the time of erection without submitting fresh structural plan along with design calculation and stability certificate in the prescribed form, necessary steps should be taken for the safety of the adjoining premises, public and private properties and safety of Human Life during construction.

*[Signature]*  
Executive Engineer  
Building Department  
Howrah Municipal Corporation

APPROVED AS PER ORDER OF  
COMMISSIONER Dt. 30/12/20

PLACED IN MUNICIPAL  
BUILDING COMMITTEE  
DATED 26/1/20

KOLKATA MUNICIPAL CORPORATION  
B.P. - 1175  
BIBIK BIKASH MULLICK

CONSULTANTS