

G.A OF TYPICAL FLOOR (TOWER-7)  
ALL SLAB THICKNESS 100 MM UNLESS OTHERWISE MENTIONED

TYPICAL FLOOR BEAM SCHEDULE:-

BEAM MKD.	BEAM SIZE	SUPPORT REINFORCEMENT			SPAN REINFORCEMENT		
		TOP	BOTTOM	STIRRUPS	TOP	BOTTOM	STIRRUPS
BX-1	200X900	3-20T+3-16T	3-20T	2L-8T@115 C/C	2-20T	3-20T+3-16T	2L-8T@200 C/C
BX-2	200X900	3-20T	3-20T	2L-8T@115 C/C	2-20T	3-20T	2L-8T@200 C/C
BX-3	200X400	2-16T	3-16T	2L-8T@115 C/C	2-16T	3-16T	2L-8T@200 C/C
BX-4	200X600	3-20T+3-16T	3-20T	2L-8T@115 C/C	2-20T	3-20T+3-16T	2L-8T@200 C/C
BX-5	200X600	3-16T	3-16T	2L-8T@115 C/C	3-16T	3-16T	2L-8T@200 C/C
BX-6	200X600	3-20T+3-16T	3-20T	2L-8T@115 C/C	2-20T	3-20T+3-16T	2L-8T@200 C/C
BX-7	200X400	2-16T	3-16T	2L-8T@115 C/C	2-16T	3-16T	2L-8T@200 C/C
BX-8	200X600	3-20T	3-20T	2L-8T@115 C/C	2-20T	3-20T	2L-8T@200 C/C
BX-9	200X400	2-16T	3-16T	2L-8T@115 C/C	2-16T	3-16T	2L-8T@200 C/C
BX-10	200X400	2-16T	3-16T	2L-8T@115 C/C	2-16T	3-16T	2L-8T@200 C/C
BX-11	200X600	3-16T	3-16T	2L-8T@115 C/C	3-16T	3-16T	2L-8T@200 C/C
BX-12	200X400	2-16T	3-16T	2L-8T@115 C/C	2-16T	3-16T	2L-8T@200 C/C
BX-13	200X600	3-20T	3-20T	2L-8T@115 C/C	2-20T	3-20T	2L-8T@200 C/C
BX-14	200X600	3-20T+3-16T	3-20T	2L-8T@115 C/C	2-20T	3-20T+3-16T	2L-8T@200 C/C
BX-15	200X600	3-20T+3-16T	3-20T	2L-8T@115 C/C	2-20T	3-20T+3-16T	2L-8T@200 C/C
BX-16	200X400	2-16T	3-16T	2L-8T@115 C/C	2-16T	3-16T	2L-8T@200 C/C
BX-17	200X600	3-20T	3-20T	2L-8T@115 C/C	2-20T	3-20T	2L-8T@200 C/C
BX-18	200X900	3-20T	3-20T	2L-8T@115 C/C	2-20T	3-20T	2L-8T@200 C/C

TYPICAL FLOOR BEAM SCHEDULE:-

BEAM MKD.	BEAM SIZE	SUPPORT REINFORCEMENT			SPAN REINFORCEMENT		
		TOP	BOTTOM	STIRRUPS	TOP	BOTTOM	STIRRUPS
BY-1	200X900/600	3-20T+3-16T	3-20T	2L-8T@115 C/C	2-20T	3-20T+3-16T	2L-8T@200 C/C
BY-2	200X600	3-20T+3-16T	3-20T	2L-8T@115 C/C	2-20T	3-20T+3-16T	2L-8T@200 C/C
BY-3	200X400	2-16T	3-16T	2L-8T@115 C/C	2-16T	3-16T	2L-8T@200 C/C
BY-4	200X900/600	3-20T	3-20T	2L-8T@115 C/C	2-20T	3-20T	2L-8T@200 C/C
BY-5	200X400	2-16T	3-16T	2L-8T@115 C/C	2-16T	3-16T	2L-8T@200 C/C
BY-6	200X400	2-16T	3-16T	2L-8T@115 C/C	2-16T	3-16T	2L-8T@200 C/C
BY-7	200X600	3-20T+3-16T	3-20T	2L-8T@115 C/C	2-20T	3-20T+3-16T	2L-8T@200 C/C
BY-8	200X600	2-20T	3-20T	2L-8T@115 C/C	2-20T	3-20T	2L-8T@200 C/C
BY-9	200X400	2-16T	3-16T	2L-8T@115 C/C	2-16T	3-16T	2L-8T@200 C/C
BY-10	200X600	3-20T	3-20T	2L-8T@115 C/C	2-20T	3-20T	2L-8T@200 C/C
BY-11	200X600	3-16T	3-16T	2L-8T@115 C/C	3-16T	3-16T	2L-8T@200 C/C
BY-12	200X400	2-16T	3-16T	2L-8T@115 C/C	2-16T	3-16T	2L-8T@200 C/C
BY-13	200X900	3-20T+3-16T	3-20T	2L-8T@115 C/C	2-20T	3-20T+3-16T	2L-8T@200 C/C
LB-1	200X600	3-20T	3-20T	2L-8T@115 C/C	2-20T	3-20T	2L-8T@200 C/C

FLOOR SLAB SCHEDULE:-

SLAB THK.	SHORTER SPAN			LONGER SPAN				
	SUPPORT	TOP	MID SPAN BOTTOM	SUPPORT	TOP	MID SPAN BOTTOM		
100	8 T	150 C/C	8 T	200 C/C	8 T	150 C/C	8 T	200 C/C
115	8 T	150 C/C	8 T	175 C/C	8 T	150 C/C	8 T	200 C/C
150	10 T	150 C/C	10 T	200 C/C	10 T	150 C/C	10 T	200 C/C

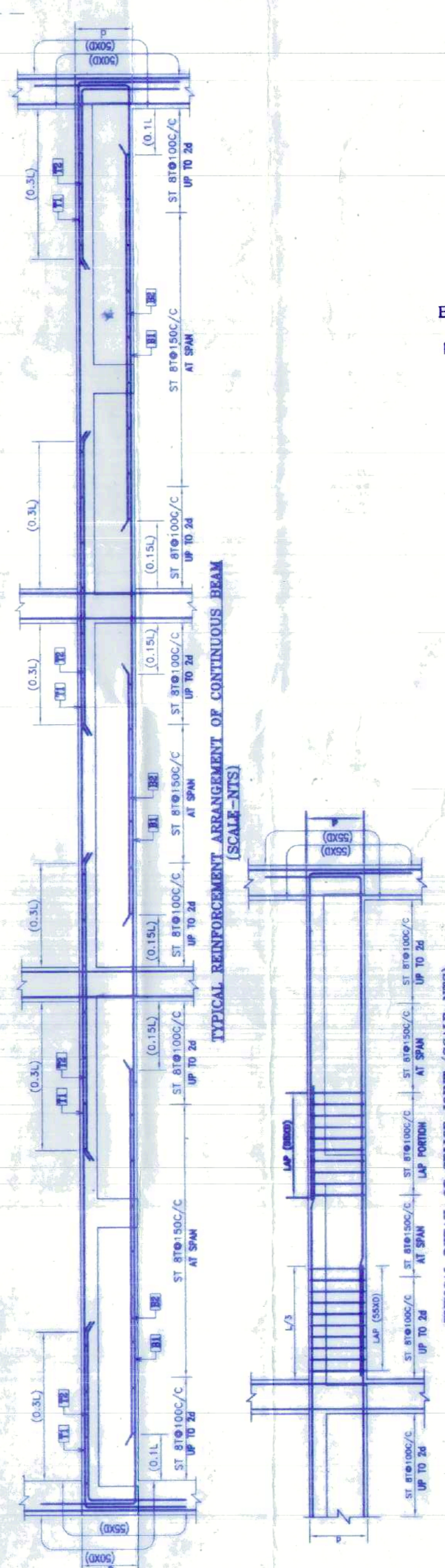

PROJECT  
**PROPOSED AFFORDABLE HOUSING UNDER PRADHAN MANTRI AWAS YOJANA AT PRE. NO.39/1 SHALIMAR ROAD, MOUZA SHIBPUR SHEET NO.169,170,179,180, J.L. NO. 1, L.R. KHATIAN NO. 170,9,15,17, L.R. DAG NO. 12,13,39,40,41,42,44,45,60,61,62,63,67,8,9,10,11,12,13,14,15,16,17,21,22,24,1,2,11 P.S.SHIBPUR, WARD NO-39, BOROUGH -VDIST HOWRAH-711103, UNDER HOWRAH MUNICIPAL CORPORATION, WEST BENGAL.**

TITLE  
**G.A OF TYPICAL FLOOR (TOWER-7)**

- NOTES
- ALL DIMENSIONS ARE IN MM EXCEPT NOTED
  - GRADE OF CONCRETE - M40 M25
  - GRADE OF STEEL - Fe500D
- PROVISION
- 15% CLASS CEMENT BRICK WORK IN SUPERSTRUCTURE
  - 20% THK. EXT. BRICK WALL & 10% THK. INT. BRICK WALL IN 1:4 CEMENT MORTAR
  - LEAN CONC. (1:3) WITH 10MM GRADED STONE CHIPS FOR ALL P.C. WORKS
  - M25 CONC. (1:1.5) FOR ALL R.C. WORKS
  - 20 MM & 15 MM (TK. PLASTER) 1:5 ON EXT. & INT. BRICK WALL RESPECTIVELY & 10MM THK. PLASTER (1:3) ON CEILING
  - 20 X 20 X 100 ORNAMENTAL GRILL WITH WINDOW FRAME & 40 X 40 THK. MARBLE FLOORING INCLUDING SKirting OVER R.C.C. FLOOR SLAB
  - BRICKLAYER F.S. IN FOUNDATION & PLINTH
  - HIRE & LABOUR FOR SHUTTLING & LABOUR WORKS INCLUDING STOUT PIRKS TO BE PLACED AS PER DIRECTION
  - 10% STEEL BAR FOR ALL R.C.C. WORKS INCLUDING DISTRIBUTERS & BINDERS
  - SANITARY & PLUMBING FITTING & FINING COMPLETE AS PER PLAN
  - MATERIALS TO BE USED - CEMENT - PORTLAND SAND - MEDIUM GRADE
  - STONE CHIPS - 10MM DOWN GRADED
  - CLEAR COVER TO MAIN REIN. FOUNDATION - 50MM, COLUMN - 40MM, BEAM - 25MM, SLAB - 20MM
  - SAL WOOD TO BE USED FOR DOOR & WINDOW FRAME & TEAK WOOD FOR SHUTTLERS
  - ALL DIMENSIONS ARE IN MM UNLESS OTHERWISE MENTIONED & WRITTEN DIMENSIONS WILL SUPERSEDE MEASURED DIMENSIONS.

DECLARATION  
 THE PLAN IS SIGNED & ENDORSED BY BOUNDARY WALL. THE CHARACTER OF THE ROAD IS A.H.C. ROAD. I DO HEREBY DECLARE WITH FULL RESPONSIBILITY THAT THE BUILDING PLAN HAS BEEN DRAWN BY ME AS PER PROVISION OF I.A.M.C. BUILDING RULES 2008 AS EXTENDED BY THE BYELAWS TO I.A.M.C. AND THE SITE CONDITION INCLUDING THE WIDTH OF THE RESULTING ROAD CONFORM WITH THE SITE PLAN AND THAT IS BUILDABLE.

**ANIL KUMAR GHOSH**  
 Regn. No. CA/92/14854  
 35A, Dr. Sarat Banerjee Road  
 Kolkata - 700 029

DECLARATION  
 I HEREBY DECLARE THAT THE FOUNDATION AND SUPERSTRUCTURE OF THE BUILDING HAS BEEN SO DESIGNED BY ME AS PER PROVISION OF I.A.M.C. BUILDING RULES 2008 AS EXTENDED BY THE BYELAWS TO I.A.M.C. AND THE SITE CONDITION INCLUDING THE WIDTH OF THE RESULTING ROAD CONFORM WITH THE SITE PLAN AND THAT IS BUILDABLE.

**BIBEK BIKASH MULLICK**  
 E.S.E. - 1/75  
 M.S. Sp. Eng. (Survey, U.K.)  
 C.Eng. (UK) (1998)  
 KOLKATA MUNICIPAL CORPORATION  
 Regn. No. 03134/8  
 H.M.C. (E.S.E./1-39)  
 10/1, Park Street, Kolkata - 700 016

DECLARATION  
 I HEREBY DECLARE THAT WHEN THE SEWER LINE WILL BE AVAILABLE I WILL TAKE CONNECTION AT MY OWN COST & AS PER PLAN.

**ALOK ROY**  
 Empanelled Geotechnical Engineer  
 Kolkata Municipal Corporation  
 Class-1, No-G-7/119  
 GA, Milan Park  
 Kolkata-700 084  
 H.M.C./G.T.E./LIC.No.3

DECLARATION  
 I HEREBY DECLARE THAT THE FOUNDATION AND SUPERSTRUCTURE OF THE BUILDING HAS BEEN SO DESIGNED BY ME AS PER PROVISION OF I.A.M.C. BUILDING RULES 2008 AS EXTENDED BY THE BYELAWS TO I.A.M.C. AND THE SITE CONDITION INCLUDING THE WIDTH OF THE RESULTING ROAD CONFORM WITH THE SITE PLAN AND THAT IS BUILDABLE.

**ALOK ROY**  
 Empanelled Geotechnical Engineer  
 Kolkata Municipal Corporation  
 Class-1, No-G-7/119  
 GA, Milan Park  
 Kolkata-700 084  
 H.M.C./G.T.E./LIC.No.3

DECLARATION  
 I HEREBY DECLARE THAT THE FOUNDATION AND SUPERSTRUCTURE OF THE BUILDING HAS BEEN SO DESIGNED BY ME AS PER PROVISION OF I.A.M.C. BUILDING RULES 2008 AS EXTENDED BY THE BYELAWS TO I.A.M.C. AND THE SITE CONDITION INCLUDING THE WIDTH OF THE RESULTING ROAD CONFORM WITH THE SITE PLAN AND THAT IS BUILDABLE.

**ALOK ROY**  
 Empanelled Geotechnical Engineer  
 Kolkata Municipal Corporation  
 Class-1, No-G-7/119  
 GA, Milan Park  
 Kolkata-700 084  
 H.M.C./G.T.E./LIC.No.3

DECLARATION  
 I HEREBY DECLARE THAT THE FOUNDATION AND SUPERSTRUCTURE OF THE BUILDING HAS BEEN SO DESIGNED BY ME AS PER PROVISION OF I.A.M.C. BUILDING RULES 2008 AS EXTENDED BY THE BYELAWS TO I.A.M.C. AND THE SITE CONDITION INCLUDING THE WIDTH OF THE RESULTING ROAD CONFORM WITH THE SITE PLAN AND THAT IS BUILDABLE.

**ALOK ROY**  
 Empanelled Geotechnical Engineer  
 Kolkata Municipal Corporation  
 Class-1, No-G-7/119  
 GA, Milan Park  
 Kolkata-700 084  
 H.M.C./G.T.E./LIC.No.3

DECLARATION  
 I HEREBY DECLARE THAT THE FOUNDATION AND SUPERSTRUCTURE OF THE BUILDING HAS BEEN SO DESIGNED BY ME AS PER PROVISION OF I.A.M.C. BUILDING RULES 2008 AS EXTENDED BY THE BYELAWS TO I.A.M.C. AND THE SITE CONDITION INCLUDING THE WIDTH OF THE RESULTING ROAD CONFORM WITH THE SITE PLAN AND THAT IS BUILDABLE.

**ALOK ROY**  
 Empanelled Geotechnical Engineer  
 Kolkata Municipal Corporation  
 Class-1, No-G-7/119  
 GA, Milan Park  
 Kolkata-700 084  
 H.M.C./G.T.E./LIC.No.3

DECLARATION  
 I HEREBY DECLARE THAT THE FOUNDATION AND SUPERSTRUCTURE OF THE BUILDING HAS BEEN SO DESIGNED BY ME AS PER PROVISION OF I.A.M.C. BUILDING RULES 2008 AS EXTENDED BY THE BYELAWS TO I.A.M.C. AND THE SITE CONDITION INCLUDING THE WIDTH OF THE RESULTING ROAD CONFORM WITH THE SITE PLAN AND THAT IS BUILDABLE.

**ALOK ROY**  
 Empanelled Geotechnical Engineer  
 Kolkata Municipal Corporation  
 Class-1, No-G-7/119  
 GA, Milan Park  
 Kolkata-700 084  
 H.M.C./G.T.E./LIC.No.3

DECLARATION  
 I HEREBY DECLARE THAT THE FOUNDATION AND SUPERSTRUCTURE OF THE BUILDING HAS BEEN SO DESIGNED BY ME AS PER PROVISION OF I.A.M.C. BUILDING RULES 2008 AS EXTENDED BY THE BYELAWS TO I.A.M.C. AND THE SITE CONDITION INCLUDING THE WIDTH OF THE RESULTING ROAD CONFORM WITH THE SITE PLAN AND THAT IS BUILDABLE.

**ALOK ROY**  
 Empanelled Geotechnical Engineer  
 Kolkata Municipal Corporation  
 Class-1, No-G-7/119  
 GA, Milan Park  
 Kolkata-700 084  
 H.M.C./G.T.E./LIC.No.3

DECLARATION  
 I HEREBY DECLARE THAT THE FOUNDATION AND SUPERSTRUCTURE OF THE BUILDING HAS BEEN SO DESIGNED BY ME AS PER PROVISION OF I.A.M.C. BUILDING RULES 2008 AS EXTENDED BY THE BYELAWS TO I.A.M.C. AND THE SITE CONDITION INCLUDING THE WIDTH OF THE RESULTING ROAD CONFORM WITH THE SITE PLAN AND THAT IS BUILDABLE.

**ALOK ROY**  
 Empanelled Geotechnical Engineer  
 Kolkata Municipal Corporation  
 Class-1, No-G-7/119  
 GA, Milan Park  
 Kolkata-700 084  
 H.M.C./G.T.E./LIC.No.3



# PARTY'S COPY

Structural plan and design calculation as submitted by the structural engineer have been kept with B.P. No. 258/1970 Date 4/1/70 for record of the Howrah Municipal Corporation without verification. No deviation from the submitted structural plan should be made at the time of erection without submitting fresh structural plan along with design calculation and stability certificate in the prescribed form. Necessary steps should be taken for the safety of the adjoining premises, public and private properties and safety of Human Life during construction.

*[Signature]*  
Executive Engineer  
Building Department  
Howrah Municipal Corporation

APPROVED AS PER ORDER OF  
COMMISSIONER Dt. 20/1/21

PLACED IN MUNICIPAL  
BUILDING COMMITTEE  
DATED 06/2/20

HOWRAH MUNICIPAL CORPORATION  
BUILDING DEPARTMENT  
HOWRAH