

SITE PLAN AT HOLDING NO.2100, DAKSHIN KUMROHALI , WARD NO.27 ,DAG - 104(P), 105(P), 106(P), AT
 MOUZA-KUMROKHALI, P.S.-SONARPUR, DIST.-24PGS.(S) , UNDER RAJPUR SONARPUR MUNICIPALITY

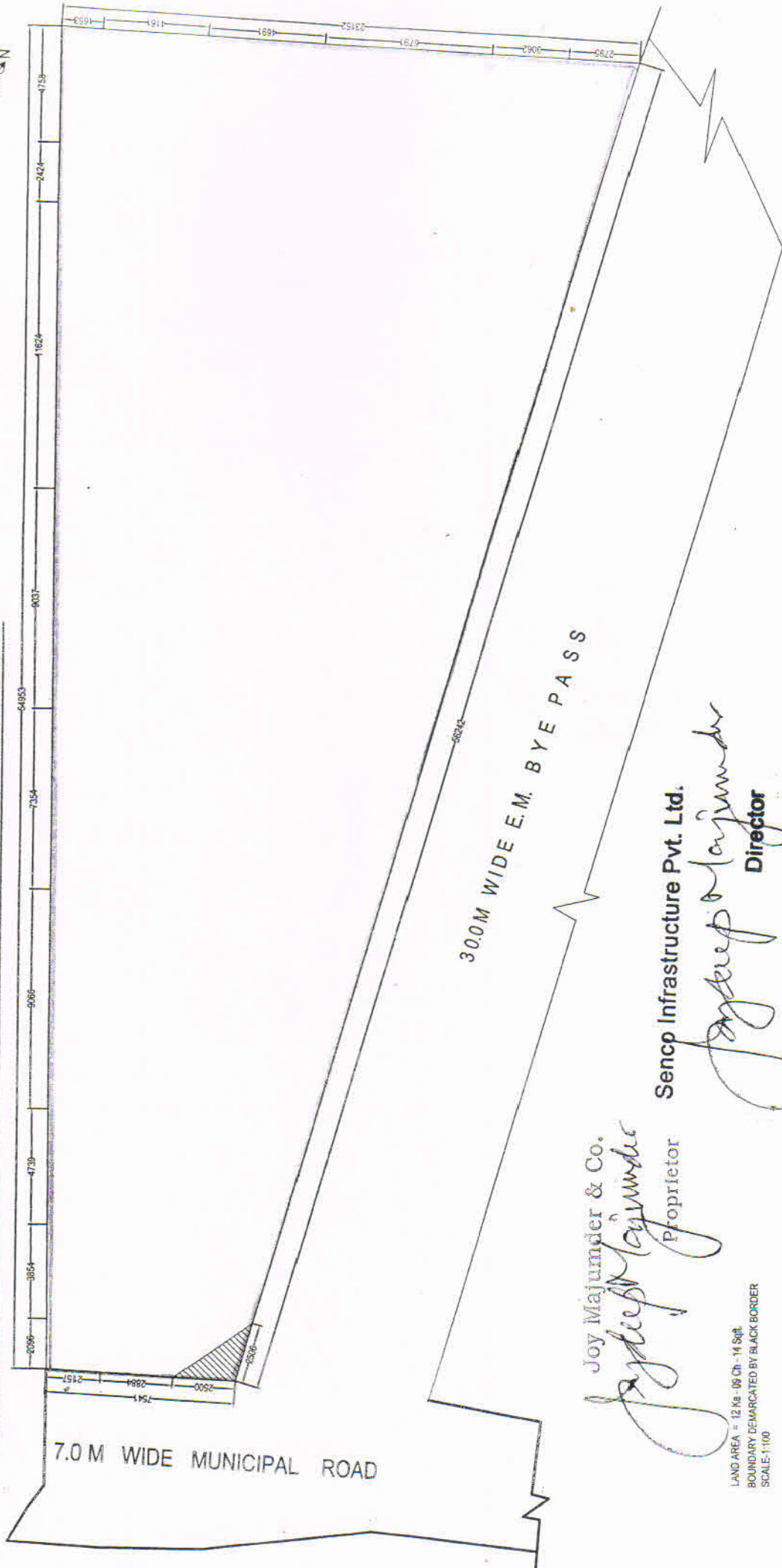

7.0 M WIDE MUNICIPAL ROAD

300.0 M WIDE E.M. BYPASS

Joy Majumder & Co.

Joydeep Majumder
 Proprietor

Senco Infrastructure Pvt. Ltd.

Jyotiraj Majumder
 Director

LAND AREA = 12 Kg - 09 Ch - 14 Sqft
 BOUNDARY DEMARCATED BY BLACK BORDER
 SCALE: 1:100