



BHARAT SANCHAR NIGAM LIMITED

(A Govt. of India Enterprise)

Office of the Chief General Manager, Eastern Telecom Projects
Microwave Survey Division,
2/5A, Judges Court Road, Alipore, Kolkata – 700 027

To
M/s Nirvana Devcon LLP
8/1, Lal Bazar Street,
1st Floor, Room No.11
Bikaner Building, Kolkata- 700001.

No-G/MWC/1-150/T.B/2017-18/Vol-I/279

Dated at Kolkata 02-08-2018

Sub:- NOC for Microwave clearance of height of the proposed residential building.

In connection with your application regarding above mentioned subject, it is observed that there is no physical obstruction to the working BSNL Microwave System from the proposed residential building, as per drawing supplied with your application. Therefore, NOC for Microwave clearance for your project having following particulars is hereby issued.

Name of the Project: Residential building.
Location: Premises No. 257/A, Deshpran Sashmal Road, Ward No. 94, Borough-X, P.S.- Jadavpur, Under KMC, Kolkata-700033.
Height: 116.50M (One Hundred Sixteen Point Five Zero Meters Only) above ground level including lift machine room and water tank on the roof top.

One set of drawings, duly signed is returned herewith. Any change/alteration/Modification in the drawings with respect to upward revision of height and/or shifting of Building Footprint is not permissible and will constitute an actionable violation of the NOC.

Encl: - As stated

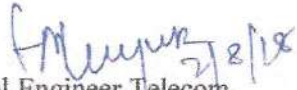
Divisional Engineer Telecom.
Microwave Survey Division
Kolkata.

For Nirvana Devcon LLP

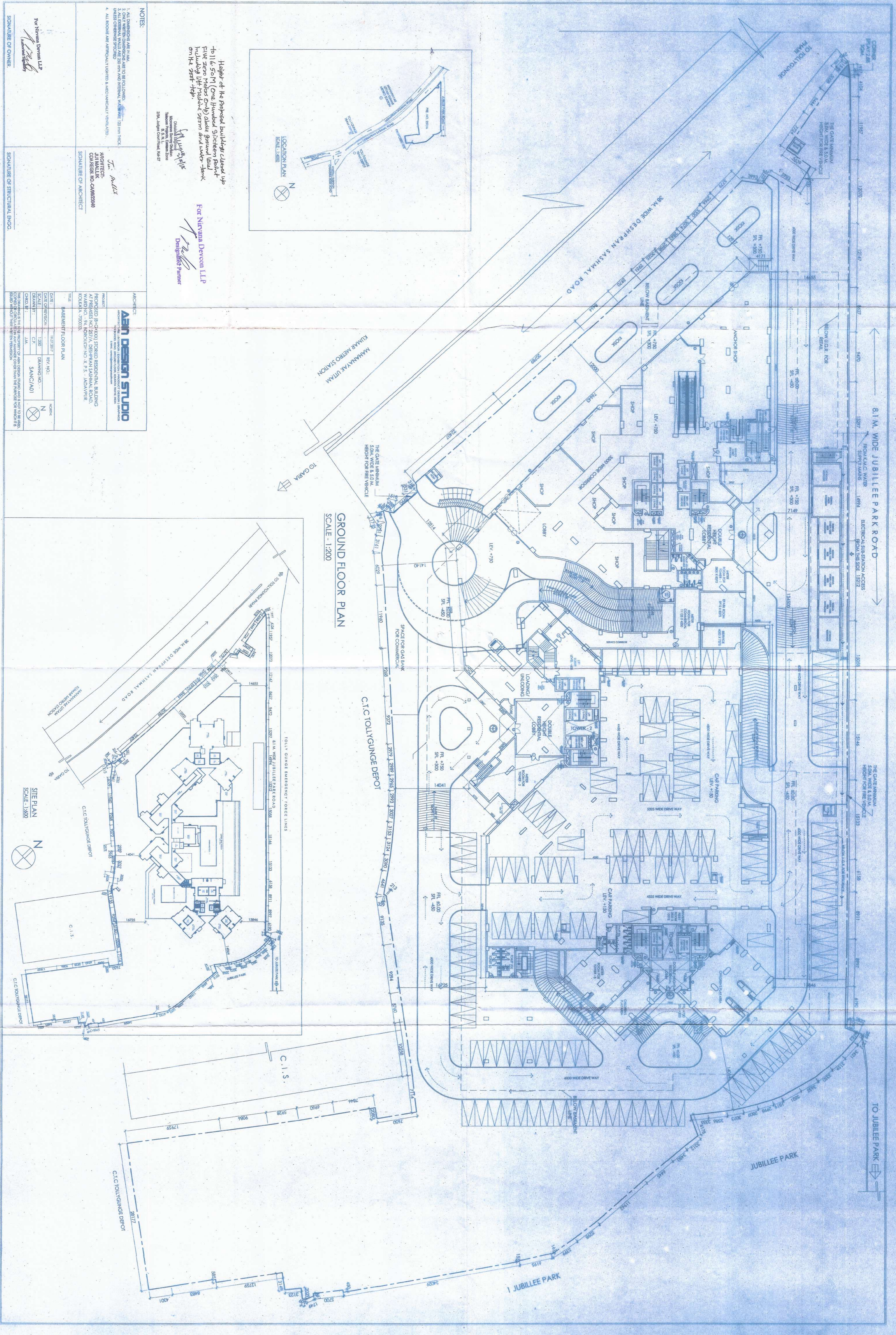

Designated Partner



GROUND FLOOR PLAN
SCALE - 1:200

C.I.C TOLLYGUNGE DEPOT

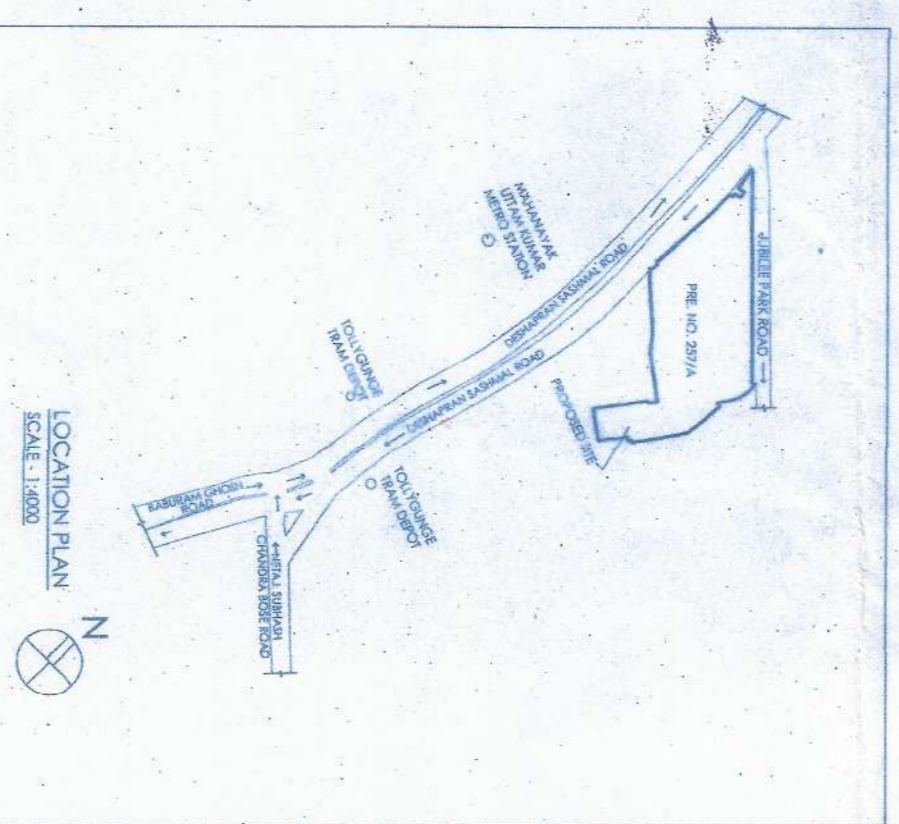
SITE PLAN
SCALE - 1:500



Height of the proposed building: 11.65m
 Five zone plots (only) above ground level
 including lift shafts, stairs and water tank
 on the 1st floor.

For Nirvana Devcon LLP
 Designer Partner

NOTES:

1. ALL DIMENSIONS ARE IN METERS.
2. ALL DIMENSIONS ARE TO FACE UNLESS SPECIFIED OTHERWISE.
3. ALL DIMENSIONS ARE TO FACE UNLESS SPECIFIED OTHERWISE.
4. ALL ROOMS ARE FINISHED TO INTERIOR SURFACE UNLESS SPECIFIED OTHERWISE.

ARCHITECT:
ASIN DESIGN STUDIO
 PROJECT NO: 25/7/A, DESHPAN SAKSHAL ROAD,
 KOLKATA, 700025.

ARCHITECT:
ASIN DESIGN STUDIO
 PROJECT NO: 25/7/A, DESHPAN SAKSHAL ROAD,
 KOLKATA, 700025.

DATE:	19/03/2017	REV. NO.:	01
SCALE:	1:200	DRAWING NO.:	ASIN/AD/17/01
DESIGNER:	J.M.	CHECKED BY:	J.M.
DATE:	19/03/2017	REV. NO.:	01
SCALE:	1:200	DRAWING NO.:	ASIN/AD/17/01
DESIGNER:	J.M.	CHECKED BY:	J.M.

For Nirvana Devcon LLP
 Designer Partner

For Nirvana Devcon LLP
 Designer Partner

For Nirvana Devcon LLP
 Designer Partner

For Nirvana Devcon LLP
 Designer Partner

For Nirvana Devcon LLP
 Designer Partner

For Nirvana Devcon LLP
 Designer Partner

For Nirvana Devcon LLP
 Designer Partner

For Nirvana Devcon LLP
 Designer Partner

For Nirvana Devcon LLP
 Designer Partner

