

THE WATER SUPPLY LAYOUT PLAN SHOWING THE PROPOSED G+IV STORIED APARTMENT TYPE RESIDENTIAL BUILDING OF SRI BRIJ BEHARI REALTORS LLP PARTNERS 1) SRI VINAY KUMAR SHARMA 2) SRI PARTHA PRATIM DUTTA, R.S. PLOT NO-1090, L.R. PLOT NO- 1297 L.R. K.H. NO-6350, SILICATE FACTORY ROAD, MOUZA- ASANSOL, P.S.- ASANSOL(S) J.L. NO- 35, WARD NO- 42, UNDER ASANSOL MUNICIPAL CORPORATION.

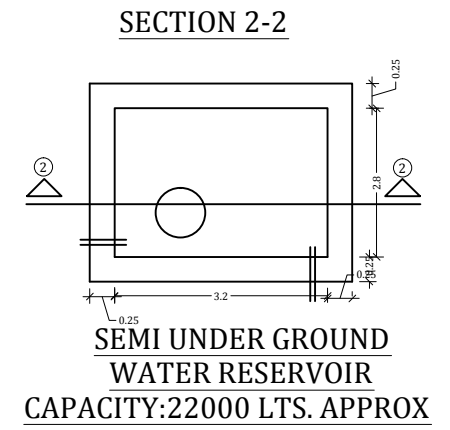
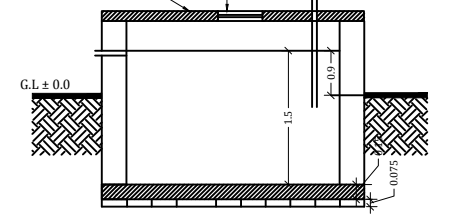
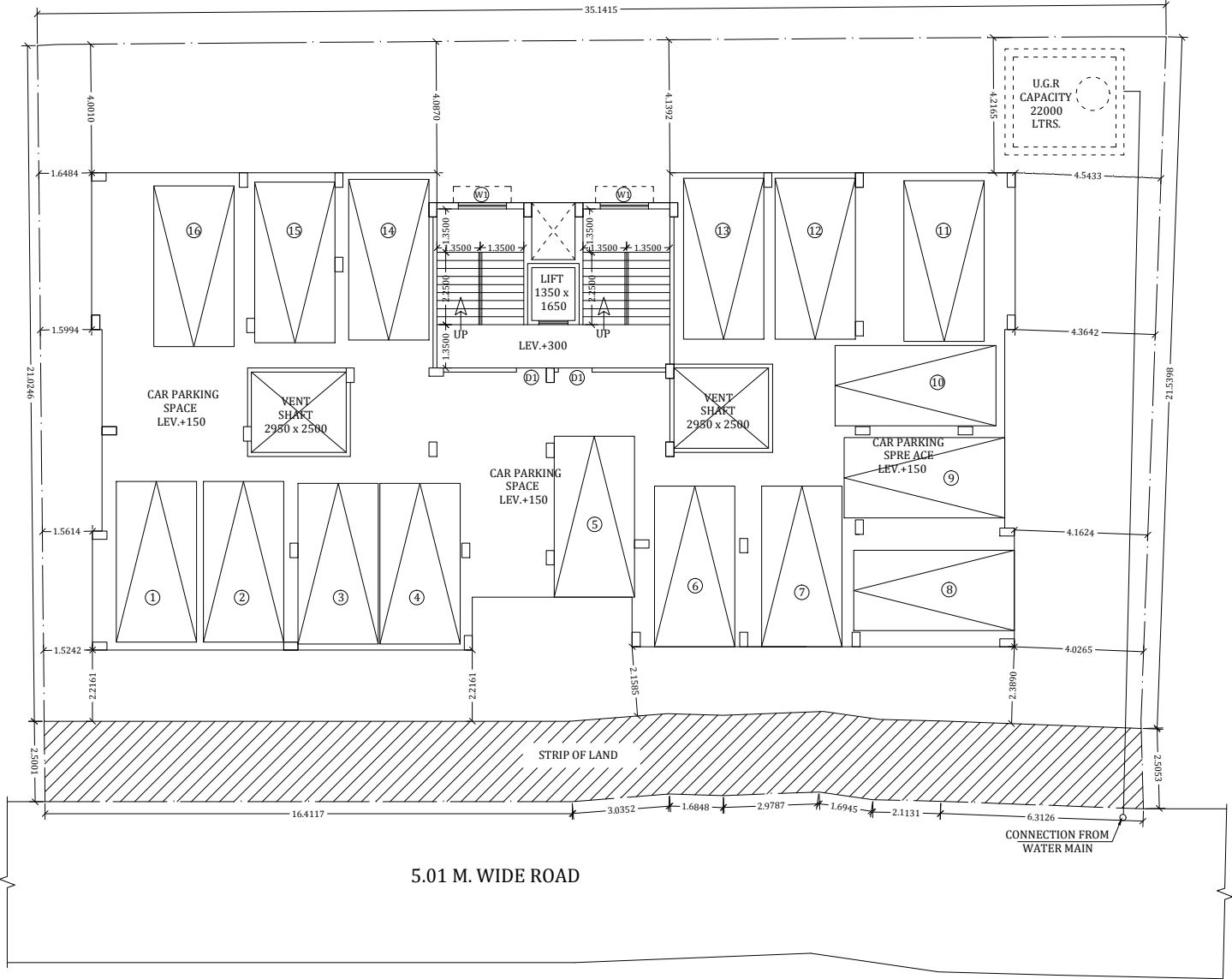
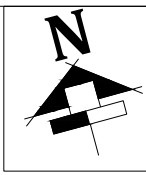

**GROUND FLOOR PLAN**  
SCALE: 1:1  
**FLOOR-PARKING**