

PLAN FOR PROP. G-3 FLAT TYPE RESIDENTIAL BLDG. OF 1) SUKANTA DASGUPTA, SO L.T. JAGATBANDHU DASGUPTA, 2) SUKLA MUKHERJEE, W/O DHIRAJ MUKHERJEE, IN MOUZA - NARI, LL. NO. - 70, C.S. PLOT NO. - 588/589, R.S. PLOT NO. - 589/4152, L.R. PLOT NO. - 1171, L.O.P. NO. - 61, L.R. KH. NO. - 42355, 43888, AT MAHALLA - HAFIZULLA BERH, WARD NO. - 08, HOLDING NO. - 328, P.S. - BARDHAMAN & DIST. - PURBA BARDHAMAN, UNDER THE MUNICIPALITY OF BURDWAN.

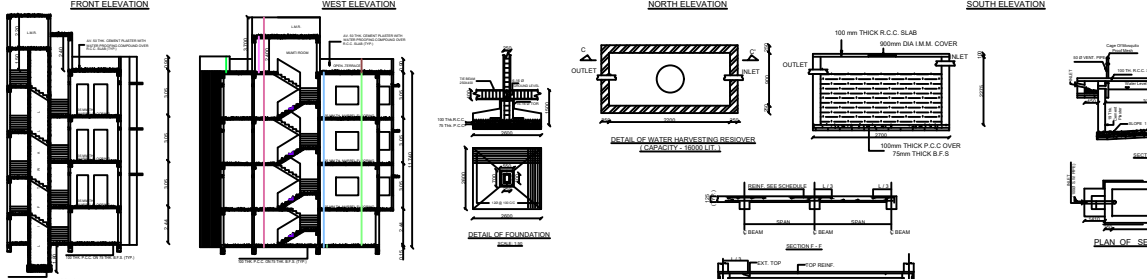

PROP. GROUND FLOOR PLAN FLOOR-PARKING | PROP. 1ST, 2ND, 3RD, F. TYPICAL FLOOR PLAN FLOORS, FLOORING, TYPICAL | ROOF PLAN (FLOOR TERRACE) | CALCULATION SHEET

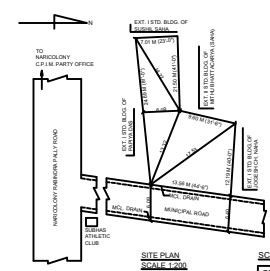

SITE PLAN SCALE: 1:200

SCHEDULE OF COLUMN :-

COLUMN MARKED	SIZE	REINFORCEMENT UPTO 3RD FLOOR		REINFORCEMENT FROM 3RD. FLOOR	
		LONGITUDINAL	TIES	SIZE	LONGITUDINAL
C1, C2, C3, C4, C5, C6, C7, C8, C9, C10, C11, C12, C13, C14, C15	250 x 400	10 - 16 Ø TOR	24-4 TOR @150 C/C	250 x 400	4 - 16 Ø TOR
C16, C17, C18, C19, C20	112 - 16 Ø TOR	24-4 TOR @150 C/C	250 x 400	4 - 16 Ø TOR	24-8 TOR @150 C/C

SCHEDULE OF ROOF BEAM :-

BEAM MARKED	SIZE	AT SUPPORT		AT SPAN	
		TOP	BOTTOM	TOP	BOTTOM
B	250 x 400	2 - 16 TOR	2 - 16 TOR	2 - 16 TOR	2 - 16 TOR
S1	250 x 400	2 - 16 TOR	2 - 16 TOR	2 - 16 TOR	2 - 16 TOR

SCHEDULE OF FOUNDATION :-

GRADE	FOUNDATION UNDER COLUMN MKD.	TYPE AND SIZE sqmm	DEPTH AT EDGE (D1)mm	REINFORCEMENT	
				AT COLUMN SUPPORT mm	ALONG LONGER DIRECTION
1	C1, C2, C3, C4, C5, C6, C7, C8, C9, C10, C11, C12, C13, C14, C15, C16, C17, C18, C19, C20	3000x3000	250	250	2 Ø TOR @ 100 C/C
II	C1, C2, C3, C4, C5, C6, C7, C8, C9, C10, C11, C12, C13, C14, C15, C16, C17, C18, C19, C20	3000x3000	300	300	2 Ø TOR @ 100 C/C

SCHEDULE OF SLAB :-

SLAB THICKNESS MKD (mm)	REINFORCEMENT AT SUPPORT		REINFORCEMENT AT SPAN	
	ALONG LONGER DIR.	ALONG SHORTER DIR.	ALONG LONGER DIR.	ALONG SHORTER DIR.
S1	8 TOR @ 150 C/C	8 TOR @ 250 C/C	8 TOR @ 150 C/C	8 TOR @ 250 C/C

SITE PLAN FOR PROP. G-3 FLAT TYPE RESIDENTIAL BLDG. OF 1) SUKANTA DASGUPTA, SO L.T. JAGATBANDHU DASGUPTA, 2) SUKLA MUKHERJEE, W/O DHIRAJ MUKHERJEE, IN MOUZA - NARI, LL. NO. - 70, C.S. PLOT NO. - 588/589, R.S. PLOT NO. - 589/4152, L.R. PLOT NO. - 1171, L.O.P. NO. - 61, L.R. KH. NO. - 42355, 43888, AT MAHALLA - HAFIZULLA BERH, WARD NO. - 08, HOLDING NO. - 328, P.S. - BARDHAMAN & DIST. - PURBA BARDHAMAN, UNDER THE MUNICIPALITY OF BURDWAN.

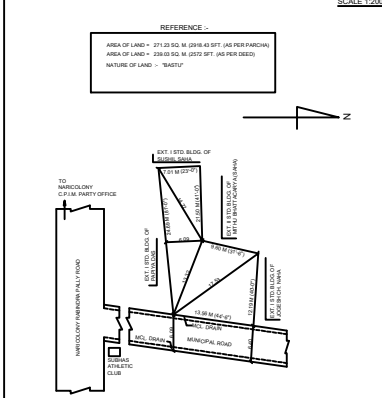

OFFICE USE (ULB) (B.M.)

AREA STATEMENT		AREA STATEMENT OF FLAT PER FLOOR
AREA OF LAND	= 271.23 sq. m. (2918.43 sq. ft.) AS PER PARCHA	
AREA OF LAND	= 239.03 sq. m. (2572.26 sq. ft.) AS PER DEED	
PROPOSED COVERED AREA IN GROUND FLOOR (CAR PARKING)	= 119.47 sq. m. = 1285.49 sq. ft.	
PROPOSED COVERED AREA IN 1ST FLOOR	= 119.47 sq. m. = 1285.49 sq. ft.	
PROPOSED COVERED AREA IN 2ND FLOOR	= 119.47 sq. m. = 1285.49 sq. ft.	
PROPOSED COVERED AREA IN 3RD FLOOR	= 119.47 sq. m. = 1285.49 sq. ft.	
TOTAL COVERED AREA (PARKING WITH 1ST TO 3RD FLOOR)	= 477.88 sq. m. = 5141.96 sq. ft.	
TOTAL COVERED AREA (1ST TO 3RD FLOOR WITHOUT PARKING)	= 358.41 sq. m. = 3865.49 sq. ft.	
TOTAL COVERED AREA (1ST -2ND -3RD) FLOOR (WITHOUT STAIR CASE)	= 335.85 sq. m. = 3613.85 sq. ft.	
GROUND COVERAGE	= 49.98 %	
F.A.R.	= 1.50	
NO. OF FLOOR	= (G + 3)	

FLOOR	FLAT NO.	FLAT AREA
1ST	FLAT - A1	20.87 sq.m.
	FLAT - A2	20.87 sq.m.
2ND	FLAT - A1	20.87 sq.m.
	FLAT - A2	20.87 sq.m.
3RD	FLAT - A1	20.87 sq.m.
	FLAT - A2	20.87 sq.m.

NO.	DESCRIPTION	QTY	UNIT
1	1:10	100	sq.m.
2	1:10	100	sq.m.
3	1:10	100	sq.m.
4	1:10	100	sq.m.
5	1:10	100	sq.m.
6	1:10	100	sq.m.
7	1:10	100	sq.m.
8	1:10	100	sq.m.
9	1:10	100	sq.m.
10	1:10	100	sq.m.
11	1:10	100	sq.m.
12	1:10	100	sq.m.
13	1:10	100	sq.m.
14	1:10	100	sq.m.

COLOUR USED :-  
 PROPOSED WORK = BLACK THICK  
 EXISTING WORK = RED  
 DRAINAGE WORK = RED DOTTED  
 WATER SUPPLY = BLACK DOTTED

