

**WATER CONNECTION PLAN FOR PROPOSED B+G+IV STORIED RESIDENTIAL BUILDING
 PLAN OF SRI KRITI BANERJEE, SRI MIHIR ROY & M/S. K.M.R. CONSTRUCTION TO BE
 CONSTRUCTED AT R.S. PLOT NO. - 738, 740, 741, 742, 743, 744, 745, 746, 747, 760
 / 966 & 760 / 967, CORRESPONDING, L.R. PLOT NO. - 1100, 1102, 1103, 1104, 1105,
 1106, 1107, 1111, 1112, 1113 & 1113/1183, L.R. KHATIAN NO.-1108, 154 & 1230,
 UNDER MOUZA- GOPALPUR, J.L. NO. - 10, P.S. - ASANSOL, DIST - PASCHIM
 BARDHAMAN WARD NO.-54, UNDER ASANSOL MUNICIPAL CORPORATION**

1. LAND AREA- (AS PER DEED) - 66 DECIMAL = 2670.92 sqm.
2. LAND AS PER MUTATION - 66 DECIMAL = 2670.92 sqm.
3. LAND AREA APPURTENANT TO BUILDING
 UNDER CONSTRUCTION : 27.76 DECIMAL = 1123.40 sqm.
4. TOTAL AREA OF OWNER'S LAND LEFT VACANT FOR
 FUTURE DEVELOPMENT : 38.24 DECIMAL = 1547.52 sqm.

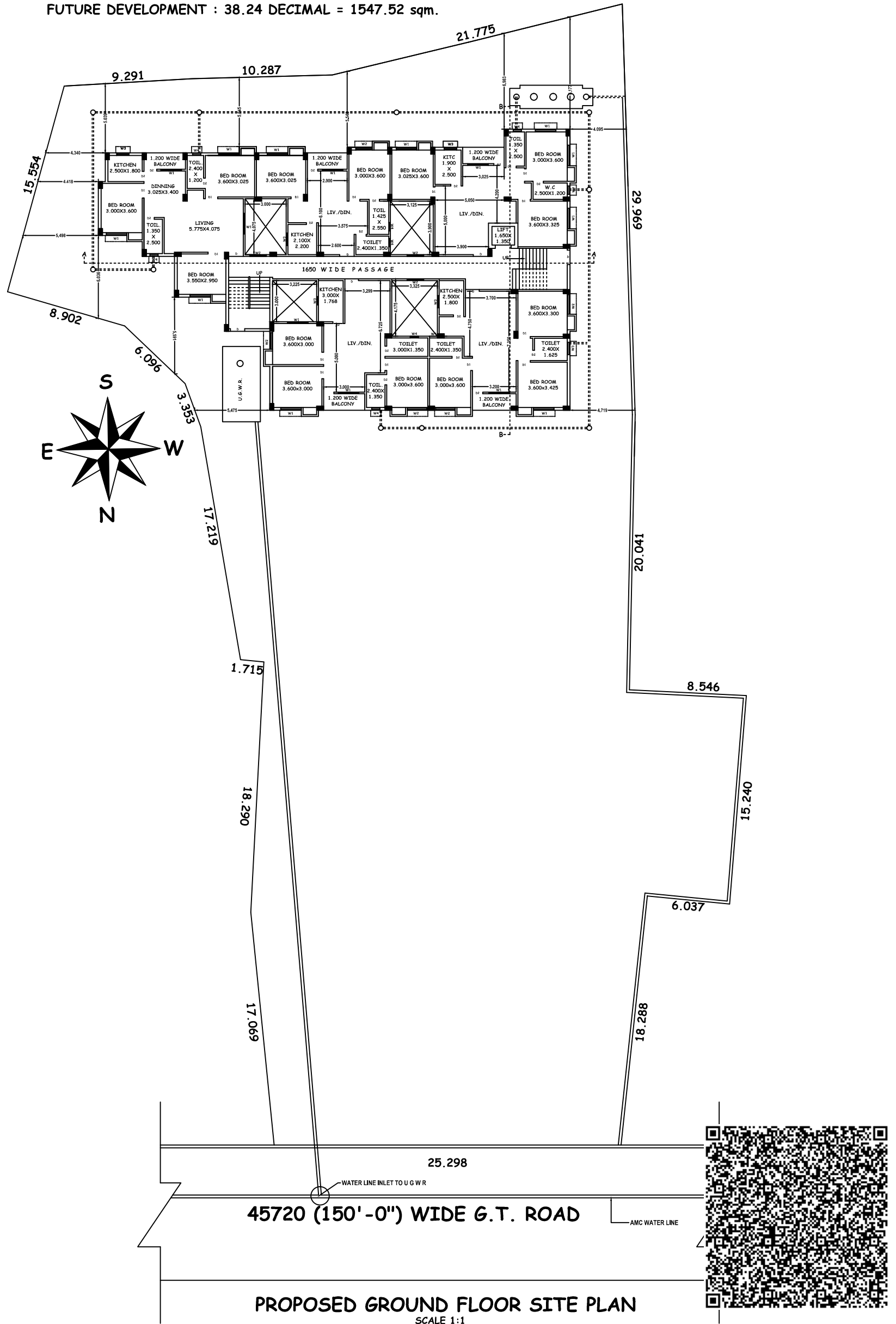

PROPOSED GROUND FLOOR SITE PLAN
 SCALE 1:1