

SS DEVELOPER

CIVIL CONSTRUCTION, PROMOTORY & LAND DEVELOPMENT

59/A BIDHAN NAGAR, MEDINIPUR, DIST - PASCHIM MEDINIPUR

TO WHOM IT MAY CONCERN

Ref..... Below shown is the location map of our project "KRISH APARTMENT" situated at.....
Mouza - Narampur, JL No. 174, RS Plot No. 15 (part), LR Plot No. 838 (part), Khatian
No-2693 & 2692, in Holding No. 638, at street Saratpally, Ward No. 23, Pin 721101:

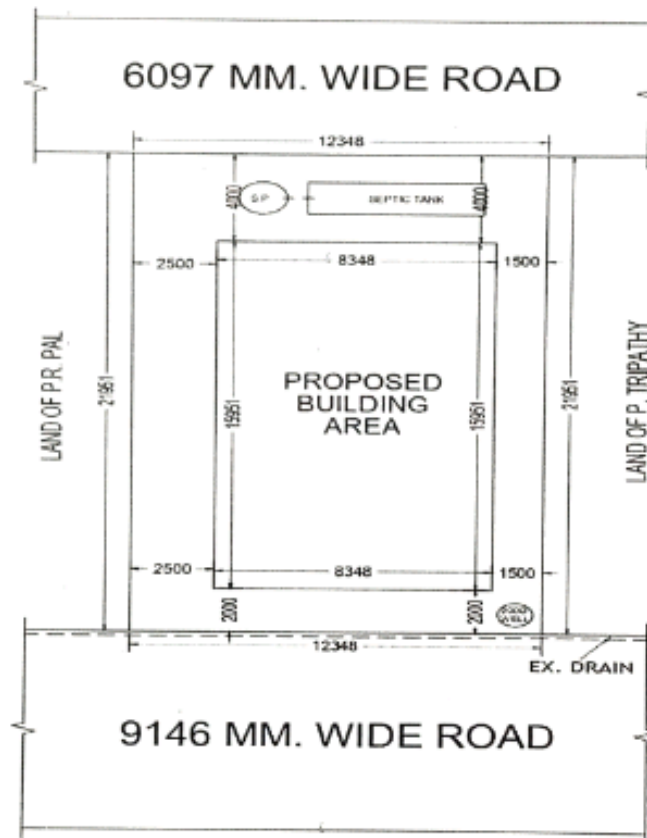

SITE PLAN
SCALE- (1 : 200)
DIMENSION ARE IN MM.

Latitude: 22.426980, Longitude: 87.324140

For M/s SS Developer:

SS DEVELOPER
Soumen Samanta
Partner

Soumen Samanta
Partner