

PROPOSED G+IV STORIED RESIDENTIAL CUM COMMERCIAL BUILDING PLAN AT MOUZA - JAGANNATHPUR , J.L. NO. - 51, L.R. DAG NO.- 602, L.R. KHATIAN NO. -2653 & 2654, HOLDING NO. - 573 ,ROAD - TEGHARI ,WARD NO. - 08, P.S. - SONARPUR, DIST-24 PGS.(S), UNDER RAJPUR SONARPUR MUNICIPALITY.

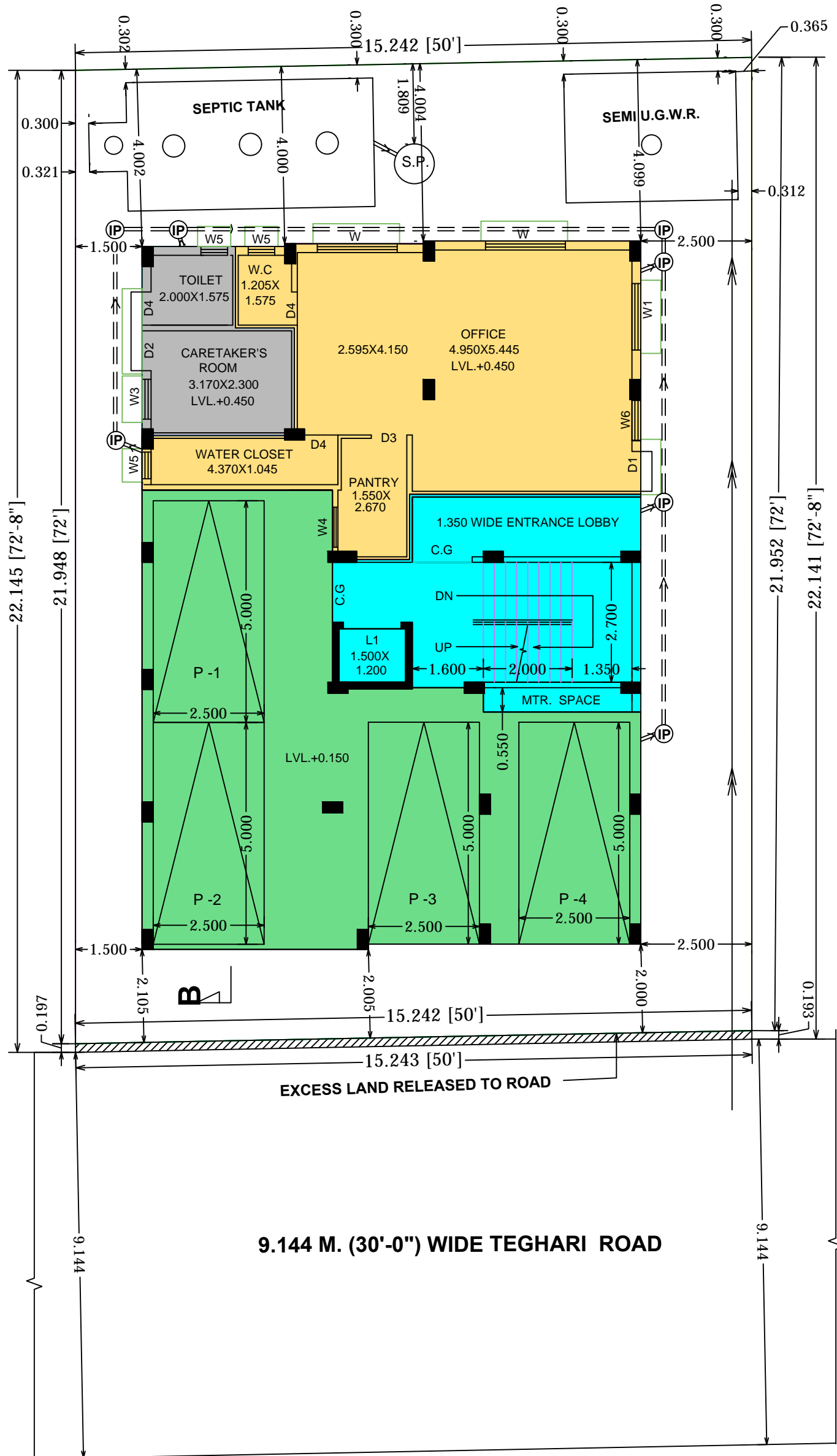

GROUND FLOOR PLAN
SCALE - 1:100

COMMERCIAL AREA STATEMENT

MKD.	CARPET AREA	BUILT UP AREA	SUPER BUILT UP AREA
OFFICE	530 SFT.	576 SFT.	720 SFT.

