

SITE PLAN & HOUSE WATER SUPPLY LAYOUT DRAWING SHOWING OF M/s SUPER CONSTRUCTION A PARTERSHIP FIRM REPRESENTED BY ITS PARTNERS (1) SRI. BHARAT PRASAD SHAW S/O LATE GULAB SHAW , (2) SRI. BINOD KUMAR SHAW , (3) SRI. AMIT KUMAR SHAW , & (4) SRI. ASHISH KUMAR SHAW ALL ARE SONS OF SRI. BHARAT PRASAD SHAW AT - PUNURI ROAD , G.T. ROAD , KULTI -713343 , DIST- PASCHIM BARDHAMAN ,(W.B.) ON R.S. & L.R. PLOT NO- 741/1120 ,742 , L.R. KHATIAN NO. - 1640 ,1641 ,1647 ,1596 ,1597 ,1621 ,1626 ,1627 ,, MOUZA- PUNURI , J.L. NO- 22 , WARD NO- 62 , BOROUGH - X , P.S.-KULTI , UNDER ASANSOL MUNICIPAL CORPORATION.

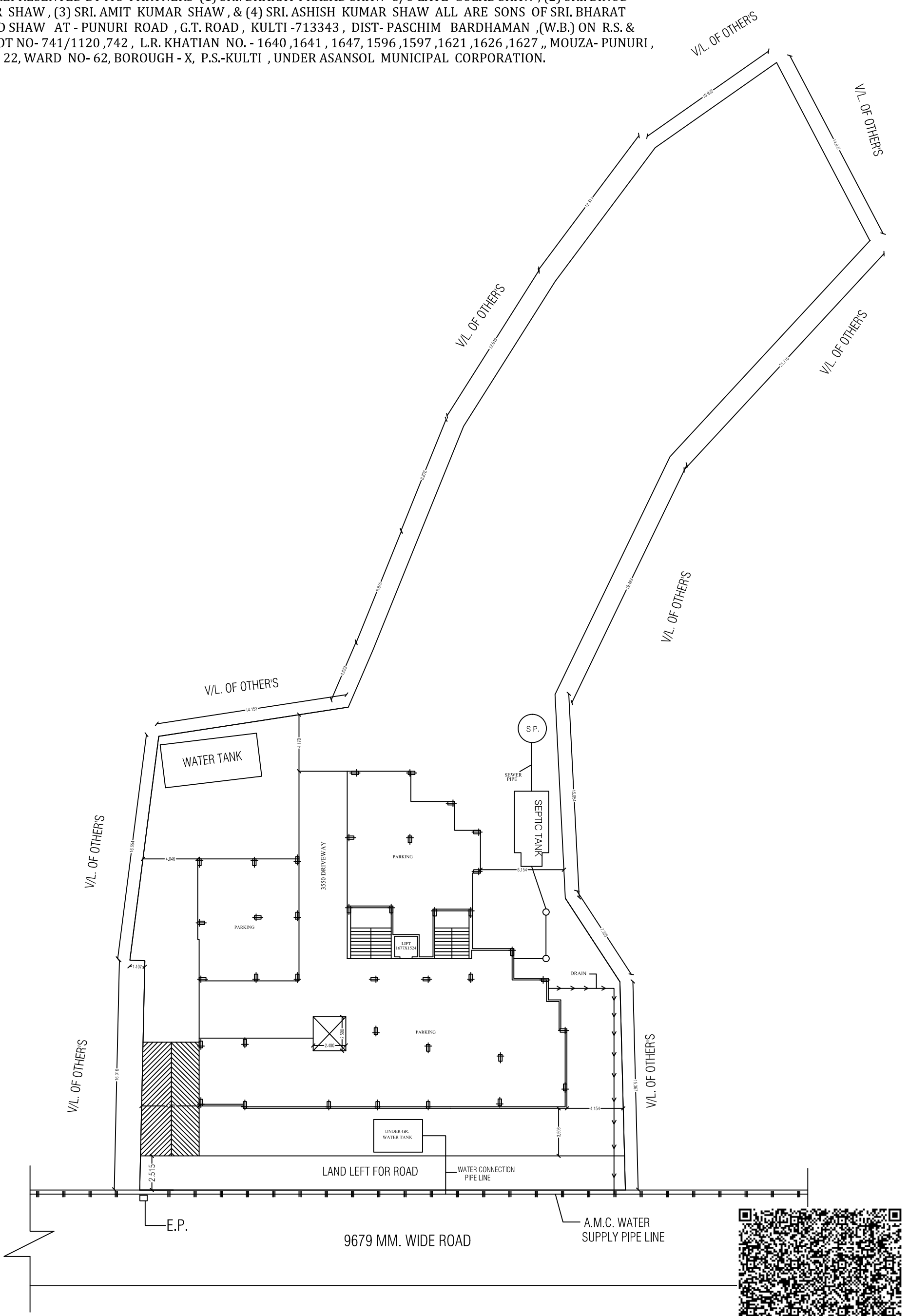

SITE PLAN & HOUSE WATER SUPPLY LAYOUT DRAWING