

**WATER CONNECTION PLAN FOR PROPOSED G+IV STORIED RESIDENTIAL CUM COMMERCIAL BUILDING PLAN OF SRI ADITYA VIKRAM CHAMARIA, SRI ANKIT SARAF & SMT. SUNITA DEBI MAHESHWARI TO BE CONSTRUCTED AT R.S.PLOT NO.-5140 & 5142/6065, CORRESPONDING L.R. PLOT NO.- 4731 & 4739, L.R. KHATIAN NO.-9196,9204 & 9208, UNDER MOUZA- SEARSOL, J.L. NO.-17, P.S.-RANIGANJ, DIST.-PASHCHIM BARDHAMAN, IN WARD NO.- 34, UNDER ASANSOL MUNICIPAL CORPORATION.**

- 1. LAND AREA AS PER DEED 27.27 DECIMAL = 1103.88 sqm.
- 2. LAND AREA AS PER PARCHA 27.00 DECIMAL = 1092.65 sqm.

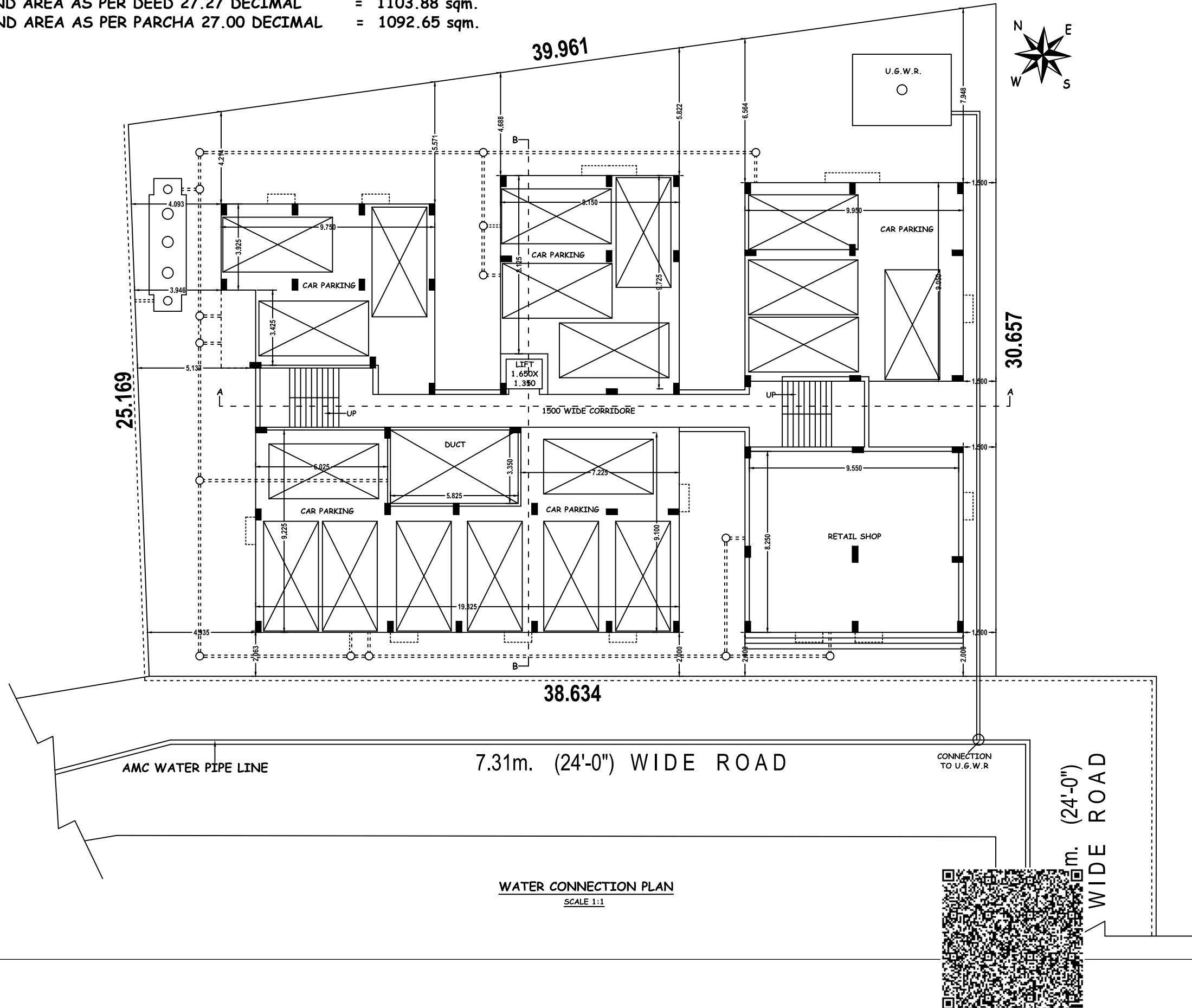

**WATER CONNECTION PLAN**  
SCALE 1:1