



दो रुपया

Admissible under Rule 2) duly
 stamped (in case of stamp
 does not require stamp duty)
 under the Indian Stamp Act
 1899 Schedule No. 25 (a)
 or under the Bengal Stamp
 (Amendment) Act 1942 Schedule
 No. 25 (a)

Fees paid as under A 34/

Registering Officer

12 MAR. 1969

24-PARGANAS
 ALIPORE
 1. SEP. 1968
 WITH JOINT (K...)

has been paid on the original
 whereon this is a duplicate of
 the original.

PARTITION DEED

Sub-Registrar's office Alipore. This instrument was made this 25th day of August 1944 between
 1. Babu Madin Chandra Mukerjee son of Aarita Lal Mukerjee deceased by
 caste Brahm in by profession service-holder residing at Barisha P.S.
 Behala Sub-Registrar's office, Alipore Dist. 24-Parganas hereinafter
 called the first party and Babu Jatindra Nath Mukerjee son of Aarita
 Lal Mukerjee deceased by caste Brahm in by profession service-holder
 residing at Barisha P.S. Behala Sub-Registrar's office Alipore Dist.
 24-Parganas hereinafter called the 2nd party and Babu Narendra Nath
 Mukerjee son of Aarita Lal Mukerjee deceased by caste Brahm in by
 profession service holder residing at Barisha P.S. Behala Sub-Regis-
 trar's office Alipore hereinafter called the third
 party and Babu Bro... son of Aarita Lal Mukerjee
 deceased by caste... service holder residing at
 Barisha P.S. Behala Sub-Registrar's office Alipore Dist. 24-Parganas
 hereinafter call... Babu Indira Nath Mukerjee son
 of Aarita Lal Mukerjee deceased by caste Brahm in by profession
 leader residing... Sub-Registrar's office Alipore

1970
 24-PARGANAS, ALIPORE

Stamp No. 336 of 21.8.44
Valued at Rs. 2000/-
old to Indra Nath Mukherjee
Secy

Indra Nath Mukherjee
Stamp Vendor

Presented for registration in Judge's Court, Alipore
25th
3 A.M. or P.M. on the day
of August 1944 at the office of
the Sadar Joint Sub-Registrar
at Alipore by Sudin Chandra Mukherjee
Executant or Claimant or attor- one of the
ney for Indra Nath Mukherjee
a Power of attorney No
for 19 authentication of the
Sub-Registrar at



Sudin Chandra Mukherjee

Sadar Joint Sub-Registrar
of Alipore

Admitted by

(1) Sudin Chandra Mukherjee (2) Jatendra Nath Mukherjee
Sudin Chandra Mukherjee (3) Narendra Nath Mukherjee
Indra Nath Mukherjee & (4) Jindra Nath Mukherjee
Sons of late Ananta Lal Mukherjee
all of Barisal
Thana Behala
District 24 Parganas
By caste Brahmin
By profession Service & no 5 Pleader
Indra Nath Mukherjee

Indra Nath Mukherjee
Sudin Chandra Mukherjee
Sons of late Jayini Charan Mukherjee
of the Barisal Caste
By profession Service & no 5 Pleader
Sudin Chandra Mukherjee

200/24/100L/D
F
23 FEB 1970
24-PARGANAS, ALIPORE.

COURT OF M... ALIPORE
FIL
15 SEP. 1965
24-PARGANAS

12 MAR. 1969

Dist. 24-Parganas herein after called the fifth party. ^{Witnessed} that the aforesaid Anrita Lal Mukerjee died leaving five sons namely the First party, ^{the Second Party, 3rd party, 4th party} and the fifth party and also the properties of Schedules A & B some of which he got by inheritance, some of which by purchase and some by purchase in the behalf of others and the 1st party, 2nd party, 3rd party, 4th party and the fifth party inherited the said properties as heirs of their deceased father and had been in joint possession thereof; that each of the above parties has got one fifth share in the said properties; that the third party at present has been living at a distant and different place and as it has now become inconvenient for the five parties to jointly possess and enjoy the properties ^{so they amicably divide these properties} among them as per details give below in schedules. All these properties were acquired and a building standing on one of the properties was built by the said Babu Anrita Lal Mukerjee deceased who had been in possession thereof. In the schedule A together with two maps is given the description of the land and a Pucca dwelling house standing thereon shown in the said maps and this property Schedule A is allotted to all the parties according to their shares and each party's share is shown in the said map in different colours. The portion marked A with measurement as shown in the said Maps is allotted to 1st party. The portion marked B with measurement as shown in the said Maps is allotted to 2nd Party and the portion marked C with measurement as shown in the said Maps is allotted to 3rd party and the portion marked D with measurement as shown in the said Maps is allotted to 4th party and the portion marked E with measurement as shown in the said Maps is allotted to 5th party and each party would get the portion allotted to each party's share exclusively save and except. The common boundary and common passage is shown in the said Maps and all the parties have agreed to the division of all the properties.



[Handwritten signature]
Sadar Joint Sub-Registrar
of Alipore. ১১০



their own convenience. It is also stated that the existing outlets for rain water and the like are to be kept open for all times to come by the parties or their heirs and administrators.

In the schedule B is given the full description of all other landed properties Khwa and tenanted acquired by the said Babu Aarita Lal Mukerjee deceased through purchase in his own name, in the benefit of others and through inheritance.

Schedule B properties are valued in consultation with all the parties according to the present day Market Valuation and are allotted to the parties according to their shares in schedules C, D, E, F and G.

Schedule C properties are exclusively allotted to the 1st party.

Schedule D properties are exclusively allotted to the 2nd party.

Schedule E properties are exclusively allotted to the 3rd party.

Schedule F properties are exclusively allotted to the 4th party.

Schedule G properties are exclusively allotted to the fifth party.

Movable properties left by the said Babu Aarita Lal Mukerjee deceased, had already been divided long ago. It is agreed amongst the parties that each party will absolutely get and exclusively enjoy the properties allotted to his respective share, and the other four parties will cease to have any interest in them. Value of the entire estate consisting of properties of Schedule A & B is estimated through expert's opinion at Rs.10,000/- (Ten thousand) and the value of the share of each party is estimated at Rs.2,000/-. It is further agreed that the title deeds of the properties in Schedule A will remain with First



party and the title deeds of properties mentioned in Schedule C will remain with 1st party, the title deeds of properties mentioned in Schedule D will remain with 2nd party and the title deeds of properties mentioned in schedule E will remain with 3rd party and that of properties mentioned in schedules F & G will remain with fourth & fifth parties respectively. That each of the parties will produce documents for the use of the other party or parties whenever required and each party will get his name recorded separately in the Zamindar's sherista and Municipal Office in respect of his separate properties and will pay separately Zamindar's rent, Municipal tax in respect of his separate properties from his own pocket without any concern of the other four parties. Each of the five parties has got separate possession of the respective properties allotted separately to them from this day and each party has got no interest left in the properties allotted to the other four parties.

SCHEDULE A.

All that piece and parcel of Barga and Bastu Land situate at the Mouza Paschim Barisha, P.S. Behala Sub-Registry Alipore Dist. 24-Parganas appertaining to C.S. Khatian Nos. 124 and 788 and 2168 measuring .45 cents C.S. Plots Nos. 469, 235 and 469/810 J.L. 19 Touzie 1-4, 5, 6, 8-10, 12-16 and 235 of the Alipore Collectorate. Shares of the parties are shown in the plans annexed herewith and marked A, B, C, D, E respectively.

All that piece and parcel of garden and Drain situate at the Mouza Paschim Barisha P.S. Behala Sub-Registry Alipore Dist. 24-Parganas appertaining to C.S. Khatian 1998 measuring .52 cents C.S. plots Nos. 471 and 472 J.L. 19 Touzie 1-6, 8-10, 12-16 shares of the parties are shown in the plan annexed herewith and marked B, C, D, E respectively.



12 MAR. 1969



cents situate at the Mouza Paschim Barisha P.S.Behala J.L.19 Dist.24-Parganas Khatian Nos.124 and 788 Plot Nos.467 and 470.

2. All that piece and parcel of garden land measuring .20 cents situate at the Mouza Paschim Barisha P.S.Behala J.L.19 Dist.24-Parganas Khatian Nos.9, 65 and 126 Plot Nos.458.

3. All that piece and parcel of garden land measuring .35 cents situate at the Mouza Paschim Barisha P.S.Behala J.L.19 Dist.24-Parganas Khatian No.1851 Plot Nos.3084, 3831.

4. All that piece and parcel of garden and tank measuring .91 cents situate at the Mouza Paschim Barisha P.S.Behala Dist.24-Parganas Khatian No.1453 Plot Nos.3084, 3830 and 3085.

5. All that piece and parcel of garden land measuring .61 cents situate at the Mouza Paschim Barisha P.S.Behala Dist.24-Parganas Khatian Nos.10,66 and 127 Plot No.3084.

6. All that piece and parcel of Danga and tank measuring .66 cents situate at the Mouza Paschim Barisha P.S.Behala Dist.24-Parganas Khatian Nos.787/1 Plot Nos.3277 and 3278.

7. All that piece and parcel of garden and Doha measuring .82 cents situate at the Mouza Paschim Barisha P.S.Behala Dist.24-Parganas Khatian No.3350 Plot Nos.3277 and 3280.

8. All that piece and parcel of garden, Bastu Tank and Doha measuring .70 cents situate at the Mouza Paschim Barisha P.S.Behala Dist.24-Parganas Khatian No.1125 Plot Nos.3675, 3676, 3677 and 3676/3924 recorded in Sub Khatian No.1126.

9. All that piece and parcel of Bastu, Doha and low land measuring .81 cents situate at the Mouza Parba Barisha P.S.Behala J.L.23 Dist.24-Parganas Khatian No.335 Plots Nos.2079, 2080 and 2083 recorded in Sub Khatian 336.

10. All that piece and parcel of Danga land measuring .12 cents situate at the Mouza Parba Barisha P.S.Behala Dist.24-Parganas J.L.23 Khatian No.473 Plot No.3075.



11. All that piece and parcel of garden land measuring .19 cents situate at the Mouza Furka Barisha P.S.Behala Dist.24-Parganas J.L.23 Khatian Nos.875 and 876 Plot No.2078.

12. All that piece and parcel of Garden land and tank measuring 1.93 Acre situate at the Mouza Paschim Barisha P.S.Behala Dist.24-Parganas J.L.19 Khatian Nos.15, 71 and 162 Plot No.3274,3275 and 3276.

13. All that piece and parcel of Garden land measuring .17 cents situate at the Mouza Paschim Barisha P.S.Behala Dist.24-Parganas J.L.19 Khatian No.212 Plot No.453.

KHAI PADDY LANDS.

14. All that piece and parcel of paddy land measuring 1.49 Acre situate at the Mouza Paschim Barisha P.S.Behala Dist.24-Parganas J.L.19 Khatian No.1313 Plot No.1830.

15. All that piece and parcel of paddy land measuring .49 cents situate at the Mouza Paschim Barisha P.S.Behala Dist.24-Parganas J.L.19 Khatian No.1366 Plot No.1366.

16. All that piece and parcel of paddy land measuring 1.15 Acre situate at the Mouza Paschim Barisha P.S.Behala Dist.24-Parganas Khatian No.740 Plot Nos.1690 and 1696.

17. All that piece and parcel of paddy land measuring .50 cents situate at the Mouza Paschim Barisha P.S.Behala Dist.24-Parganas Khatian No.872 Plot Nos.1647 and 1649.

18. All that piece and parcel of paddy land measuring .12 cents situate at the Mouza Paschim Barisha P.S.Behala Dist.24-Parganas Khatian No.1304 Plot No.3118.

19. All that piece and parcel of paddy land measuring 2.39 Acre situate at the Mouza Paschim Barisha P.S.Behala Dist.24-Parganas Khatian Nos.597 and 1645 Plot Nos.1609, 1622, 1739, 1823, 1898, 1907 1997 and 1199.

20. All that piece and parcel of paddy land measuring 1.22 Acre situate at the Mouza Paschim Barisha P.S.Behala Dist.24-Parganas

Volume No. 34



Khatian Nos.453 and 1102 Plot Nos.1602, 1636 and 1645 and 1330.

21. All that piece and parcel of paddy land measuring .22 cents situate at the Mouza Paschim Barisha P.S.Behala Dist.24-Parganas Khatian No.2134 Plot No.3072.

22. All that piece and parcel of paddy land measuring .60 cents situate at the Mouza Paschim Barisha P.S.Behala Dist.24-Parganas Khatian No.1541/1 and Plot Nos.1333 and 3088.

23. All that piece and parcel of paddy land measuring .23 cents situate at the Mouza Paschim Barisha P.S.Behala Dist.24-Parganas Khatian No.1175 and Plot No.1690,2320.

TENANTED LANDS.

24. All that piece and parcel of paddy land measuring .57 cents situate at the Mouza Paschim Barisha P.S.Behala Dist.24-Parganas Khatian No.1108 Plot No.1029, 2213.

25. All that piece and parcel of paddy land measuring .50 cents situate at the Mouza Kalagatchia P.S.Nobestollah Dist.24-Parganas Khatian Nos.29, 79 and 129 Sub Khatian 255 Plot Nos.335 and 336.

26. All that piece and parcel of paddy land measuring .42 cents situate at the Mouza Paschim Barisha P.S.Behala Dist.24-Parganas Khatian No.1105 Plot No.2619.

27. All that piece and parcel of paddy land measuring 3.70 Acre situate at the Mouza Paschim Barisha P.S.Behala Dist.24-Parganas Khatian No.1103 Plot Nos.1795 and 1796 2227.

28. All that piece and parcel of paddy land measuring 2.28 Acre situate at the Mouza Paschim Barisha P.S.Behala Dist.24-Parganas Khatian No.1104 Plot No.1803.

29. All that piece and parcel of paddy land measuring 1.07 Acre situate at the Mouza Paschim Barisha P.S.Behala Dist.24-Parganas Khatian No.742 Plot No.2128.

30. All that piece and parcel of paddy land measuring .77 cents situate at the Mouza Paschim Barisha P.S.Behala Dist.24-Parganas



Khatian Nos.1004 and 741 Plot Nos.1119 and 1114.

31. All that piece and parcel of Bestu land measuring .42 cents situate at the Mouza Paschim Barisha P.S.Behala Dist.24-Parganas Khatian No.131 Sub Khatian 132 Plot No.3281.

32. All that piece and parcel of Bestu, Doba, Danga Tank etc., measuring 1.41 Acre situate at the Mouza Paschim Barisha P.S.Behala Dist.24-Parganas Khatian No.1230 Sub Khatians 1231 and 1232. Plot Nos. 3108, 3109, 3110, 3111, 3112, 3493 and 3494.

33. All that piece and parcel of Bestu land measuring 0.4 cents situate at the Mouza Paschim Barisha P.S.Behala Dist.24-Parganas Khatian No.1002 Sub Khatian 1003. Plot No.1700.

34. All that 1/2 share in the piece and parcel of Bestu land measuring .84 cents situate at the Mouza Paschim Barisha P.S.Behala Dist.24-Parganas Khatian No.498 and 1383 Sub Khatian No.1384 Plot No.3025.

35. All that piece and parcel of paddy land measuring 1.19 acre situate at the Mouza Paschim Barisha P.S.Behala Dist.24-Parganas Khatian No.1647 Plot No.2110.

36. All that piece and parcel of Doba and Danga measuring .68 cents situate at the Mouza Paschim Barisha P.S.Behala Dist.24-Parganas Khatian No.1648 Plot No.3126, 3127.

37. All that piece and parcel of Bestu land measuring .36 cents situate at the Mouza Paschim Barisha P.S.Behala Dist.24-Parganas Khatian No.1649 Plot No.1636.

38. All that piece and parcel of Bestu land measuring .14 cents situate at the Mouza Paschim Barisha P.S.Behala Dist.24-Parganas Khatian No.128 Plot No.1120.

39. All that piece and parcel of Garden land measuring .13 cents situate at the Mouza Paschim Barisha P.S.Behala Dist.24-Parganas Khatian No.2303 Sub Khatian 2303 Plot No.3196.

Volume No. 34



40. All that piece and parcel of Bastu land measuring .73 cents situate at the Mouza Paschim Barisha P.S.Behala Dist.24-Parganas Khatian No.1541/2 Plot No.1350.
41. All that piece and parcel of Bastu and Doba measuring .30 cents situate at the Mouza Purba Barisha P.S.Behala Dist.24-Parganas Khatian No.333 Sub Khatian No.334 Plot Nos.2073 and 2074.
42. All that piece and parcel of paddy land measuring .93 cents situate at the Mouza Purba Barisha P.S.Behala Dist.24-Parganas Khatian No.416 Sub Khatian No.417 Plot No.3119.
43. All that piece and parcel of paddy land measuring 1.49 Acre situate at the Mouza Purba Barisha P.S.Behala Dist.24-Parganas Khatian No.482 Sub Khatian No.483 Plot No.3013.

C SCHEDULE PROPERTY OF 1ST PARTY.

1. The A marked portion of the property mentioned in the A Schedule of this deed with two Pucca rooms upstairs and downstairs, two covered Verandah upstairs and downstairs, one covered Verandah in front of the room with roof, one privy and the back portion Bank with walls and open space running upto the Bank opposite to the covered Dahan of the Fifth party and open land on the south of the common passage and on the east of the bank allotted to Fifth party as shown in the plans annexed herewith.
2. All that piece and parcel of paddy land situate at the Mouza Paschim Barisha P.S.Behala Dist.24-Parganas measuring 1.34 Acre appertaining to C.S.Khatian Nos.453 and 1102 and C.S.Plot Nos.1602, 1636, 1645 and 1330 Khas and in under Khatian Nos.1103, 1104, 1105 and 1108 paddy Khas measuring 6.97 acres tenanted. Annual Rental of Rs.14/6/3 is payable to the Touzie holders 1-6, 8-10, 12-16.
3. All that piece and parcel of tenanted Bastu and Doba land measuring .30 cent situate at the Mouza Purba Barisha P.S.Behala Dist.24-Parganas appertaining to C.S. Khatian No.333 under Khatian



4. All that piece and parcel of Rent free paddy land measuring .32 cent situate at the Mouza Paschim Khatian Nos. 557 and 1646 and C.S. Plot No. 1603
5. All that piece and parcel of Danga land and tank measuring .66 cents situate at the Mouza Paschim Barisha P.S. Behala Dist. 24-Parganas appertaining to C.S. Khatian No. 787/1 and Plot Nos. 3277 and 3278. Annual Rental of Rs. 5/10/- is payable to Touzie holders Nos. 1-4, 5, 6-8, 10, 12-16. A passage 8 ft. wide running from the Municipal road right upto this land and Plot No. 3279 allotted to fifth party over C.S. Plot No. 3274 on the eastern boundary line of the same is kept common by the parties. This passage may be used by the parties in taking Electric wires and for all other right of easements..
6. All that piece and parcel of Danga land measuring .20 cents situate at the Mouza Paschim Barisha P.S. Behala Dist. 24-Parganas appertaining to C.S. Khatian Nos. 9, 65 and 126 and Plot No. 458. Annual Rental of Rs. 1/14/6 is payable to Touzie holders Nos. 3, 4 and 5. The right of way to this land will have along the east north and western bank of the tank allotted to fifth party.
7. All that piece and parcel of Danga land measuring .17 cents situate at the Mouza Paschim Barisha P.S. Behala Dist. 24-Parganas appertaining to C.S. Khatian No. 212 and Plot No. 453. Annual rental of Rs. 1/3/3 is payable to the estate of Dargacharan Mukerjee & others.
8. All that piece and parcel of partly rentfree and partly rented Khas Danga land measuring .19 cents situate at the Mouza Paschim Barisha P.S. Behala Dist. 24-Parganas appertaining to C.S. Khatian No. 875 and 876 and Plot No. 3078.

D. SCHEDULE PROPERTY ALLOTTED TO 2ND PARTY.

1. The B marked portion of the property mentioned in the Schedule A of this deed with two good rooms upstairs and downstairs, two pieces Balans upstairs and downstairs, one covered Verandah in front of the Balan with roof, stairs leading upto the 2nd floor, staircase



free and back portion rack with wall and one privy and two oven lands marked B, shown in the plans annexed herewith.

2. All that piece and parcel of Khas paddy land situate at the Mouza Paschim Barisha P.S.Bahala Dist.24-Parganas appertaining to C.S. Khatian No.1175 and Plot No.1690/2320 measuring .23 cents and all that piece and parcel of tenanted paddy land situate at the Mouza Purba Barisha P.S.Bahala Dist.24-Parganas appertaining to C.S.Khatian No.416 under Khatian No.417 Plot No.3119 measuring .93 cents. Annual Rental of Rs.6/5/6 pie is payable to the estate of Chandra Sekher Das Naskar and Jotindra Nath Das Naskar of Sarsoonsah.

3. All that piece and parcel of paddy land measuring .60 cents situate at the Mouza Paschia Barisha P.S.Bahala Dist.24-Parganas appertaining to C.S.Khatian No.1541/1 and Plot No.1333 and 3088 and tenanted Danga land measuring .23 cents situate at the same Mouza appertaining to C.S.Khatian No.1541/2 and Plot No.1330. Annual rental of Rs.6/12/0 is payable to the estate of Rabindra Nath Boychowdhury and others of Barisha, Kumar Sanat Kumar Mukerjee and others.

4. All that piece and parcel of Khas rent free paddy land measuring .74 cents situate at the Mouza Paschim Barisha P.S.Bahala Dist.24-Parganas appertaining to C.S.Khatian Nos.557 and 1646 and Plot No.1622.

5. All that piece and parcel of tenanted Bastu land measuring .42 cents situate at the Mouza Paschim Barisha P.S.Bahala Dist.24-Parganas appertaining to C.S.Khatian No.131 and Sub Khatian 132 Plot No.3281. Annual rental of Rs.0/5/- is payable to Khas mahal Deptt.

6. All that 1/2 share in the piece and parcel of Bastu land measuring .34 cents situate at the Mouza Paschia Barisha P.S.Bahala Dist.24-Parganas appertaining to C.S.Khatian Nos.498 and 1383 and Plot No.3025. Recorded as liable to rent.

7. All that piece and parcel of Danga land measuring .04 cents and paddy land measuring .15 cents situate at the Mouza Paschim Barisha



P.S. Behala Dist. 24-Parganas appertaining to G.S. Khatians 1002 and 1003 and 1004 Plot Nos. 1300 and 1329. Annual rental of Rs. 2/- is payable to the estate of Durga Charan Mukerjee & others.

8. All that piece and parcel of tenanted Danga land measuring .12 cents situate at the Mouza Paschim Barisha P.S. Behala Dist. 24-Parganas appertaining to G.S. Khatian No. 2302 and under Khatian No. 2303 Plot No. 3196. Annual rental of Rs. 14/8 pies is payable to the estate of Sarat Chandra Dutta Chowdhury and others.

9. All that piece and parcel of 1/3rd share in Garden and Tank measuring 1-93 Acre situate at the Mouza Paschim Barisha P.S. Behala Dist. 24-Parganas appertaining to G.S. Khatian Nos. 15, 71, 162 and Plot Nos. 3274, 3275 and 3276. Annual rental of Rs. 16/14/- is payable to Touzie holders Nos. 3, 4 and 5.

10. All that piece and parcel of Khas Garden, B. stu and Tank measuring .70 cents situate at the Mouza Paschim Barisha P.S. Behala Dist. 24-Parganas appertaining to G.S. Khatian No. 1125 Sub Khatian 1126 and Plot Nos. 3675, 3676 3677 and 3676/3994. Annual rental of Rs. 5/6/- is payable to the estate of Sk. Jambur Ali and others.

B. SCHEDULE PROPERTY ALLOTTED TO 3RD PARTY.

1. The C marked portion of the property mentioned in the Schedule A of this deed with 4 pucca rooms in the upstairs and down-
and two silos uplairs and downlairs
stairs and the back portion extending upto the wall and common passage, and open land marked C in the west of the building and another plot marked C shown in the plans annexed herewith.

2. All that piece and parcel of Khas paddy lands measuring 1.15 Acre situate at the Mouza Paschim Barisha P.S. Behala Dist. 24-Parganas appertaining to G.S. Khatian No. 740 Plot No. 1690 and 1696 and tenanted paddy lands measuring 1.07 Acre situate at the same Mouza appertaining to G.S. Khatian Nos. 741 and 742 Plot Nos. 1114 and 2128. Annual rental of Rs. 12/- is payable to the estate of Kuser Sanat Kumer



Makerjee.

3. All that piece of land or rent free paddy lands measuring .40 cents situate at the Mouza Paschim Barisha P.S. Behala Dist. 24-Parganas appertaining to C.S. Khatian Nos. 557 and 1646 and Plot No. 1893.
4. All that piece and parcel of rent free tenanted Doba and Danga measuring .68 cents appertaining to C.S. Khatian Nos. 557 and 1646 and Sub Khatian No. 1648 and Plot No. 3126 and 3127 at Paschim Barisha P.S. Behala Dist. 24-Parganas.
5. All that piece and parcel of tenanted Bastu, Doba, Danga, Tank etc., measuring 1.41 Acre situate at the Mouza Paschim Barisha P.S. Behala Dist. 24-Parganas appertaining to C.S. Khatian No. 1230 and Sub Khatian Nos. 1231 and 1232 and Plot Nos. 3108, 3109, 3110, 3111, 3112 and 3493 and 3494. Annual rental of Rs. 17/3/- is payable to the estate of Jaynarain Chandra and others.
6. All that piece and parcel of 1/3rd share in Khas land and Tank measuring 1.93 Acre situate at the Mouza Paschim Barisha P.S. Behala Dist. 24-Parganas appertaining to C.S. Khatian Nos. 15, 71 and 162 and Plot Nos. 3274, 3275 and 3276. Annual rental of Rs. 16/14/- is payable to Touzie holders Nos. 3, 4 and 5.
7. All that piece and parcel of Khas Danga land measuring .61 cents situate at the Mouza Paschim Barisha P.S. Behala Dist. 24-Parganas appertaining to C.S. Khatian Nos. 10, 66 and 127 and Plot No. 3084 and tenanted Bastu land measuring .14 cents situate at the same Mouza appertaining to C.S. Khatian No. 128 and Plot No. 1120. Annual Rental of Rs. 3/- is payable to Touzie holders Nos. 3, 4 and 5.

SCHEDULE F PROPERTY ALLOTTED TO 4TH PARTY.

1. The D marked portion of the property mentioned in Schedule A of this deed with two rooms and one Balcony on the ground floor and open land on the west of the building and another piece of open land marked D shown in the plans annexed herewith.

Volume 10/34



[Handwritten signature]

Sadar Joint Sub-Registrar
of Alipore.



2. All that piece and parcel of Ehsa paddy land measuring .90 cents situate at the Mouza Paschim Barisha P.S. Behala Dist. 24-Parganas appertaining to C.S. Khatian No. 871 and Plot Nos. 1647 and 1649. Annual rental of Rs. 5/- is payable to Babu Chandri Chandra Ganguly of Barisha.
3. All that piece and parcel of Ehsa paddy land measuring .49 cents situate at the Mouza Paschim Barisha P.S. Behala Dist. 24-Parganas appertaining to C.S. Khatian No. 1366 and Plot No. 1366. Annual rental of Rs. 2/8/- is payable to the estate of Babu Parbati Nath Banerjee and others.
4. All that piece and parcel of Ehsa paddy land measuring .28 cents situate at the Mouza Paschim Barisha P.S. Behala Dist. 24-Parganas appertaining to C.S. Khatian No. 3284 Plot No. 3072. Annual rental of Rs. 1/8/- is payable to the estate of Jaynarain Chandra and others.
5. All that piece and parcel of rent free Ehsa paddy land measuring .42 cents situate at the Mouza Paschim Barisha P.S. Behala Dist. 24-Parganas appertaining to C.S. Khatian Nos. 557 and 1646 and Plot No. 1739.
6. All that piece and parcel of Ehsa and partly tenanted Bastu, Doha and low land measuring .81 cents situate at the Mouza Purba Barisha P.S. Behala Dist. 24-Parganas appertaining to C.S. Khatian No. 335 and Sub Khatian No. 336 and Plot Nos. 2079, 2080 and 2083. Recorded as liable to rent.
7. All that piece and parcel of tenanted paddy land measuring 1.49 cents situate at the Mouza Purba Barisha P.S. Behala Dist. 24-Parganas appertaining to C.S. Khatian Nos. 482 and Sub Khatian 481 and Plot No. 3015 Annual rental of Rs. 12/4/3 pias is payable to the estate of Jaynarain Chandra and others.
8. All that piece and parcel of rent free tenanted Bastu land measuring .36 cents situate at the Mouza Paschim Barisha P.S. Behala Dist. 24-Parganas appertaining to C.S. Khatian Nos. 557 and 1646 and Sub Khatian No. 1649 and Plot No. 1606.



9. All that piece and parcel of 3rd share in Khas land and tank measuring 1.93 Acre situated at the Mouza Paschim Barisha P.S. Bahala Dist. 24-Parganas appertaining to C.S. Khatian Nos. 71, 15 and 162 and Plot Nos. 3274, 3275 and 3276.

SCHEDULE G ALLOTTED TO FIFTH PARTY.

1. The B marked portion of the property mentioned in the A Schedule of this deed with one pucca room and one covered Verandah in front ~~with one pucca room and one covered Verandah~~ of the room with one paddy Gola and walls and the portion of open land in front of the building extending upto the common passage on the south and West and on the east upto Municipal road and another plot of open land as shown in the plans annexed herewith

2. All that piece and parcel of Khas paddy land measuring 1.49 cents situate at the Mouza Paschim Barisha P.S. Bahala Dist. 24-Parganas appertaining to C.S. Khatian No. 1313 and Plot No. 1830. Annual rental of Rs. 4/8/- is payable to the estate of Babu Prasanna Poychowdhuri of Barisha.

3. All that piece and parcel of Rent free Khas paddy lands measuring .51 cents situate at the Mouza Paschim Barisha P.S. Bahala Dist. 24-Parganas appertaining to C.S. Khatian Nos. 557 and 1646, Plot Nos. 1397/2297, 1159, 1823 and tenanted rent free paddy land at the same Mouza appertaining to C.S. Khatian 1647 Plot No. 2110 measuring 1.19 Acre.

4. All that piece and parcel of land and tank measuring .91 cents situate at the Mouza Paschim Barisha P.S. Bahala Dist. 24-Parganas appertaining to C.S. Khatian No. 1453 and Plot Nos. 3084/3830 and 3085. A common passage 8 ft. wide running from the south eastern corner of Plot No. 3084 extending towards the north and turning towards the east will touch Plot No. 3831 over C.S. Plot No. 3084/3830. Annual rental of Rs. 2/2/3 is payable to the estate of Durgacharan Mukherjee and others.

5. All that piece and parcel of Khas Garden Land and Dohs measuring .87 cents situate at the Mouza Paschim Barisha P.S. Bahala Dist. 24-Parganas appertaining to C.S. Khatian No. 2350 and Plot No. 3079 and 3080. Annual rental of Rs. 5/12/6 is payable to the estate of Jaynarain Chandra and others.

Volume No. 34

FILED
10 SEP. 1981
24-PARGANAS

6. All that piece and parcel of Khos Garden land measuring .35 cents situate at the Mouza Paschim Barisha P.S. Bahola Dist. 24-Parganas appertaining to G.S. Khatun No. 1851 and Plot No. 3084/3631. Annual rental of Rs. 2/2/3 pie is payable to the estate of Parbatimath Banerjee & ors.

7. All that piece and parcel of Kh a Danga lands measuring .12 cents situate at the Mouza Purba Barisha P.S. Bahola Dist. 24-Parganas appertaining to G.S. Khatun No. 473 and Plot No. 2075. Annual rental of Rs. 1/1/3 is payable to the estate of Jayram Chandra and others.

8. All that piece and parcel of 4/5 share in the tank and land measuring .38 cents situate at the Mouza Paschim Barisha P.S. Bahola Dist. 24-Parganas appertaining to G.S. Khatun No. 124 and 788 and Plot No. 467 and 470. Passage to Plot No. 467 will have along the ^{written} ~~written~~ bank of the tank abutting Plot No. 498. All the parties will have the right of easements in the aforesaid tank.

9. All that piece and parcel of Khos paddy land measuring .12 cents situate at the Mouza Paschim Barisha P.S. Bahola Dist. 24-Parganas appertaining to G.S. Khatun No. 2304 and Plot No. 3118. Annual rental of Rs. 0/5/4 is payable to the estate of Sarot Chandra Das Chowdhary and others.

FILED
12 MAR. 1989

Typed by :-
S.C. Mukerjee. 24.8.44.

Witnesses :-

Satish chandra Banerjee
Barisha

Sarkari Mukherjee
Barisha

Profulla Kumar Mukerjee
Barisha

Abdul Kumar Banerjee
Barisha.

Sudin Chandra Mukerjee
Sudra Nath Mukerjee
Narendra Nath Mukerjee
Bijendra Nath Mukerjee
Indranath Mukerjee

Volume No. 34



7

~~Ex. 111~~ Munsif's Court
 5th Alipore
 Suit No. 275 of 1965
 Filed by Plaintiff
 Exhibit No. 4

12.3.66

5th

Munsif's Court
 Alipore
 T Suit No. 321/65 of 1965
 Filed by Plaintiff
 on 15.9.65
 Exhibit No. 2

31.1.66

[Signature]
 Joint Sub-Registrar
 of Alipore



BOOK NO. I
 Volume No. 34
 Pages 4-26
 Being No. 1857
 For the Year 1964

Sadar Joint Sub-Registrar
 of Alipore.

2/9/65

SEPARATION PLAN
AT DAG NO 471 OF BARISA
SCALE 20 FT = 1 IN.

*N. B. in the name of the plot
 Barisa - 727 - 1000/1000
 Suburban H. Plot 727*

N.B.		sq. ft.	SHOWN THUS	
PLOT	14-9-0		DO	DO
DO	5-2-33		DO	DO
DO	3-0-6		DO	DO
DO	7-3-32		DO	DO
COMMON PASSAGE			DO	DO



BY: -

Original plan of the road in I
attached to the paper in 2613

Book no I

Volume n. 34

for the year 1962



Aliporn
Director Joint Sub-Regional
of Aliporn, ds/bw

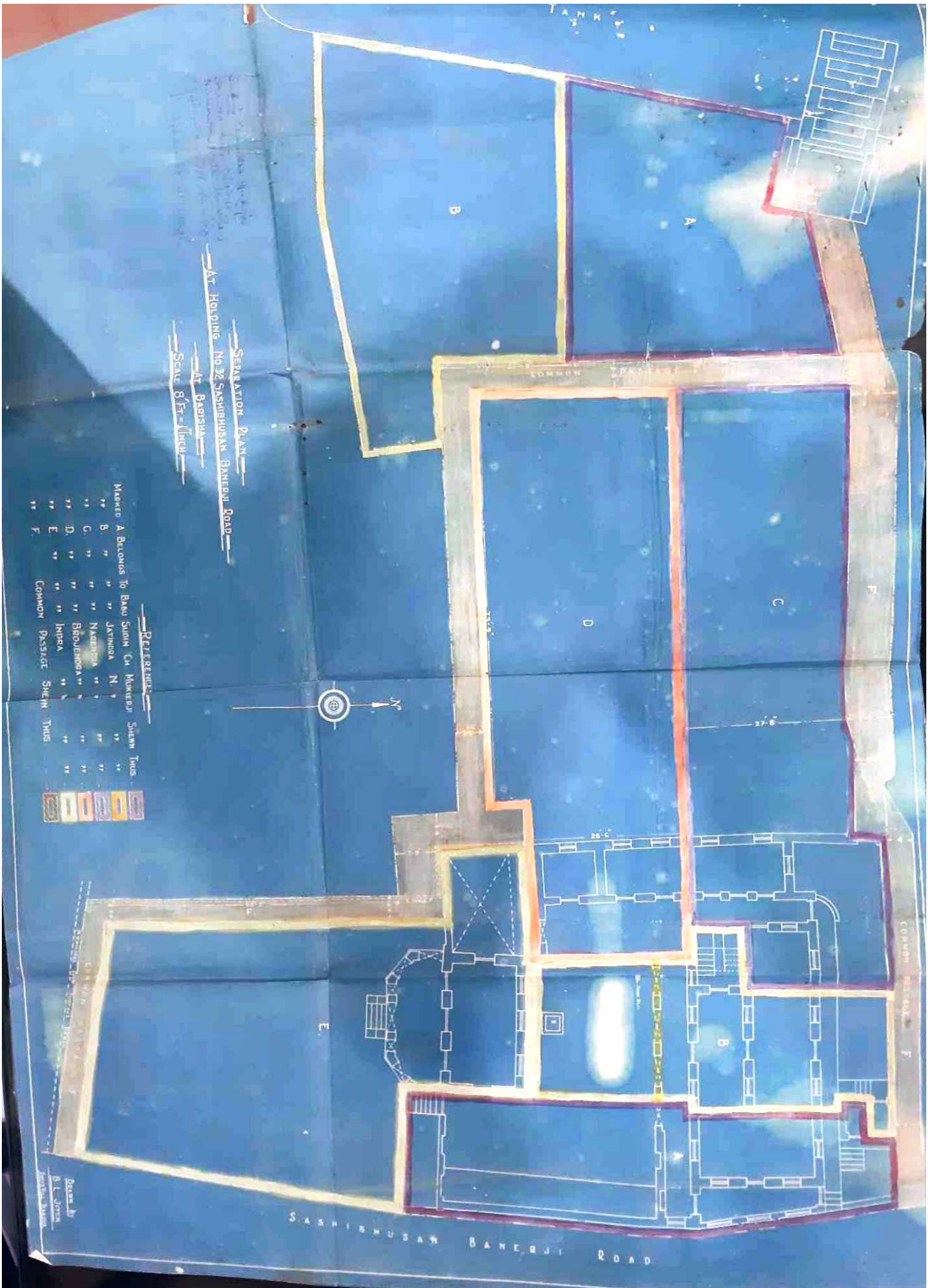

SEPARATION PLAN
 AT. HOLDING No. 22 SASHIBHUSAN BANERJI ROAD
 AT BANARSI
 SCALE 8 FT = 1 INCH

REFERENCE:

Master A	Belongs to	Babu	Sudh	Ci	Mukherji	Sherni	Tind
" B "	" "	" "	JATINDA	" "	" "	" "	" "
" C "	" "	" "	MADEHRA	" "	" "	" "	" "
" D "	" "	" "	BROUENORA	" "	" "	" "	" "
" E "	" "	" "	IMRA	" "	" "	" "	" "
" F "	" "	" "	COMMON	PASSAGE	SHERI	TIND	" "



Drawn by
 B.L. JINNA
 Jinnah Institute

original of the deed in 1856
attached - the page in 241
Book in I
Volume in 34
for the year 1845.



Registrar of Alipore
of Alipore. *[Signature]*