

GROUND FLOOR PLAN

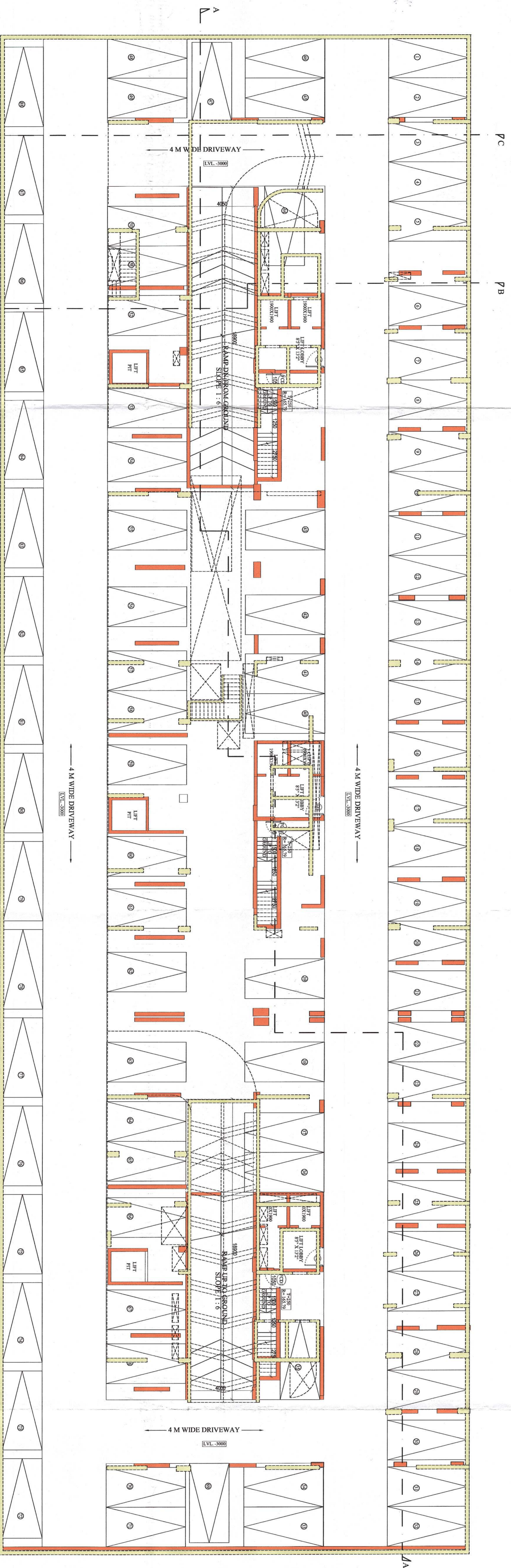

BASEMENT PLAN

- NOTES:**
1. ALL DIMENSIONS ARE IN MM UNLESS OTHERWISE MENTIONED.
  2. ALL EXTERIOR WALLS AND INTERIOR WALLS SHALL BE 150 MM THK. IF NOT STATED IN 1:4 CEMENT SAND MORTAR.
  3. ALL ELEVATION PROJECTIONS ARE 600 MM. PROTECTED.
  4. ALL ELEVATION PROJECTIONS WATER RESISTION SHOULD NOT EXCEED THE DEPTH OF FOUNDATION.
  5. GRADE OF CONCRETE & GRADE OF STEEL USED ARE AS PER IS 456 & IS 2008 RESPECTIVELY.
  6. ALL STRUCTURE SHALL BE CONSTRUCTED AS PER IS 456 & IS 2008.
  7. ANY DISCREPANCY IN SCALE, THE WRITTEN DIMENSION SHALL GOVERN.
  8. FOR SPECIFICATION OF MATERIALS & WORKMANSHIP N.B.C. 2016 TO BE FOLLOWED.
  9. OPEN TERRACE WITH LINE TERRACING OF RATIO 1:2.5.
  10. DAMP PROOF COURSE TO BE PROVIDED WITH P.C.C. (1:2:4).

**DOORS & WINDOWS SCHEDULE**

DOORS		WINDOWS					
MRKD.	WIDTH	INTEL. HT.	SILL HT.	MRKD.	WIDTH	HEIGHT	SILL HT.
D1	2000	2250	-	W1	1500	1950	300
D2	1500	2250	-	W2	1200	1950	300
D3	1200	2250	-	W3	1000	1950	300
D4	1200	2200	-	W4	1000	1200	1050
D5	1150	2250	-	W5	600	1000	1250
D6	1000	2250	-	W6	1200	1000	1250
D7	750	2250	-	W7	600	1000	1250
SD	2250	2250	-	SW	3000	600	1650
FCD	1200	2250	-	D/W	1200	1650	600
SD	1200	2250	-	D/W	1500	2250	300
FG.	1200	2250	-	D/W	1500	2250	1050

I DO HEREBY DECLARE WITH FULL RESPONSIBILITY THAT I HAVE ENGAGED M/S. SVASIRK PROJECTS PVT. LTD. AS ARCHITECT FOR THE DESIGN OF THE BUILDING AS PER PLAN K.M.C. L.B.A. & S.E. BUILDING CONSTRUCTION OF THE BUILDING AS PER PLAN K.M.C. AUTHORITY WILL NOT BE RESPONSIBLE FOR STRUCTURAL STABILITY OF THE BUILDING. THE ARCHITECT WILL BE RESPONSIBLE FOR THE STRUCTURAL STABILITY OF THE BUILDING. THE ARCHITECT WILL BE RESPONSIBLE FOR THE STRUCTURAL STABILITY OF THE BUILDING. THE ARCHITECT WILL BE RESPONSIBLE FOR THE STRUCTURAL STABILITY OF THE BUILDING.

**Signature of Architect**  
**Signature of Owner**

**CERTIFICATE OF STRUCTURAL ENGINEER**  
 I DO HEREBY DECLARE WITH FULL RESPONSIBILITY THAT I HAVE ENGAGED M/S. SVASIRK PROJECTS PVT. LTD. AS ARCHITECT FOR THE DESIGN OF THE BUILDING AS PER PLAN K.M.C. L.B.A. & S.E. BUILDING CONSTRUCTION OF THE BUILDING AS PER PLAN K.M.C. AUTHORITY WILL NOT BE RESPONSIBLE FOR STRUCTURAL STABILITY OF THE BUILDING. THE ARCHITECT WILL BE RESPONSIBLE FOR THE STRUCTURAL STABILITY OF THE BUILDING. THE ARCHITECT WILL BE RESPONSIBLE FOR THE STRUCTURAL STABILITY OF THE BUILDING.

**Signature of Structural Engineer**  
**Signature of S.E.**

**CERTIFICATE OF GEO-TECHNICAL ENGINEER**  
 I DO HEREBY DECLARE WITH FULL RESPONSIBILITY THAT I HAVE ENGAGED M/S. SVASIRK PROJECTS PVT. LTD. AS ARCHITECT FOR THE DESIGN OF THE BUILDING AS PER PLAN K.M.C. L.B.A. & S.E. BUILDING CONSTRUCTION OF THE BUILDING AS PER PLAN K.M.C. AUTHORITY WILL NOT BE RESPONSIBLE FOR STRUCTURAL STABILITY OF THE BUILDING. THE ARCHITECT WILL BE RESPONSIBLE FOR THE STRUCTURAL STABILITY OF THE BUILDING. THE ARCHITECT WILL BE RESPONSIBLE FOR THE STRUCTURAL STABILITY OF THE BUILDING.

**Signature of Geo-Technical Engineer**  
**Signature of G.T.E.**

**CERTIFICATE OF ARCHITECT**  
 I DO HEREBY DECLARE WITH FULL RESPONSIBILITY THAT I HAVE ENGAGED M/S. SVASIRK PROJECTS PVT. LTD. AS ARCHITECT FOR THE DESIGN OF THE BUILDING AS PER PLAN K.M.C. L.B.A. & S.E. BUILDING CONSTRUCTION OF THE BUILDING AS PER PLAN K.M.C. AUTHORITY WILL NOT BE RESPONSIBLE FOR STRUCTURAL STABILITY OF THE BUILDING. THE ARCHITECT WILL BE RESPONSIBLE FOR THE STRUCTURAL STABILITY OF THE BUILDING. THE ARCHITECT WILL BE RESPONSIBLE FOR THE STRUCTURAL STABILITY OF THE BUILDING.

**Signature of Architect**  
**Signature of Architect**

**PROJECT**  
 REGULARIZATION PLAN U/R 26(2A) FOR B+G+XIII STORED/HT=79.75 MTS, RESIDENTIAL BUILDING AT PREMISES NO. 46A/1, BHEL/BI BARIN GHOSH SARANI WARD NO. 14, BOBROUGH-III, P.S.-NANIKATA, KOLKATA-700015, IN DEVELOPMENT FROM SANCTION VIDE B.P. NO.-2021030076, DATED 29.11.2021

**CONTENTS:**

**BASEMENT FLOOR & GROUND FLOOR PLAN**

NO.	REV. DATE	REASON	BY
1	27.09.2022	CHECKED	K.AAL

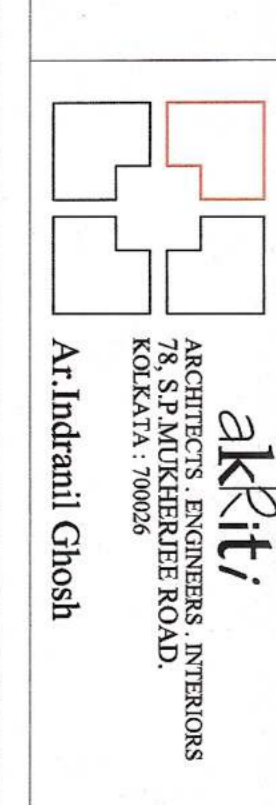

Atulchandra Ghosh