

(22ND FLOOR PLAN) FIRE REFUGE FLOOR PLAN

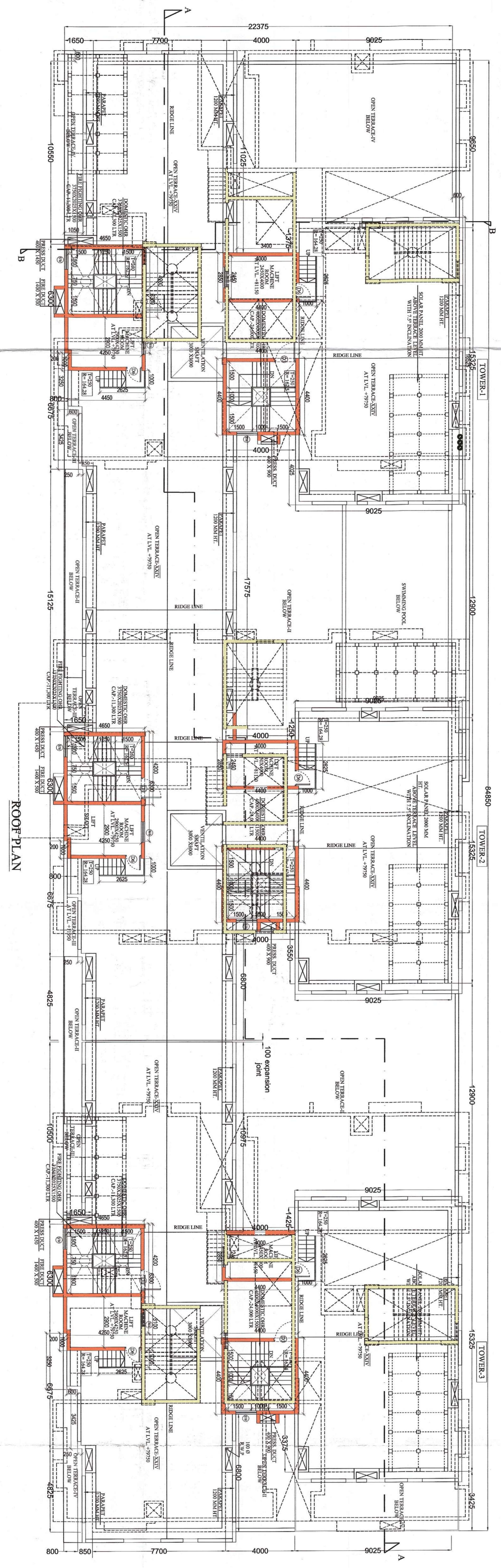

ROOF FLOOR PLAN

- NOTES :**
1. ALL DIMENSIONS ARE IN MM UNLESS OTHERWISE MENTIONED.
 2. ALL DIMENSIONS ARE TO FACE UNLESS SPECIFIED OTHERWISE.
 3. ALL ELEVATION PROJECTIONS ARE 600 MM. PROJECTED DEPTH OF FOUNDATION.
 4. GRADE OF CONCRETE & GRADE OF STEEL USED ARE M20 & R500 RESPECTIVELY.
 5. ALL DIMENSIONS ARE TO FACE UNLESS SPECIFIED OTHERWISE.
 6. ALL DIMENSIONS ARE TO FACE UNLESS SPECIFIED OTHERWISE.
 7. ANY DISCREPANCY IN SCALE, THE WRITTEN DIMENSION SHALL GOVERN.
 8. FOR SPECIFICATION OF MATERIALS & WORKMANSHIP N.B.C. 2016 TO BE FOLLOWED.
 9. OPEN TERRACE WITH LINE TERRACING & WORKMANSHIP N.B.C. 2016 TO BE FOLLOWED.
 10. DAMP PROOF COURSE TO BE PROVIDED WITH P.C.C. (1:2:4).

DOORS & WINDOWS SCHEDULE			
DOORS		WINDOWS	
MKD.	WIDTH	HT.	SILL HT.
D1	2000	2250	300
D2	1500	2250	300
D3	1200	2250	300
D4	1150	2250	300
D5	1000	2250	300
D6	900	2250	300
D7	750	2250	300
SD	2250	-	600
FCD	1200	2250	300
FD	1200	2250	1050

I DO HEREBY DECLARE WITH FULL RESPONSIBILITY THAT I SHALL ENGAGE L.B.A & E.E. ENGINEERING CONSULTANTS FOR THE DESIGN OF THE BUILDING AS PER PLAN N.B.C. BUILDING & ADJOINING STRUCTURE. IF ANY SANCTIONED DOCUMENT, THE FINE OF THE K.M.C. AUTHORITY WILL BE ON THE SANCTION PLAN. THE CONSTRUCTION OF THE WORK SHALL BE UNDER THE GUIDANCE OF THE SUPERVISOR OF THE K.M.C. AUTHORITY.

CERTIFICATE OF STRUCTURAL ENGINEER
 CERTIFIED THAT THE STRUCTURAL DESIGN ADVISORIES OF BOTH FOUNDATION & SUPER STRUCTURE OF THE BUILDING HAS BEEN DESIGNED BY PERFORMING NATIONAL BUILDING CODE OF INDIA & CERTIFIED THAT IT IS SAFE & STABLE IN ALL RESPECTS.

SANJIV GUHA
 REGISTERED STRUCTURAL ENGINEER
 E.R. 8816
 SIGNATURE OF E.S.E.

SANJIV GUHA
 REGISTERED STRUCTURAL ENGINEER
 E.R. 8816
 SIGNATURE OF E.S.E.

CERTIFICATE OF ARCHITECT
 THE PLAN IS SUBMITTED ON THE PLAN UNDER MY FULL RESPONSIBILITY. I HAVE CHECKED THE PLAN AND I AM SURE THAT THE PLAN IS CORRECT AND THAT THE BUILDING WILL BE STABLE IN ALL RESPECTS FROM THE POINT OF VIEW OF ARCHITECTURE.

INDRANIL GHOSH
 REGISTERED ARCHITECT
 E.R. 8816
 SIGNATURE OF ARCHITECT

PROJECT
 REGULARIZATION PLAN U/R -26(2A) FOR B-G-XXIII STORED (HT -79.75 MTS) RESIDENTIAL BUILDING AT PREMISES NO. 46A/1, BIPLABI BARNI GHOSH SARANI, WARD NO. 14, BOROUGHI-II, P.S.-MANKITALA, KOLKATA-700015, IN DEVIATION FROM SANCTION VIDE B.P. NO.-2021030076, DATED 29.11.2021

CONTENTS:

NO.	DESCRIPTION	DATE
1	7th, 10th, 13th, 16th & 19th FLOOR PLAN	27/09/2022

skt
 ARCHITECTS & ENGINEERS
 76, S.P. KUMAR ROAD
 KOLKATA - 700005
 Ar. Indranil Ghosh