

5 MT. WIDE ROAD

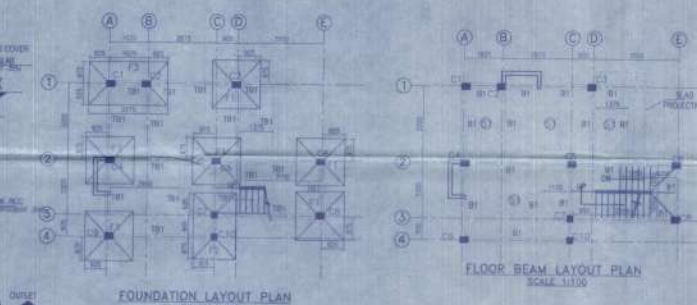

DOOR		
MARKED	WIDTH	LINTEL SPECI
D	1050	2200
D1	900	2200
D2	800	2200
D3	750	2200
D4	2100	2200

WINDOW		
MARKED	WIDTH-HEIGHT	SILL
W1	1800 x 900	300
W2	1200 x 1000	300
W3	900 x 1000	300
W4	600 x 900	1300
W5	900 x 1900	300
W6	900 x 1000	1200
W7	600 x 1450	750

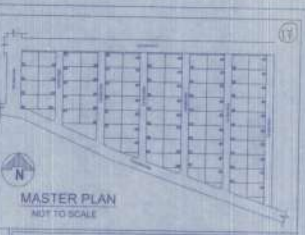

MASTER PLAN
NOT TO SCALE

NOTES AND SPECIFICATIONS

1. ALL DIMENSIONS ARE IN MM UNLESS OTHERWISE SPECIFIED.
2. GRADE OF CONCRETE, FOUNDATIONS AND COLUMNS UP TO BEAM AND BEAM-ROOF COLUMNS ARE: 20 MPa M30.
3. GRADE OF STEEL: M.Y.S.C. Fe 500.
4. DO NOT SCALE THE DRAWING. WRITTEN DIMENSIONS ARE TO BE FOLLOWED.
5. BASIS OF DESIGN & LIMIT STATE METHOD.
6. LAP & ANCHORAGE OF REINFC. AS PER IS 456 & IS 1786.
7. CLEAR COVER TO MAIN REINFC. ELEMENT: 25 MM FOR SLAB, 40 MM FOR COLUMN, 40 MM FOR BEAM, 25 MM FOR FOOTING.
8. BEARING CAPACITY OF SOIL CONSIDERED AS PER SOIL REPORT.
9. THIS DRAWING IS A PRELIMINARY DOCUMENT OF THE CONSULTANT IT MUST NOT BE COPIED OR CHANGED WITHOUT THEIR CONSENT.

PROPOSED TWO STORED BUILDING
AT R.S. DAG NO. 82(P), 83(P), 404(P)
MOUZA - UTTAR KAZIRHAT, J.L. NO
22 UNDER P.S. BISHNUPUR, P.O.
RASAPUNJA, DIST-SOUTH 24
PARGANAS, UNDER PASCHIM
BISHNUPUR GRAM PANCHAYAT.

LAND AREA = 455.04 SQ.MT
= 4898 SQ.FT = 6 KATHA + 12 CHATTAK = 38 SQ.FT.

AREA STATEMENT OF ONE BUILDING
PLINTH AREA = 50.86 SQ.M
= 547 SQ.FT
FIRST FLOOR AREA = 51.67 SQ.M
= 556 SQ.FT
TOTAL AREA = (50.86+51.67) SQ.M
= 102.54 SQ.M
= 1104 SQ.FT

NUMBER OF PARKING = 1 NOS

TOTAL NUMBER OF BUILDING = 4 NOS
TOTAL AREA OF 4 NOS BUILDING
= (102.54 X 4) SQ.M
= 410.16 SQ.M = 4415 SQ.FT
TOTAL NOS OF PARKING = 4 NOS.

I CERTIFY THAT ALL THE ARCHITECTURAL DRAWINGS OF PROPOSED TWO STORED BUILDING AT R.S. DAG NO. 82(P), 83(P), 404(P) MOUZA - UTTAR KAZIRHAT, J.L. NO 22 UNDER P.S. BISHNUPUR, P.O. RASAPUNJA, DIST-SOUTH 24 PARGANAS, UNDER PASCHIM BISHNUPUR GRAM PANCHAYAT, HAVE BEEN PREPARED BY ME, BEING IN COMPLIANCE WITH THE PROVISIONS OF THE NATIONAL BUILDING CODE 2005 AND THE WEST BENGAL MUNICIPAL BUILDING RULES 2007. NO SUCH WRONG AND INCORRECT INFORMATION HAS BEEN FURNISHED BY ME, INCLUDING AREA CALCULATION CHARTS IN THIS DRAWINGS AND NO VIOLATION OF THE PROVISIONS OF THESE RULES WILL BE FOUND IN ANY OF THE DRAWINGS AND DOCUMENTS SUBMITTED TO THE SANCTIONING AUTHORITY FOR OBTAINING SANCTIONS.



APPROVAL LOCATION PLAN
SCALE: 1:4000

Attested
Plan Approved and Ordered
For total Covered area: 4415 Sq.Ft
Date Received From: 11.03.24
Verified by: E. Alex. Bhattacharya
13th April 2024
in Bishnupur, West Bengal
Bishnupur-134 24 Pgs

SCHEDULE OF COLUMN

ROOF	SP.
1	1

FND	CLUSTERS	CLUSTERS
1	1	1

LINK: AS SPECIFIED.

SCHEDULE OF FLOOR AND ROOF SLAB

LEVEL	THICKNESS	REINFORCEMENT	REINFORCEMENT
1	150	10	10

SCHEDULE OF FOOTING

NO.	DESCRIPTION	THICKNESS	REINFORCEMENT
1	ISOLATION	150	10

BEAM SCHEDULE

NO.	DESCRIPTION	THICKNESS	REINFORCEMENT
1	ISOLATION	150	10

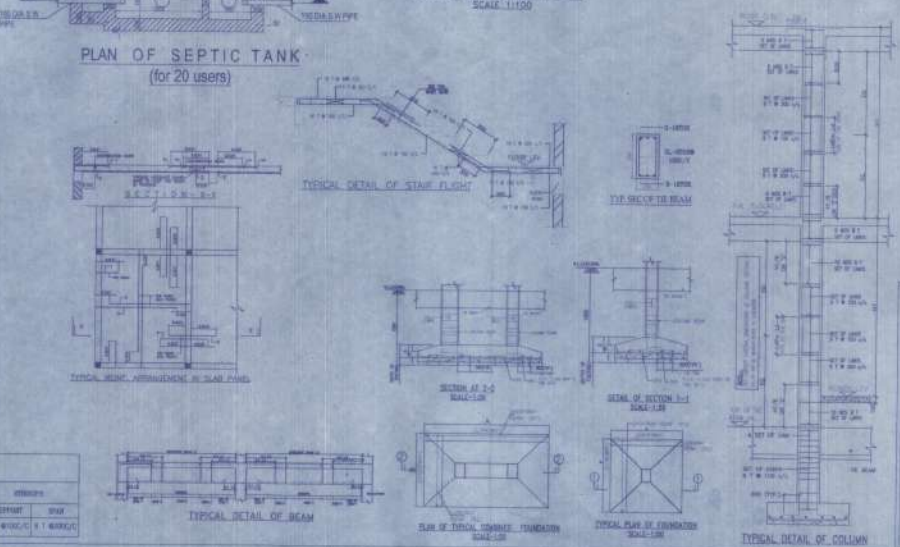

Signature of Architect / Engineer
Kaishik Bhattacharya
Director

Authorized Signatory
Kaishik Bhattacharya
Director

TITLE:
OVERALL SITE PLAN SHOWING GROUND FLOOR PLAN WITH SEWERAGE LAYOUT, SITE PLAN, LOCATION PLAN, MASTER PLAN & SEPTIC TANK DETAIL, GROUND FLOOR PLAN, 1ST FLOOR PLAN, ROOF PLAN, ELEVATION & SECTIONS AT AA, BB, FOUNDATION LAYOUT PLAN, FLOOR BEAM LAYOUT PLAN, TYPICAL REINFC. ARRANGEMENT IN SLAB PANEL, TYP. SECTION OF THE BEAM, TYPICAL DETAIL OF COLUMN BEAM & STAIR FLIGHT, TYPICAL PLAN & SECTION OF FOUNDATION.

DRAWN BY: TARUN KUMAR
CHECKED BY: ATARU C
SCALE: 1:500
DATE: 14.06.21

DRAWINGS NO.: GEMS-SANC-JRCH-PH-1-17K-BUNG-BALMB-B-13-B-11-01
REVISION NO.:

Project
Paschim Bishnupur G.P.
Bishnupur-1, South-1 Pgs