

Sub-arch Engineer
Srikanth Kumar
Approved
16.02.19

REVISED PLAN FOR PROPOSED & EXISTING PARKING + 4 STD. RESIDENTIAL BUILDING AT CHAYAN PARA, SILIGURI, DIST. - JALPAIGURI

OWNER
SRI ARUN KUMAR AGARWALA, 30 LT. BISWANATH AGARWALA, SMT. NEELAM DEVI AGARWALA, WHO SRI ARUN KR. AGARWALA

SMC HOLDING NOS - V/100/06/31
AP/70, LDC MEMO NO. - 191/LDC/03/ANP/SP/DA DT. - 08.08.2012
PREV. AP/ND SITE PLAN NO. - 76/18/13 DT. - 23.11.2012
PREV. AP/ND B.D.C. PLAN NO. - 889 DT. - 23.11.2012

LAND SCHEME NO. - DAGGRAM
PLOT NO. - 452 L.R. 287/9 R.S.
J.L. NO. - 02
KHALTA NO. - 807 L.R. 634 R.S. 508 L.R.
WATER NO. - 42
PARANAGA - BAKANTHAPUR
P.S. - BAKANTHAPUR
DIST. - JALPAIGURI

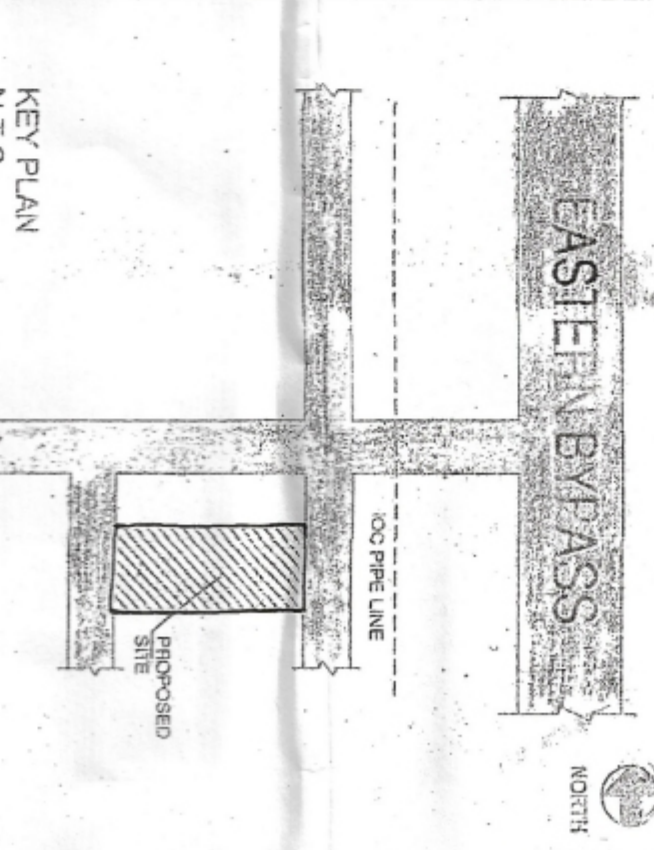

LAND AREA AS PER DETD
2424.11 SQ.M.

LAND AREA AS PER SITE
2424.83 SQ.M.

PERM. GROUND COVERAGE
50% OR 1212.48 SQ.M.

EXISTING GROUND COVERAGE
16.87% OR 411.87 SQ.M.

PROP. GROUND COVERAGE
30.85% OR 748.18 SQ.M.

TOTAL GROUND COVERAGE
47.82% OR 1159.72 SQ.M.

TOTAL HEIGHT OF BUILDING
20.00 M.

PROP. HEIGHT OF BUILDING
14.95 M.

USE OF PROPOSED BUILDING
RESIDENTIAL

AREA STATEMENT

GROUND FLOOR AREA
411.57 SQ.M.

EXISTING AREA
736.13 SQ.M.

PROPOSED AREA
1150.70 SQ.M.

TOTAL GROUND FL. AREA
1648.22 SQ.M.

EXISTING TOWER AREA (158.73x4)
299.64 SQ.M.

TOTAL T.T.R. FL. AREA (158.73x4)
468.68 SQ.M.

TOTAL FLOOR AREA
2057.86 SQ.M.

EXISTING FLOOR AREA
578.82 SQ.M.

PROPOSED FLOOR AREA
1479.04 SQ.M.

TOTAL NOS. OF TENEMENT - 41 NOS

EXISTING TENEMENTS - 16 NOS

PROPOSED TENEMENTS - 4 NOS

TOTAL TENEMENT AREA - 1460.87 SQ.M.

EXISTING TENEMENT AREA (158.73x4)
299.64 SQ.M.

PROPOSED TENEMENT AREA (158.73x4)
1161.23 SQ.M.

AREA FREE FROM F.A.R.
LIFT LOBBY @ 350 M. x 5 F.L.R. 75.0 SQ.M.

CAR PARKING & SERV. AREA
1029.07 SQ. M.

STAR COVER
378.8 SQ.M.

11.28 x 4 NOS. x 8 F.L.S. = 368.2

11.92 x 1 NOS. x 8 F.L.S. = 71.92

TOTAL FREE AREA
1460.87 SQ.M.

TOTAL AREA FOR F.A.R.
15788.82 - 1460.87
= 4388.75 SQ.M.

PROPOSED F.A.R.
1.777

PERMISSIBLE F.A.R.
2.0

TREE COVER AREA CALCULATION

TOTAL FLR. AREA	LAND AREA	PERMISSIBLE	PROPOSED
6000 SQ.M.	15% OF LAND AREA	900	900
5788.82 SQ.M.	15% x 0.78827	600	14.84% CR
	= 14.47% CR	850.82 SQ.M.	

SIGNATURE OF OWNER

SIGNATURE OF ENGINEER

SIGNATURE OF GEO-TECHNICAL ENGRS

SIGNATURE OF L.B.S

TITLE
CORPORATION PLAN

DRAWN SOURAV SCALE AS SHOWN

CHKD. S.M. SHEET NO. 01/01

Sudhanta Majumder
RAJEN KOLEY
Geo. Technical Engineer, Class-II
SMC Engineerment No. 01
M. 9830828888
SIGN. OF GEO-TECHNICAL ENGRS

Majumder & Associates
Civil. +11-9830828888, 49/9932973581