



e - NOC

No.

E 000803

KOLKATA METROPOLITAN DEVELOPMENT AUTHORITY

Housing Sector
Unnayan Bhawan, 1st Floor, DJ – 11, Sector – II,
Salt Lake, Kolkata – 700091.

No. 2E / KMDA / EoDB/ 2022/463

Dated : 04.07.2022

Sri/Smt. KAMALESH GANDHI
P S REALITY GROUP
1002, E. M. Bye Pass,
P.S. –Pragati Maidan,
P.O.– Dhapa,
Kolkata – 700 105.

Re. :- Premises No. 17, RADHANATH CHOWDHURY ROAD,
Ward No.- 056,
Borough No.- VII,
Kolkata – 700 015.

Dear Sir / Madam,

In connection with Plan Case No. 2022070055 applied on dated. 03.06.2022 for K.M.C. Assessee No. 110561200580 I have to inform you that the site / building plan submitted with your application has been examined with erstwhile Trust Plan / Records. Accordingly, the above property is not affected at present by any published / sanctioned Scheme of the erstwhile Trust.

The above observation must be read with the copy of the site plan which is returned herewith duly endorsed. The correctness of the site plan is not verified / certified.

Further, the letter should be treated as invalid or cancelled if any overwriting, erasing or any kind of disfiguration is made either on this letter or on the enclosed site plan.

Yours faithfully,

Executive Engineer,

Housing Sector, K. M. D. A.

04/7/2022

Encl. : Copy of endorsed site plan in .pdf format showing
Land Area mentioned in Boundary Declaration.

EXECUTIVE ENGINEER
KMDA, HOUSING SECTOR

SITE PLAN AND LOCATION PLAN OF PREMISES NO. - 17 RADHANATH CHOWDHURY ROAD, KOLKATA - 700015, WARD NO:- 56, BOROUGH :- VII P.S. - ENTALY, FOR KMDA NOC U/S 393(A) OF K.M.C. ACT B/R 2009
 LAND AREA = 137 K - 6 CH - 3 SFT = 9189.24 SQM (AS PER DECL. IN B/D)
 ASSESSE NO.: 110561200580 PLAN CASE NO. 2022070055

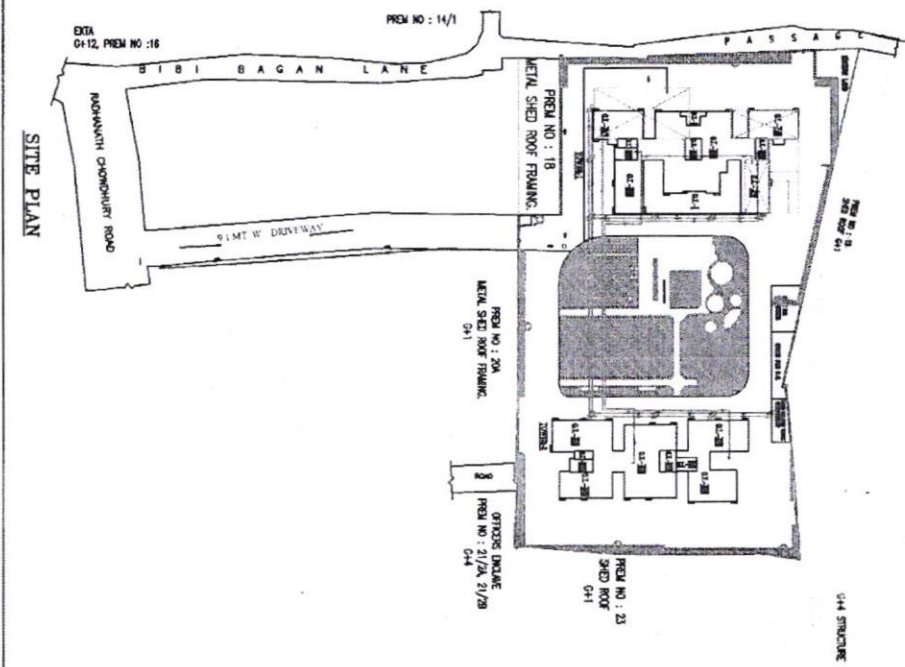
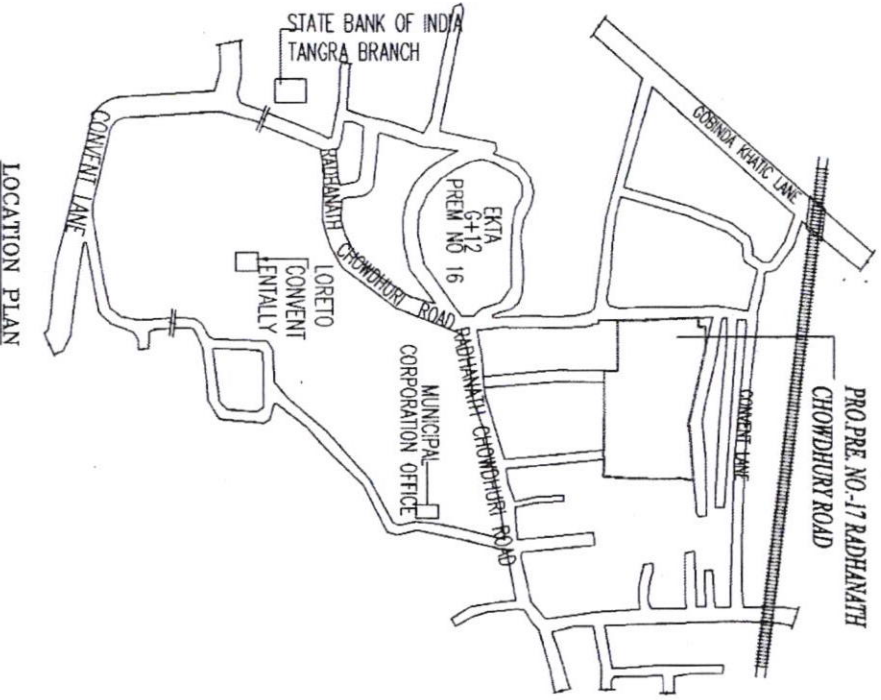

PS GROUP REALTY PVT. LTD.
 Director/Authorised Signatory



NOTE:
 This plan is not to the scale and has been prepared on the basis of Building Plan submitted by the Applicant in .dwg format through CAF against Plan case No. 2022070055 dated 03.06.2022

These observations are hereby given as per Sub- Rule (8) of Rule (4) of the K.M.C. Building Rule 1990
 This plan was enclosed with Party's applications.
 The Correctness of the plan is not verified / certified.
 Enclosure to the letter No. 2E/KMDA/EODB/2022/463

M. S. M. S.
 04/12/2022
 Executive Engineer
 Housing sector
 KMDA, HOUSING SECTOR,
 Kolkata Metropolitan Development Authority