



SURVEY OBSERVATION REPORT

Chief Valuer & Surveyor's Department
The Kolkata Municipal Corporation
5, S.N. Banerjee Road, Kolkata - 700013

REF - Assessee No. / Nos.
 Premises No. & Street Name
 Dag No. (C.S.) Dag No. (R.S.) : Touzi No. : Holding Map No. :
 Mouza Khanan No. J.L. No. :
 Ht. of Building : Mt. No. of Block Area of Land : Sq. M.
 1) K.M.C. Alignment on Abutting Road - Passage (if any)

2) Character of Abutting Road - Passage

3) Width of Abutting Road / Passage

4) Other Observation if any

Report of A.E. (C)

[Signature]
 29/4/22
 Signature of S.A.E. (C)

[Signature]
 30/04/2022
 Signature of A.E. (C)

Note :- The report is granted on the basis of condition as laid down on the back page. The above all dimensions, if any marked in the Column 4), has been shown in the Site Plan of the Annexed Drawing.

RAJ ARYAMA & ASSOCIATES
 88 BIRLA STREET, KOLKATA - 76

SCALE: 1:400
 ARCHITECT

PROPOSED GYM STORED (G.S. RT. H.1)
 RESIDENTIAL BUILDING AT PLOT NO. 17
 RAJANATH CHOWHURY ROAD, KOLKATA - 700017, WARD NO. - 28, BOHOWAH - VI
 P.S. - ENTALF.

GROUND FLOOR PLAN, SITE PLAN &
 LOCATION PLAN

TITLE

AREA OF LAND (123' x 137') = 9824 SQM
 EXCLUDING 81 RT (PARKING) = 2844 SQM
 PROPOSED CARP. UP AREA = 2844 SQM

-AREA STAMIN-

SIGNATURE OF ARCHITECT

SIGNATURE OF OWNER

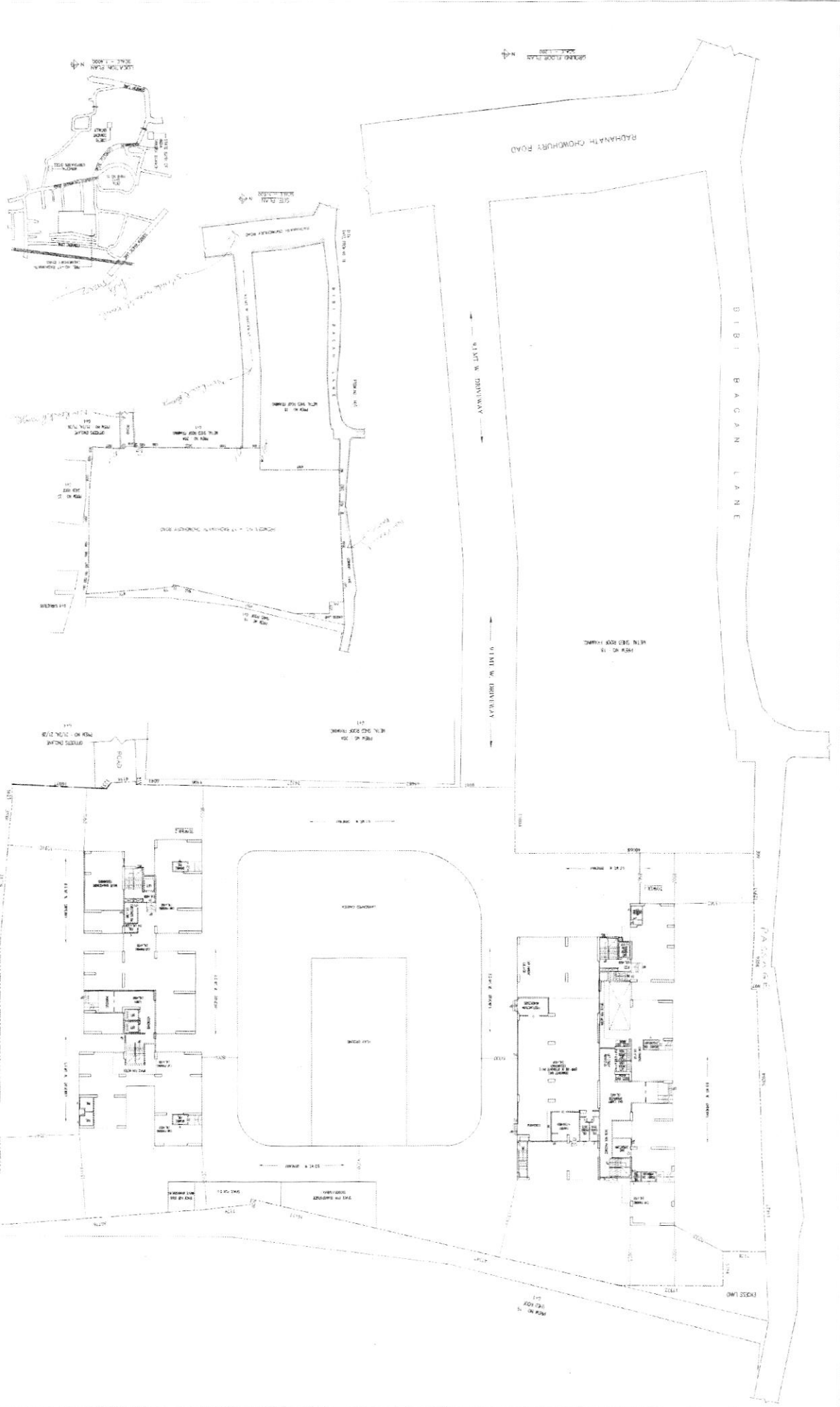

CONDITION ON SURVEY OBSERVATION REPORT AS DETAILED ON PREVIOUS PAGE.



Chief Valuer & Surveyor's Department
The Kolkata Municipal Corporation
5, S. N. Banerjee Road, Kolkata - 700 013

6. THIS S.O.R. IS ONLY TO CERTIFY THE WIDTH OF THE MEANS OF ACCESS, ITS CHARACTER & ALIGNMENT, IF ANY.
7. THIS S.O.R. DOES NOT IN ANY WAY CERTIFY THE OWNERSHIP, RIGHT OF ERECTION AND BOUNDARY OF THE PREMISES AS SHOWN IN THE ANNEXED DRAWING.
8. THIS SOR WILL NOT BE TREATED AS CLEARANCE IN REGARD TO VESTED LAND WATER BODIES OR CONSTRUCTION OVER TANK / WATER BODY FILLED-UP LAND.
9. THIS DEPARTMENT HAS NO RECORD REGARDING RESERVATION OF LAND AS REQUIRED IN TERMS OF MUNICIPAL COMMISSIONER'S CIRCULAR No. 034 OF 2000 - 2001, AT THE TIME OF SEPARATION AND AMALGAMATION OF THE PLOT(S) OF THE RESPECTIVE PREMISES WAS DONE AT THE TIME OF MUTATION OR NOT.
10. THIS SOR IS ISSUED ON THE BASIS OF THE SITE PLAN GIVEN BY L.B.S./ ARCHITECT. ANY MISREPRESENTATION OF THE FACTS GIVEN BY L.B.S./ ARCHITECT WILL MAKE LIABLE FOR REVOCATION THE LICENSE OF THE L.B.S. OR INTIMATION TO THE COUNCIL OF ARCHITECTURE FOR REVOCATION OF REGISTRATION. THIS S.O.R. WILL AUTOMATICALLY BE TREATED AS CANCELLED DUE TO SUCH MISREPRESENTATION.

24.09/14/15
[Signature]
PS GROUP REALTY PVT. LTD.

[Signature]
Director / Authorised Signatory