

**SITE PLAN FOR A PROPOSED G+VII STORIED ( HEIGHT - 24.00 M. )  
RESIDENTIAL BUILDING OF 1) SRI TAPAN KUMAR SARKAR, 2) SRI SWAPAN  
KUMAR SARKAR BOTH S/O.- LATE KSHIRODE CHANDRA SARKAR, 3) SRI  
RANJAN MONDAL, S/O. - LATE PRABODH KUMAR MONDAL, 4) SITAL PRASAD  
MANDAL S/O. - LATE JITENDRA NATH MANDAL & 5) MOHAMMED SULTAN S/O.-  
LATE ABDUL RAHIM, AT MOUZA - PARBANGLA, J. L. NO - 49, R. S. & L. R. DAG  
NO. - 336, 336/733 & 354, L. R. KHATIAN NO- 2471, 2472, 2473, 2474 & 2717, P. S.-  
MAHESHTALA, UNDER MAHESHTALA MUNICIPALITY, WARD NO - 31, KOLKATA -  
700 140, DIST.- SOUTH 24 PARGANAS.**

**HOLDING NO - E3 - 48 / NEW, B. B. T. ROAD ( RIGHT SIDE TOWARDS KOLKATA )**

**ALL DIMENSIONS ARE IN mm.  
SCALE = 1:600**

1. Land Area as per Deed:- (11,188.00 SQ FT ) = 15 K 08 Ch. 28 Sq.ft = 1039.391 Sqm
2. Land Area as per Site :- (11,188.00 SQ FT ) = 15 K 08 Ch. 28 Sq.ft = 1039.391 Sqm

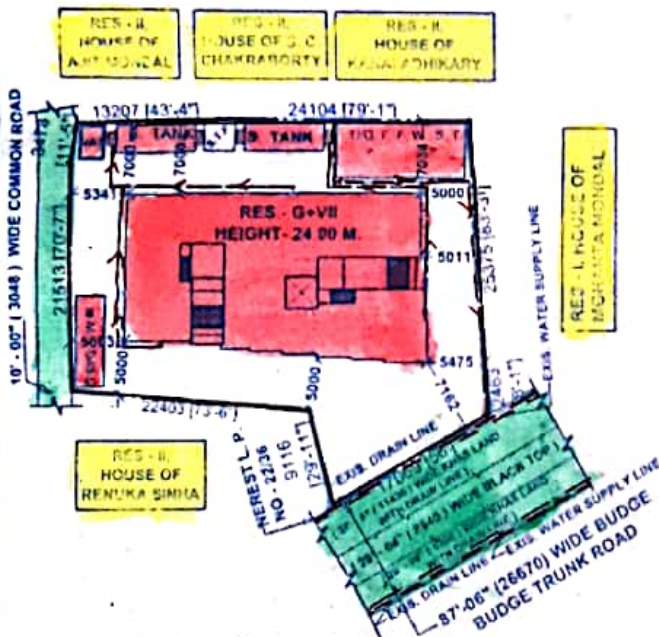

**SITE PLAN  
SCALE= 1:600**

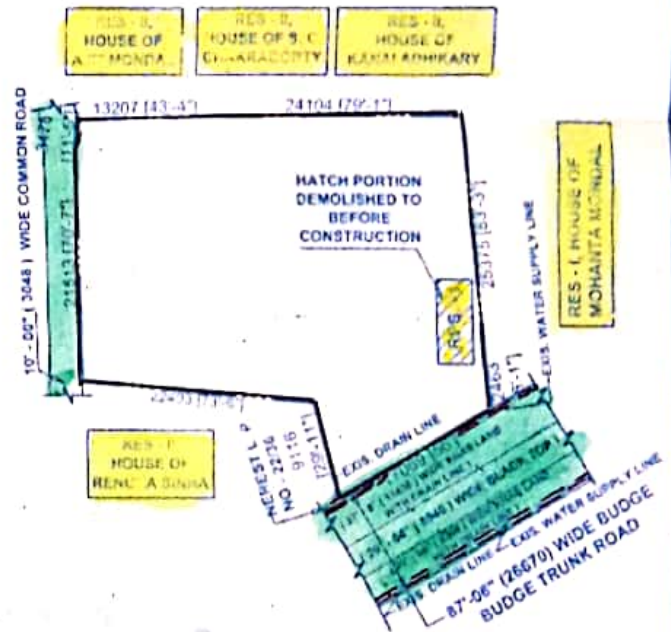

**EXIS. SITE PLAN  
SCALE= 1:600**

*Md. Sultan*  
For Self and as Constituted Attorney of  
**TAPAN KUMAR SARKAR  
SWAPAN SARKAR  
RANJAN MONDAL  
SITAL PRASAD MANDAL**

**SIGN. OF OWNER**

**SUNRISE ERECTORS PVT. LTD.**

*Md. Sultan*  
Managing Director

*Swarajit Roy*

**SWARAJIT ROY  
B.ARCH., M.T.R.P.  
REGISTERED WITH COUNCIL OF  
ARCHITECTURE- CA/96/19638  
K.M.C. NO.- 237 (A)**

**SIGN. OF ARCHITECT**

**APPARTMENT BUILDING**

ORIGINAL COPY / DUPLICATE COPY  
FINAL / PROVISIONALLY SANCTIONED  
SITE PLAN

Plan No. 203/1/15-16/15-16 / SP/BP

Date: 2.11.2015

Name: Shyam K. Saregare & S/ESS

Address: B.R.T Road

Ward No: 9/1

Shyam K. Saregare  
Sub-Asst. Engineer,  
Building Section  
Maheshvara Municipality

Valid Date: .....

CIC Member  
Sofal Watar  
Maheshvara Municipality

29 NOV 2016

29/11/15  
29/11/15

PLAN NO. 11-B/111M/BDDG/2/459/15-16/SP/BP  
Date: 29-11-2016