

FOR OFFICE USE

BOARD MEETING DATE = 30.8.2019

SANCTIONED
01/10/2019
P.L. NO. 1457/2019
P.L. NO. 1457/2019

CHIEF ENGINEER
MADHYAMGRAM MUNICIPALITY
North 24 Parganas
Kolkata - 700029



EXISTING & PROPOSED PLAN OF A GHV STORED RESIDENTIAL BUILDING OWNED BY-SMT. BHARATI GUPTA & 14 OTHERS, AT MOUZA - UDAYRAJPUR, J.L. NO.- 43, R.S. DAC NOS- 1233/1519 (P), 1233/1520 (P), 1240, 1241 (P) & 1242 (P), WARD NO.-56, HOLDING NO.-1457/ NABRUL ISLAM SARANI, P.S.-MADHYAMGRAM, DIST.- NORTH 24 PARGANAS, UNDER MADHYAMGRAM MUNICIPALITY.

STATEMENT OF PLAN PROPOSAL

AREA STATEMENTS:-

AREA OF LAND- 7307.35 SQ.MTR. (05BG.09KT.03CH.39 SFT.) (ASPER DEED)
AREA OF LAND- 7250.10 SQ.MTR. (05BG.08KT.06CH.10 SFT.) (AFTER GIFT)
GROUND COVERAGE CONSUMED = 3229.755 (44.55%).

PROPOSED AREA STATEMENT OF BLOCK- 1
GROUND COVERAGE = 593.47 SQ.M. = 6345.06 SFT.
PROP. CAR PARKING SPACE = 301.88 SQ.M. = 3249.44 SFT.
COMMON AREA (STAIR, LIFT & LOBBY) = 22.32 SQ.M. = 240.25 SFT.
EXIS. RESIDENTIAL AREA = 265.27 SQ.M. = 2855.37 SFT.
TOTAL EXIS. GROUND FLOOR = 589.47 SQ.M. = 6292.06 SFT.
PROP. TYP. (1ST. TO 4TH.) FLOOR = 642.97 SQ.M. = 6920.93 SFT. (EACH)
TOTAL FLOOR AREA = 3161.35 SQ.M. = 34028.78 SFT.

AREA STATEMENT OF EXISTING BLOCK- 2
GROUND COVERAGE = 357.31 SQ.M. = 3846.08 SFT.
GROUND FLOOR = 357.31 SQ.M. = 3846.08 SFT.
CAR PARKING SPACE = 304.78 SQ.M. = 3280.65 SFT.
TYP. (1ST. TO 4TH.) FLOOR = 354.75 SQ.M. = 3818.53 SFT. (EACH)
TOTAL FLOOR = 1776.31 SQ.M. = 19120.20 SFT.

AREA STATEMENT OF COMPLETED BLOCK- 3(C.C. ISSUED)
GROUND COVERAGE = 357.31 SQ.M. = 3846.08 SFT.
GROUND FLOOR = 357.31 SQ.M. = 3846.08 SFT.
CAR PARKING SPACE = 166.57 SQ.M. = 1792.93 SFT.
TYP. (1ST. TO 4TH.) FLOOR = 354.75 SQ.M. = 3818.53 SFT. (EACH)
TOTAL FLOOR = 1776.31 SQ.M. = 19120.20 SFT.

AREA STATEMENT OF EXISTING BLOCK- 4
GROUND COVERAGE = 389.612 SQ.M. = 4193.78 SFT.
GROUND FLOOR = 389.612 SQ.M. = 4193.78 SFT.
CAR PARKING SPACE = 342.01 SQ.M. = 3681.40 SFT.
TYP. (1ST. TO 4TH.) FLOOR = 387.05 SQ.M. = 4166.21 SFT. (EACH)
TOTAL FLOOR = 1937.812 SQ.M. = 20858.61 SFT.

AREA STATEMENT OF COMPLETED BLOCK- 5 (C.C. ISSUED)
GROUND COVERAGE = 389.612 SQ.M. = 4193.78 SFT.
GROUND FLOOR = 389.612 SQ.M. = 4193.78 SFT.
CAR PARKING SPACE = 134.34 SQ.M. = 1448.19 SFT.
TYP. (1ST. TO 4TH.) FLOOR = 387.05 SQ.M. = 4166.21 SFT. (EACH)
TOTAL FLOOR = 1937.812 SQ.M. = 20858.61 SFT.

AREA STATEMENT OF COMPLETED BLOCK- 6 & 7 (C.C. ISSUED)
GROUND COVERAGE = 1104.671 SQ.M. = 11890.68 SFT.
GROUND FLOOR = 1079.006 SQ.M. = 11614.42 SFT.
CAR PARKING SPACE = 476.470 SQ.M. = 5128.72 SFT.
TYP. (1ST. TO 4TH.) FLOOR = 1098.272 SQ.M. = 11812.80 SFT. (EACH)
TOTAL FLOOR = 5473.004 SQ.M. = 58801.62 SFT.

TOTAL COVERED AREA INCLUDING CAR PARKING SPACE = 16061.70 SQ.M. = 1,72,888.10 SFT.

TOTAL PODIUM AREA = 70.83 SQ.M. = 762.41 SFT.

SPECIFICATION

01. ALL DIMENSIONS ARE IN MM UNLESS OTHERWISE STATED.
02. ALL EXTERNAL WALLS ARE 200 TH. & ALL INTERNAL WALLS ARE 125 TH UNLESS OTHERWISE STATED.
03. THE DEPTH OF ALL W.F. & SEWER TANK SHALL NOT BE LESS THAN THE DEPTH OF FOUNDATION.
04. BRICK WORK 200 TH. WITH MORTAR 1:6. BRICK WORK 125 TH. WITH MORTAR 1:4.
05. ALL C.C. WORKS INCLUDING FOUNDATION SHALL BE DONE.
06. GRADE OF STEEL IS 415 I.S. CODE 178-1979.
07. ALL DETAILS OF PRECAST/CAST-IN-SITU SHALL BE TAKEN AT THE TIME OF CONSTRUCTION.
08. OTHERS ITEM ARE AS PER I.S. SPECIFICATION.

COLOR SPECIFICATION

PROPOSED AREA —	RED
EXISTING AREA —	YELLOW
SURFACE DRAIN	ROAD
WATER LINE	

CERTIFICATE OF BUILDING PLAN-

I/WE DO HEREBY CERTIFY THAT PLANS, ELEVATIONS & SECTIONS AND OTHER STRUCTURAL DETAILS OF THE PROPOSED BUILDING ON PLOT NO. 43, STREET, NABRUL ISLAM SARANI, WARD NO. 56 UNDER THE JURISDICTION OF MADHYAMGRAM MUNICIPALITY, NORTH 24 PARGANAS, WEST BENGAL, INDIA, HAVE BEEN PREPARED IN CONFORMITY WITH ALL RELEVANT PROVISIONS UNDER THE GENERAL BUILDING REGULATIONS, 2007 THIS IS ALSO TO CERTIFY THAT ALL RELEVANT 'NO OBJECTION' CERTIFICATE FROM THE RESPECTIVE AUTHORITIES SUCH AS FIRE & EMERGENCY SERVICES DEPARTMENT, AIRPORT AUTHORITY, POLLUTION CONTROL BOARD, TELECOMMUNICATIONS DEPARTMENT ETC. AS APPLICABLE IN THIS REGARD, ARE ALSO ENCLOSED WITH THE APPLICATION FOR SECURING APPROVAL OF THE PLAN TO CONSTRUCT/RECONSTRUCT/ ADDITION TO ALTERATION OF THE BUILDING ON THE SAID PLOT.

ARCHANJAN BANERJEE
M-Tech (CE, Geo)
License No. 10151/18/09/2017

SIGNATURE OF LICENSED BUILDING SURVEYOR OR ARCHITECT
NAME, ADDRESS & EMPANELMENT NO. (REGISTRATION NO.)

CERTIFICATE OF STRUCTURAL STABILITY:-
I/WE HEREBY CERTIFY THAT THE FOUNDATION & SUPERSTRUCTURE OF THE BUILDING PROPOSED FOR CONSTRUCTION ON PLOT NO. 43, STREET, NABRUL ISLAM SARANI, WARD NO. 56 UNDER THE JURISDICTION OF MADHYAMGRAM MUNICIPALITY, NORTH 24 PARGANAS, WEST BENGAL, INDIA, HAVE BEEN PERSONALLY INSPECTED AND SO DESIGNED BY ME/US WITH ALL RELEVANT PROVISIONS UNDER THE GENERAL BUILDING REGULATIONS, 2007 THIS IS ALSO TO CERTIFY THAT ALL RELEVANT 'NO OBJECTION' CERTIFICATE FROM THE RESPECTIVE AUTHORITIES SUCH AS FIRE & EMERGENCY SERVICES DEPARTMENT, AIRPORT AUTHORITY, POLLUTION CONTROL BOARD, TELECOMMUNICATIONS DEPARTMENT ETC. AS APPLICABLE IN THIS REGARD, ARE ALSO ENCLOSED WITH THE APPLICATION FOR SECURING APPROVAL OF THE PLAN TO CONSTRUCT/RECONSTRUCT/ ADDITION TO ALTERATION OF THE BUILDING ON THE SAID PLOT.

W. ANANTH CHATTERJEE
S.E. NO. 251
K.M.C.

TUSHARBARAN PARIKAR
P.E. (Structural)
Professional Engineer
No. 2172

SIGNATURE OF STRUCTURAL ENGINEER
NAME, ADDRESS & EMPANELMENT NO. (REGISTRATION NO.)

SIGNATURE OF GEO-TECHNICAL ENGINEER
NAME, ADDRESS & EMPANELMENT NO. (REGISTRATION NO.)

CERTIFICATE OF OWNER:-

CERTIFIED THAT I SHALL NOT AT LATER DATE MAKE ANY ADDITION OR ALTERATION TO THIS PLAN, CERTIFIED THAT I HAVE DONE THROUGH THE BILLS FOR MADHYAMGRAM MUNICIPALITY AND ALSO UNDER TAKE TO ABIDE BY THOSE RULES, REGULATIONS & AFTER THE CONSTRUCTION OF THE BUILDING, I shall
as Constituted Author of Mrs. Bharati Gupta as self and
Mrs. Shashi Prasad, Mr. Ramesh Kumar Gupta, Mr. Sanjay Gupta and
Authorized Signatures of Spotlight Finance & Consultancy Pvt. Ltd., Sunshri Infrastructure Pvt. Ltd., Classic Niketan Pvt. Ltd., Escorte Merchandise Pvt. Ltd., Gajendrapada Pvt. Ltd., Gupta Properties & Finance Pvt. Ltd., Gupta Towers Pvt. Ltd., Vignesh Developers Pvt. Ltd. and Pankaj Engineers Pvt. Ltd.

C. A. CONSTRUCTION
(A GROUP OF CIVIL ENGINEERS)
SHOP NO.-63, MADHYAMGRAM MUNICIPALITY MARKET COMPLEX, KOLKATA, 700129
PH. 0333 2539-8009

SCHEDULE OF DOORS & WINDOWS

DOOR MKD.	SIZE(LXH)	WIN. MKD.	SIZE(LXH)
D/W	1800X2100	W1	1800X1200
D1	1050X2100	W2	1500X1200
D2	975X2100	W3	900X1200
D3	900X2100	W4	750X600
D4	750X2100		

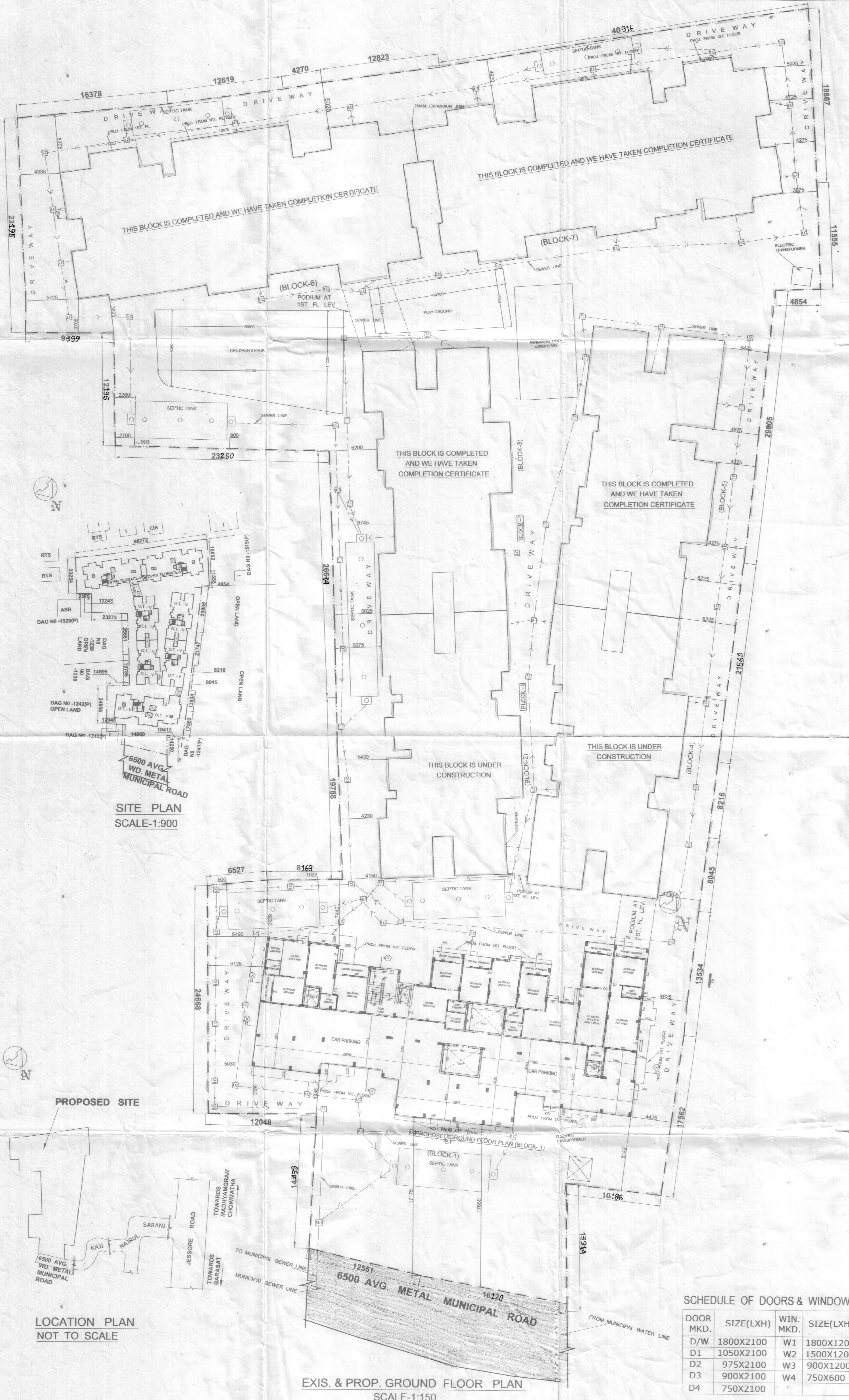

SITE PLAN SCALE:1:900



LOCATION PLAN NOT TO SCALE

EXIS. & PROP. GROUND FLOOR PLAN SCALE:1:150

