



APPROVED

PLAN No CB/403/19
RB/CB/18.8.19.10.1
APN
20.20
Date 30.06.2020

Commissioner
Durgapur Municipal Corporation

Mohan Lal Majee,
Planner-in-Charge, Building Plan,
Durgapur Municipal Corporation

Structural Safety Should be
Ensured by the Party.

BUILDING PLAN APPROVED
ON THE BASIS OF THE INDEMNITY
BOND, LAND MUTATION
& CONVERSION IS THE RESPONSIBILITY
OF THE OWNER

PERMISSION ACCORDED AS
PER ACT AND BUILDING
PLAN REGULATIONS & BYE-LAWS

DOOR - WINDOW SCHEDULE									
DOORS	WIDTH	HEIGHT	WINDOWS						
			MKD	WIDTH	HEIGHT	SILL	LINTEL		
D0	1200	2150	W0	1500	1500	650	2150		
D1	1100	2150	W1	1200	1700	450	2150		
D2	900	2150	W2	600	1700	450	2150		
D3	750	2150	W3	900	1050	1100	2150		
D4	1000	2150	W4	600	900	1250	2150		
SD1	2100	2150	SW	1200	1700	450	2150		
FCD	1200	2150	FG	VARIABLE	2000	150	2150		
RS	VARIABLE	2150	WF	WALL TO WALL WINDOW			2150		

- NOTES :-
1. ALL DIMENSIONS ARE IN MM. UNLESS OTHERWISE MENTIONED.
 2. ALL EXTERNAL WALLS ARE 200 THK & INTERNAL WALLS ARE 125 THK.
 3. IF NOT STATED IN 1:4 CEMENT SAND MORTAR.
 4. DEPTH OF SEPTIC TANK & UNDERGROUND WATER RESERVOIR SHOULD NOT EXCEED THE DEPTH OF FOUNDATION.
 5. GRADE OF CONCRETE & GRADE OF STEEL USED ARE M30 & M50 & Fe500 RESPECTIVELY.
 6. R.C.C. FRAMED STRUCTURE.
 7. ANY DISCREPANCY IN SCALE, THE WRITTEN DIMENSION SHALL GOVERN.
 8. FOR SPECIFICATION OF MATERIALS & WORKMANSHIP N.B.C. 2016 TO BE FOLLOWED.
 9. OPEN TERRACE WITH LIME TERRACING OF RATIO 2:2:7.
 10. DAMP PROOF COURSE TO BE PROVIDED WITH P.C.C. (1:2:4).

PROJECT :

PROPOSED ARCHITECTURAL PLAN FOR COMMERCIAL CUM RESIDENTIAL (APARTMENT) COMPLEX CONSISTING OF SINGLE TOWER HAVING 2 NOS. WING (A&B) OF G+10 STORED BUILDING (BY THE OF " SHRI KRISHNA KUNJ RESIDENCY" OF SRI DILIP KUMAR BARNWAL & OTHER'S OVER R.S. PLOT NO. - 217, 225, L.R. PLOT NO. - 597,768 L.R. KHATIAN NO. - 5984, 5985, 5986, 5990, 5991, 5992, 5993, 6006, 6008, 6009, 6010, 6105, 6106, AT MOUZA- FULJHORE, J.L. NO.-107 (OLD 82), P.S. - N.T.P.S, A.D.S.R. DURGAPUR, DIST - PASCHIM BARDHAMAN, PIN. NO-713206

SIGNATURE OF OWNER

Certified that I have gone through the building rules of Durgapur municipal (building) Corporation 2006 and its amendment & also undertake to abide by those rules during & after the construction of the building.

- | | | | |
|---|---------------------|----|---------------------|
| 1 | Dilip Kumar Barnwal | 8 | Bhukti Bhuan Mondal |
| 2 | Ranabkr. B. | 9 | Rita Devi Gupta |
| 3 | Bijay kr. Bhadani | 10 | Kazi Akbar Hossain |
| 4 | Pragyanmouly | 11 | Dr. Anil Kumar Das |
| 5 | Ritika Rani Gupta | 12 | Sanghamitesa Roy |
| 6 | Dwij Mondal | 13 | Dilip Ch. Das |
| 7 | Aashitparan | | |

SIGNATURE OF ARCHITECT

I/We do hereby certify that plans, elevations and sections and other structural details of the above said building have been prepared in conformity with all relevant provisions under Durgapur municipal (building) Corporation 2006. This also to certify that relevant "No Objection" certificates from the respective Authorities such as Fire and Emergency Services Department, Airport Authority, Pollution Control Board, Telecommunication Department etc as applicable in this regard are also enclosed with the application for seeking approval of the plan to construction /reconstruct/ addition to alteration of the building on the said Plot.

KAMAL KUMAR PERIHAL
CA 15/10/20

SIGNATURE OF GEOTECHNICAL ENGINEER

DR. SUJIT KUMAR BOSE
Ph.D., M.C.E. (Smt), B.C.E. (Hons.)
MIGS, MIR
Empowered Geotechnical
Engineer (I) under KMC
License No: GT-12

SIGNATURE OF ARCHITECT / ENGINEER

SANJIB GUHA
STRUCTURAL CONSULTANT
BSC, BICE, P.E. Chartered Engineer
Structural Reviewer (I.M.C.)
Empowered No. - ESR (I) 88/16
Structural Reviewer (NDA)
Empowered No. - STER/NDA/16/00003

CHANDI PROSAD KHANRA
BE (Civil), ME (Struct.), MIE (India)
ESE-12

TITLE : FIRST FLOOR PLAN 7TH FLOOR PLAN

DRG. NO.	MAHESHWARI SUBMISSION/ARCB-01
REV. DATE	
SCALE	1:100
DATE	06.07.2020
DRWG. BY	ADRIKA
CHECKED	BIBER

ARCHITECT : MAHESHWARI & ASSOCIATES
37A, BAKER ROAD, 2ND. FLOOR,
Tel : 65334966,
www.architectmaheshwari.com KOLKATA - 71

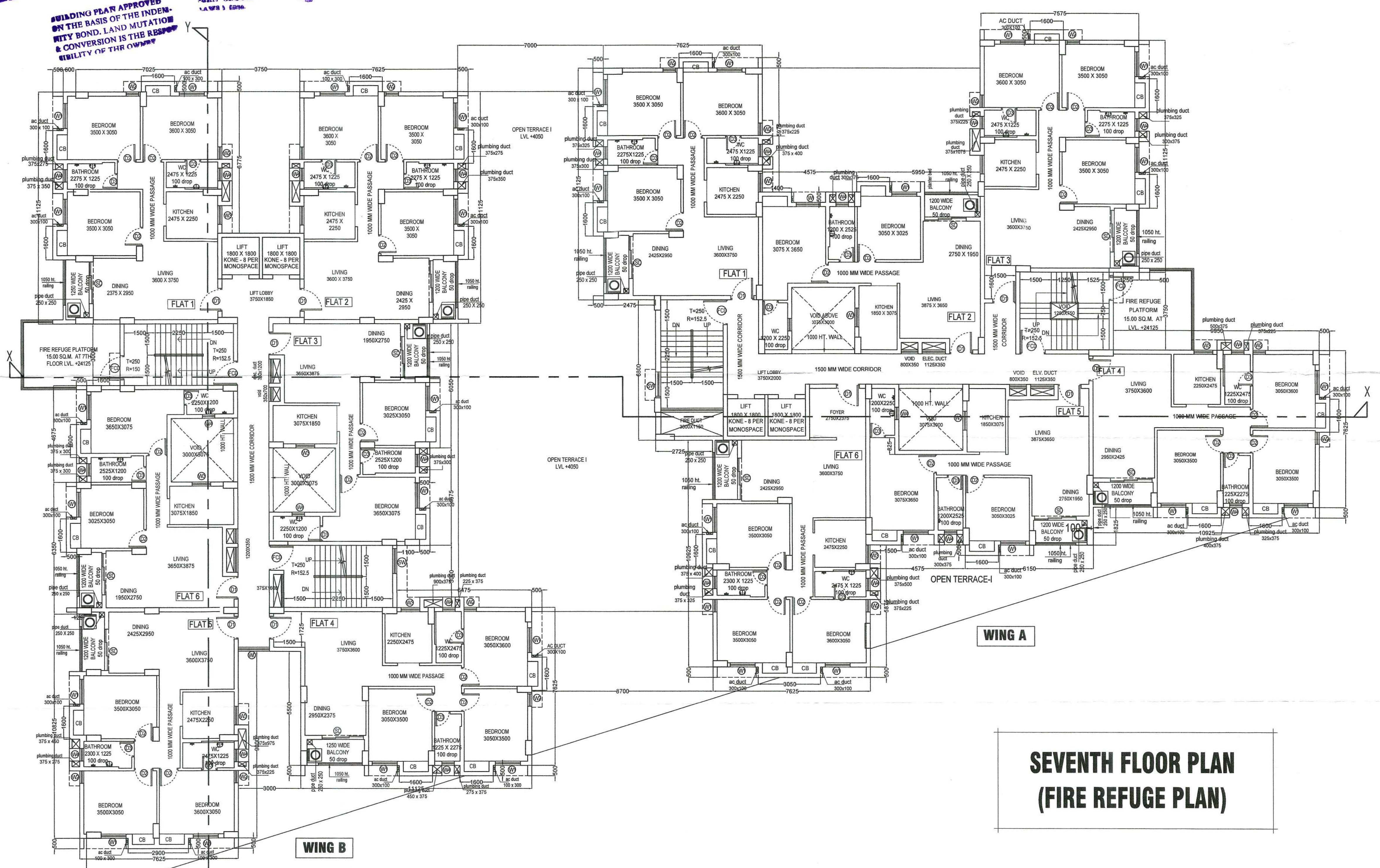

SEVENTH FLOOR PLAN
(FIRE REFUGE PLAN)