

**LOCATION PLAN**  
SCALE - 1:4000

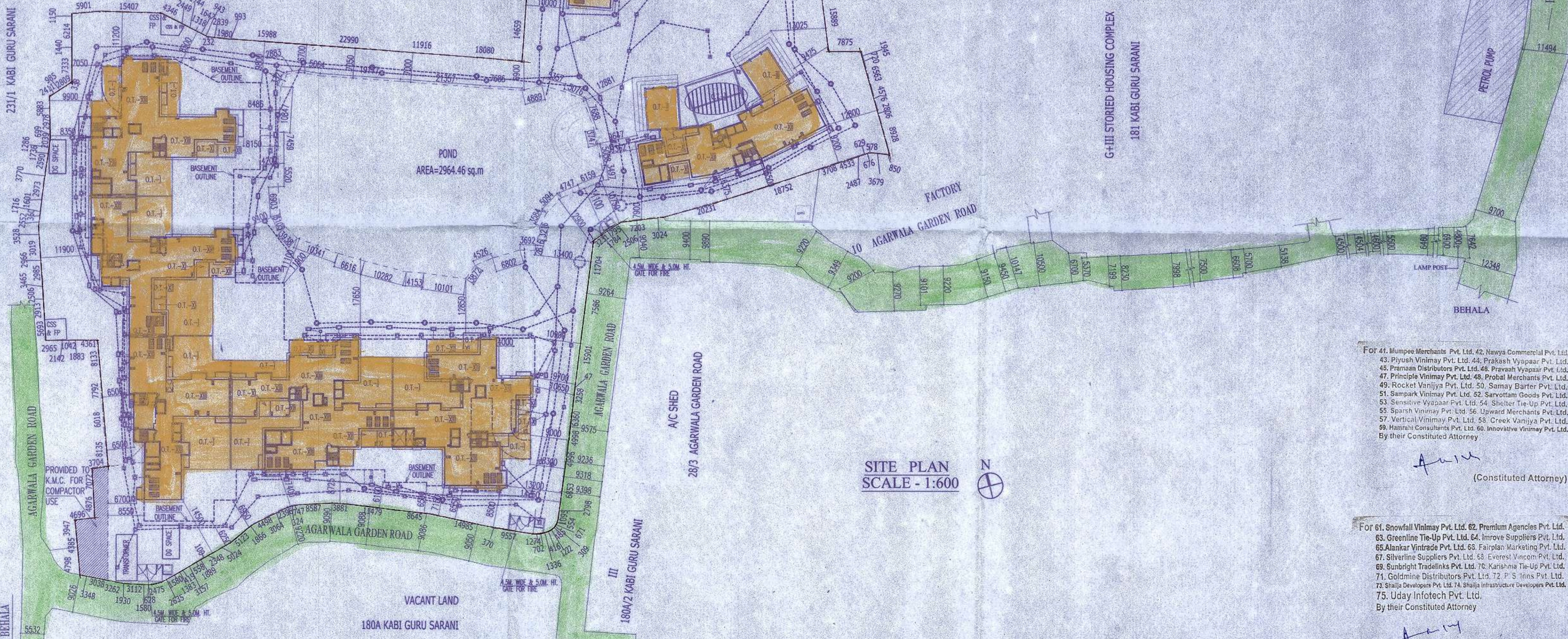

**SITE PLAN**  
SCALE - 1:600

For 1. Clarity Barter Pvt. Ltd. 2. Himadri Tieup Pvt. Ltd. 3. Kalindi Agency Pvt. Ltd. 4. Anurag Enclave Pvt. Ltd. 5. Anurag Hirise Pvt. Ltd. 6. Gurukul Consultant Pvt. Ltd. 7. Matrubhumi Tieup Pvt. Ltd. 8. Siddharth Advisory Services Pvt. Ltd. 9. Uplink Commercial Pvt. Ltd. 10. Umabala Infrastructure Pvt. Ltd. 11. Khazana Tieup Pvt. Ltd. 12. Shree Vinayak Villa Pvt. Ltd. 13. Umabala Hirise Pvt. Ltd. 14. Kyal Promoters Pvt. Ltd. 15. Kyal Hirise Pvt. Ltd. 16. Kyal Realestate Pvt. Ltd. 17. Kyal Residency Pvt. Ltd. 18. Kyal Complex Pvt. Ltd. 19. Kyal Realtors Pvt. Ltd. 20. Lakshya Distributors Pvt. Ltd. By their Constituted Attorney

For 21. Sherwin Distributors Pvt. Ltd. 22. Parmita Tieup Pvt. Ltd. 23. Stendal Tieup Pvt. Ltd. 24. Liberal Barter Pvt. Ltd. 25. Shree Barter Pvt. Ltd. 26. Lily Advisory Services Pvt. Ltd. 27. Sheshil Advisory Pvt. Ltd. 28. Kyal Housing Pvt. Ltd. 29. Rishi Complex Pvt. Ltd. 30. Rishi Enclave Pvt. Ltd. 31. Anchal Barter Pvt. Ltd. 32. Adash Goods Pvt. Ltd. 33. Akriti Goods Pvt. Ltd. 34. Anmol Barter Pvt. Ltd. 35. Anubhav Sales Pvt. Ltd. 36. Astha Barter Pvt. Ltd. 37. Compare Vaniya Pvt. Ltd. 38. Gurukul Vaniya Pvt. Ltd. 39. Mantra Vyapaar Pvt. Ltd. 40. Megamart Merchants Pvt. Ltd. By their Constituted Attorney

**CERTIFICATE OF STRUCTURAL ENGINEER.**

THIS IS TO CERTIFY THAT THE STRUCTURAL DESIGN AND DRAWINGS OF BOTH FOUNDATION AND SUPER STRUCTURE OF THE BUILDING HAS BEEN MADE BY ME CONSIDERING ALL POSSIBLE LOADS INCLUDING THE SEISMIC LOAD AS PER THE NATIONAL BUILDING CODE OF INDIA AND CERTIFIED THAT IT IS SAFE AND STABLE IN ALL RESPECTS. SOIL TEST REPORT IS PREPARED BY M/S BOSE ENGINEERS OF -74/11, SULTAN ALAM ROAD, KOLKATA-700033

**SANJIV J. PAREKH**  
M.E.(STRUCT), B.C.E., PGCCM,  
C(ENG)-1, MSCE, ASCE, FIE-(F-018202-4)  
E.S.E. No. 104 (I) K.M.C.

SIGNATURE OF STRUCTURAL ENGG.

**SANJIV GUHA**  
BSC BCC FIE-(F-116854-6)  
CHARTERED ENGINEER  
ENLISTED STRUCTURAL  
REVIEWER 88/16 K.M.C.

SIGNATURE OF STRUCTURAL REVIEWER.

**CERTIFICATE OF ARCHITECT.**

I DO HERE BY CERTIFY WITH FULL RESPONSIBILITY THAT THE BUILDING PLAN HAS BEEN DRAWN UP AS PER K.M.C. BUILDING RULE-2009 AS AMENDED FROM TIME TO TIME THAT THE WIDTH OF THE BUTTING ROAD CONFORM WITH THE PLAN AND IT IS A BUILDABLE SITE NOT A TANK OR A FILLED UPTANK. THE SITE PLAN KEY PLAN AGREES WITH THE SITE. THE PLOT IS DEMARCATED BY BOUNDARY WALLS & MEASUREMENTS TALLY WITH THE REGD. DEED PLAN. THE EXISTING STRUCTURE AS SHOWN FULLY OCCUPIED BY OWNERS AS PER OWNERS UNDERTAKING.

**JAY PRAKASH BHARAT KUMAR AGRAWAL**  
B. Arch., A.I.I.A.  
Reg. No. CA / 86 / 10098  
ARCHITECT SL. NO. - 32(A)

SIGNATURE OF ARCHITECT.

**TITLE SITE PLAN & LOCATION PLAN.**

**PROJECT-**  
PLAN SHOWING CHANGES U/R 2(a)&(2b) OF KMC BUILDING RULE-2009 OF RESIDENTIAL COMPLEX WITH BLOCK-1 (G+XI), BLOCK-2 TO 4 (B+G+XI) AND BLOCK-5 (B+G+XI) AT PREMISES NO. 49A, MONMOHAN BANERJEE ROAD, KOLKATA-700 038 WARD NO. - 118, BOROUGH - XIII, P.S - BEHALA, SANCTIONED VIDE B.P. NO.2017130182 DATED 16/12/2017, SUPERSADING B.P. NO. 2015130048 DATED 18/05/2015

N	ARCHITECTS		CHECKED
	AGRAWAL & AGRAWAL	KOLKATA	
SCALE	DATE	DEALT	
1:4000, 1:600	05.07.18	ANINDITA	SHILA

**PARTY'S COPY**

Sheet No. :- 33/35

008/2017/26(2a)(2b) 18-19 08-30/08/18

This Plan is To Be Treated As Part  
And Parcel And Contiguous To  
B. S. Plan No. 2017/26(2a)(2b)  
Dated 22/12/17  
Ex. Engineer (C-B)  
Bor. No. :- 2017

Approved as per approval of 26(2) dt. 20/08/18

KOLKATA MUNICIPAL CORPORATION  
BUILDING DEPTT.  
PLANS APPROVED U/R 26 (2a) & (2b) of  
C.M.C. BUILDING RULES 2009  
B.P. No. 187 Br. No. 2017 Dtd. 22/12/17  
Assistant Engineer Ex. Engr. (Civil)  
Br. No. 2017 Br. No. 2017

BUILDING DEPARTMENT  
30 AUG 2018  
THE KOL. MUNICIPAL CORP.