

A. STAMP FOR K.M.C.



THE STATE OF KERALA
 ARCHITECTURAL REGULATIONS
 ACT 1968
 SECTION 10
 REGISTERED ARCHITECT
 VIVEK SINGH PANTHORE
 No. 10000/2019

KOLKATA MUNICIPAL CORPORATION
 PLANS APPROVED BY 25/12/2019 & 15/04/20
 BY VIVEK SINGH PANTHORE
 No. 10000/2019
 5 P. No. 10000/2019
 Registered Engineer
 No. 10000/2019

B. GENERAL NOTES:
 1. ALL DIMENSIONS ARE IN MILLIMETERS UNLESS OTHERWISE SPECIFIED.
 2. ALL EXTERNAL PLASTER ARE 15MM THK AND INTERNAL PLASTER ARE 12.5MM THK.
 3. ALL EXTERNAL WALLS ARE 200 THK & INTERNAL PARTITION WALLS ARE 125 THK UNLESS OTHERWISE MENTIONED.
 4. ALL ELECTRICAL AND PLUMBING WORKS ARE CONSIDERED AS PER STANDARD PRACTICES.
 5. TOILETS ARE VENTILATED BY MEANS OF MECHANICAL VENTILATION WHEREVER NATURAL VENTILATION IS NOT POSSIBLE.

C. SCHEDULE OF DOORS, WINDOWS & FIXED GLAZING.

SCHEDULE OF DOORS		
TYPE	WIDTH	HEIGHT
D1	750	2100
D2	900	2100
D3	900	2100
D4	1100	2100
D5	1100	2100
D6	1500	2100
D7	1800	2100
D8	1800	2100
D9	2100	2100
D10	2100	2100
D11	2100	2100
D12	2100	2100
D13	2100	2100
D14	2100	2100
D15	2100	2100
D16	2100	2100
D17	2100	2100
D18	2100	2100
D19	2100	2100
D20	2100	2100
D21	2100	2100
D22	2100	2100
D23	2100	2100
D24	2100	2100
D25	2100	2100
D26	2100	2100
D27	2100	2100
D28	2100	2100
D29	2100	2100
D30	2100	2100
D31	2100	2100
D32	2100	2100
D33	2100	2100
D34	2100	2100
D35	2100	2100
D36	2100	2100
D37	2100	2100
D38	2100	2100
D39	2100	2100
D40	2100	2100
D41	2100	2100
D42	2100	2100
D43	2100	2100
D44	2100	2100
D45	2100	2100
D46	2100	2100
D47	2100	2100
D48	2100	2100
D49	2100	2100
D50	2100	2100
D51	2100	2100
D52	2100	2100
D53	2100	2100
D54	2100	2100
D55	2100	2100
D56	2100	2100
D57	2100	2100
D58	2100	2100
D59	2100	2100
D60	2100	2100
D61	2100	2100
D62	2100	2100
D63	2100	2100
D64	2100	2100
D65	2100	2100
D66	2100	2100
D67	2100	2100
D68	2100	2100
D69	2100	2100
D70	2100	2100
D71	2100	2100
D72	2100	2100
D73	2100	2100
D74	2100	2100
D75	2100	2100
D76	2100	2100
D77	2100	2100
D78	2100	2100
D79	2100	2100
D80	2100	2100
D81	2100	2100
D82	2100	2100
D83	2100	2100
D84	2100	2100
D85	2100	2100
D86	2100	2100
D87	2100	2100
D88	2100	2100
D89	2100	2100
D90	2100	2100
D91	2100	2100
D92	2100	2100
D93	2100	2100
D94	2100	2100
D95	2100	2100
D96	2100	2100
D97	2100	2100
D98	2100	2100
D99	2100	2100
D100	2100	2100

SCHEDULE OF WINDOWS

TYPE	WIDTH	HEIGHT
W1	600	1200
W2	600	1200
W3	600	1200
W4	600	1200
W5	600	1200
W6	600	1200
W7	600	1200
W8	600	1200
W9	600	1200
W10	600	1200
W11	600	1200
W12	600	1200
W13	600	1200
W14	600	1200
W15	600	1200
W16	600	1200
W17	600	1200
W18	600	1200
W19	600	1200
W20	600	1200
W21	600	1200
W22	600	1200
W23	600	1200
W24	600	1200
W25	600	1200
W26	600	1200
W27	600	1200
W28	600	1200
W29	600	1200
W30	600	1200
W31	600	1200
W32	600	1200
W33	600	1200
W34	600	1200
W35	600	1200
W36	600	1200
W37	600	1200
W38	600	1200
W39	600	1200
W40	600	1200
W41	600	1200
W42	600	1200
W43	600	1200
W44	600	1200
W45	600	1200
W46	600	1200
W47	600	1200
W48	600	1200
W49	600	1200
W50	600	1200
W51	600	1200
W52	600	1200
W53	600	1200
W54	600	1200
W55	600	1200
W56	600	1200
W57	600	1200
W58	600	1200
W59	600	1200
W60	600	1200
W61	600	1200
W62	600	1200
W63	600	1200
W64	600	1200
W65	600	1200
W66	600	1200
W67	600	1200
W68	600	1200
W69	600	1200
W70	600	1200
W71	600	1200
W72	600	1200
W73	600	1200
W74	600	1200
W75	600	1200
W76	600	1200
W77	600	1200
W78	600	1200
W79	600	1200
W80	600	1200
W81	600	1200
W82	600	1200
W83	600	1200
W84	600	1200
W85	600	1200
W86	600	1200
W87	600	1200
W88	600	1200
W89	600	1200
W90	600	1200
W91	600	1200
W92	600	1200
W93	600	1200
W94	600	1200
W95	600	1200
W96	600	1200
W97	600	1200
W98	600	1200
W99	600	1200
W100	600	1200

* ARTIFICIAL LIGHTING AND MECHANICAL VENTILATION

FOR APPROVAL BY THE ARCHITECTURAL OFFICE OF THE MUNICIPAL CORPORATION, KOLKATA.

SIGNATURE OF OWNER: GANESH DEB BURDORF EMPORIS PROPERTIES PVT LTD

CERTIFICATE OF STRUCTURAL ENGINEER

SIGNATURE OF STRUCTURAL ENG: SANJIV J. PAREKH (ESE/1/14)

CERTIFICATE OF ARCHITECT

SIGNATURE OF ARCHITECT: VIVEK SINGH PANTHORE (CA2001/29/182)

TITLE: BASEMENT FLOOR PLAN

PROJECT: PROJECT CHANGES U/R 36/24/20 OF K.M.C. BLDG. NO. 20717 FOR PROPOSED PLAN OF 8+8+10 STOREY RESIDENTIAL BLDG. AT 17/1, BOROUGHS NO. 17, KOLKATA 700016 HEIGHT - 40M. U/S - 303A OF KOLKATA MUNICIPAL CORPORATION / ACT - 1980

ARCHITECTS: VIVEK SINGH PANTHORE

SCALE: 1:200

SHEET NO. 01

DATE: 25.04.17

DEALT: 51

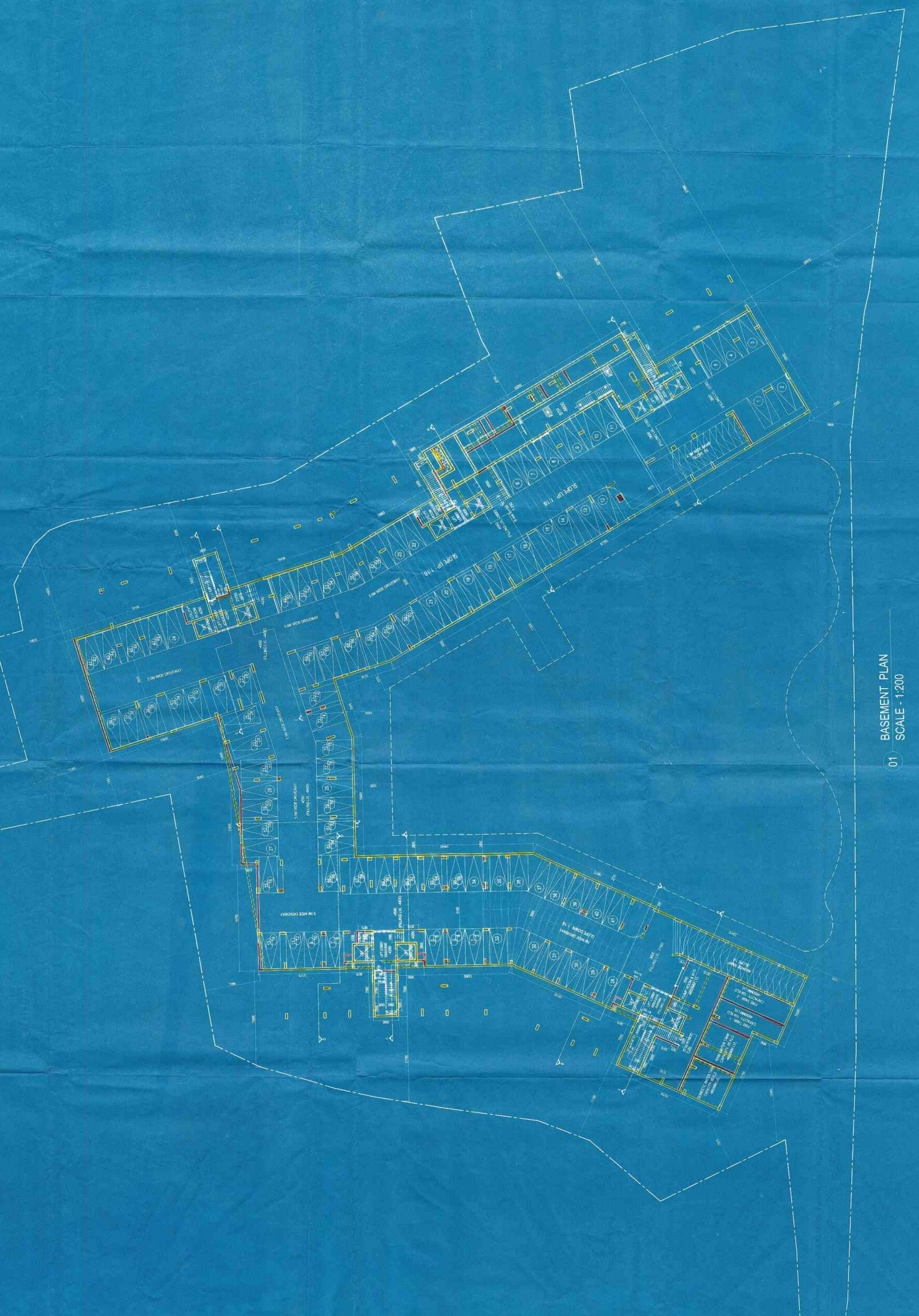

01 BASEMENT PLAN
 SCALE - 1:200

