

Member:
Chattopadhyay Council
Kamarpatti Municipality

Chairman
Kamarpatti Municipality

APPROVED
25 DEC 2014

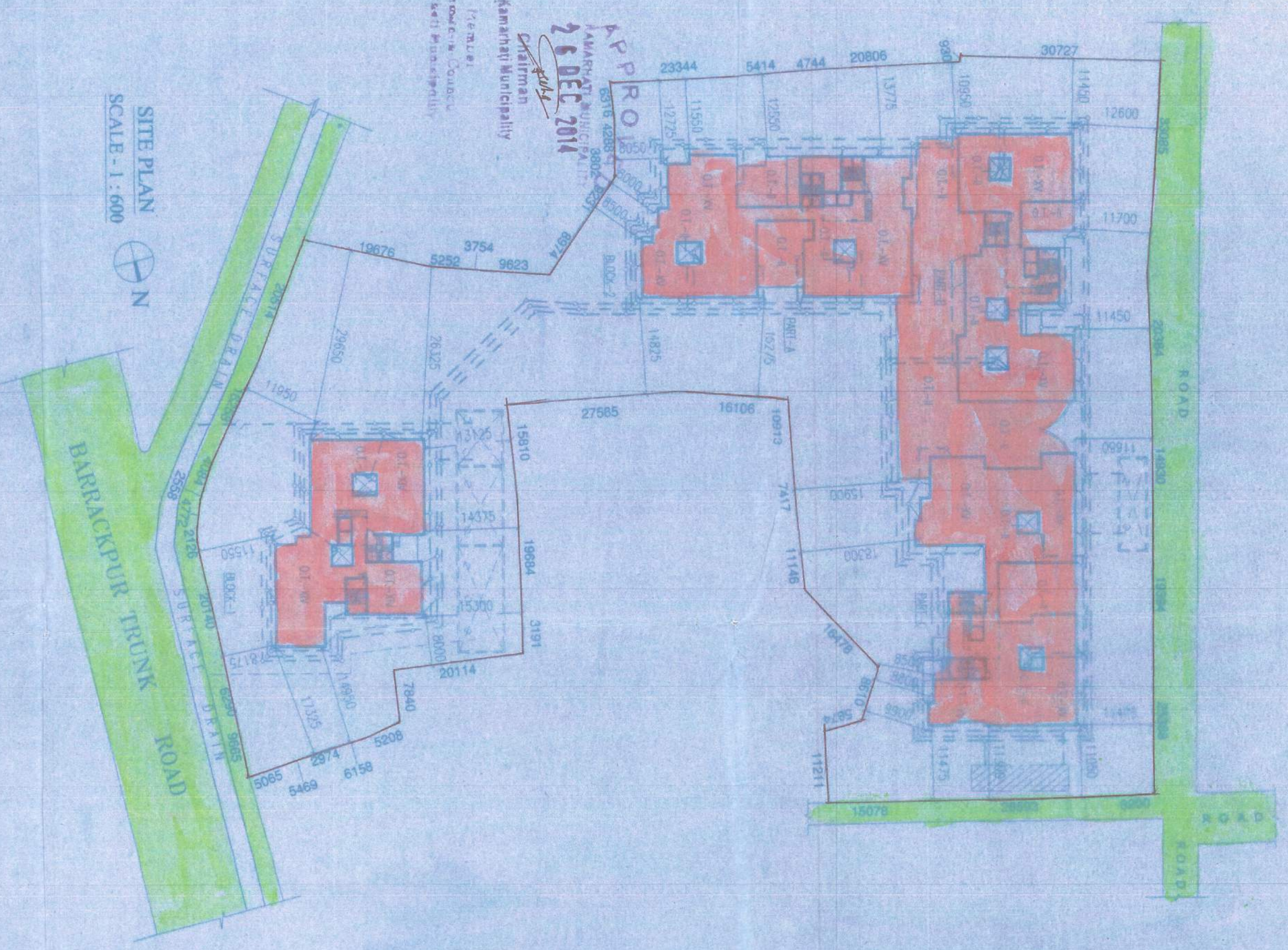

SITE PLAN
SCALE - 1 : 600

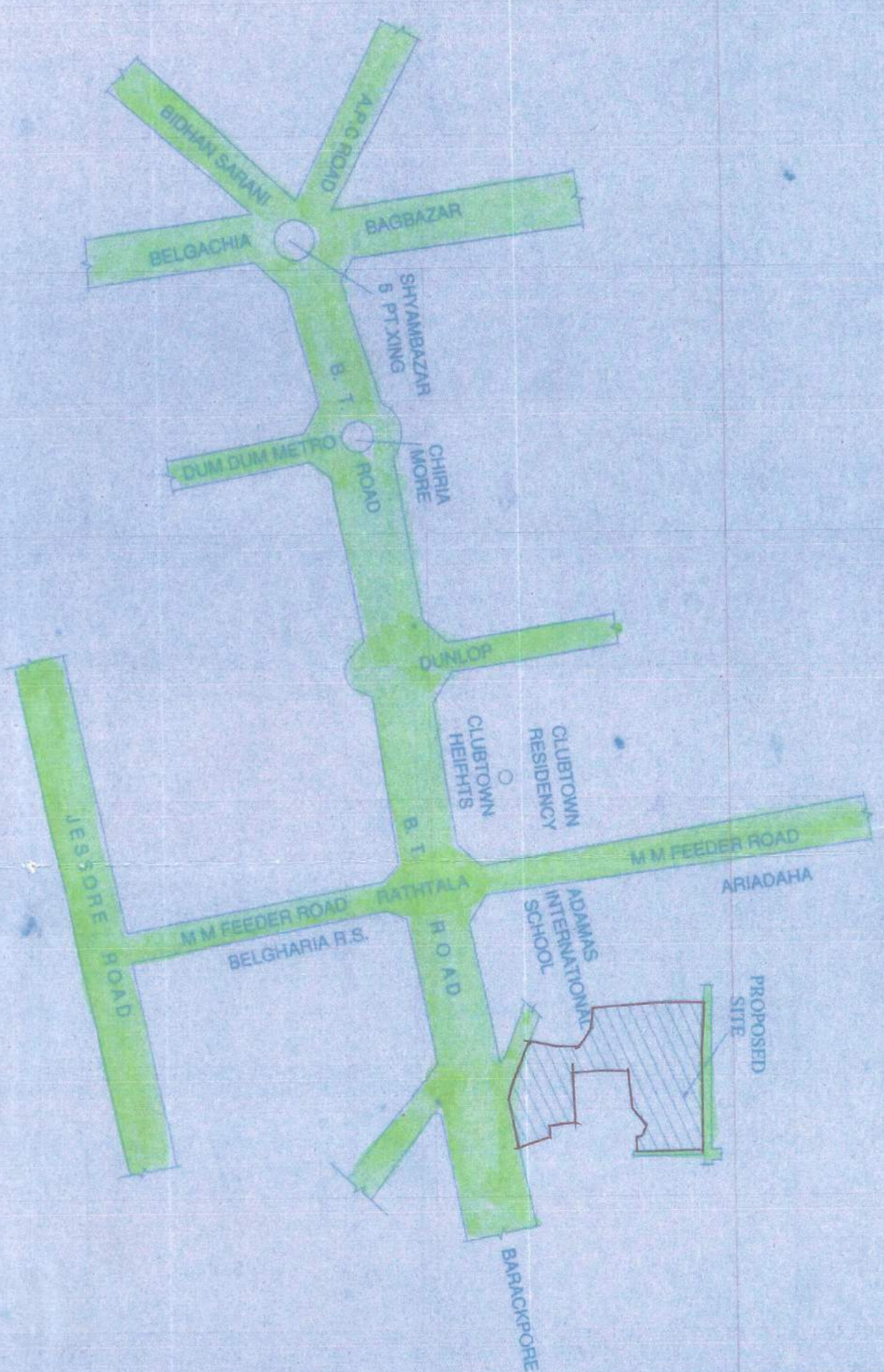

LOCATION PLAN
SCALE - 1 : 4000

AREA STATEMENT :-

1. LAND AREA	=	10071.00 SQ.M.
2. PERMISSIBLE F.A.R.	=	3.00
3. PERMISSIBLE GROUND COVERAGE (45.00%)	=	4592.22 SQ.M.
4. PROPOSED GROUND COVERAGE (32.10%)	=	3489.64 SQ.M.
5. PERMISSIBLE BUILT-UP AREA (EXCL. EXEMPTED AREAS GIVEN BELOW)	=	32614.80 SQ.M.
6. NO. OF BLOCK - 2 NOS.		
7. REQUIRED 8% RESERVED AREA PROVIDED	=	805.73 SQ.M.
8. PROPOSED F.A.R.	=	881.96 SQ.M.
9. NO. OF TENEMENT	=	2342
10. TOTAL TENEMENT AREA	=	22710.30 SQ.M.
TENEMENT AREA IN BLOCK - 1 (468.94 X 13)	=	6106.22 SQ.M.
TENEMENT AREA IN BLOCK - 2 (1624.18 X 13)	=	21114.08 SQ.M.
11. REQUIRED CAR PARKING FOR RESIDENTIAL PART	=	208 NOS.
a) FOR 600 SQ.M. @ 150 SQ.M. / CAR	=	04 NOS.
b) FOR (6000 - 600) SQ.M. @ 140 SQ.M. / CAR	=	31 NOS.
c) FOR (27210.17 - 5000) SQ.M. @ 120 SQ.M. / CAR	=	171 NOS.
12. PROVIDED CAR PARKING AREA (421.89 + 2020.66 + 2557.16) = 4999.71 SQ.M.		
13. PROPOSED AREAS:-		
(i) FIRE PUMP ROOM AREA	=	47.10 SQ.M.
(ii) GROUND FLOOR AREA:		
BLOCK 1 -	=	545.11 SQ.M.
BLOCK 2 -	=	2793.78 SQ.M.
TOTAL	=	3338.89 SQ.M.
(iii) FIRST FLOOR AREA:		
BLOCK 1 -	=	533.08 SQ.M.
BLOCK 2 -	=	2836.85 SQ.M.
TOTAL	=	3369.93 SQ.M.
(iv) TYPICAL FLOOR (2ND TO 13TH) AREA:		
BLOCK 1 -	=	639.08 SQ.M.
BLOCK 2 -	=	6179.96 SQ.M.
PART A (681.63 X 12)	=	8179.96 SQ.M.
PART B (658.15 X 12)	=	6796.80 SQ.M.
PART C (723.34 X 12)	=	6590.08 SQ.M.
TOTAL	=	29968.40 SQ.M.
(v) 14TH FLOOR AREA:		
BLOCK 2 -		
PART A	=	681.63 SQ.M.
PART B	=	659.15 SQ.M.
PART C	=	723.34 SQ.M.
TOTAL	=	1964.12 SQ.M.

PROPOSED TOTAL BUILT-UP AREA (INCL. EXEMPTED AREAS GIVEN BELOW)

14. TOTAL AREA EXEMPTED FOR F.A.R. CALCULATION (a + b + c)	=	6699.32 SQ.M.
a) CAR PARKING AREA ADVANTAGE:		
BLOCK - 1	=	421.89 SQ.M.
BLOCK - 2	=	4095.00 SQ.M.
TOTAL	=	4516.89 SQ.M.
b) TOTAL AREA OF STAIRWAYS	=	(420.75 + 1407.89) SQ.M.
	=	1828.63 SQ.M.
@ 6 SQ.M. IN 15 FLS. OF BLD. 2 (PART A, B & C)	=	354.00 SQ.M.
15. PROPOSED F.A.R. =	33936.44 + 6699.32	= 2.942
16. TOTAL REQUIRED CAR PARKING	(206+05)	= 211 NOS.
17. PROVIDED CAR PARKING		= 233 NOS.
TOTAL COVERED		= 159 NOS.
BLOCK - 1		= 19 NOS.
BLOCK - 2 (PART A, B & C) (77 GR. LVL. 483 1ST. FL. LVL.)		= 139 NOS.
OPEN		= 125 NOS.

CERTIFICATE OF OWNER
CERTIFIED THAT I HAVE GONE THROUGH THE BUILDING RULES FOR KAMARPATI MUNICIPALITY AND ALSO UNDER TAKE TO ABIDE BY THOSE RULES DURING AND AFTER CONSTRUCTION OF THE BUILDING.

For PAMPHATI RUBBER LIMITED
CONSTITUTED ATTORNEY
BLUE FOX PROJECTS PVT. LTD.
DIRECTOR / AUTHORIZED SIGNATORY

SANJIV J. PAREKH
M.E. (STRUCT.), B.C.E., F.C.C.M.
C/ENGL-17, MSCOE ASCE, FIE (F-03202-4)
E.S.E. NO. 104 (I) K.M.C.

SIGN OF STRUCTURAL ENGG

JAY PRAKASH AGRAWAL
B ARCH, A.I.I.A.
Reg. No. CA/867/10098
SIGNATURE OF ARCHITECT

TITLE
SITE PLAN & LOCATION PLAN.

PROJECT
PROPOSED PLAN OF (G+XIII) & (G+XIV) STORED RESIDENTIAL BUILDING AT MOULDA-ARIADAH, KAMARPATI, PREMISES NO. - 36 DNG NO. - 3439, 3442, 3443, 3444, 3446, 3449, 3450, 3451, 3452, 3453, 3454, 3455, 3456, 3457 & 3459 HOLDING NO. - F-20 UNDER WARD NO. 8 UNDER KAMARPATI MUNICIPALITY, P.S. KHATIAN NO. - 21, 877, 907, 2991 & 2992, T.L.NO. - 01-TOLZI NO.-173, P.S. BELGHARIA FORMERLY BARANAGAR, UNDER DIST. - 24 PRAG (N).

ARCHITECTS	AGRAWAL & AGRAWAL	KOLKATA	CHECKED	SUPRIYA
SCALE	1:200	DATE	11.11.14	FINBY