

AISWARYA KR. DEBNATH

CIVIL ENGINEER

K.M.C. Registered L. B. S. No (1304 / II)

83/4D/4, Barisha Purba Para Road, Kolkata- 700063, Ph.-8017110880

o Planner o Estimator o Surveyor o Consulting Engineer

Ref.....

Date.....

LOCATION PLAN FOR MAJUMDAR CONSTRUCTION'S PROJECT AT PREMISES NO.- 3, CHANDI CHARAN GHOSH ROAD, K.M.C. WARD NO.- 124.



SITE CO-ORDINATES

22 28 34.53N 88 18 37.89E, 22 28 35.53N 88 18 37.99E
22 28 34.49N 88 18 38.40E, 22 28 35.49N 88 18 38.49E

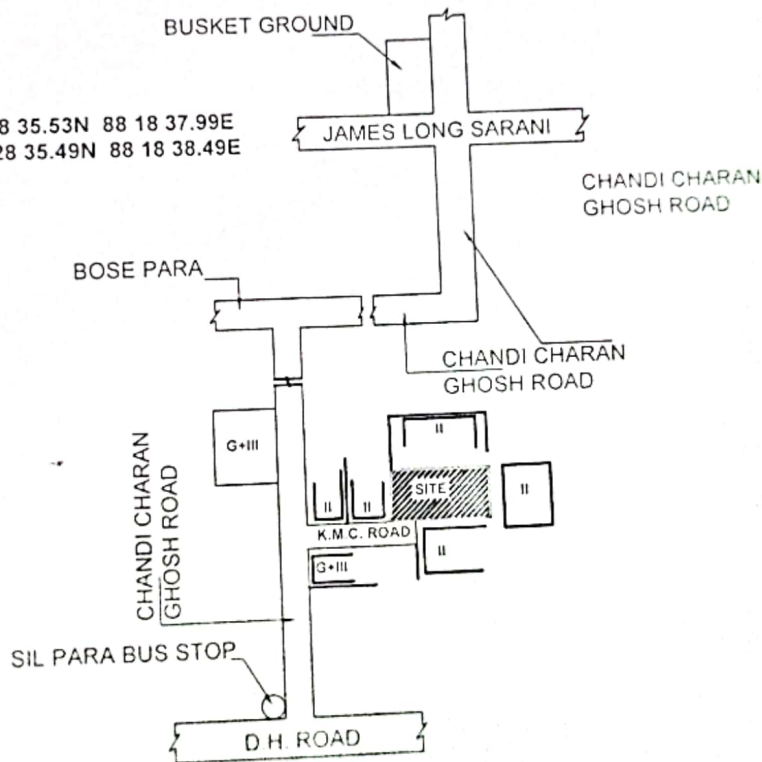

LOCATION PLAN

SCALE - 1:600

(Signature)
AISWARYA KR. DEBNATH
 K.M.C. REGD. L.B.S.
 REGD. No.- 1304 (II)