

SITE PLAN
SCALE: 1:800

LOCATION PLAN
SCALE: 1:4000

PROPOSED RESIDENTIAL BUILDING AT B.C. ROY ROAD

LAND AREA AS PER DEED	LAND AREA AS PER PHYSICAL MEASUREMENTS	AREA OF POND AS PER SITE	AREA RELEASED FOR WIDENING OF ROAD	NET LAND AREA	PERMISSIBLE GROUND COVERAGE @ 50%	CONSUMED GROUND COVERAGE
8116.37	6305.39	6071.735	6071.735	6064.915	3032.457	3032.457
8039.95	6271.735	593.36	593.36	593.36	296.68	296.68
402.72	93.3	93.3	93.3	93.3	46.65	46.65
9.3	9.3	9.3	9.3	9.3	4.665	4.665
3030.13	6064.915	6064.915	6064.915	6064.915	3032.457	3032.457
1515.065	3030.96	3030.96	3030.96	3030.96	1515.48	1515.48
1340.22	2478.54	2478.54	2478.54	2478.54	1239.27	1239.27
44.895	39.7395	39.7395	39.7395	39.7395	19.86975	19.86975
	10147.8	10147.8	10147.8	10147.8	5073.9	5073.9
	2.25	2.25	2.25	2.25	1.125	1.125
6066.26	11639.31	11639.31	11639.31	11639.31	5819.655	5819.655
5533.31	6748.70	6748.70	6748.70	6748.70	3374.35	3374.35
1.83	1.117	1.130	1.130	1.130	0.565	0.565
48	54.42	57.25	57.25	57.25	28.625	28.625
53	53	64	64	64	32	32
52	71	84	84	84	42	42
TOTAL FLOOR AREA	6784.76	8181.91	8244.72	16418.63		

Constituted Attorney For
 STARLITE INFRACON PVT. LTD.
 Director

SIGNATURE OF OWNERS
 DECLARATION OF E.B.A.
 I HAVE CERTIFIED ON THE PLAN ITSELF WITH FULL RESPONSIBILITY THAT BUILDING RULES 2007 AS AMENDED FROM TIME TO TIME AND THAT THE SITE CONDITIONS INCLUDING THE ADJOINING ROAD CONFORM WITH THE PLAN AND THAT IT IS A BUILDABLE SITE AND NOT A TANK OR A FILLED UP LAND.

SIGNATURE OF ARCHITECT
 MUKUL MITTRA
 B.Arch (HONS.), F.I.A.I.V
 EMPANELMENT NO. 666/RIPS ON/EBA/2008-09

CERTIFICATE OF STRUCTURAL STABILITY
 I HEREBY DECLARE THAT THE FOUNDATION AND SUPER-STRUCTURE OF THE BUILDING PROPOSED FOR CONSTRUCTION ON R.S. DAG NO. 3102,3103,3139, LR 3140,3141,3220,3143,3142, RS 3106,3168 & 3105 KHATTIAN NO- RS 666,684/2,468,712,573,83,60,643,674, 1367,1642,411,3115/1 & 1648 J.L. NO- 71, MOUZA - JAGADDAL, WARD NO- 25, HOLDING NO- 11 UNDER RAJPUR SONARPUR MUNICIPALITY, HARINAVI, KOLKATA - 700 148 HAVE BEEN SO DESIGNED BY ME THAT IT WILL MAKE SUCH FOUNDATION AND SUPER-STRUCTURE SAFE IN ALL RESPECT INCLUDING THE CONSIDERATION OF BEARING CAPACITY OF SOIL ETC.

SIGNATURE OF STRUCTURAL ENGINEER
 BIBEK BIKASH MULLICK
 Rajpur Sonarpur Municipality
 E.S.E. 021

SIGNATURE OF STRUCTURAL REVIEWER
 KAUSHIK SENGUPTA
 B.E. (CIVIL), M.E. (STRUCTURE)
 EMPANELMENT NO.- ESE-039

SIGNATURE OF GEO-TECHNICAL ENGINEER
 ALOK ROY
 B.E. (CIVIL), M.C.E. (FOUNDATION ENGG.)
 EMPANELMENT NO.- GT/008

PROJECT TITLE :
 PROPOSED G+XII,G+V(2 NOS),G+IV STORIED RESIDENTIAL BUILDING AT R.S. DAG NO. - 3102,3103,3139, LR3140,3141,3220,3143,3142,RS 3106,3168 & 3105 KHATTIAN NO- RS 666,684/2,468,712,573,83,60, 643,674,1367,1642,411,3115/1 & 1648 J.L. NO- 71, MOUZA - JAGADDAL, WARD NO- 25, HOLDING NO- 11, DR. B.C. ROY ROAD UNDER RAJPUR SONARPUR MUNICIPALITY, HARINAVI, KOLKATA - 700 148
PREV. SANC. NO. : 1297/C/25/21 DATED - 13/01/2014
NAME OF OWNER = M/S STARLITE INFRACON PVT LTD & OTHERS

TITLE :
MASTER LAYOUT

SITE PLAN WITH SITE SERVICES, SITE PLAN, LOCATION PLAN & SITE PLAN SHOWING EXISTING STRUCTURE TO BE DEMOLISHED

PROJECT ARCHITECT :-
 CONSULTANTS FOR HUMAN SETTLEMENT
 FLAT-38, 7TH Floor, 105 Park Street, Kolkata-700016
 Tel:-91-33-2261263/71, E-mail : sngupta.shelter@gmail.com
 164/B Becharani Chatterjee Street, Kolkata-700061 566 Annu Saha, Teynapet, Chennai- 600018

DEALT BY: SUSMITA
SCALE : 1:200,1:600,1:4000
DATE : 31.08.2018
DRG. NO. : DNP/ARCH/SUB/SITE/01

OFFICE USE ONLY
APPROVED
 Plan No. 156/RW/25/21/2014/19.11.2018
 V.O. : Upto 19.11.2023
 Malay Kumar Pal
 Assistant Engineer Incharge P.W.D
 RAJPUR-SONARPUR MUNICIPALITY
 Dr. Pallab Das
 Chairman
 RAJPUR-SONARPUR MUNICIPALITY

SITE PLAN WITH SITE SERVICES
SCALE: 1:800

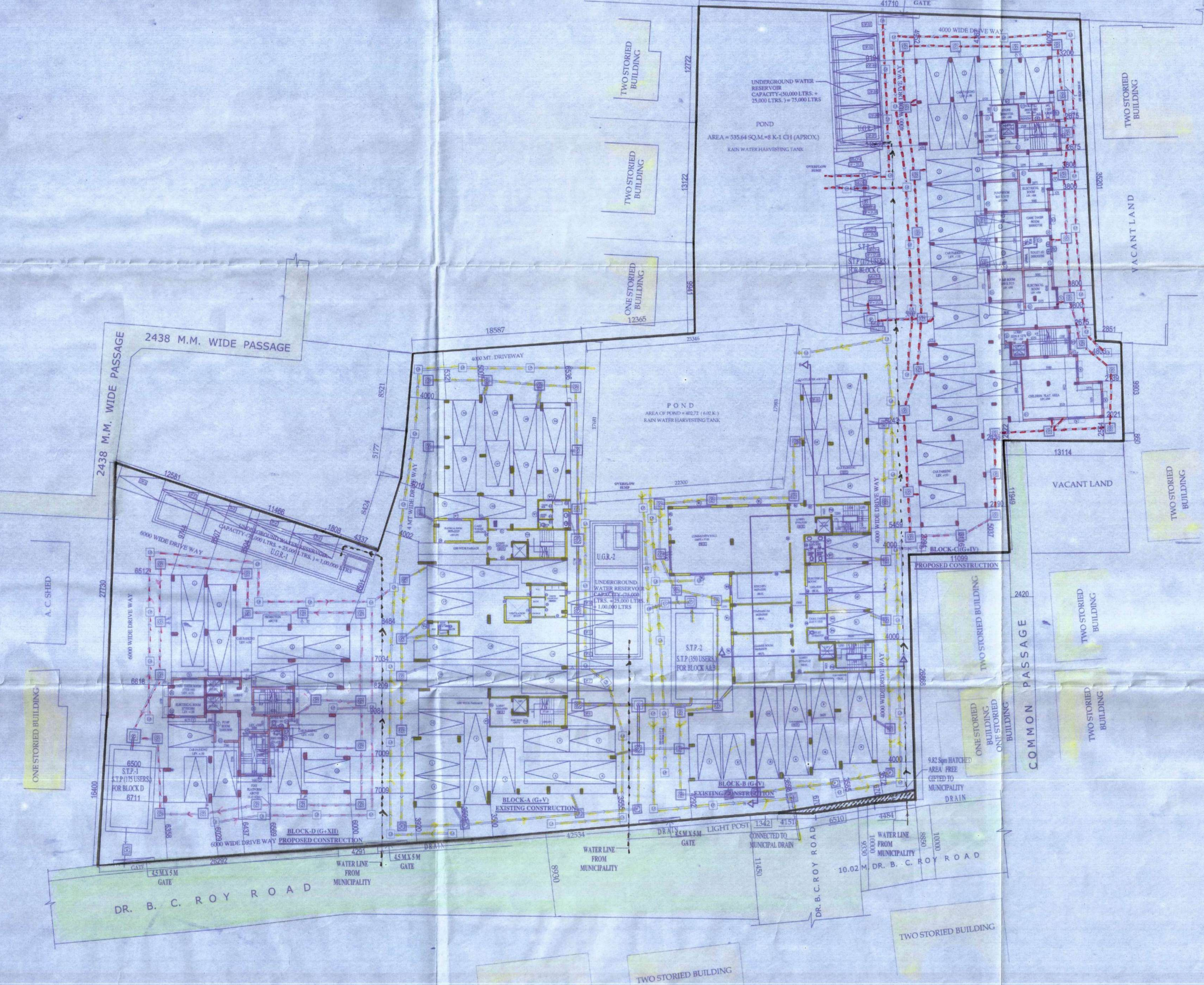

SITE PLAN WITH SITE SERVICES
SCALE: 1:800

