

ADDL./ALTRN. SEVEN (G+V) STORED RESIDENTIAL CUM COMMERCIAL BUILDING PLAN OF SRI DEBRAJ DE. AT MOUZA-BAGJOLA, J.L. NO. 21 IN C.S. DAG NO. - 638,639, C.S. KHATHAN NO. - 184, R.S. DAG NO. - 3173, R.S. KHATHAN NO. - 104, NEW KHATHAN NO. - 1243, IN RESPECT OF MUNICIPAL HOLDING NO. - 242, DUM DUM COSSIPORE ROAD, WARD NO. 10, P.S.-DUM DUM, DISTRICT - 24 PARGANAS (N) UNDER SOUTH DUM DUM MUNICIPALITY.

APPROVED SITE PLAN NO. - 276, DATED: - 12/09/2016
 APPROVED BUILDING PLAN NO. - 234, DATED: - 06/08/2018

AREA STATEMENT

TOTAL AREA OF LAND - 11 KH. 07 CH. 15 SFT. - i.e. 766.44 Sqm. (AS PER DEED)
TOTAL AREA OF LAND - 11 KH. 07 CH. 15 SFT. - i.e. 766.44 Sqm. (AS PER MEASURED)
PERMISSIBLE COVERED AREA - (50.00%) - 383.22 Sqm.
EXISTING GROUND FLOOR COVERED AREA - 560.37 Sqm.
EXISTING FIRST FLOOR COVERED AREA - 563.74 Sqm.
EXISTING SECOND FLOOR COVERED AREA - 564.63 Sqm.
EXISTING THIRD FLOOR COVERED AREA - 559.50 Sqm.
EXISTING FOURTH FLOOR COVERED AREA - 556.33 Sqm.
EXISTING FIFTH FLOOR COVERED AREA - 556.33 Sqm.
EXISTING SIXTH FLOOR COVERED AREA - 556.33 Sqm.
TOTAL EXISTING COVERED AREA - 3917.23 Sqm.
GROUND FLOOR CAR PARKING AREA - 91.97 Sqm.
SECOND FLOOR CAR PARKING AREA - 293.48 Sqm.
GROUND FLOOR COMMERCIAL AREA - 399.11 Sqm.
FIRST FLOOR COMMERCIAL AREA - 506.04 Sqm.
SECOND FLOOR COMMERCIAL AREA - 163.14 Sqm.
TOTAL COMMERCIAL AREA - 1068.29 Sqm.
LEFT OPEN AREA - 207.83 Sqm.
VOLUME OF CONSTRUCTION - 11699.92 Cubm.

CERTIFICATE OF OWNERS -

CERTIFIED THAT I SHALL NOT AT A LATER DATE MAKE ANY ADDITION OR ANY ALTERATION IN THE BUILDING OR MAKE ANY CHANGE IN THE THROUGH THE BUILDING RULES FOR THE SOUTH DUM DUM MUNICIPALITY AND ALSO UNDERTAKE TO ABIDE BY THOSE RULES DURING & AFTER CONSTRUCTION OF THE BUILDING.

I/WE AS LAND OWNER HEREBY CERTIFIED THAT I/WE INDEMNIFY SOUTH DUM DUM MUNICIPALITY REGARDING TITLE OF LAND IN SOUTH DUM DUM MUNICIPALITY WILL NOT BE HELD RESPONSIBLE, IF ANY DISPUTE ARISES IN FUTURE REGARDING THE TITLE OF THE LAND.

Signature
 SIGNATURE OF OWNER

CERTIFICATE OF ENGINEER/L.B.S. :-

CERTIFIED THAT THE FOUNDATION & SUPERSTRUCTURE OF THE BUILDING HAVE BEEN SO DESIGNED BY ME AS PER ALL THE CAPACITY & SETTLEMENT OF SOIL ETC. AS PER I.S. STANDARD & N.B CODE. CERTIFIED THAT THE PLAN HAS BEEN DESIGNED & DRAWN UP STRICTLY ACCORDING TO THE BUILDING RULES FOR SOUTH DUM DUM MUNICIPALITY. I AS STRUCTURAL ENGINEER HEREBY CERTIFIED THAT I INDEMNIFY SOUTH DUM DUM MUNICIPALITY FROM ANY STRUCTURAL DEFECT & FOR FAILURE OF THE PROPOSED PART OF THE BUILDING AFTER OR DURING THE CONSTRUCTION.

Signature
 ASIT KUMAR RAY CHAUDHURI
 Licensed Structural Engineer
 LIC No. - SD/03/03/19/19
 ASIT KUMAR RAY CHAUDHURI
 CHARTERED ENGINEER
 E.S.E. M.C. No. - 11/17
 SIGNATURE OF ENGINEER

Signature
 ASIT KUMAR RAY CHAUDHURI
 Licensed Structural Engineer
 LIC No. - SD/03/03/19/19
 ASIT KUMAR RAY CHAUDHURI
 CHARTERED ENGINEER
 E.S.E. M.C. No. - 11/17
 SIGNATURE OF L.B.S.

SCALE: - 1:100
 DATE: - 02.09.17
 SCHEDULE OF DOORS & WINDOWS

DOORS	WT = 1500X2100
D	D = 1500X2100
W1	W1 = 900X2100
W2	W2 = 900X2100
W3	W3 = 900X2100
W4	W4 = 1200X2100

DETAILS OF FLOOR PLANS, SECTION, ELEVATION, SEPTIC TANK, CHLORINATION CHAMBER & SITE PLAN

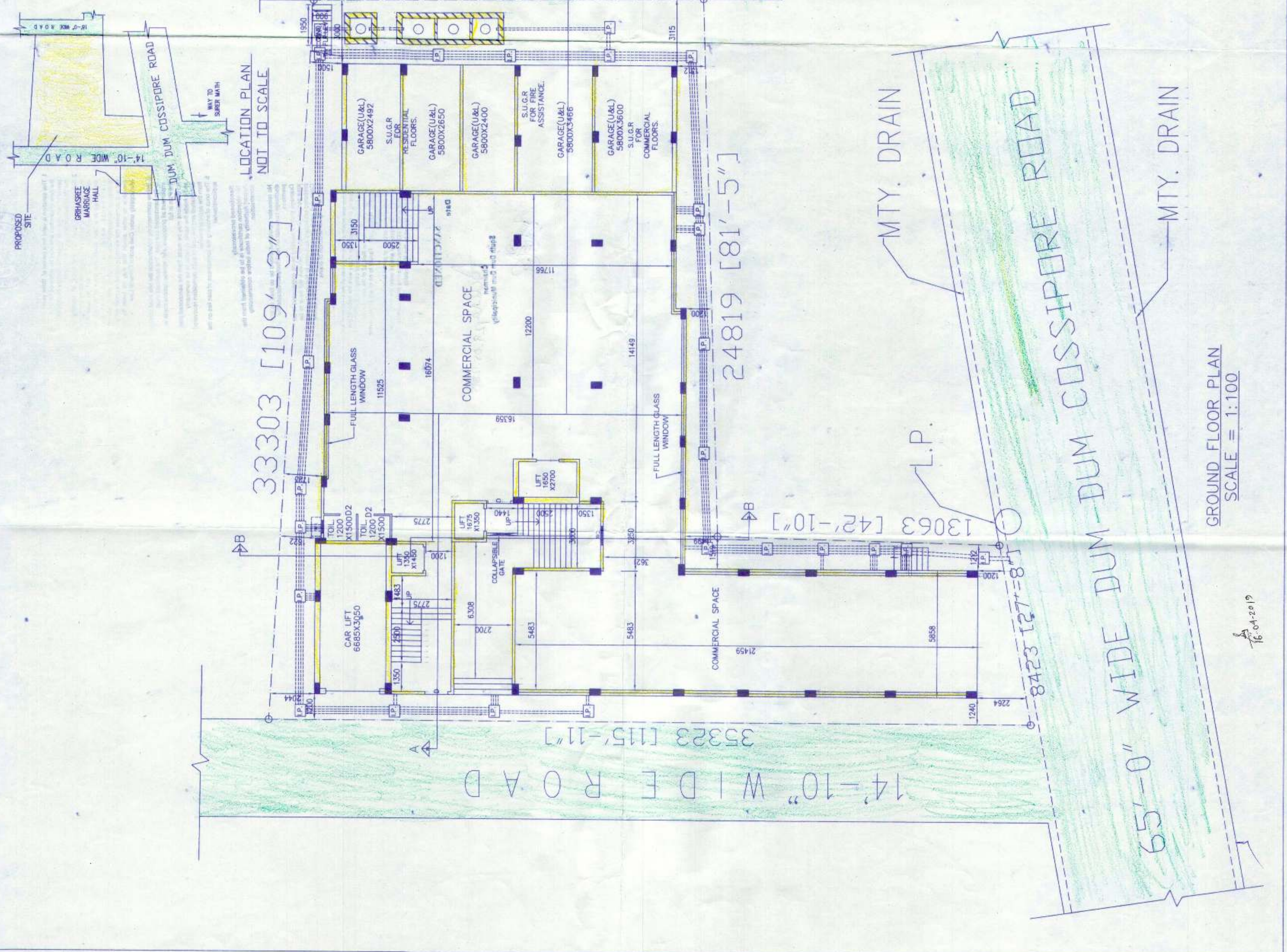
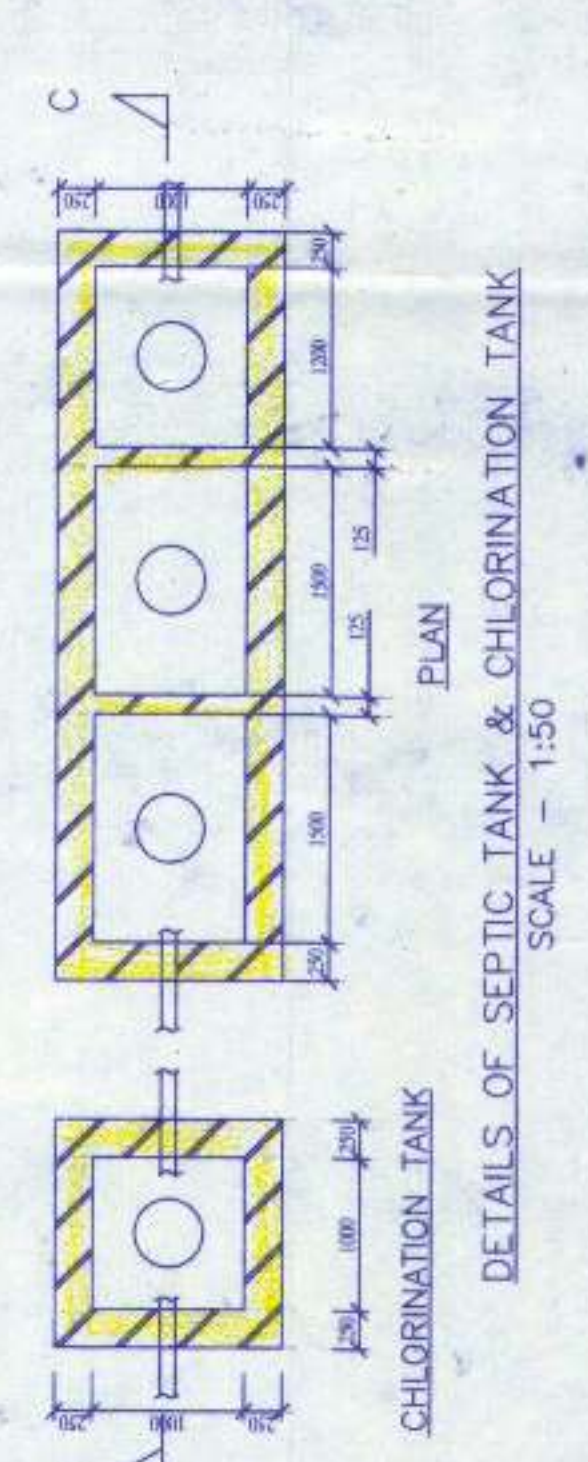
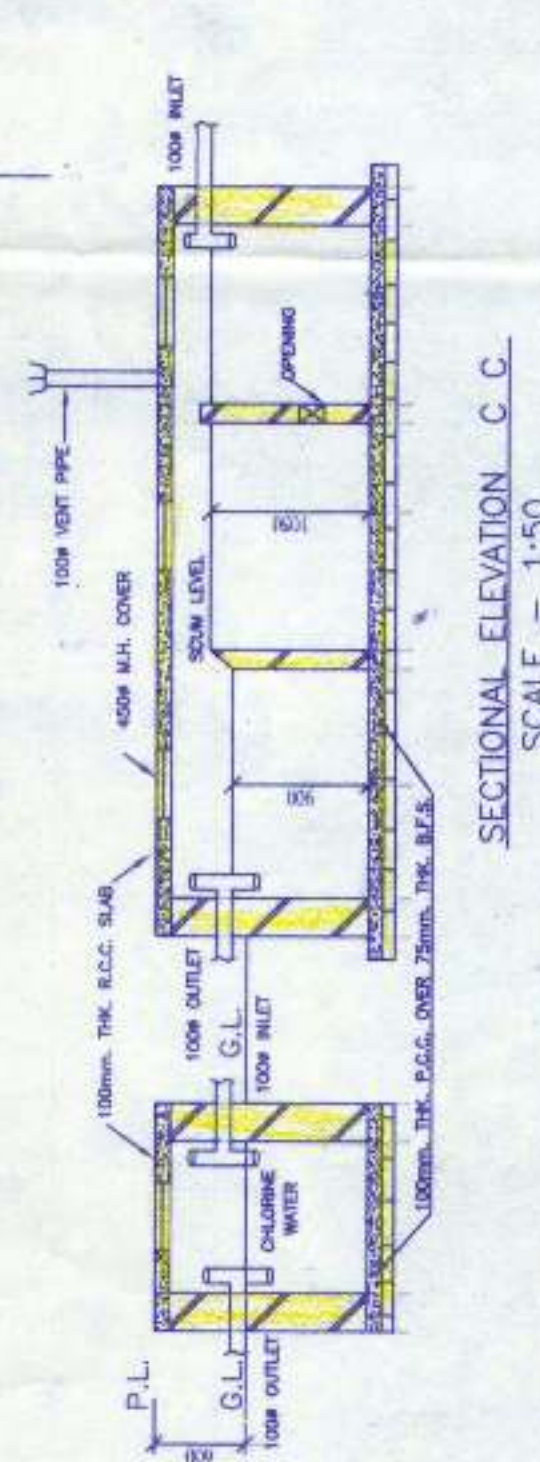
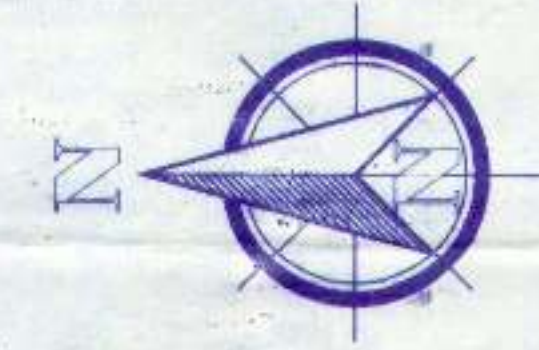
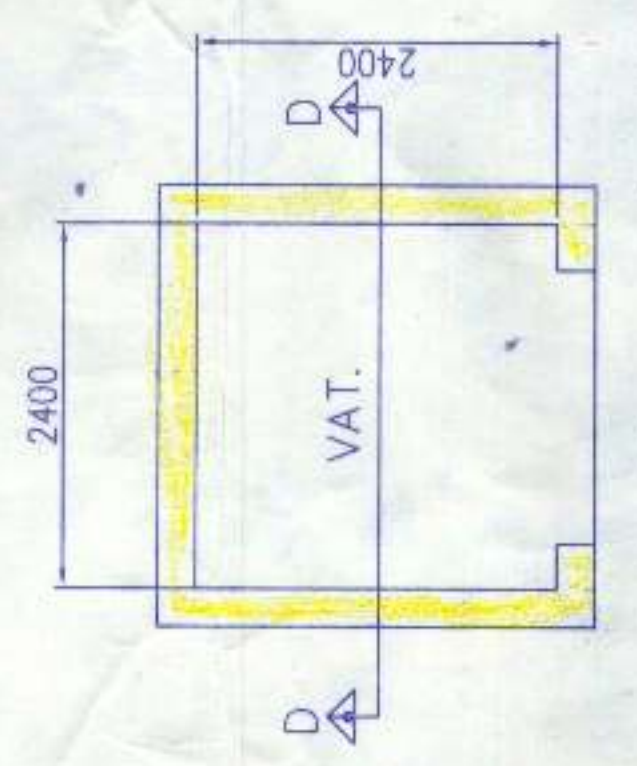
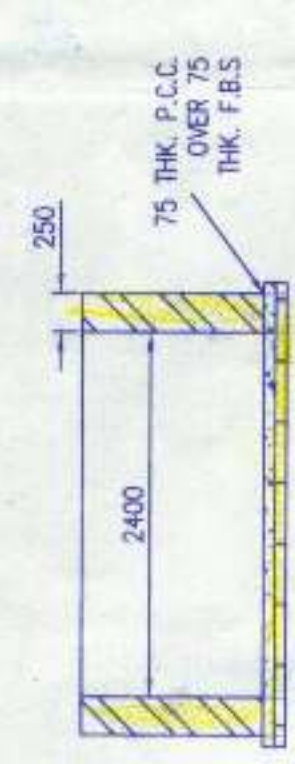
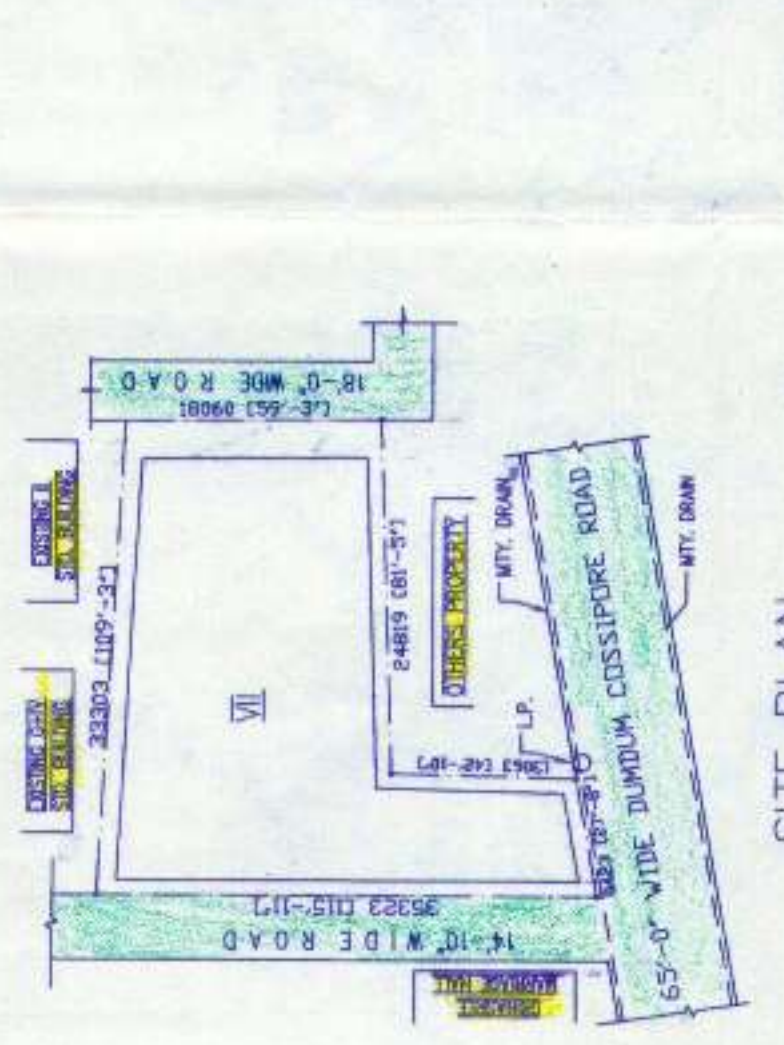

16.04.2019