

Rajendra Kumar Agarwal
(SIGNATURE OF THE DECLARANT)

[Being represented by the constituted Attorney on behalf of Sri Haranath Das, Sri Gobindo chandra Das, Sri Lalpat Das, Sri Shambhu Nath Das, Sri Rabindra Nath Das, Sri Kartick chandra Das, & Smt. Memika Mondal and for self and constituted Attorney of M/s Rajwada Group partners paiveen Agarwal, Dikash Agarwal & Raj Kumar Agarwal.]



AREA=5379.60 Sqm. (04 BI - 00 Ka - 06 Ch - 36 Sqft.)
 TOTAL AREA SHOWN IN RED BORDER.

SITE PLAN OF R.S. DAG NO - 43, 45, 47, 47/1126, 48, 48/1127, 49 & 50, R. S. KHATTIAN NO.- 281, 413, 262, 833 & 910, MOUZA-UKHILLA
 PAIKPARA, J.L. NO.- 56, P.S. SONARPUR, DIST-24PG(S), WARD NO.- 26, HOLDING NO.- 57, VIVEKANANDA SARANI, UNDER RAJPUR
 SONARPUR MUNICIPALITY

SCALE 1:0.6334

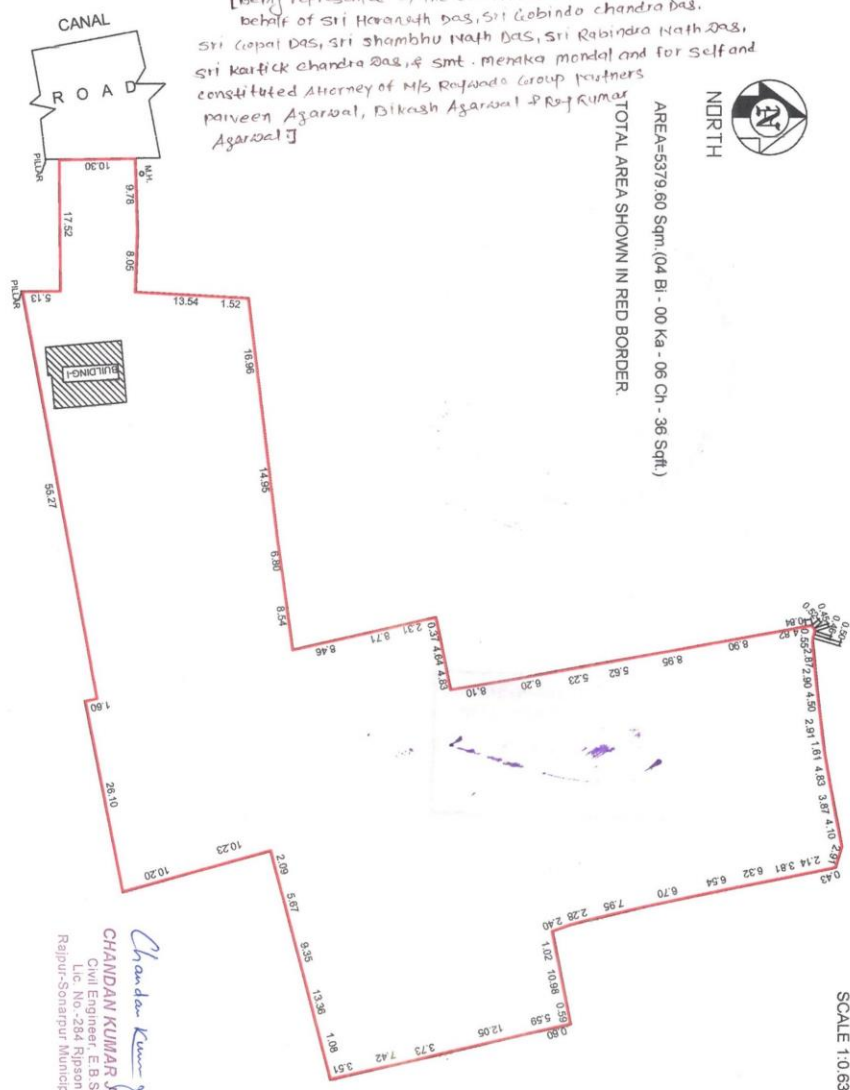

Chandan Kumar Jana
CHANDAN KUMAR JANA
 Civil Engineer, E.B.S.
 Lic. No.-284, Rajpur
 Rajpur-Sonarpur Municipality