

THE SANCTION IS VALID UP TO 12/31/2025

APPROVED

ASSET ENGINEER G1

APPROVED BY M.B.C. for R.R. 02/01/25

5960 MM WIDE K.M.C. ROAD

EXISTING TWO STORED BUILDING PRES. NO :- 535, B. L. SAHA ROAD

EXISTING ONE STORED BUILDING PRES. NO :- 535/A, B. L. SAHA ROAD

EXISTING TWO STORED BUILDING PRES. NO :- 533, B. L. SAHA ROAD

EXISTING ONE STORED BUILDING PRES. NO :- 532, B. L. SAHA ROAD

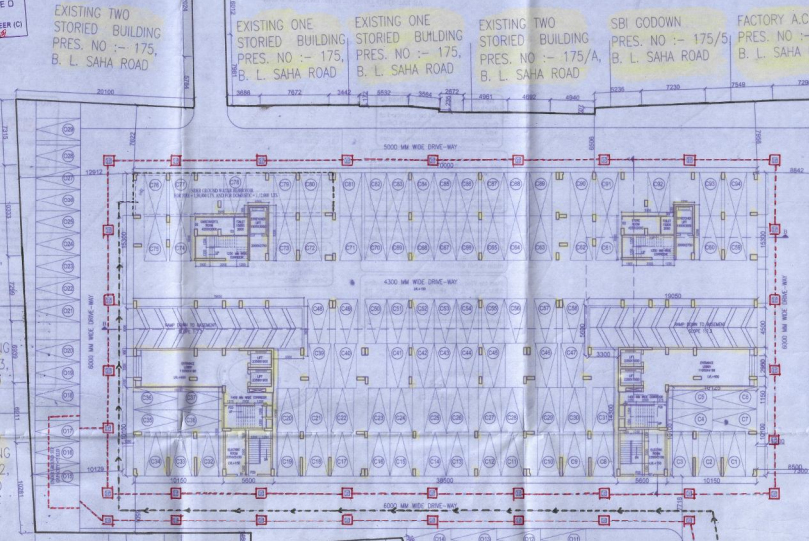

EXISTING TWO STORED BUILDING PRES. NO :- 177/6, B. L. SAHA ROAD

FACTORY A.C. SHED PRES. NO :- 177/B, B. L. SAHA ROAD

SOUTHERN-FABRICATORS A.C. SHED PRES. NO :- 177, B. L. SAHA ROAD

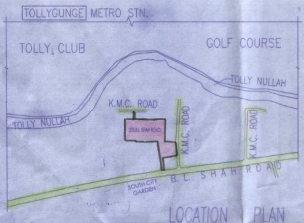

EXISTING ONE STORED BUILDING PRES. NO :- 174/22, B. L. SAHA ROAD

EXISTING FIVE STORED BUILDING PRES. NO :- 232, B. L. SAHA ROAD

EXISTING TWO STORED A. C. SHED PRES. NO :- 103/4, B. L. SAHA ROAD

GROUND FLOOR PLAN

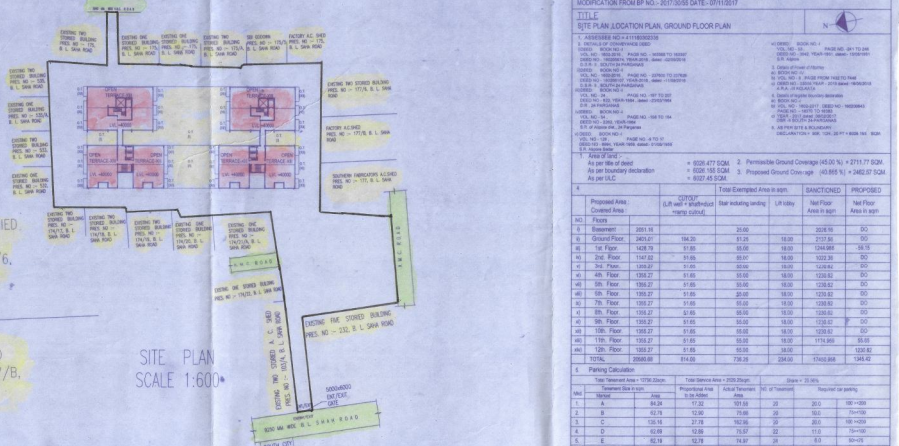
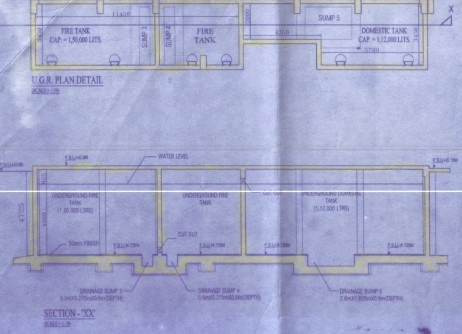
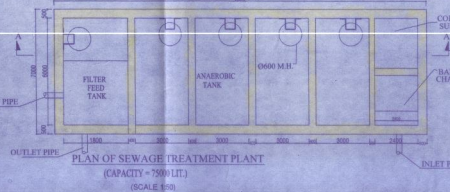
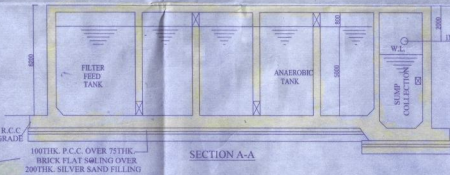

SCHEDULE OF DOORS			SCHEDULE OF WINDOWS			
TYPE	WIDTH	HEIGHT	TYPE	SIZE	INTEL	REMARKS
S/D	2000	2100	W1	1200x1350	2100	
D1	1100	2100	W2	1000x1350	2100	
D2	800	2100	W3	900x900	2100	
D3	750	2100	W4	600x900	2100	
FCD.1	1100	2100	W5	1500x1200	2100	
FCD.2	800	2100	W6	2000x1200	2100	
			W7	600x1500	2250	

PROPOSED ADDITION OF ONE FLOOR US 3M (CF RMC ACT 1960) OVER AND ABOVE THE SANCTIONED B.G.H.T. STORED RESIDENTIAL BUILDING AT PRES. NO :- 232, B. L. SAHA ROAD, K.M.C. ROAD, B.L. SAHA ROAD. AREA: 45000 SQ. FT. (4500 SQ. METERS) APPROXIMATELY. PROJECT NO. ES/25/18/24. APPROVED BY: M.B.C. ON: 02/01/25. SANCTIONED BY: M.B.C. ON: 02/01/25. APPROVED BY: M.B.C. ON: 02/01/25. APPROVED BY: M.B.C. ON: 02/01/25.

TITLE: SITE PLAN LOCATION PLAN GROUND FLOOR PLAN

1. ADDRESS: HQ-1111111111

2. PREPARED: 2025

3. DATE: 2025

Proposed Area	CFR 317 Coverage Area	Total Estimated Area in sqm	Sanctioned Area in sqm	Proposed Area in sqm
1. Shedding	2501.18	2500	2501.18	0
2. Shedding	2453.27	186.25	186.25	2167.02
3. Shedding	429.75	17.08	17.08	130.68
4. Shedding	149.22	33.85	33.85	110.37
5. Shedding	136.27	31.65	31.65	107.62
6. Shedding	136.27	31.65	31.65	107.62
7. Shedding	136.27	31.65	31.65	107.62
8. Shedding	136.27	31.65	31.65	107.62
9. Shedding	136.27	31.65	31.65	107.62
10. Shedding	136.27	31.65	31.65	107.62
11. Shedding	136.27	31.65	31.65	107.62
12. Shedding	136.27	31.65	31.65	107.62
13. Shedding	136.27	31.65	31.65	107.62
14. Shedding	136.27	31.65	31.65	107.62
15. Shedding	136.27	31.65	31.65	107.62
16. Shedding	136.27	31.65	31.65	107.62
17. Shedding	136.27	31.65	31.65	107.62
18. Shedding	136.27	31.65	31.65	107.62
19. Shedding	136.27	31.65	31.65	107.62
20. Shedding	136.27	31.65	31.65	107.62

- 1. Permissible FAR = 2.4000
- 2. Proposed FAR = 2.4000
- 3. Sanctioned Coverage Area for Area = 1310 SQ. METERS
- 4. Proposed Coverage Area = 1212.00 SQ. METERS
- 5. Net Proposed Area for FAR = 1876.38 SQ. METERS
- 6. Proposed FAR - Area Area - Capable provided Land Area = 1876.38 SQ. METERS
- 7. Proposed FAR - Area Area - Capable provided Land Area = 1876.38 SQ. METERS
- 8. Proposed FAR - Area Area - Capable provided Land Area = 1876.38 SQ. METERS
- 9. Proposed FAR - Area Area - Capable provided Land Area = 1876.38 SQ. METERS
- 10. Proposed FAR - Area Area - Capable provided Land Area = 1876.38 SQ. METERS
- 11. Proposed FAR - Area Area - Capable provided Land Area = 1876.38 SQ. METERS
- 12. Proposed FAR - Area Area - Capable provided Land Area = 1876.38 SQ. METERS
- 13. Proposed FAR - Area Area - Capable provided Land Area = 1876.38 SQ. METERS
- 14. Proposed FAR - Area Area - Capable provided Land Area = 1876.38 SQ. METERS
- 15. Proposed FAR - Area Area - Capable provided Land Area = 1876.38 SQ. METERS
- 16. Proposed FAR - Area Area - Capable provided Land Area = 1876.38 SQ. METERS
- 17. Proposed FAR - Area Area - Capable provided Land Area = 1876.38 SQ. METERS
- 18. Proposed FAR - Area Area - Capable provided Land Area = 1876.38 SQ. METERS
- 19. Proposed FAR - Area Area - Capable provided Land Area = 1876.38 SQ. METERS
- 20. Proposed FAR - Area Area - Capable provided Land Area = 1876.38 SQ. METERS

CERTIFICATE OF GEO-TECHNICAL ENGINEER

UNDERRUN HAS INSPECTED THE SITE AND CARRIED OUT SOIL BATHYMETRY. IT IS CERTIFIED THAT THE EXISTING SOIL OF THIS SITE IS CAPABLE OF SUPPORTING THE PROPOSED CONSTRUCTION AND A PROTECTION SYSTEM PROPOSED HEREIN IS SAFE & STABLE IN ALL RESPECTS. TECHNICAL POINT OF VIEW.

DECLARATION OF STRUCTURAL ENGINEER

THE STRUCTURAL DESIGN OF BOTH PROPOSED AND SUPERSTRUCTURE OF THE BUILDING HAVE BEEN MADE BY THE CONSULTANT. ALL POSSIBLE LOADS INCLUDING THE BASIC LOAD AS PER B.G.H.T. AND BASED ON SOIL INVESTIGATION REPORT BY GEOTECHNICAL CONSULTANTS & ENGINEERS, ARE CONSIDERED IN THE DESIGN. WE CERTIFY THAT IT IS SAFE AND STABLE IN ALL RESPECTS.

SNEHASHISHA SINHA
 B.E., C.E., M.E. (STRUCTURAL)
 Chartered Engineer (I.E.T.E.)
 Registration No.: 477
 (S.E. & M.E.)

DECLARATION OF ARCHITECT

I HEREBY DECLARE THAT I HAVE FULL RESPONSIBILITY FOR THE DESIGN AND SUPERSTRUCTURE OF THE BUILDING AS PER PROVISION OF K.M.C. BUILDING RULES 2008, AS SANCTIONED FROM THE ENGINEER AND THE SITE CONDITIONS INCLUDING THE EXISTING ROAD INCLUDING THE PLAN. IT IS DECLARED BY NOT TO BE A BANK OF FILTERED TANK, THERE IS AN EXISTING TO BE ENCLOSED BEFORE THE COMMENCEMENT OF WORK. IT IS FULLY OCCUPIED BY THE OWNER. THERE IS NO TANK.

SNEHASHISHA SINHA
 B.E., C.E., M.E. (ARCHITECTURE)
 Chartered Engineer (I.E.T.E.)
 Registration No.: 477
 (S.E. & M.E.)

DECLARATION OF OWNER

I HEREBY DECLARE THAT I SHALL ENGAGE I.E.T.E. & E.E. DURING CONSTRUCTION. I SHALL FOLLOW THE INSTRUCTION OF I.E.T.E. & E.E. DURING CONSTRUCTION OF THE BUILDING AS PER PLAN. I.E.T.E. & E.E. WILL NOT BE RESPONSIBLE FOR STRUCTURAL STABILITY OF THE BUILDING AND ANNEALED STRUCTURE. I HAVE SUBMITTED DOCUMENTARY EVIDENCE THAT THE I.E.T.E. & E.E. AUTHORITY WILL ISSUE THE SANCTION ON THE CONSTRUCTION OF I.E.T.E. & E.E. PLAN. I HAVE UNDER THE SANCTION ON THE BUILDING FOUNDATION.

ESPACE

3/5/25

ESPACE

3/5/25

ESPACE

3/5/25