

SHEET NO. 1
 DRAWING TITLE
 GROUND FLOOR PLAN
 LOCATION PLAN

PROPOSED G+VII STORED RESIDENTIAL BUILDING OF A PIECE OF A LAND OF SRI PROSANTA CH. DAS & OTHERS, AT MOUZA-SHYAMNAGAR NOW KRISHNAPUR, IN C.S. DAG NO- 960, C.S. KHATAN NO- 28 IN RESPECT OF MUNICIPAL HOLDING NO.- 72, GOURI NATH SHASTRI SARANI, J.L. NO.-32/20, WARD NO.- 27, UNDER SOUTH DUM DUM MUNICIPALITY, P. S.-DUM DUM, DISRICT- 24 PARGANAS (N),

AREA STATEMENT

AREA OF LAND (AS PER DEED)	44 KH. 14 CH. 09 SFT. 0136.29 Sgm.
AREA OF LAND (AS PER MEASUREMENT)	45 KH. 16 CH. 03 SFT. 2673.04 Sgm.
AREA OF LAND (EXCLUDING POND AREA)	35 KH. 01 CH. 9 SFT. 2346.19 Sgm.
AREA OF POND (AS PER MEASUREMENT)	10 KH. 10 CH. 39 SFT. 726.85 Sgm.
AREA OF LAND (ALREADY DEVELOPED)	NIL
AREA OF LAND (REMAINING AFTER DEVELOPMENT)	1173.01 Sgm.
PERMISSIBLE COVERED AREA (50%)	2.25
PROPOSED F. A. R.	6166.752 - 536.334/3073.04 Sgm.
PROPOSED GROUND COVERAGE	= 1.831
COVERED AREA OF GROUND FLOOR	518.041 Sgm. (39.129%)
BLOCK: 1	325.169 Sgm.
BLOCK: 2	365.418 Sgm.
COVERED AREA OF 1st FLOOR	342.415 Sgm.
BLOCK: 1	309.448 Sgm.
BLOCK: 2	335.393 Sgm.
COVERED AREA OF 2nd TO 7th FLOOR	461.298 Sgm.
BLOCK: 1	283.137 Sgm.
BLOCK: 2	6105.752 Sgm.
COVERED AREA OF CLUB & COMMUNITY HALL	1151.01 Sgm.
REQUIRED OPEN AREA OF LAND	1484.234 Sgm.
PROPOSED OPEN AREA OF LAND	1336.534 Sgm.
COVERED AREA OF CAR PARKING	342.415 Sgm.
COVERED AREA OF COMMERCIAL SPACE	51 Nos.
REQUIRED CAR PARKING	59 Nos.
PROPOSED CAR PARKING	29 Nos.
COVERED PARKING	30 Nos.
OPENED PARKING	19103.597 Cum.

- NOTE:**
1. ALL SORTS OF PRECAUTIONARY MEASURE WILL BE TAKEN AT THE TIME OF CONSTRUCTION.
 2. ALL MAIN WALL 200 TH. ALL PARTITION WALL 125 TH. & 75 TH.
 3. BRICK WORK 250N. MORTAR 1:3 & BRICK WORK 125N. & 75N MORTAR 1:4.
 4. GRADE OF STEEL Fe-500, I.S. CODE 1786-1979.
 5. GRADE OF CONCRETE M-20.
 6. ALL OTHER MATERIALS USED AS PER I.S. CODE.
 7. 25TH. D.P.C. WILL BE 1:2:4 WITH PROPER WATER PROOFING COMPOUND.

CERTIFICATION OF OWNER
 I/WE ALSO UNDERTAKE TO REPORT THAT THERE IS NO COURT CASE OR ANY COMPLAINT FROM ANY CORNER OF ANY/OUR PROPERTY AS PER PLAN/WE HERE BY DECLARE THAT I/WE WILL REPAIR / RECONSTRUCT IF ANY DAMAGE CAUSED TO THE EXISTING DRAIN WHILE CONSTRUCTION, FURTHER THERE IS NO TENANT IN THE ABOVE SAID PREMISES. S. D. D. M. WILL NOT BE LIABLE FOR ANY TYPE OF DISPUTE IF ARISES IN FUTURE.

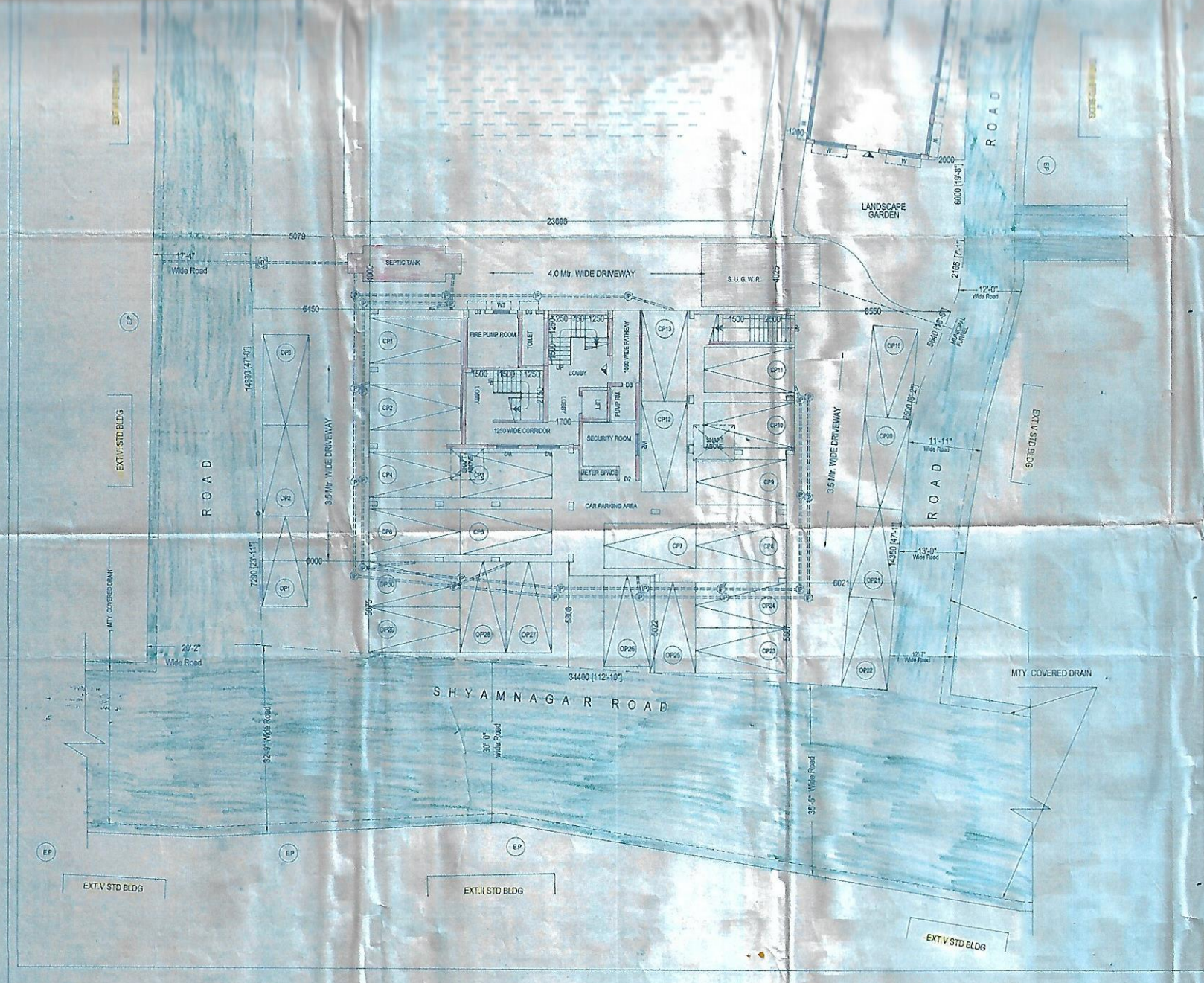

RAJESH K. SINGH
 Partner
 KALPESH K. SINGH
 Partner
 Signature of Owner

CERTIFICATION OF BUILDING PLAN

I/WE DO HEREBY CERTIFY THAT PLANS, ELEVATIONS AND SECTIONS AND OTHER STRUCTURE DETAILS OF THE PROPOSED BUILDING ON HOLDING NO- 72, GOURI NATH SHASTRI SARANI, WARD NO- 27 UNDER THE JURISDICTION OF SOUTH DUMDUM MUNICIPALITY HAVE BEEN PREPARED IN CONFORMITY WITH ALL RELEVANT PROVISION UNDER THE WEST BENGAL MUNICIPALITY (BUILDING RULES 2007). THIS ALSO TO CERTIFY THAT ALL RELEVANT NO OBJECTION CERTIFICATES FROM THE RESPECTIVE AUTHORITIES SUCH AS FIRE AND EMERGENCY SERVICES DEPARTMENT, AS APPLICABLE IN THIS REGARD, ARE ALSO ENCLOSED WITH THE APPLICATION FOR SEEKING APPROVAL OF THE PLAN TO CONSTRUCT/ADDITION TOTAL/ALTERATION OF THE BUILDING ON THE SAID PLOT.

Tamal Chaudhuri
TAMAL CHAUDHURI
 B.Arch
 Regd no:- CA/2002/29203

Asit Kr. Roy Chaudhuri
ASIT KR. ROY CHAUDHURI
 Licensed Building Surveyor
 S.31.0 M, Class-1
 Lic. No. BDDM/4/201-1

SIG. OF LICENSED BUILDING SURVEYOR/ARCHITECT

CERTIFICATION OF BUILDING OF STRUCTURAL STABILITY

I/WE HEREBY CERTIFY THAT THE FOUNDATION AND SUPERSTRUCTURE OF THE BUILDING PROPOSED FOR CONSTRUCTION, ON HOLDING NO- 72, GOURI NATH SHASTRI SARANI, WARD NO- 27 UNDER THE JURISDICTION OF SOUTH DUMDUM MUNICIPALITY HAVE BEEN PERSONALLY INSPECTED AND SO DESIGNED BY ME/US WILL MAKE SUCH FOUNDATION AND SUPERSTRUCTURE SAFE IN ALL RESPECT INCLUDING THE CONSIDERATION OF BEARING CAPACITY AND SETTLEMENT OF SOIL AND OTHER CONDITIONS, IF ANY, CONFORMING TO ALL STIPULATIONS OF ALL RELEVANT IS CODE OF PRACTICE AND NATIONAL BUILDING CODE.

Subrata Mondal
Subrata Mondal
 M.E. (Structural)
 P-23, Parkside Park, Kolkata-34
 Engineer of K.M.C.O., No. G.T./17

SUBRATA MONDAL
 Chartered Engineer (CIVIL)
 D.C.E., A.M.T.E., C. ENG. (I)
 Lic. No. 120 BY, S.E. 2-1/164
 BTER/NEDA/10/00082

SIG. OF STRUCTURAL ENGINEER

Asit Kr. Roy Chaudhuri
ASIT KR. ROY CHAUDHURI
 Licensed Building Surveyor
 S.31.0 M, Class-1
 Lic. No. BDDM/4/201-1

SIG. OF GEOTECHNICAL ENGINEER

ARCHITECT / CONSULTANT	TITLE	GROUND FLOOR PLAN	LOCATION PLAN
 SDCS ARCHITECTS & ENGINEERS 228, Gopalchand Road, Flat 20 (2nd Fl) Kolkata 700014 Ring: +91 983 464 3728, +91 983 015 3728 +91 33 2268 9702 Email: sdcsonline@rediffmail.com Website: www.sdcsonline.com	PROJECT	72 GOURI NATH SHASTRI SARANI	
	DRAWN BY	SIBWARI	
	CHECKED BY	S. MONDAL	
	SCALE	1:100	
SHEET	01		
DATE	14/01/18		

Debasis Dey
 Assistant Engineer
 South Dum Dum Municipality