

SCHEDULE OF SLAB (S3)
 SLAB THICKNESS AS MENTIONED :- 135 MM (M20 AND FE 500)
 (ALONG SHORTER DIRECTION)

SUPPORT 8mm@150mm c/c at top of support & extended upto L/3 from beam.
 SPAN 8mm@150mm c/c at span & alternately curtailed at L/4 from beam.

SCHEDULE OF SLAB (S1)
 SLAB THICKNESS AS MENTIONED :- 135 MM (M20 AND FE 500)
 (ALONG LONGER DIRECTION)

SUPPORT 8mm@150mm c/c at top of support & extended upto L/3 from beam.
 SPAN 8mm@150mm c/c at span & alternately curtailed at L/4 from beam.

SCHEDULE OF SLAB (S1)
 SLAB THICKNESS AS MENTIONED :- 115 MM (M20 AND FE 500)
 (ALONG SHORTER DIRECTION)

SUPPORT 8mm@150mm c/c at top of support & extended upto L/3 from beam.
 SPAN 8mm@150mm c/c at span & alternately curtailed at L/4 from beam.

SCHEDULE OF SLAB (S1)
 SLAB THICKNESS AS MENTIONED :- 115 MM (M20 AND FE 500)
 (ALONG LONGER DIRECTION)

SUPPORT 8mm@150mm c/c at top of support & extended upto L/3 from beam.
 SPAN 8mm@175mm c/c at span & alternately curtailed at L/4 from beam.

SCHEDULE OF 1ST FLOOR TO ROOF (M20 AND FE 500)

BEAM MKD	SIZE (MMxMM)	TOP		BOT.		STIRRUPS (2 LEGGED)	
		AL TH	EXT (AT SUPT.)	AL TH	EXT (MID SPAN)	AT SUPPORT	AT SPAN
B1	250x450	2-10#	2-10#	2-10#	2-10#	8@2.0@50C/C	8@2.0@75C/C
B2	250x450	2-10#	2-10#	2-10#	2-10#	8@2.0@50C/C	8@2.0@75C/C
B3	250x450	2-10#	2-10#	2-10#	2-20#	8@2.0@50C/C	8@2.0@75C/C
B4	250x450	2-10#	2-10#	2-10#	-	8@2.0@50C/C	8@2.0@75C/C
B5	250x450	3-12#	-	2-10#+1-12#	-	8@2.0@50C/C	8@2.0@75C/C
B6	250x450	2-10#	2-10#	2-20#	2-20#	8@2.0@50C/C	8@2.0@75C/C
B7	250x450	2-10#	2-20#	2-20#	2-10#	8@2.0@50C/C	8@2.0@75C/C
B8	250x450	3-10#	2-10#	4-20#	-	8@2.0@50C/C	8@2.0@75C/C
H.L.B	250x450	3-10#	3-10#	-	-	8@2.0@50C/C	-

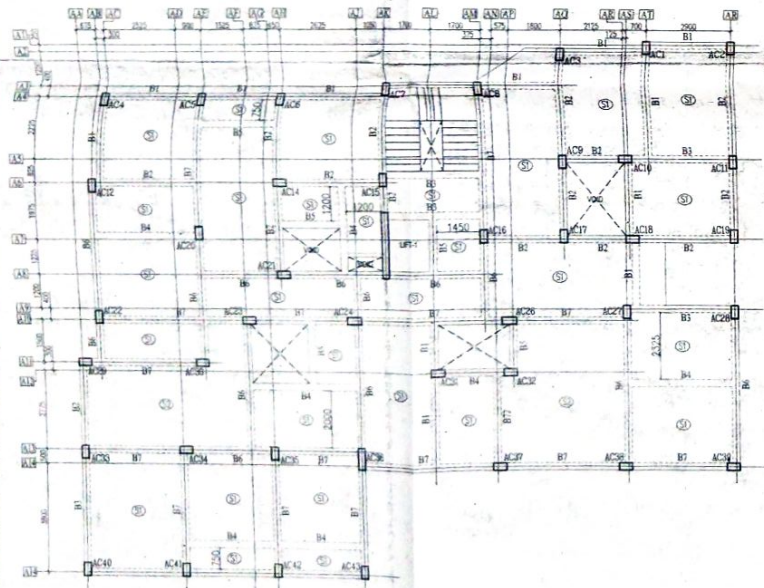
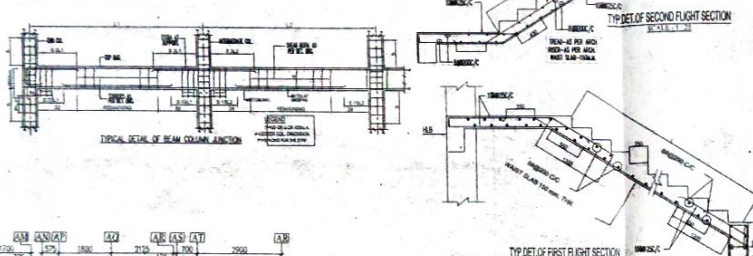

TYPICAL FLOOR BEAM LAYOUT PLAN (BLOCK-A)
 SCALE: 1/100

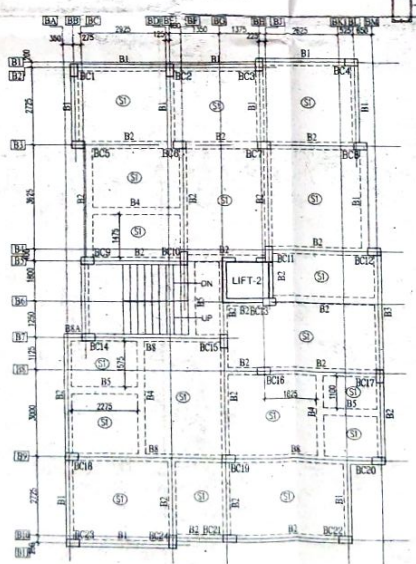

TYPICAL FLOOR BEAM LAYOUT PLAN (BLOCK-B)
 SCALE: 1/100

- NOTES**
1. ALL DIMENSIONS ARE IN MM
 2. CONCRETE GRADE TO BE ADOPTED AS MENTIONED, GR. OF STEEL FE 500
 3. COVER TO REINFORCEMENT
 COLUMN = 40mm, BEAM = 30mm
 SLAB = 15mm, FOUNDATION = 50mm
 4. DEPTH OF EXCAVATION OF UNDER GROUND SUMP SHOULD BE ABOVE THAT OF FOUNDATION.
 5. DO NOT SCALE THE DRAWING, FOLLOW WITH DIMENSION.
 6. ALL EXTERNAL WALLS ARE 250mm THK. & INTERNAL WALLS ARE 125 mm THK.
 7. LEAN CONCRETE (1:1.5:6) NOMINAL MIX 75 THK. SHALL BE PROVIDED UNDER FOUNDATION.
 8. EXTERNAL PLASTER 19mm THK. IN CEMENT MORTAR GRADE (1:6)
 9. INTERNAL PLASTER 12mm THK. IN CEMENT MORTAR GRADE (1:5)
 10. ALL CEILING PLASTER 6mm THK. IN CEMENT MORTAR GRADE (1:4)
 11. 5mm I.P.S. FLOOR FINISH OVER 100mm THK. P.C.C. WORK OVER 75mm THK. BRICK FLAT SOLING.

STRUCTURAL CERTIFICATE
 THE STRUCTURAL DESIGN AND DRAWING OF BOTH FOUNDATION AND SUPER STRUCTURE OF THE BUILDING HAS BEEN MADE BY ME CONSIDERING ALL POSSIBLE LOADS INCLUDING THE SEISMIC LOAD AS PER NATIONAL BUILDING CODE OF INDIA AND CERTIFIED THAT IT IS SAFE AND STABLE IN ALL RESPECT

SUBIR CHANDRA SANYAL
 B.C.E., A.M.I., STRUCT. E. (I)
 E. S. NO. 840, CLASS-I
 E. S. NO. 007, CLASS-I
 RAJPUR-SONARPUR MUNICIPALITY

SIGNATURE OF STRUCTURAL ENGINEER (E.S.E. NO. 007)

DECLARATION OF E.B.A.
 I HAVE CERTIFIED ON THE PLAN ITSELF WITH FULL RESPONSIBILITY THAT BUILDING RULES 1960 AS AMENDED FROM TIME TO TIME AND THAT THE SITE CONDITIONS INCLUDING THE ADJUTING ROAD CONFORM WITH THE PLAN AND THAT IT IS A BUILDABLE SITE AND NOT A TANK OR A FILLED UP LAND.

SUBIR CHANDRA SANYAL
 B.C.E., A.M.I., STRUCT. E. (I)
 E. S. NO. 840, CLASS-I
 E. S. NO. 007, CLASS-I
 RAJPUR-SONARPUR MUNICIPALITY

SIGNATURE OF E.B.A.

Kallol Kr. Ghoshal
 Kallol Kr. Ghoshal B.E. (CIVIL), M.E.
 Geo. Technical Engineer
 Enginering No.: 028/RJPSON/G.T./2019-2020

SIGNATURE OF GEOTECHNICAL ENGINEER

- ✓ Papi Ghose.
- ✓ Kalita Nath
- ✓ Ratan Kumar Ghosh
- ✓ Kishore Kumar Ghosh

SIGNATURE OF OWNER

PROJECT
 STRUCTURAL DRAWING FOR A PROPOSED G + III STORED RESIDENTIAL BUILDING AT HOLDING NO 1238, TETULBERIA, WARD NO.06, J.L. NO. 44, DAD. NO. 269, HATIAN NO. 390, 392, 421 AT MOUZA-TETULBERIA, P.S.-SONARPUR, DIST.-24PG (S), UNDER RAJPUR SONARPUR MUNICIPALITY

NAMES OF OWNER: RATAN KUMAR GHOSH & OTHERS

DESIGNED	DATE
CHECKED	JOB NO.
APPROVED	

anyalson Associates
 consultant Pvt. Ltd.
 INSULTANT PLANNER & STRUCTURAL ENGINEERS
 1-157 KANUNGO PARK, KOLKATA-94



APPROVAL OF S.A.E

OFFICE USE ONLY

Structural plan as submitted by the structural Engineer have been kept with Building Plan No. 310/03/05/82 Dated On: 19/07/2020 for record of the Rajpur-Sonarpur Municipality without verification No. for record of the Rajpur-Sonarpur Municipality should be made at the time of sanction without submitting fresh structural plan along with design calculation and stability certificate in the prescribed form necessary steps should be taken for the safety of the adjoining premises public private properties and safety of human life during construction

SUBIR CHANDRA SANYAL
 Sig. of Assistant Engineer.
 Incharge P.W.D.
 RAJPUR-SONARPUR MUNICIPALITY

Stocking of building materials on
the public roads is illegal, and
the Municipality hereby requests these
materials as per table.
The request is for the purpose of
the work of the Municipality and
the request is for the purpose of
the work of the Municipality.

The number of occupancy units of any
flat or building before the
completion of construction shall be
as follows:
The number of occupancy units shall
be as follows:

Information in the present form is to be
submitted to the concerned authority
for the purpose of the work of the
Municipality and the request is for
the purpose of the work of the
Municipality and the request is for
the purpose of the work of the
Municipality.