

**SCHEDULE OF FLOOR & HALF LANDING BEAMS**

Beam No.	Beam Size	Top Reinforcement	Bottom Reinforcement	Stirrups	Notes
101	200 x 200	2-12 @ 150	2-12 @ 150	2-8 @ 150	1
102	200 x 200	2-12 @ 150	2-12 @ 150	2-8 @ 150	1
103	200 x 200	2-12 @ 150	2-12 @ 150	2-8 @ 150	1
104	200 x 200	2-12 @ 150	2-12 @ 150	2-8 @ 150	1
105	200 x 200	2-12 @ 150	2-12 @ 150	2-8 @ 150	1
106	200 x 200	2-12 @ 150	2-12 @ 150	2-8 @ 150	1
107	200 x 200	2-12 @ 150	2-12 @ 150	2-8 @ 150	1
108	200 x 200	2-12 @ 150	2-12 @ 150	2-8 @ 150	1
109	200 x 200	2-12 @ 150	2-12 @ 150	2-8 @ 150	1
110	200 x 200	2-12 @ 150	2-12 @ 150	2-8 @ 150	1

**SCHEDULE OF ROOF & ABOVE ROOF BEAMS**

Beam No.	Beam Size	Top Reinforcement	Bottom Reinforcement	Stirrups	Notes
111	200 x 200	2-12 @ 150	2-12 @ 150	2-8 @ 150	1
112	200 x 200	2-12 @ 150	2-12 @ 150	2-8 @ 150	1
113	200 x 200	2-12 @ 150	2-12 @ 150	2-8 @ 150	1
114	200 x 200	2-12 @ 150	2-12 @ 150	2-8 @ 150	1
115	200 x 200	2-12 @ 150	2-12 @ 150	2-8 @ 150	1
116	200 x 200	2-12 @ 150	2-12 @ 150	2-8 @ 150	1
117	200 x 200	2-12 @ 150	2-12 @ 150	2-8 @ 150	1
118	200 x 200	2-12 @ 150	2-12 @ 150	2-8 @ 150	1
119	200 x 200	2-12 @ 150	2-12 @ 150	2-8 @ 150	1
120	200 x 200	2-12 @ 150	2-12 @ 150	2-8 @ 150	1

- NOTES**
1. ALL REINFORCEMENT SHALL BE CONSTRUCTION METHOD. REINFORCEMENT SHALL BE CHECKED BY THE ARCHITECT.
  2. ALL REINFORCEMENT SHALL BE CHECKED BY THE ARCHITECT.
  3. ALL REINFORCEMENT SHALL BE CHECKED BY THE ARCHITECT.
  4. ALL REINFORCEMENT SHALL BE CHECKED BY THE ARCHITECT.
  5. ALL REINFORCEMENT SHALL BE CHECKED BY THE ARCHITECT.
  6. ALL REINFORCEMENT SHALL BE CHECKED BY THE ARCHITECT.
  7. ALL REINFORCEMENT SHALL BE CHECKED BY THE ARCHITECT.
  8. ALL REINFORCEMENT SHALL BE CHECKED BY THE ARCHITECT.
  9. ALL REINFORCEMENT SHALL BE CHECKED BY THE ARCHITECT.
  10. ALL REINFORCEMENT SHALL BE CHECKED BY THE ARCHITECT.
  11. ALL REINFORCEMENT SHALL BE CHECKED BY THE ARCHITECT.
  12. ALL REINFORCEMENT SHALL BE CHECKED BY THE ARCHITECT.
  13. ALL REINFORCEMENT SHALL BE CHECKED BY THE ARCHITECT.
  14. ALL REINFORCEMENT SHALL BE CHECKED BY THE ARCHITECT.
  15. ALL REINFORCEMENT SHALL BE CHECKED BY THE ARCHITECT.
  16. ALL REINFORCEMENT SHALL BE CHECKED BY THE ARCHITECT.
  17. ALL REINFORCEMENT SHALL BE CHECKED BY THE ARCHITECT.

**PROPOSED G+4 STORED RESIDENTIAL BUILDING PLAN OF GADIA ASSOCIATES PVT LTD AT MOUDA - KHAYANI, RS & L.R. NO. 7482/401, 1280/2, 172/1, 2307, 3397, 3114/6, 2310/ST-24 (RESID.) UNDER JYANGGAS-VI/1982-2 (GADIA PARKWAY) PRESENT L.R.KH. NO. \_\_\_\_\_**

NAME OF OWNERS: GADIA ASSOCIATES PVT LTD  
 DATE: \_\_\_\_\_  
 SIGNATURE: \_\_\_\_\_

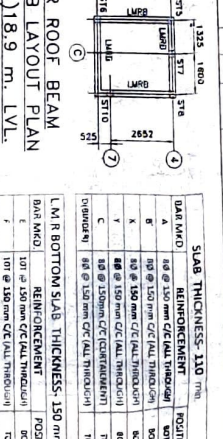
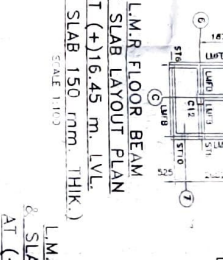
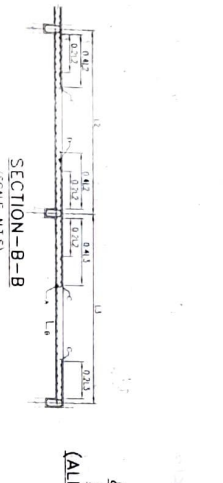

**REINFORCEMENT SCHEDULE**

Beam No.	Beam Size	Top Reinforcement	Bottom Reinforcement	Stirrups	Notes
121	200 x 200	2-12 @ 150	2-12 @ 150	2-8 @ 150	1
122	200 x 200	2-12 @ 150	2-12 @ 150	2-8 @ 150	1
123	200 x 200	2-12 @ 150	2-12 @ 150	2-8 @ 150	1
124	200 x 200	2-12 @ 150	2-12 @ 150	2-8 @ 150	1
125	200 x 200	2-12 @ 150	2-12 @ 150	2-8 @ 150	1
126	200 x 200	2-12 @ 150	2-12 @ 150	2-8 @ 150	1
127	200 x 200	2-12 @ 150	2-12 @ 150	2-8 @ 150	1
128	200 x 200	2-12 @ 150	2-12 @ 150	2-8 @ 150	1
129	200 x 200	2-12 @ 150	2-12 @ 150	2-8 @ 150	1
130	200 x 200	2-12 @ 150	2-12 @ 150	2-8 @ 150	1

**DECLARATION OF STRUCTURAL ENGINEER**

I, the undersigned, being a duly qualified and registered Structural Engineer, have examined the drawings and specifications of the proposed structure and certify that it is safe and stable in all respects.

Signature: \_\_\_\_\_  
 Name: \_\_\_\_\_  
 Date: \_\_\_\_\_

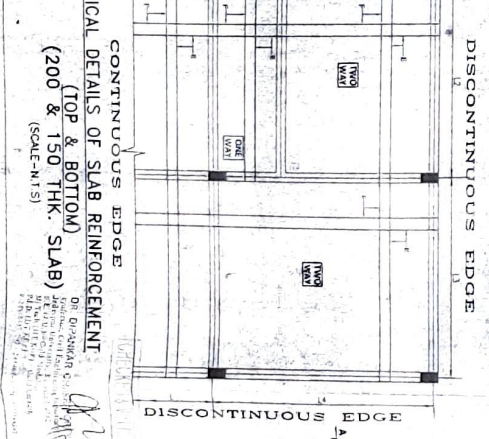
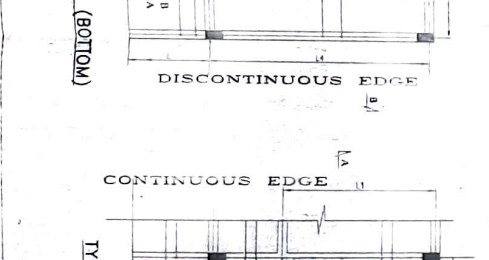
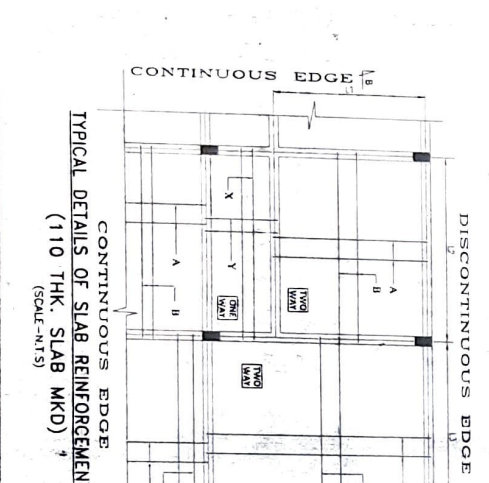
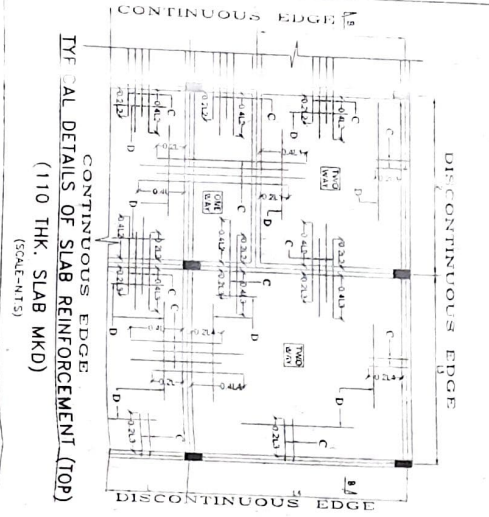

**DECLARATION OF ARCHITECT**

I, the undersigned, being a duly qualified and registered Architect, have examined the drawings and specifications of the proposed structure and certify that it is safe and stable in all respects.

Signature: \_\_\_\_\_  
 Name: \_\_\_\_\_  
 Date: \_\_\_\_\_

**DRAWING TITLE:** FLOOR BEAM, ROOF & ABOVE ROOF BEAM, SLAB LAYOUT PLAN & REINFORCEMENT SCHEDULE.

**DATE:** 23-10-2012

**SCALE:** 1:100

**PROJECT:** GADIA ASSOCIATES PVT LTD AT MOUDA - KHAYANI, RS & L.R. NO. 7482/401, 1280/2, 172/1, 2307, 3397, 3114/6, 2310/ST-24 (RESID.) UNDER JYANGGAS-VI/1982-2 (GADIA PARKWAY) PRESENT L.R.KH. NO. \_\_\_\_\_