

SITE PLAN FOR PROPOSED G+6TH.RESIDENTIAL FLAT BUILDING OF 1.TAPAN KUMAR PAL S/O LATE GOKUL CHANDRA PAL  
 2.GOPAL CHANDRA DEY S/O LATE UMA PATI DEY 3.SARADA DASHRATH BHARATE W/O LATE DASHRATH SOPAN BHARATE  
 4.KIRAN DASHRATH BHARATE S/O LATE DASHRATH SOPAN BHARATE AT MAHALLA-B.C.ROAD,HOLDING NO-28, WARD NO-29,  
 UNDER BURDWAN MUNICIPALITY.MOUZA-BURDWAN,J.L.NO-30,R.S.PLOT NO-7261,L.R.PLOT NO-8281,R.S.KH.NO-5359,

L.R.KH.NO-16614,16615,20237,20238,  
 P.S. & DIST.- PURBA BURDWAN.(SCALE-1"=20'-0")

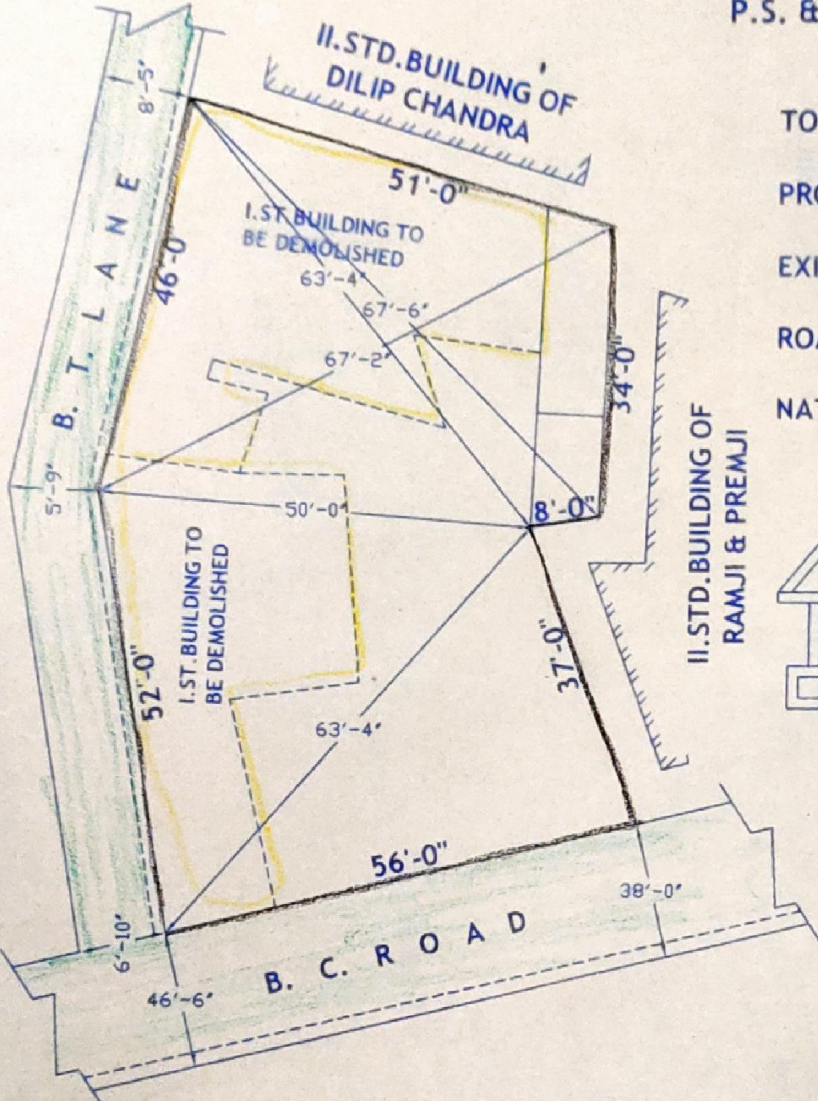

TOTAL AREA OF LAND = 4498.85 SQ.FT.

PROP. LINE SHOWN IN COLOUR = —

EXISTING CONST. SHOWN IN COLOUR = —

ROAD SHOWN IN COLOUR = —

NATURE OF LAND = BASTU

*[Signature]*  
 15/9/18  
 Chairman  
 Burdwan Municipality  
 CHAIRMAN

*[Signature]*  
 HEALTH OFFICER

*[Signature]*  
 15/9/18  
 ENGINEER

- Tapan Kumar Pal
- Gopal Ch. Dey
- सारदा दशरथ भारते
- Kiran Dashrath Bharate

*[Signature]*

DRAWN BY

OWNER