

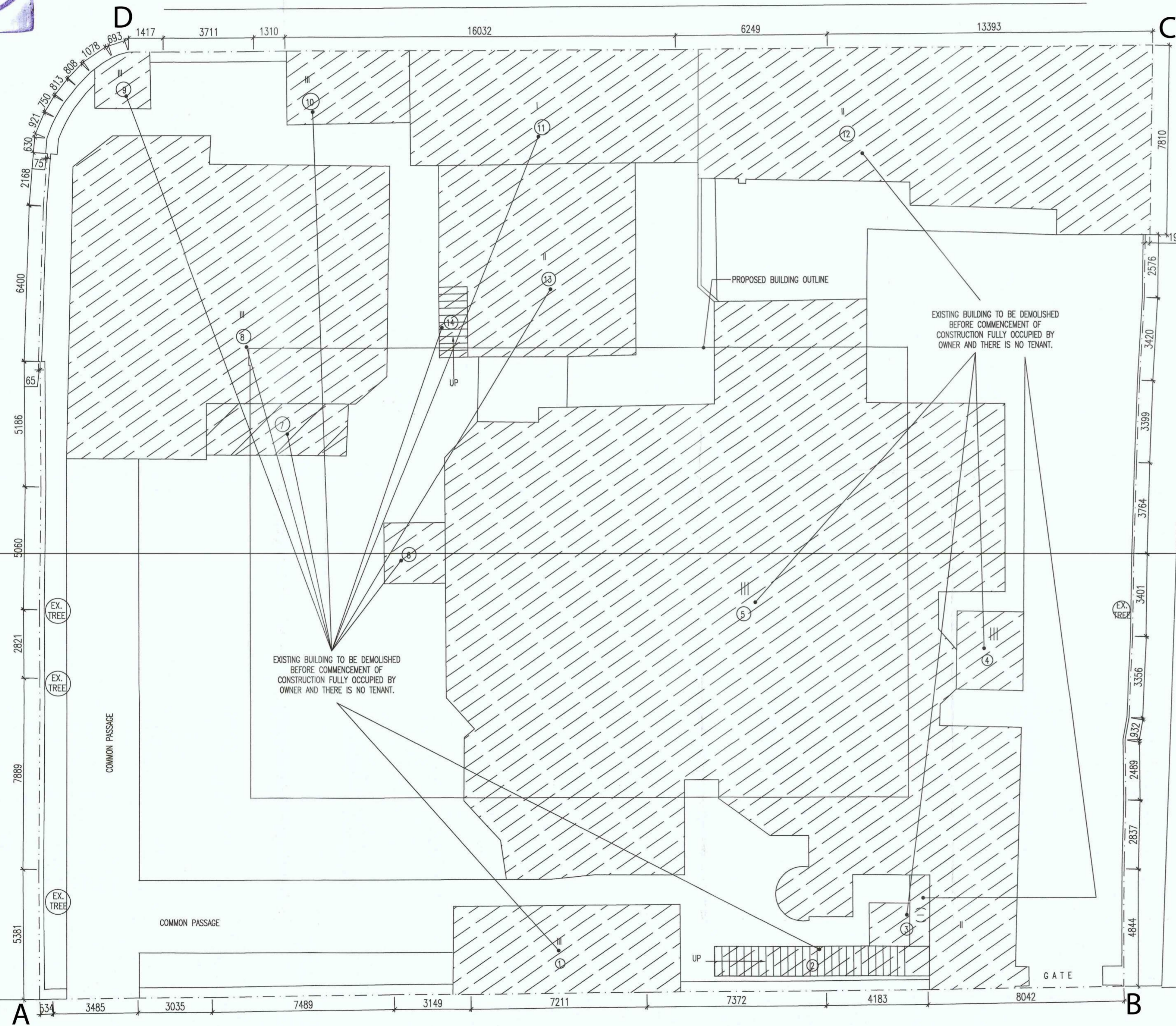

EXISTING III STORED BUILDING  
PRES. NO. - 7, SAROJINI NAIDU SARANI



NOTE:  
EXISTING BUILDING TO BE DEMOLISHED BEFORE COMMENCEMENT OF CONSTRUCTION FULLY OCCUPIED BY OWNER AND THERE IS NO TENANT.

LAND AREA (26K-13CH-7 SQ.FT.) = 1794.12 SQ.M. (AS PER DEED)

EXISTING COVERED AREA :

S.L. NO	AREA (SQ.M)
1.	33.78
2.	10.81
3.	5.40
4.	8.85
5.	460.93
6.	6.25
7.	12.37
8.	146.35
9.	4.85
10.	15.17
11.	55.53
12.	117.60
13.	60.56
14.	3.38
<b>TOTAL: 941.82</b>	

OPEN SPACE = 804.21 SQ.M

DECLARATION OF OWNER

I DO HEREBY UNDERTAKE WITH FULL RESPONSIBILITY THAT  
i) I SHALL ENGAGED L.B.S & E.S.E. DURING CONSTRUCTION.  
ii) I SHALL FOLLOWED THE INSTRUCTION OF L.B.S & E.S.E. DURING CONSTRUCTION OF BUILDING (AS PER B.S. PLAN)  
iii) KMC AUTHORITY WILL NOT BE RESPONSIBLE FOR STRUCTURE STABILITY OF THE BUILDING AND ADJOINING STRUCTURE.  
iv) IF ANY OF THE SUBMITTED DOCUMENTS ARE FOUND TO BE FAKE, THE KMC AUTHORITY WILL REVOKE THE SANCTION PLAN.

For : Kishwar Khan  
Yasmin Servaia  
Arshad Momen  
By their constituted Attorney  
Gulam Nayeem  
Gulam Momen  
Rehana Khan  
Afsana Marwah  
Faizana Khan  
Farhat Salahuddin  
Almas Hussain  
Faisal Momen  
By their constituted Attorney

SIGNATURE OF OWNER (CONSTITUTED ATTORNEY)  
MR. GAURAV DUGAR & SAIF KAMALESH SERVAIA,  
CONSTITUTED ATTORNEY OF GOLAM NAYEEM & OTHERS,  
KOLKATA-700017.

CERTIFICATE OF STRUCTURAL ENGINEER

THIS IS TO CERTIFY THAT THE STRUCTURAL DESIGN AND DRAWING OF BOTH FOUNDATION AND SUPER STRUCTURE OF THE PROPOSED BUILDING HAS BEEN MADE BY ME CONSIDERING THE SOIL TEST REPORT (AS PER THE RULES AND REGULATIONS MADE UNDER THE ACT) AND ALSO CONSIDERING ALL POSSIBLE LOADS INCLUDING THE SEISMIC LOAD AS PER THE NATIONAL BUILDING CODE OF INDIA AND CERTIFIED THAT IT IS SAFE AND STABLE IN ALL RESPECTS.

UTPAL SANTRA  
B.C.E., M.C.E. (STRUCT.)  
FILE: P/22/2009  
KMC Empanelled Structural Engineer  
Class-I, E.S.E. No. 1/58

SIGNATURE OF STRUCTURAL ENGG.

UTPAL SANTRA  
ESE / 1 / 58

M. K. ROY  
B. C. E. (Madras), M. Sc. TECH. (Manchester, U.K.)  
A. M. S. T. C. CIVIL, M.I. STRUCT. E. (London)  
Membership No. 20105900

SIGNATURE OF STRUCTURAL REVIEWER

MRIGANKA KUMAR ROY  
ESR - (I) 6/12

CERTIFICATE OF GEO-TECHNICAL ENGINEER.

UNDERSIGNED HAS INSPECTED THE SITE AND CARRIED OUT SOIL INVESTIGATION THEREON. IT IS CERTIFIED THAT THE EXISTING SOIL OF THE SITE IS ABLE TO CARRY THE LOAD COMING FROM THE PROPOSED CONSTRUCTION AND THE FOUNDATION SYSTEM PROPOSED HEREIN IS SAFE AND STABLE IN ALL RESPECT FROM GEO-TECHNICAL POINT OF VIEW.

ALOK ROY  
Empanelled Geotechnical Engineer  
Kolkata Municipal Corporation  
Class-I, No. - 6/7/11  
64, Milan Park,  
Kolkata-700 084

SIGNATURE OF GEO-TECHNICAL ENGG.

ALOK ROY  
GT/1/007

CERTIFICATE OF ARCHITECT.

I CERTIFY THAT ALL THE ARCHITECTURAL DRAWINGS OF THE PROJECT AT PREMISES NO. 6, SAROJINI NAIDU SARANI, KOLKATA-700017, WARD NO. 63 BOROUGH - VII HAVE BEEN PREPARED BY ME COMPLYING WITH THE KMC BUILDING RULES 2009.

I SHALL BE HELD RESPONSIBLE IF ANY INCORRECT INFORMATION IS FURNISHED BY ME OR ANY VIOLATION OF THE PROVISION OF KMC BUILDING RULE 2009 IS FOUND IN ANY OF THE DRAWINGS AND DOCUMENTS, SIGNED BY ME AND SUBMITTED TO THE SANCTIONING AUTHORITY FOR OBTAINING SANCTION.

I SHALL BE LIABLE FOR PENAL ACTION AS PER LAWS OF THE TIME BEING IN FORCE.

JAY PRAKASH BHARAT KUMAR AGRAWAL  
B. Arch., A.I.A.,  
Reg. No. CA / 86 / 10088  
ARCHITECT. S.L. NO. - 32(A)

SIGNATURE OF ARCHITECT.  
JAY PRAKASH BHARAT KUMAR AGRAWAL  
REGN. NO. - CA/86/10088

TITLE-  
SITE PLAN SHOWING EXISTING STRUCTURE

PROJECT-  
PROPOSED (B+G+XIV) STORED RESIDENTIAL BUILDING (OF BLDG. HT. 56.00 M) U/S 393A OF KMC ACT 1980 ALONG WITH RULE 69 A (i) (a) BLDG. RULE 2009 AT PREMISES NO. 6, SAROJINI NAIDU SARANI, KOLKATA-700017, WARD NO. 63 BOROUGH - VII.

ARCHITECTS

AGRAWAL & AGRAWAL			
BARODA		KOLKATA	
SCALE	DATE	DEALT	CHECKED
1 : 100	26.12.2017	AMIT	SUPRIYA

	NORTH	EAST
A	22° 32' 45.2"	88° 21' 32"
B	22° 32' 46.5"	88° 21' 32.5"
C	22° 32' 47.1"	88° 21' 31.2"
D	22° 32' 45.8"	88° 21' 30.7"

SITE PLAN SHOWING EXISTING STRUCTURE

S A R O J I N I N A I D U S A R A N I