



EXISTING III STORED BUILDING
PRES. NO. :- 7, SAROJINI NAIDU SARANI

EXISTING VIII STORED BUILDING
PRES. NO. :- 5, SAROJINI NAIDU SARANI



NOTE:
EXISTING BUILDING TO BE DEMOLISHED BEFORE COMMENCEMENT OF CONSTRUCTION FULLY OCCUPIED BY OWNER AND THERE IS NO TENANT.

SL. NO	EXISTING COVERED AREA (AS PER DEED)	AREA (SQ.M)
1.		33.78
2.		10.81
3.		5.40
4.		8.85
5.		460.93
6.		6.25
7.		12.37
8.		146.35
9.		4.85
10.		15.17
11.		55.53
12.		117.60
13.		60.56
14.		3.98
OPEN SPACE = 804.21 SQ.M		
TOTAL: 941.82		

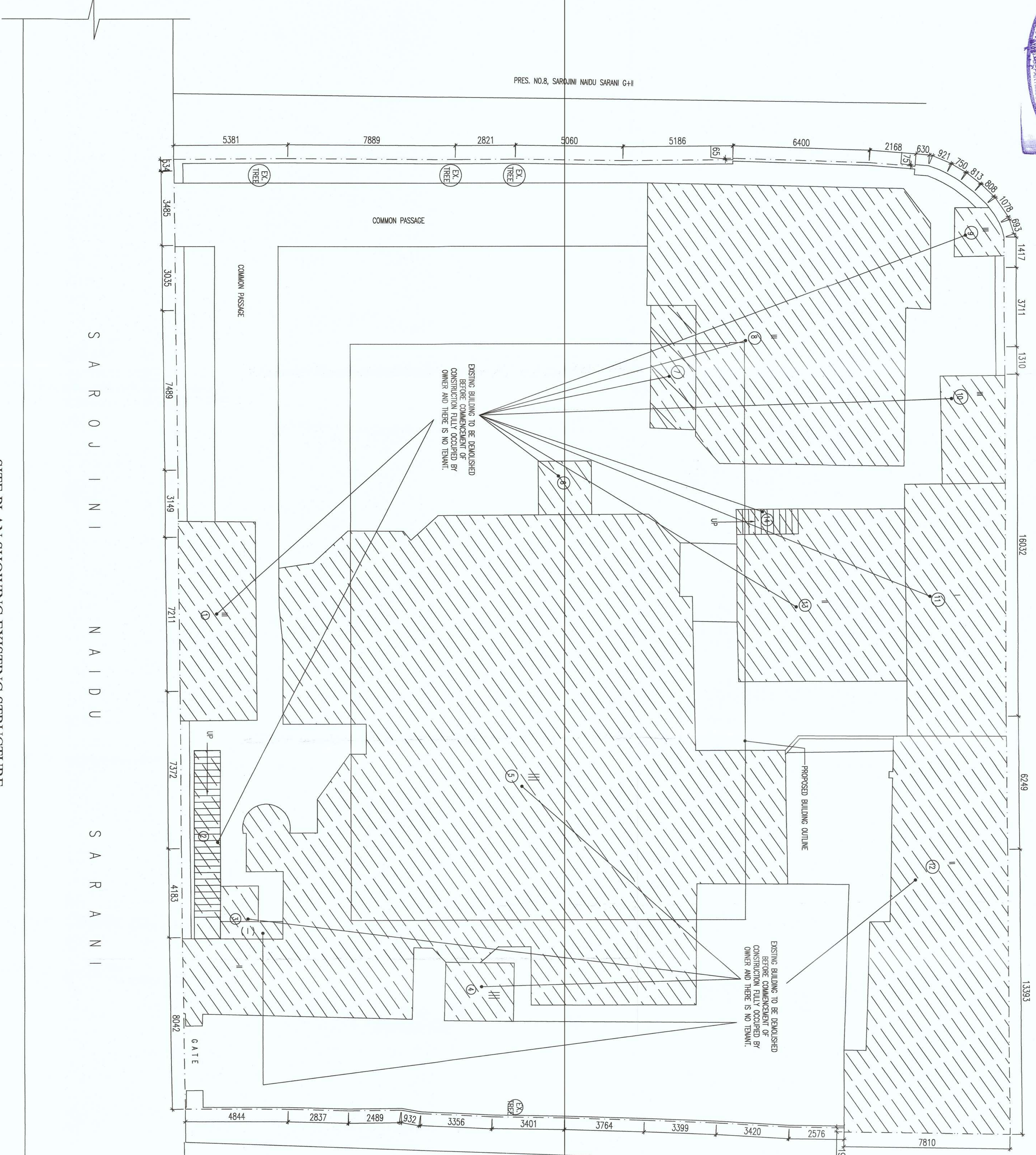

SITE PLAN SHOWING EXISTING STRUCTURE

S A R O J I N I N A I D U S A R A N I

DECLARATION OF OWNER

I DO HEREBY UNDERTAKE WITH FULL RESPONSIBILITY THAT
 (i) I SHALL ENGAGED L.B.S & E.S.E. DURING CONSTRUCTION.
 (ii) I SHALL FOLLOWED THE INSTRUCTION OF L.B.S & E.S.E. DURING CONSTRUCTION OF BUILDING (AS PER B.S. PLAN).
 (iii) KMC AUTHORITY WILL NOT BE RESPONSIBLE FOR STRUCTION STABILITY OF THE BUILDING AND ADJOINING STRUCTION.
 (iv) IF ANY OF THE SUBMITTED DOCUMENTS ARE FOUND TO BE FAKE, THE KMC AUTHORITY WILL REMOVE THE SANCTION PLAN.

SIGNATURE OF OWNER
 MR. GAURAV DUGAR & SAI KAMALESH SERIWA,
 CONSTITUTED ATTORNEY OF GOLAM NAYEM & OTHERS,
 6 SAROJINI NAIDU SARANI, KOLKATA-700017.

CERTIFICATE OF STRUCTURAL ENGINEER
 THIS IS TO CERTIFY THAT THE STRUCTURAL DESIGN AND PERFORMING OF BOTH FOUNDATION AND SUPER STRUCTURE OF THE PROPOSED BUILDING HAS BEEN MADE BY ME CONSIDERING THE SOIL TEST REPORT (AS PER THE RULES AND REGULATIONS MADE UNDER THE ACT) AND ALSO CONSIDERING ALL POSSIBLE LOADS INCLUDING THE SEISMIC LOAD AS PER THE NATIONAL BUILDING CODE OF INDIA AND CERTIFIED THAT IT IS SAFE AND STABLE IN ALL RESPECTS.

SIGNATURE OF STRUCTURAL ENGINEER
 UTPAL SANTHA
 ESE / 11/88
 B. C. E. (Structure), M. E. (EST), (West Bengal), IIT Kharagpur, Kharagpur, West Bengal, India
 Registration No. 20100000
 MEGHANKA KUMAR ROY
 ESR - (I) 612

CERTIFICATE OF GEO-TECHNICAL ENGINEER
 UNDERSIGNED HAS INSPECTED THE SITE AND CARRIED OUT SOIL INVESTIGATION THEREON. IT IS CERTIFIED THAT THE EXISTING SOIL OF THE SITE IS ABLE TO CARRY THE LOAD COMING FROM THE PROPOSED CONSTRUCTION AND THE FOUNDATION SYSTEM PROPOSED HEREIN IS SAFE AND STABLE IN ALL RESPECT FROM GEO-TECHNICAL POINT OF VIEW.

SIGNATURE OF GEO-TECHNICAL ENGINEER
 ALOK ROY
 Registered Geotechnical Engineer
 Kolkata Municipal Corporation
 Class-I, No.- 63/1/11
 6th, Midnapore Road
 Kharagpur-751004

SIGNATURE OF ARCHITECT
 ALOK ROY
 GT/1007

CERTIFICATE OF ARCHITECT
 I CERTIFY THAT ALL THE ARCHITECTURAL DRAWINGS OF THE PROJECT AT PREMISES NO. 6, SAROJINI NAIDU SARANI, KOLKATA-700017, WARD NO. 63, BOROUGH - VII HAVE BEEN PREPARED BY ME COMPLYING WITH THE KMC BUILDING RULES 2009.

I SHALL BE HELD RESPONSIBLE IF ANY INCORRECT INFORMATION IS FURNISHED BY ME OR ANY VIOLATION OF THE PROVISIONS OF KMC BUILDING RULE 2009 IS FOUND IN ANY OF THE DRAWINGS AND DOCUMENTS, SIGNED BY ME AND SUBMITTED TO THE SANCTIONING AUTHORITY FOR OBTAINING SANCTION.

I SHALL BE LIABLE FOR PENAL ACTION AS PER LAWS OF THE TIME BEING IN FORCE.

AGRAWAL & AGRAWAL
 BARODA KOLKATA
 ARCHITECTS
 PROJECT- PROPOSED (B+G+XIV) STORED RESIDENTIAL BUILDING (OF BLDG. HT. 56.00 M) US 393A OF KMC ACT 1980 ALONG WITH RULE 69 A (I) (a) BLDG. RULE 2009 AT PREMISES NO. 6, SAROJINI NAIDU SARANI, KOLKATA-700017, WARD NO. 63, BOROUGH - VII.
 SCALE DATE DEALT CHECKED
 1 : 100 26.12.2017 AMIT SUPRIYA

PARTY'S COPY

Plan for Water Supply arrangement including the SEMI-C.G. & Office of the Executive Engineer and the sanction obtained before proceeding with the work of Water Supply any deviation may lead to disconnection/demolition.

No rain water pipe should be fixed or discharged on Road or Footpath. Drainage plan should be submitted at the Borough Executive Engineer's Office and the same should be approved before proceeding with the drainage work.

A suitable pump has to be provided, i.e. pumping unlimited water and its distribution to the flushing cisterns and urinals in the building increase unlimited water from street main is not available.

DEVIATION WOULD MEAN DEMOLITION

Approved By: *[Signature]*
The Building Committee



* Provision for use of solar energy in the form of solar heater and / or solar photo-cells shall be provided as required under Rule 147 of Building rules, 2009 and completion certificate will not be issued in case of building without having such provision *

The building materials that will be used for the construction of the building should be of good quality and should be of the type specified in the Building Code of India. The building materials should be of the type specified in the Building Code of India. The building materials should be of the type specified in the Building Code of India.

Before starting any construction the site must conform with the plans sanctioned and all the conditions as proposed in the plan should be fulfilled. The validity of the written permission to execute the work is subject to the above conditions.

Design of all Structural Members including that of the foundation should conform to standards specified in the National Building Code of India.

All Building Materials to be used in construction should conform to standards specified in the National Building Code of India.

Non Commencement of Erection/ Re-Erection within Two Year will Require Fresh Application for sanction.

THE SANCTION IS VALUED UP TO 11.11.19

APPROVED
ASSISTANT ENGINEER (C)
BOROUGH AND

Sanctioned subject to demolition of existing structure to provide for the construction of the building before construction is started.

Executive Engineer (C)
Br. PLAN
Approved by: *[Signature]*
Assistant Engineer (C)
K.M.C. BIRJE - DCP-1

OFFICE OF THE DEPUTY CHIEF ENGINEER
BUILDING DIVISION - VII
K.M.C. BIRJE - DCP-1

THE KALYANA MUNICIPAL CORPORATION

CONSTRUCTION SITE SHALL BE MAINTAINED TO PREVENT MOSQUITO BREEDING AS REQUIRED UNDER RULE 147 OF BUILDING RULES, 2009 AND SO THAT ALL WATER COLLECTION DRAINING SITES, OPEN UPT WELLS, ETC. MUST BE EMPTIED COMPLETELY TWICE A WEEK.

GREEN BUILDING
Green Building Rating: *[Signature]*
Certifying Authority: *[Signature]*
Reference No.: *[Signature]*
Date: *[Signature]*
K.M.C. BIRJE - DCP-1

RESIDENTIAL BUILDING